



ReverieTM

DECORATIVE LOW BAY

Columbia
LIGHTING

Current®

Features and Benefits

Reverie™ Decorative Low Bay delivers an integrated solution for educational, automotive and retail spaces. With extensive distribution options, multiple control capabilities and continuous illumination, RLB offers customizable options that fit perfectly in your low bay applications.

Versatility

Available in 4' or 8'; row mounting optional. Reverie Decorative Low Bay offers a unified look across a variety of spaces

Lens

Contoured frosted acrylic for even illumination without pixelation

Best in Class Emergency Solutions

CSA certified to UL 924 standards with battery pack or DTS (Dimming Bypass Module) options

Decorative End Caps

Injection Molded ABS material end caps; standard

Ease of Installation

Easily mounts and wires without accessing the electrical channel

Illumination

Uninterrupted ribbon of light for single or row mount applications; fluorescent technology creates shadow and interrupted ribbon of light

DLC LISTED

DLC LISTED PREMIUM

Reverie is DLC® (DesignLights Consortium) Qualified, with Premium Qualified configurations — see www.designlights.org for specific SKU's on QPL

Advanced Technology Options from NX Lighting Controls

NX LIGHTING CONTROLS

- Code-compliant lighting controls with wired and wireless networking
- Integrated sensor with occupancy/vacancy, daylighting and scheduling built-in
- NX Lighting Controls digital wall switch stations, touchscreens, and sensors
- Stand-alone to building-wide scaling with native BACnet® integration
- Simplified setup with the NX mobile app for iOS and Android devices

SpectraSync™

Color Tuning Technology

- Tunable White to enhance task visibility, colors, materials and aesthetics
- Correlated color temperature (CCT) LED ranges in 2700K-5000K or 2700K-6500K
- Tailor lighting match to occupant preferences, applications and activities
- NX Lighting Controls digital touchscreen and wall switch station control
- Time of day scheduling and manual preset CCT settings with continuous dimming

Light Delivered Exactly Where You Need It

With its medium, narrow and aisle/stack distribution options, Reverie offers lighting solutions for a variety of spaces. Optional upright, available up to 4,000 lumens, removes "the cave effect" by pleasantly illuminating your ceilings.



Medium Distribution

Mid-range, diffused path of light

- General lighting
- Work spaces



Narrow Distribution

Concentrated channel of light

- Auto service areas
- Manufacturing stations



Aisle/Stack Distribution

Bidirectional paths of light

- Library bookshelves
- Store aisles

Unified Appearance in Different Applications

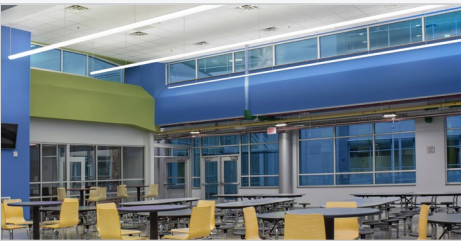

Medium Distribution



Narrow Distribution

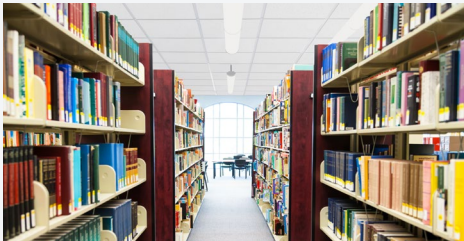

Stack/Aisle Distribution

Ordering Information

EXAMPLE RLB4-35LV-FAN-EDU

YOUR ORDER

MODEL ¹		SIZE	CRI	COLOR TEMP	LUMEN OUTPUT ³	SHIELDING	DISTRIBUTION	UPLIGHT ^{4,5,6}
RLB	Reverie™ Decorative Low Bay	4 4'	Blank >80	30 3000K	LL 4' (3949) 8' (7898)	FA Frosted Acrylic	M Medium N Narrow A Aisle/Stack	Blank No Uplight
		8 8'	9 >90	35 3500K	LLHE 4' (4057) 8' (8114)			U1 Uplight 1000 Lumens
				40 4000K	LM 4' (5688) 8' (11,376)			U2 Uplight 2000 Lumens
				50 5000K	LMHE 4' (5888) 8' (11,776)			U3 Uplight 3000 Lumens
				2750T 2700K-5000K SpectraSync™ Tunable White ²	LH 4' (7530) 8' (15,060)			U4 Uplight 4000 Lumens
FA				2765T 2700K-6500K SpectraSync™ Tunable White ²	LHHE 4' (7828) 8' (15,656)			
					LV 4' (9507) 8' (19,014)			
					LVHE 4' (9705) 8' (19,410)			
					LX 4' (11,357) 8' (22,714)			
					LXHE 4' (11,644) 8' (23,288)			

DRIVER	VOLTAGE	OPTIONS	CONTROL OPTIONS ^{21,22}
E Fixed Output	U 120-277V	ELL14 Emergency Battery Pack, 1400 Lumens ¹⁰	NX Networked – Wired NXE NX Wired Dual RJ45 SmartPORTS , without Sensor NXESM NX Wired Dual RJ45 SmartPORTS and Integral NXSMP2-SMI PIR Occupancy Sensor with Automatic Dimming Photocell and Bluetooth Programming NXERM NX Wired Dual RJ45 SmartPORTS and Integral NXSMP2-LMI PIR Occupancy Sensor with Automatic Dimming Photocell and Bluetooth Programming NXEOM NX Wired Dual RJ45 SmartPORTS and Integral NXSMP2-OMNI PIR Occupancy Sensor with Automatic Dimming Photocell and Bluetooth Programming NXELM NX Wired Dual RJ45 SmartPORTS and Integral NXSMP2-LMO PIR Occupancy Sensor with Automatic Dimming Photocell and Bluetooth Programming NXEHM NX Wired Dual RJ45 SmartPORTS and Integral NXSMP2-HMO PIR Occupancy Sensor with Automatic Dimming Photocell and Bluetooth Programming
ED 0-10V Dimming	347 347V	GTD Generator Transfer Device ¹¹	
ED1 0-10V 1% Dimming	480 480V ⁹	DTS Dimming Bypass Module ¹²	
EDD 0-10V Dim-to-Off ⁷		ATSD Auxiliary Transfer Switch ¹¹	
ESD Step Dimming ⁸		GLR Fast Blow Fuse	
ACCESSORIES (ORDER SEPARATELY)		C6TLL15 6' - Cord and Twist -Lock Plug 15 A (Add Voltage 1=120-, 2=277)	NX Networked – Wireless NXW NX Networked Wireless Radio Module NXRM2 and Bluetooth Programming, without Sensor NXWSM NX Networked Wireless Enabled Integral NXSMP2-SMI PIR Occupancy Sensor with Automatic Dimming Photocell and Bluetooth Programming NXWRM NX Networked Wireless Enabled Integral NXSMP2-LMI PIR Occupancy Sensor with Automatic Dimming Photocell and Bluetooth Programming NXWOM NX Networked Wireless Enabled Integral NXSMP2-OMNI PIR Occupancy Sensor with Automatic Dimming Photocell and Bluetooth Programming NXWOM NX Networked Wireless Enabled Integral NXSMP2-OMNI PIR Occupancy Sensor with Automatic Dimming Photocell and Bluetooth Programming
		C6TL20 6' - Cord and Twist -Lock Plug 20 A (Add Voltage 1=120-, 2=277)	
		C6P151 6' - Cord and Straight Blade Plug 15 A (Voltage = 120)	
		EOR End of Row ^{13,14,15,16}	
		INT Intermediate ^{13,14,15,16,17}	
		LBC LED Branch Circuit Wiring	NX Connect – Wireless NXCXS NX Connect NXC-WIZ20 Wireless Indoor Occupancy & Photocell Sensor ¹ NX Connect Networked – Wireless NXENS NX Connect Networked NXC-WIZ20 Wireless Indoor Occupancy & Photocell Sensor ²
		SSP10 10kVA Surge Suppression Protection	
		MST MASTER fixture that controls one or more SATELLITE fixtures in a continuous row application ^{13,14,15,18,19,20}	
		SAT SATELLITE fixture controlled by MASTER fixture in a continuous row application ^{13,14,15,19,20}	

1 Through wiring is limited to maximum 25°C when surface mounted

2 Not available with HE lumen outputs

3 See spec sheet for additional lumen output information. High efficacy versions designated with "HE"

4 Not available in surface mount

5 Not available with 2750T or 2765T

6 Nominal lumens listed are per 4'. See page 3 of spec sheet for further uplight detail

7 Not available with uplight

8 Not available on LV, LVHE, LX or LXHE lumen outputs

9 Contact local representative for compatibilities

10 LX, LXHE limited to 25°C. LV, LVHE limited to 30°C

11 GTD and ATSD available for universal voltage and fixed output driver options only

12 For emergency circuit control loads including sensors and wireless systems CSA certified to UL 924. Only available with 0-10V drivers. Universal voltage only. See spec sheet for wiring diagram

13 Not available with DTS, GTD, or ATSD

14 All fixtures in a row must be the same driver type and voltage

15 Includes quick-connect wiring harness

16 A row-connector kit will be included with each fixture when EOR or INT is selected

17 Suspension support required at every fixture coupling; see Mounting Accessories Guide

18 MST option not available with INT row position

19 Multiple SAT fixtures can be controlled by one MST fixture. Any one SAT fixture can have no more than one connected MST fixture

20 NX is supported for this application; consult brand for use with other controls systems

NX In-Fixture Control Options:

1 NX Connect devices can be customized with the NX Connect app, available on the Apple® App Store

2 NX Connect Networked devices can be customized with the NX Connect app, available on the Apple® App Store



Current Lighting Solutions, LLC

701 Millennium Blvd.
Greenville, SC 29607

currentlighting.com/columbialighting

© 2022 HLI Solutions, Inc. All rights reserved. Information and specifications subject to change without notice. All values are design or typical values when measured under laboratory conditions.

Rev 06/27/23

COL_RLB_B_R02
