



KIMLIGHTING

Ouro

Current®

form performance control
no compromise

ouro

The striking form seamlessly blends high performance optics, controls, scalability and mounting options to cover more applications and enhance the environment they occupy.

form
design freedom



Ouro

solo arm • post top • arm mount

Two sizes, two mounting configurations, two post top aesthetics. Ouro provides a unique, scalable lighting solution targeted for 8' to 40' mounting heights. Its design brings proportion to parking lots, drive lanes, entrances, building perimeters and pathways.

performance
with aesthetics

Exceptional performance and uniformity with three lens configurations: clear, diffuse and no lens options. Outputs range from 3,000lm to 35,000lm. Unparalleled performance with visual comfort, the low glare, diffuse lens is available in Type III and Type V distributions.

Kim Lighting's nine optical distributions ensure precise, even illumination throughout the application.

Ouro

performance

edge-lit

Pedestrian cityscape requires an architectural luminaire to enhance the site by day and to provide visual comfort and security by night.

Ouro
EDGE-LIT

Ouro Edge-Lit features advanced light guide lens technology with optical precision that maximizes fixture spacing. With this exceptional light distribution and high peak angles, Ouro Edge-Lit delivers more light where you need it (street side) and less where do not (house side).

IES Type II (Medium) Distribution

Medium rectangular distribution for maximizing pole spacing along pathways or sidewalks.

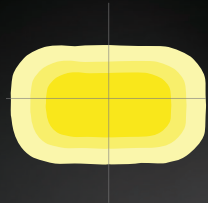

IES Type III (Short) Distribution

Wide distribution with forward throw for general illumination. Primarily used at the perimeter in conjunction with IES Type V luminaires.

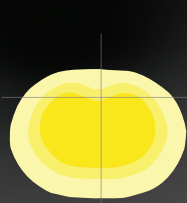

IES V (Wide) Distribution

Wide symmetrical distribution with optimized pole spacing for perimeter site lighting applications.



Today's urban green spaces, parks and pedestrian walkways provide outdoor space for exercise, entertainment, family and community gatherings. The design of these spaces improves the quality of life for local citizens and is in high demand.

From large scale parking areas that require higher mounting heights, greater outputs, and wider distributions to pedestrian walkways where visual comfort is a must, the Ouro is offered in arm, wall, and post top mounting is the ideal solution for any architectural application.

visual comfort

The Ouro Edge-Lit light guide technology features no hot-spots and unmatched visual comfort without compromising performance, uniformity, and IES distributions.



Front Row Distribution

Concentrated wide pattern provides targeted front row illumination for applications such as automobile dealerships or very narrow drive lanes.



IES Type II Distribution

Wide rectangular pattern for maximizing drive lane applications.



IES Type III Distribution

Wide rectangular distribution with forward throw. Primarily used at the perimeter in conjunction with IES Type V luminaires.



IES Type IV Distribution

Forward throw distribution with optimized pole spacing for perimeter site lighting applications.



IES Type V (Medium) Distribution

Wide/square symmetric distribution for interior site lighting applications.

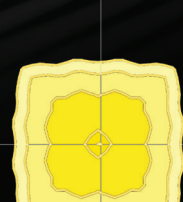

IES Type V (Narrow) Distribution

Narrow/square symmetric distribution for interior site lighting applications.

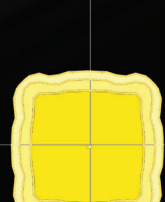

IES Type V (Rectangular) Distribution

Narrow/rectangular symmetric distribution for interior site lighting applications.

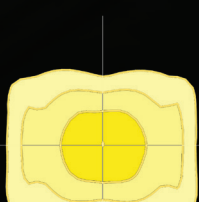

IES Type V (Wide) Distribution

Wide/round symmetric distribution for interior site lighting applications.

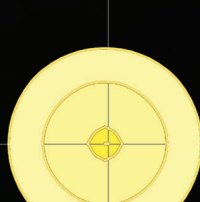

engineered excellence

The Ouro is designed to the highest standards of excellence and quality with attention focused on the finest details to aid installation and maintenance.

Features include:

- Tool free entry
- Tamper resistant hardware available
- Hidden hinge allows access to the electrical components without compromising the exterior design
- Kickstand enables safe installation and easy maintenance
- Speed Mount aids pole and wall installation
- IP66 options ensure robustness in application
- Dynamic thermal regulation protects LEDs and electronics under extreme temperatures

Hinges

Kickstand

Latch

For over seven decades, Kim Lighting has a reputation of providing the highest quality luminaires and the Ouro continues in that tradition. All housing components are constructed with die-cast, low copper alloy (<0.6%) aluminum for superior durability. One piece silicone gaskets enable an IP66 rated optical compartment and assure optical integrity over time. Stainless steel hardware is used to properly secure all components within the housing. Ouro maintains a 4G vibration rating in both post top and arm mount configurations.

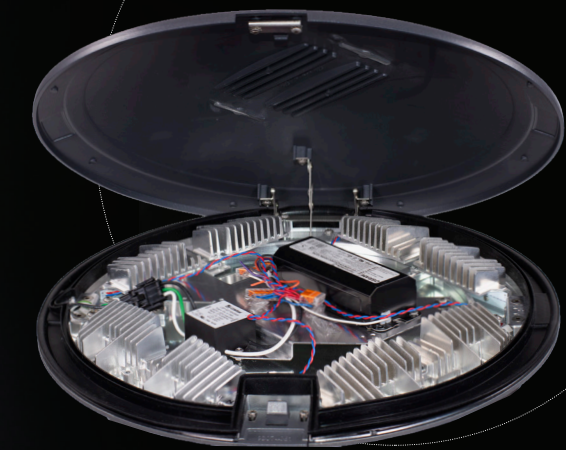



solo arm post top

mounting

Complements the Ouro's design language. The Solo Arm post top will fit into a 3" or 4" pole and is also available with a twin arm pole mount and a wall mount. The Solo arm post top is available in the 20" version of the Ouro in both TIR Strike and Edge-Lit, perfect for pedestrian scale application.

FMSA33 3" Solo Arm Post Top Flush Mount 3.0" OD Pole

FMSA34 4" Solo Arm Post Top Flush Mount 3.6" to 4.0" OD Pole

PTSA23 3" Solo Arm Post Top Mount for 2-3/8" OD x 4" Long Tenon

PTSA24 4" Solo Arm Post Top Mount for 2-3/8" OD x 4" Long Tenon

PTSA34 4" Solo Arm Post Top Mount for 2-7/8" OD x 4" Long Tenon

WBFM3 3" Solo Arm/Standard Post Top Mount Wall Bracket

WBFM4 4" Solo Arm/Standard Post Top Mount Wall Bracket

TAFM3 3" Solo Arm/Standard Post Top Mount Twin Arm Mount

TAFM4 4" Solo Arm/Standard Post Top Mount Twin Arm Mount



WBFM3/WBFM4

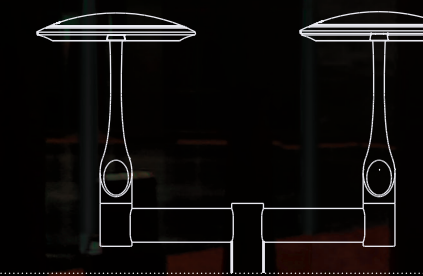

TAFM3/TAFM4



FMSA33/ FMSA34
PTSA23/ PTSA24/ PTSA34



post top mounting

Flush mount options enable seamless transitions to 3", 4" and 5" round poles. Tenon mounts to fit 2" and 3" tenons are also available. Choose from 3" and 4" fixture base diameters on the UR20 and 4" or 5" fixture base diameters on the UR28.

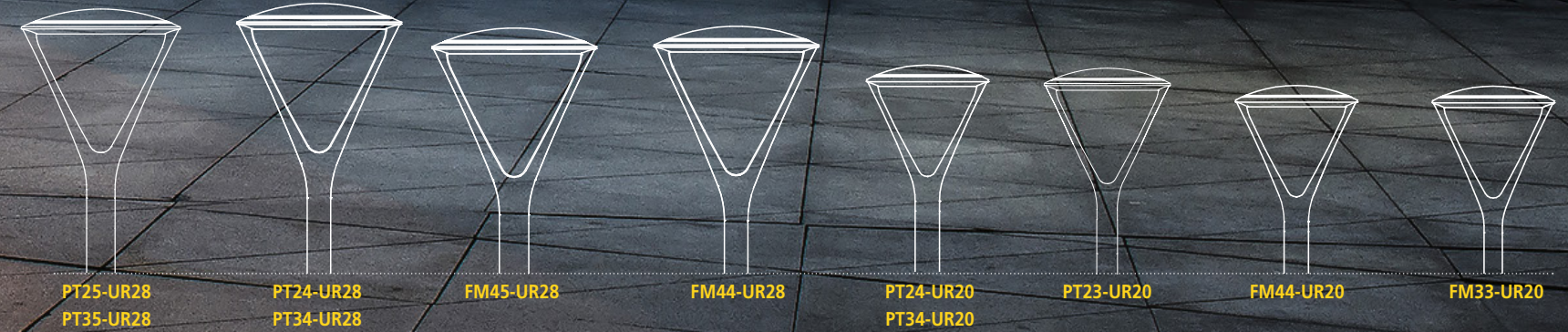

arm mounting

Ouro arm mounts fit 3 to 6" round poles or 4" and larger square poles. Install Kim Lighting's Speed Mount anchor to the pole and the luminaire seamlessly slides into place. Kim Lighting also offers a horizontal slipfitter, round and square vertical slipfitters and a wall mount option.

ASQ	Arm Square pole	SVSF	Square Vertical Tenon Fitter
A34	Arm 3.0-4.0" OD Round pole	VSF	Round Vertical Tenon Fitter
A46	Arm 4.5-6.0" OD Round pole	WB	Wall Bracket

control integration



NX Lighting Controls utilizes a Distributed Network Architecture (DNA) that connects intelligent devices including luminaires, controllers, panels, occupancy sensors, photocells, wall switches and dimmers, creating a system with an unmatched level of reliability, scalability and simplicity.

Elevated Scale

The Ouro has a variety of architectural mounting options that can be used to scale any application. It also unlocks multiple aesthetic styles in the wall and pole category with the addition of the Solo arm post top and the wall arm and twin arm pole mount options. These mounting options accentuates the architecture and maximizes the freedom to design any application without limitations.



theory of relativity

Arm Mount 30 ft

Arm Mount 24 ft

Post Top 12 ft

Wall Mount 9ft

Bollard 4ft

In-Grade

Theory of Relativity

The Kim Lighting Theory of Relativity promotes harmony between the outdoor lighting and architecture through a seamless blending of the two. Comprehensive product families allow specifiers to carry a continuous aesthetic through the project regardless of the application. As distance to structures decreases, luminaire height and scale decrease accordingly, maintaining visual comfort and contextual balance. This maximizes efficiency while preserving and enhancing the architectural experience.

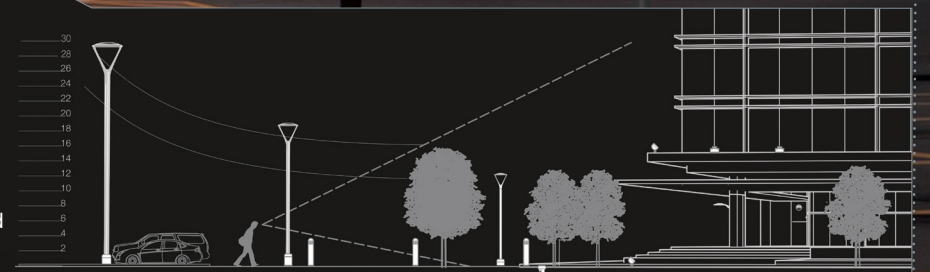

ordering information

UR20 | a r m m o u n t

UR20 | p o s t t o p / s o l o a r m

1. SERIES	2. LED ENGINE	3. CCT	4. DISTRIBUTION	5. ROTATION	6. VOLTAGE	7. MOUNTING
UR20 Ouro	No or Clear Lens 24L-25 3,000 lm 24L-65 7,000 lm 56L-75 10,000 lm 56L-110 15,000 lm 56L-140 17,000 lm HDL - High Diffusion Lens* 28L-30 3,000 lm 28L-70 7,000 lm 68L-80 9,000 lm 68L-115 13,000 lm 68L-150 15,000 lm	AM¹¹ Amber, 595nm 27K8 2700K, 80 CRI 3K7 3000K, 70 CRI 3K8 3000K, 80 CRI 35K8 3500K, 80 CRI 3K9 3000K, 90 CRI 4K7 4000K, 70 CRI 4K8 4000K, 80 CRI 5K7 5000K, 70 CRI <i>Consult factory for other CCTs and CRIs</i>	No Lens or Clear Lens FR Type I/Front Row 2 Type II 3 Type III 4 Type IV 4W Type IV Wide 5QM Type V Square Medium 5QN Type V Square Narrow 5R Type V Rectangular 5W Type V Wide (Round) HDL - High Diffusion Lens 3 Type III/Asymmetric 5W Type V/Symmetric	(Blank) Blank for no rotation L¹ Optic rotation left R¹ Optic rotation right	UNV 120-277V 347 347V 480 480V DALI 120-277V* <i>* Consult factory</i>	ASQ Arm Square pole A34 Arm mt 3.3-4.2" OD pole A46 Arm mt 4.5-6.0" OD pole MAF Horizontal Slip Fitter 2 3/8" OD arm SVSF Square Vertical Slipfitter for 2" Tenon (2-3/8" OD) VSF Round Vertical Slipfitter for 2" Tenon (2-3/8" OD) WB Wall Bracket

8. FINISH	9. CONTROL OPTIONS	10. OPTIONS	11. CONTROL ACCESSORIES
BLS Black Gloss Smooth BLT Black Matte Textured DBS Dark Bronze Gloss Smooth DBT Dark Bronze Matte Textured GTT Graphite Matte Textured LGS Light Grey Gloss Smooth LGT Light Grey Matte Textured PSS Platinum Silver Gloss Smooth VGT Verde Green Matte Textured WHS White Gloss Smooth WHT White Matte Textured Color Option CC Custom Color ⁷	7PR-TL 7 pin PCR with twist lock photocontrol 7PR-SC 7 pin PCR with shorting cap 7PR 7 pin PCR, wireless control enabled AD-01² AstroDIM: 50% output at midnight AD-02² AstroDIM: 50% output midnight to 4 AM AD-03² AstroDIM: 50% output 10PM AD-04² AstroDIM: 50% output 10PM to 4AM NXWE¹⁵ NX Networked Wireless Radio Module, without Sensor WSP-40F-1^{2,5} Dimming Occ. Sensor for up to 40' MH, 120/277/347V	BC⁴ Back-light Control SF Single Fuse DF Double Fuse TB Terminal Block CLR Clear Lens HDL Diffuse Lens TL Tamper proof latch	WIR-RME-L wiSCAPE External Fixture Module SCL-R Occ. Sensor for Round Pole (up to 16' MH) SCL-S Occ. Sensor for Square Pole (up to 16' MH) SCH-R Occ. Sensor for Round Pole (16' to 30' MH) SCH-S Occ. Sensor for Square Pole (16' to 30' MH)

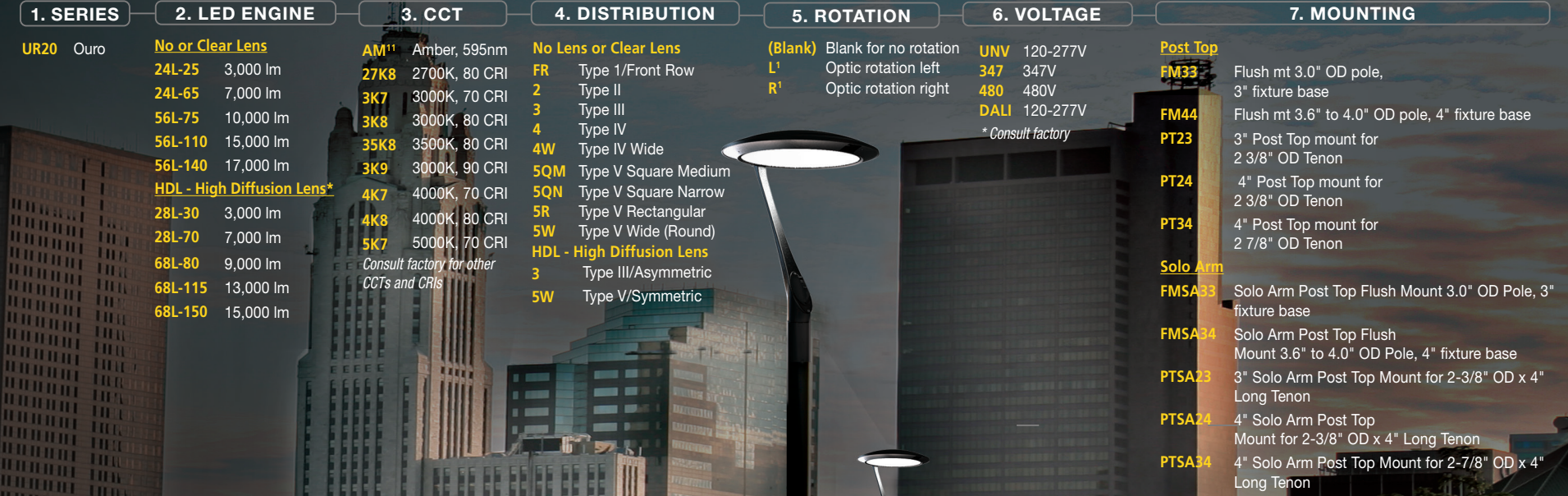

¹ Not available with 5QM, 5QN, and 5W distributions.
² Not available with other sensor or wireless control options.
³ Specify group and zone at time of order. See www.hubbellighting.com/sitesync for more details. Order at least one SiteSync interface accessory SWUSB or SWTAB. Each option contains SiteSync™ License, GUI, and Bridge Node.
⁴ Not available with 347V and 480V.
⁵ 96L only.
⁶ Not available with HDL option.
⁷ Consult factory for custom color, marine and corrosive finish options.
⁸ Turtle Friendly.
⁹ Please see Delivered Lumens chart on Page 5 for lumen
¹⁰ Microsoft, Encarta, MSN, and Windows are either registered trademarks or trademarks of Microsoft Corporation in the United States and/or other countries.
¹¹ Not available with 96L-255 and the 96L-315 configuration of the LED Engine
¹² IK10 rated. Consult factory for details
¹³ IK08 rated. Consult factory for details
¹⁴ Not available with 5QM, 5QN, and 5W distributions.
¹⁵ Not available with other sensor or wireless control options.
¹⁶ Specify group and zone at time of order. See www.hubbellighting.com/sitesync for more details. Order at least one SiteSync interface accessory SWUSB or SWTAB. Each option contains SiteSync™ License, GUI, and Bridge Node.
¹⁷ Consult factory for custom color, marine and corrosive finish options.
¹⁸ Turtle Friendly.
¹⁹ Please see Delivered Lumens chart on Page 5 for lumen
²⁰ Microsoft, Encarta, MSN, and Windows are either registered trademarks or trademarks of Microsoft Corporation in the United States and/or other countries.
²¹ Not available with 24L-65 and the 56L-140 configuration of the LED Engine
²² IK10 rated. Consult factory for details
²³ IK08 rated. Consult factory for details
²⁴ Must order with Flush Mount "FM" mounting option and correct pole diameter.
²⁵ Not available with Solo Arm Post Top (FMSA/PTSA)

ordering information

UR20 | arm mount edge-lit

UR20 | post top/solo arm edge-lit

1. SERIES 2. LED ENGINE 3. CCT 4. DISTRIBUTION 5. ROTATION 6. VOLTAGE

1. SERIES	2. LED ENGINE	3. CCT	4. DISTRIBUTION	5. ROTATION	6. VOLTAGE
Ouro	Type 2M and 3	3K7 3000K, 70 CRI	2M ⁵ Type II Medium	(Blank) No Rotation	UNV 120-277V
UR20 Edge-Lit	96L-30 3,000 lm	3K8 3000K, 80 CRI	3 ⁵ Type III Short		347 347V
	96L-50 5,000 lm	3K9 3000K, 90 CRI	5W ⁶ Type V Wide		480 480V
	96L-70 7,000 lm	4K7 4000K, 70 CRI			
	96L-90 9,000 lm	4K8 4000K, 80 CRI			
	96L-135 12,000 lm	5K7 5000K, 70 CRI			
	Type 5W	Consult factory for other CCTs and CRIs			
	192L-30 3,000 lm				
	192L-45 5,000 lm				
	192L-60 7,000 lm				
	192L-75 9,000 lm				
	192L-110 12,000 lm				
	192L-135 15,000 lm				

1. SERIES 2. LED ENGINE 3. CCT 4. DISTRIBUTION 5. ROTATION 6. VOLTAGE

1. SERIES	2. LED ENGINE	3. CCT	4. DISTRIBUTION	5. ROTATION	6. VOLTAGE
Ouro	Type 2M and 3	3K7 3000K, 70 CRI	2M ⁵ Type II Medium	(Blank) No Rotation	UNV 120-277V
UR20 Edge-Lit	96L-30 3,000 lm	3K8 3000K, 80 CRI	3 ⁵ Type III Short		347 347V
	96L-50 5,000 lm	3K9 3000K, 90 CRI	5W ⁶ Type V Wide		480 480V
	96L-70 7,000 lm	4K7 4000K, 70 CRI			
	96L-90 9,000 lm	4K8 4000K, 80 CRI			
	96L-135 12,000 lm	5K7 5000K, 70 CRI			
	Type 5W	Consult factory for other CCTs and CRIs			
	192L-30 3,000 lm				
	192L-45 5,000 lm				
	192L-60 7,000 lm				
	192L-75 9,000 lm				
	192L-110 12,000 lm				
	192L-135 15,000 lm				

7. MOUNTING 8. FINISH 9. CONTROL OPTIONS

7. MOUNTING	8. FINISH	9. CONTROL OPTIONS
Arm Mount	BLS Black Gloss Smooth	7PR-TL 7 pin PCR with twist lock photocontrol
ASQ Arm Square pole	BLT Black Matte Textured	7PR-SC 7 pin PCR with shorting cap
A34 Arm mt 3.3-4.2" OD pole	DBS Dark Bronze Gloss Smooth	7PR 7 pin PCR, wireless control enabled
A46 Arm mt 4.5-6.0" OD pole	DBT Dark Bronze Matte Textured	AD-01 ² AstroDIM: 50% output at midnight ³
MAF Horizontal Slip Fitter 2 3/8" OD arm	GTT Graphite Matte Textured	AD-02 ² AstroDIM: 50% output midnight to 4 AM ³
SVSF Square Vertical Slipfitter for 2" Tenon (2-3/8" OD)	LGS Light Grey Gloss Smooth	AD-03 ² AstroDIM: 50% output 10PM ³
VSF Round Vertical Slipfitter for 2" Tenon (2-3/8" OD)	LGT Light Grey Matte Textured	AD-04 ² AstroDIM: 50% output 10PM to 4AM ³
WB Wall Bracket	PSS Platinum Silver Gloss Smooth	NXWE ⁸ NX Networked Wireless Radio Module, without Sensor ⁸
	VGT Verde Green Matte Textured	WSP-40F Dimming Occ. Sensor for up to 40' MH, 120-480V
	WHS White Gloss Smooth	
	WHT White Matte Textured	
	Color Option	
	CC Custom Color ¹	

7. MOUNTING 8. FINISH 9. CONTROL OPTIONS

7. MOUNTING	8. FINISH	9. CONTROL OPTIONS
Post Top	BLS Black Gloss Smooth	7PR-TL 7 pin PCR with twist lock photocontrol
FM33 Flush mt 3.0" OD pole, 3" fixture base	BLT Black Matte Textured	7PR-SC 7 pin PCR with shorting cap
FM44 Flush mt 3.6" to 4.0" OD pole, 4" fixture base	DBS Dark Bronze Gloss Smooth	7PR 7 pin PCR, wireless control enabled
PT23 3" Post Top mount for 2 3/8" OD Tenon	DBT Dark Bronze Matte Textured	AD-01 ² AstroDIM: 50% output at midnight ³
PT24 4" Post Top mount for 2 3/8" OD Tenon	GTT Graphite Matte Textured	AD-02 ² AstroDIM: 50% output midnight to 4 AM ³
PT34 4" Post Top mount for 2 7/8" OD Tenon	LGS Light Grey Gloss Smooth	AD-03 ² AstroDIM: 50% output 10PM ³
	LGT Light Grey Matte Textured	AD-04 ² AstroDIM: 50% output 10PM to 4AM ³
	PSS Platinum Silver Gloss Smooth	NXWE ⁸ NX Networked Wireless Radio Module, without Sensor ⁸
	VGT Verde Green Matte Textured	WSP-40F Dimming Occ. Sensor for up to 40' MH, 120-480V
	WHS White Gloss Smooth	
	WHT White Matte Textured	
	Color Option	
	CC Custom Color ¹	

10. OPTIONS 11. CONTROL ACCESSORIES

10. OPTIONS	11. CONTROL ACCESSORIES
SF Single Fuse	WIR-RME-L wiSCAPE™ External Fixture Module
DF Double Fuse	NXOFM1R1D-UNV NX 7-Pin Twist-Lock® with NX Networked Wireless Radio, Integral Automatic Dimming Photocell, Integral Single Pole Relay with Dimming, and Bluetooth Programming
TPL Clear Lens	
WBFM3 ⁷ Tamper proof latch	
WBFM4 ⁷ Terminal Block	
TAFM3 ⁹ Clear Lens	
TAFM4 ⁹ Diffuse Lens	

¹ Consult factory for custom color, marine and corrosive finish options
² Not available with other sensor or wireless control options.
³ Specify group and zone at time of order. See www.hubbellighting.com/sitesync for more details. Order at least one SiteSync interface accessory SWUSB or SWTAB. Each option contains SiteSync License, GUI, and Bridge Node.

⁴ Not available with 347V and 480V.
⁵ Only available with 96L.
⁶ Only available with 192L.
⁷ Must order with Flush Mount "FM" mounting option and correct pole diameter.
⁸ Not available with Solo Arm Post Top (FMSA/PTSA)

10. OPTIONS 11. CONTROL ACCESSORIES

10. OPTIONS	11. CONTROL ACCESSORIES
SF Single Fuse	WIR-RME-L wiSCAPE™ External Fixture Module
DF Double Fuse	NXOFM1R1D-UNV NX 7-Pin Twist-Lock® with NX Networked Wireless Radio, Integral Automatic Dimming Photocell, Integral Single Pole Relay with Dimming, and Bluetooth Programming
TPL Clear Lens	
WBFM3 ⁷ Tamper proof latch	
WBFM4 ⁷ Terminal Block	
TAFM3 ⁹ Clear Lens	
TAFM4 ⁹ Diffuse Lens	

¹ Consult factory for custom color, marine and corrosive finish options
² Not available with other sensor or wireless control options.
³ Specify group and zone at time of order. See www.hubbellighting.com/sitesync for more details. Order at least one SiteSync interface accessory SWUSB or SWTAB. Each option contains SiteSync License, GUI, and Bridge Node.

⁴ Not available with 347V and 480V.
⁵ Only available with 96L.
⁶ Only available with 192L.
⁷ Must order with Flush Mount "FM" mounting option and correct pole diameter.
⁸ Not available with Solo Arm Post Top (FMSA/PTSA)

ordering information

UR28 | arm mount

UR28 | post top/solo arm

1. SERIES	2. LED ENGINE	3. CCT	4. DISTRIBUTION	5. ROTATION	6. VOLTAGE	7. MOUNTING
UR28 Ouro	No or Clear Lens	AM ¹¹ Amber, 595nm	No Lens or Clear Lens	(Blank) Blank for no rotation	UNV 120-277V	ASQ Arm Square pole
	96L-155 20,000 lm	27K8 2700K, 80 CRI	FR Type I/Front Row	L ¹ Optic rotation left	347 347V	A34 Arm mt 3.3-4.2" OD pole
	96L-170 22,500 lm	3K7 3000K, 70 CRI	2 Type II	R ¹ Optic rotation right	480 480V	A46 Arm mt 4.5-6.0" OD pole
	96L-185 24,000 lm	3K8 3000K, 80 CRI	3 Type III		DALI 120-277V*	MAF Horizontal Slip Fitter 2 3/8" OD arm
	96L-220 27,000 lm	35K8 3500K, 80 CRI	4 Type IV		<i>* Consult factory</i>	SVSF Square Vertical Slipfitter for 2" Tenon (2-3/8" OD)
	96L-255 30,000 lm	3K9 3000K, 90 CRI	4W Type IV Wide			VSF Round Vertical Slipfitter for 2" Tenon (2-3/8" OD)
	96L-315 35,000 lm	4K7 4000K, 70 CRI	5QM Type V Square Medium			WB Wall Bracket
	HDL - High Diffusion Lens*	4K8 4000K, 80 CRI	5QN Type V Square Narrow			
	114L-160 18,000 lm	5K7 5000K, 70 CRI	5R Type V Rectangular			
	114L-180 20,000 lm	<i>Consult factory for other CCTs and CRIs</i>	5W Type V Wide (Round)			
	114L-265 25,000 lm		HDL - High Diffusion Lens			
			3 Type III/Asymmetric			
			5W Type V/Symmetric			

1. SERIES	2. LED ENGINE	3. CCT	4. DISTRIBUTION	5. ROTATION	6. VOLTAGE	7. MOUNTING	8. FINISH
UR28 Ouro	No or Clear Lens	AM ¹¹ Amber, 595nm	No Lens or Clear Lens	(Blank) Blank for no rotation	UNV 120-277V	Post Top	BLS Black Gloss Smooth
	96L-155 20,000 lm	27K8 2700K, 80 CRI	FR Type I/Front Row	L ¹ Optic rotation left	347 347V	FM44 Flush mt 3.6" to 4.0" OD pole, 4" fixture base	BLT Black Matte Textured
	96L-170 22,500 lm	3K7 3000K, 70 CRI	2 Type II	R ¹ Optic rotation right	480 480V	FM45 Flush mt 3.6" to 5.0" OD pole, 5" fixture base	DBS Dark Bronze Gloss Smooth
	96L-185 24,000 lm	3K8 3000K, 80 CRI	3 Type III		DALI 120-277V*	PT24 4" Post Top mount for 2 3/8" OD Tenon	DBT Dark Bronze Matte Textured
	96L-220 27,000 lm	35K8 3500K, 80 CRI	4 Type IV		<i>* Consult factory</i>	PT24 4" Post Top mount for 2 3/8" OD Tenon	GTT Graphite Matte Textured
	96L-255 30,000 lm	3K9 3000K, 90 CRI	4W Type IV Wide			PT34 4" Post Top mount for 2 7/8" OD Tenon	LGS Light Grey Gloss Smooth
	96L-315 35,000 lm	4K7 4000K, 70 CRI	5QM Type V Square Medium			PT34 4" Post Top mount for 2 7/8" OD Tenon	LGT Light Grey Matte Textured
	HDL - High Diffusion Lens	4K8 4000K, 80 CRI	5QN Type V Square Narrow			PT25 5" Post Top mount for 2 3/8" OD Tenon	PSS Platinum Silver Gloss Smooth
	114L-160 18,000 lm	5K7 5000K, 70 CRI	5R Type V Rectangular		<i>Consult factory for other CCTs and CRIs</i>	PT25 5" Post Top mount for 2 3/8" OD Tenon	VGT Verde Green Matte Textured
	114L-180 20,000 lm		5W Type V Wide (Round)			PT35 5" Post Top mount for 2 7/8" OD Tenon	WHS White Gloss Smooth
	114L-265 25,000 lm		HDL - High Diffusion Lens				WHT White Matte Textured
			3 Type III/Asymmetric				Color Option
			5W Type V/Symmetric				CC Custom Color ⁷

8. FINISH	9. CONTROL OPTIONS	10. OPTIONS	11. CONTROL ACCESSORIES
BLS Black Gloss Smooth	7PR-TL 7 pin PCR with twist lock photocontrol	BC ⁵ Back-light Control	WIR-RME-L wiSCAPE External Fixture Module
BLT Black Matte Textured	7PR-SC 7 pin PCR with shorting cap	SF Single Fuse	SCH-R Occ. Sensor for Round Pole (16" to 30" MH)
DBS Dark Bronze Gloss Smooth	7PR 7 pin PCR, wireless control enabled	DF Double Fuse	SCH-S Occ. Sensor for Square Pole (16" to 30" MH)
DBT Dark Bronze Matte Textured	AD-01 ¹ AstroDIM: 50% output at midnight	TB Terminal Block	NXOFM-1R1D-UNV NX 7-Pin Twist-Lock® with NX Networked Wireless Radio, Integral Automatic Dimming Photocell and Bluetooth Programming
GTT Graphite Matte Textured	AD-02 ² AstroDIM: 50% output midnight to 4 AM	CLR ^{5,6,13} Clear Lens	
LGS Light Grey Gloss Smooth	AD-03 ³ AstroDIM: 50% output 10PM	TPL Tamper proof latch	
LGT Light Grey Matte Textured	AD-04 ⁴ AstroDIM: 50% output 10PM to 4AM	Cps ^{5,6,12} Clear polycarbonate lens	
PSS Platinum Silver Gloss Smooth	NXWE ¹⁵ NX Networked Wireless Radio Module, without Sensor		
VGT Verde Green Matte Textured	WSP-40F-1 ^{2,5} Dimming Occ. Sensor for up to 40' MH, 120/277/347V		
WHS White Gloss Smooth			
WHT White Matte Textured			
Color Option			
CC Custom Color ¹			

9. CONTROL OPTIONS	10. OPTIONS	11. CONTROL ACCESSORIES
7PR-TL 7 pin PCR with twist lock photocontrol	BC ⁵ Back-light Control	WIR-RME-L wiSCAPE External Fixture Module
7PR-SC 7 pin PCR with shorting cap	SF Single Fuse	SCH-R Occ. Sensor for Round Pole (16" to 30" MH)
7PR 7 pin PCR, wireless control enabled	DF Double Fuse	SCH-S Occ. Sensor for Square Pole (16" to 30" MH)
AD-01 ¹ AstroDIM: 50% output at midnight	CLR ^{5,6,13} Clear Lens	NXOFM-1R1D-UNV NX 7-Pin Twist-Lock® with NX Networked Wireless Radio, Integral Automatic Dimming Photocell and Bluetooth Programming
AD-02 ² AstroDIM: 50% output midnight to 4 AM	TPL Tamper proof latch	
AD-03 ³ AstroDIM: 50% output 10PM	Cps ^{5,6,12} Clear polycarbonate lens	
AD-04 ⁴ AstroDIM: 50% output 10PM to 4AM		
NXWE ¹⁵ NX Networked Wireless Radio Module, without Sensor		
WSP-40F-1 ^{2,5} Dimming Occ. Sensor for up to 40' MH, 120/277/347V		

¹ Not available with 5QM, 5QN, and 5W distributions.
² Not available with other sensor or wireless control options.
³ Specify group and zone at time of order. See www.hubbellighting.com/sitesync for more details. Order at least one SiteSync interface accessory SWUSB or SWTAB. Each option contains SiteSync™ License, GUI, and Bridge Node.
⁴ Not available with 347V and 480V.
⁵ 96L only.
⁶ Not available with HDL option.
⁷ Consult factory for custom color, marine and corrosive finish options.
⁸ Turtle Friendly.
⁹ Please see Delivered Lumens chart on Page 5 for lumen
¹⁰ Microsoft, Encarta, MSN, and Windows are either registered trademarks or trademarks of Microsoft Corporation in the United States and/or other countries.
¹¹ Not available with 96L-255 and the 96L-315 configuration of the LED Engine
¹² IK10 rated. Consult factory for details
¹³ IK08 rated. Consult factory for details

Current

Current Lighting Solutions, LLC

701 Millennium Blvd.
Greenville, SC 29607

currentlighting.com/kimlighting

© 2022 HLI Solutions, Inc. All rights reserved. Information and specifications subject to change without notice.
All values are design or typical values when measured under laboratory conditions.

Rev 06/22/22

kim_ur_lit_R03
