

LG-D (15/16") CROSS SECTION

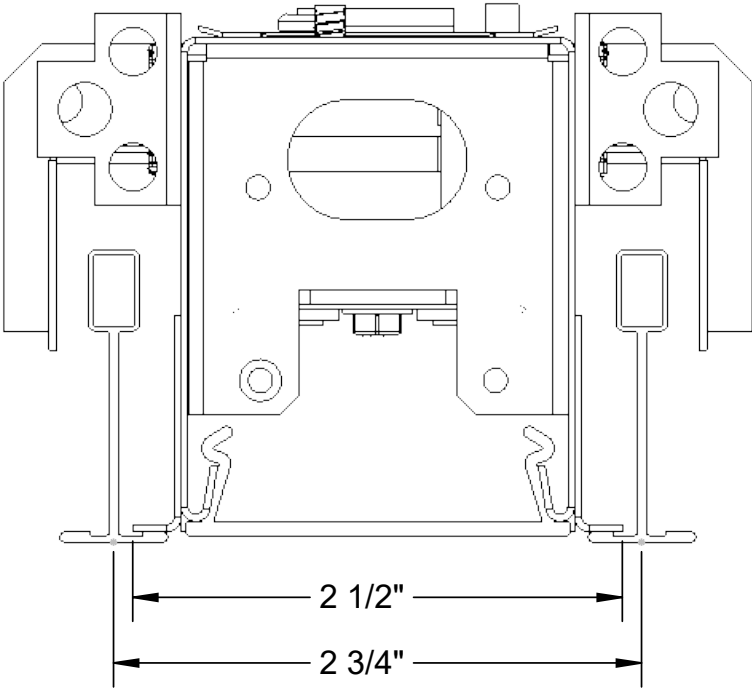

NG-D (9/16") CROSS SECTION

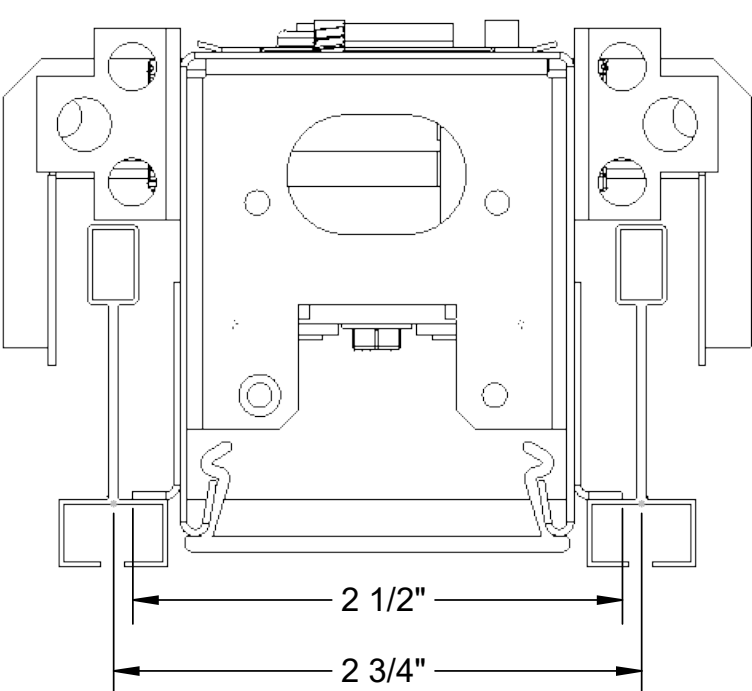

SS-D (SCREWSLOT) CROSS SECTION

- GENERAL NOTES:
- 1. LEAVE PROTECTIVE WRAPPING MATERIAL ON FIXTURE UNTIL FIXTURES ARE MOUNTED. THIS WILL PROTECT FINISH FROM DAMAGE
 - 2. REFER TO SUPPLEMENTAL WIRING INSTRUCTION SHEET 510401 FOR MAKING WIRING CONNECTIONS.
 - 3. ALL CEILING T-BARS MUST BE INSTALLED BEFORE FIXTURES ARE MOUNTED IN CEILING

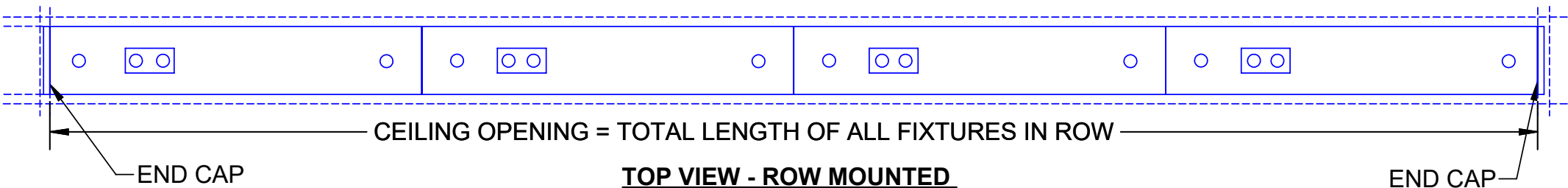

TOP VIEW - ROW MOUNTED RECESSED FIXTURE

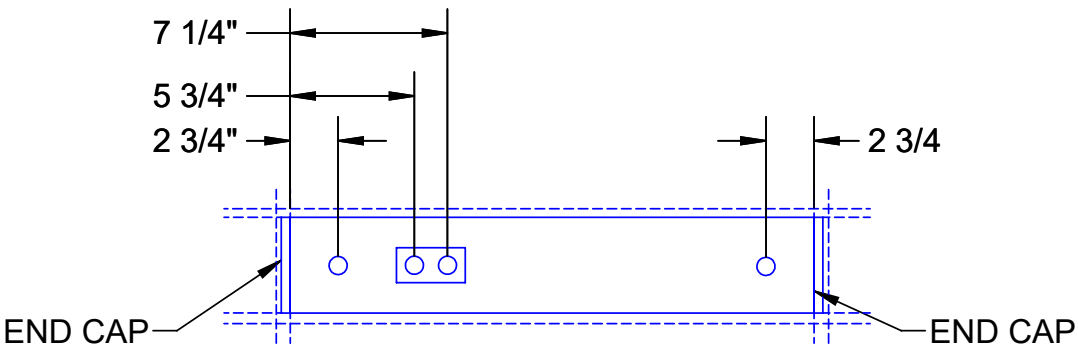

TOP VIEW - INDIVIDUALLY MOUNTED RECESSED FIXTURE

NOTE:
INDIVIDUAL UNITS CANNOT BE JOINED IN FIELD TO CREATE RUNS.

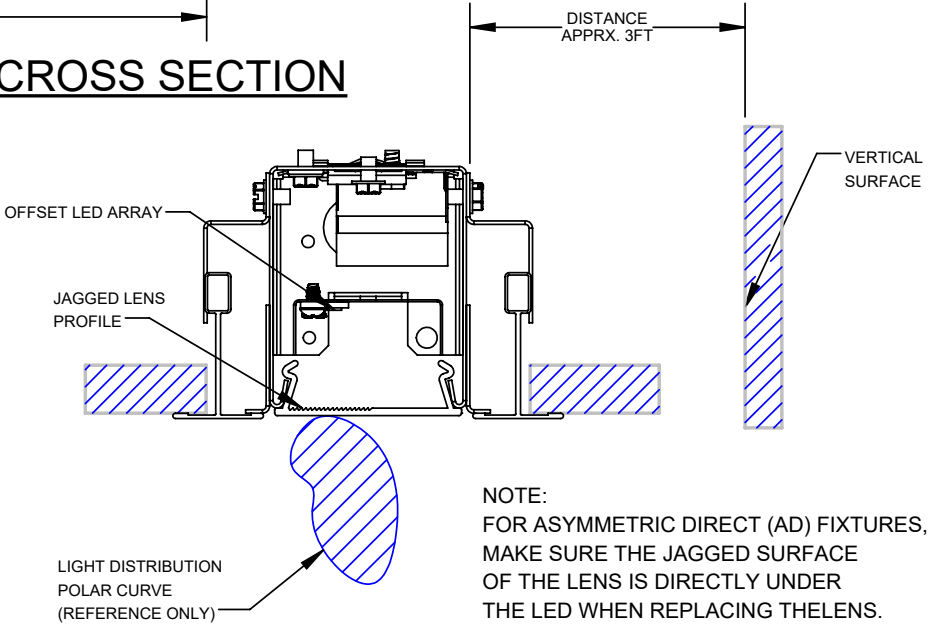

NOTE:
FOR ASYMMETRIC DIRECT (AD) FIXTURES, MAKE SURE THE JAGGED SURFACE OF THE LENS IS DIRECTLY UNDER THE LED WHEN REPLACING THE LENS.

TOOLS REQUIRED

SCREWDRIVER OR 1/4" HEX DRIVER/SOCKET
7/16" HEX DRIVER/SOCKET

SUPPLIED BY INSTALLER

SUPPORT WIRE/CHAIN

2

IF INSTALLING INDIVIDUAL FIXTURE, SKIP TO STEP 3

SOME COMPONENTS HIDDEN FOR CLAIRTY

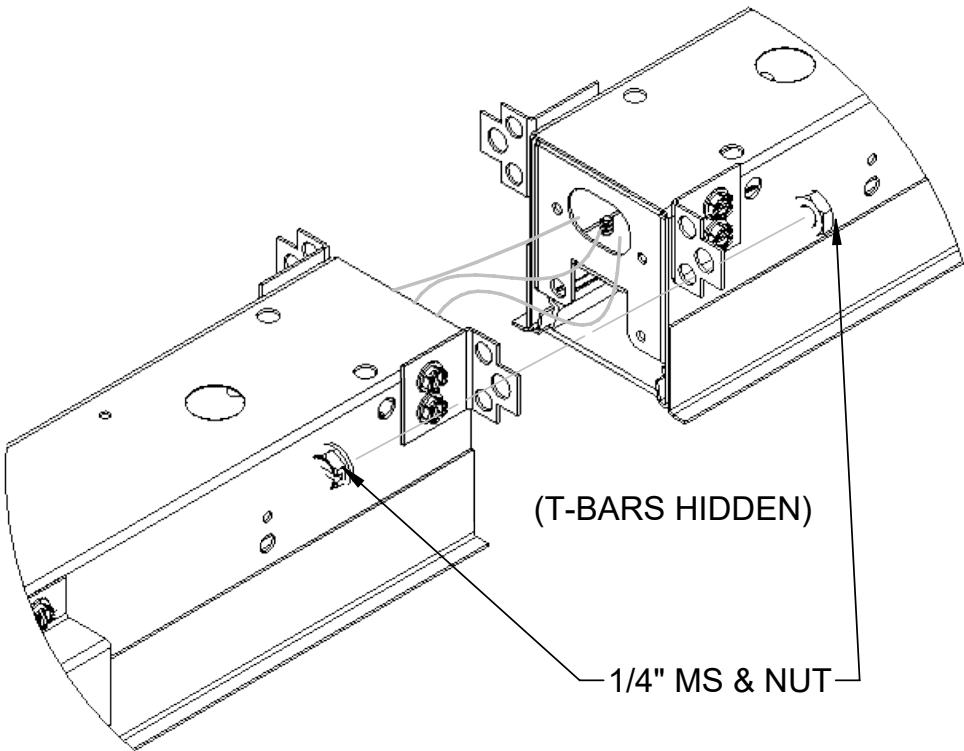

LIFT AND INSTALL NEXT FIXTURE IN ROW PER STEPS 1 - 2. LOOSELY BOLT FIXTURES TOGETHER USING (2) 1/4-20 X 3/8" LONG MACHINE SCREWS AND NUTS. ROUTE FIXTURE WIRING THROUGH .625 X .938 OBOURND SLOT HOLES IN END HEADERS. LEVEL AND ALIGN FIXTURES BEFORE TIGHTENING FASTENERS. REPEAT PROCEDURE FOR EACH ADDITIONAL FIXTURE.

1

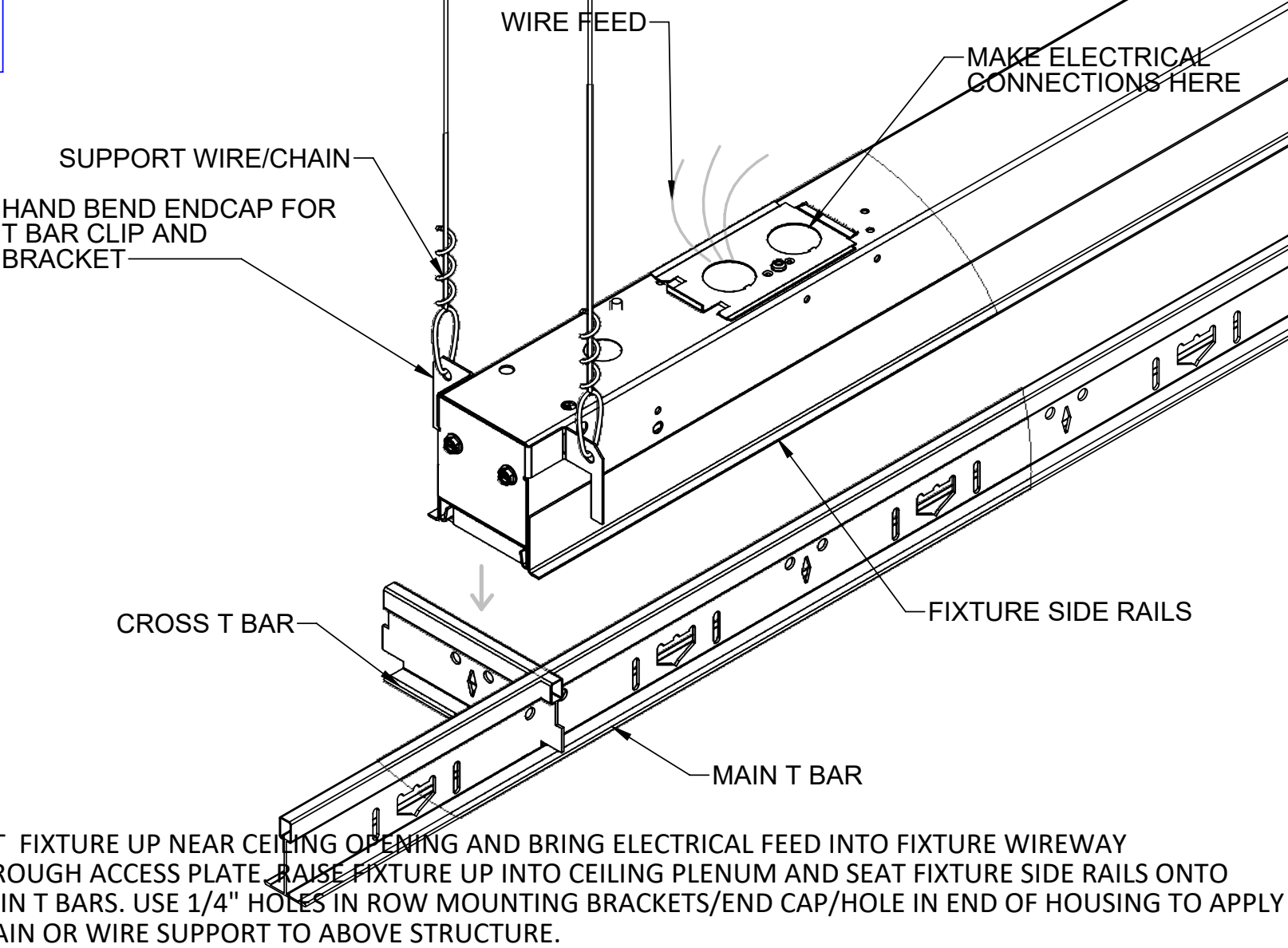

3

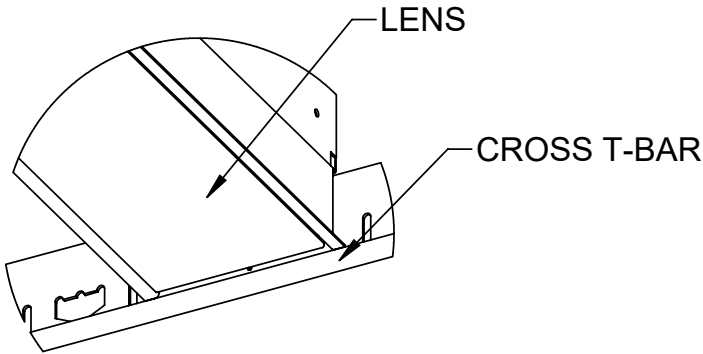

LENS WILL FIT IN FRONT OF CROSS T-BAR

4

LENS REMOVAL

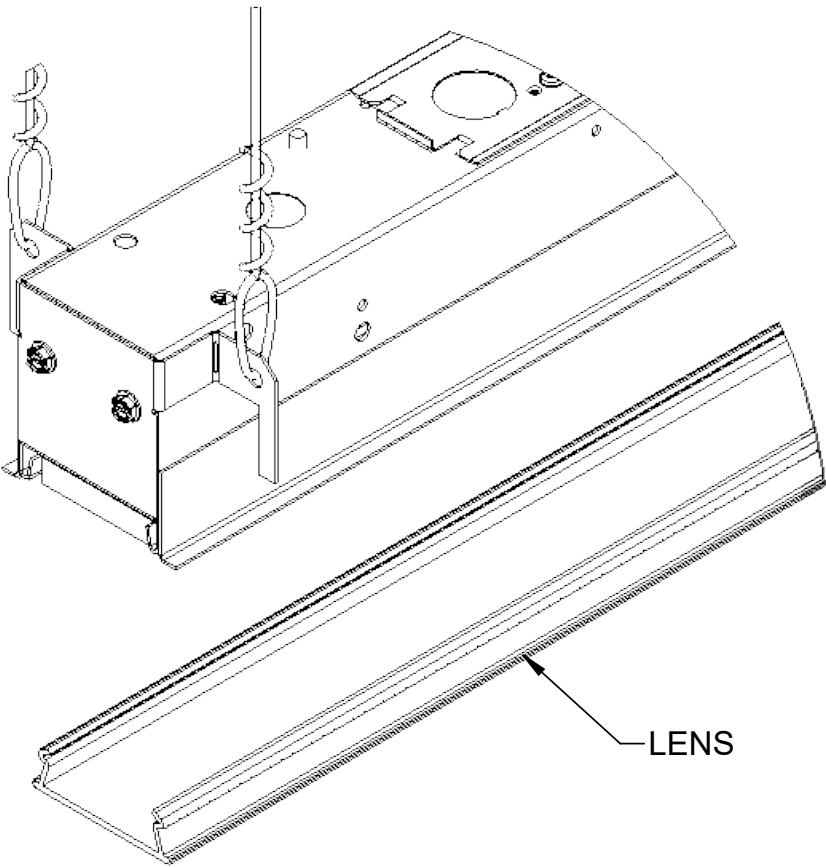

TO REMOVE LENS INSERT SCREWDRIVER OR FLAT HEAD PRY TOOL INTO THE END OF THE HOUSING AND PULL DOWN.

5

ACCESS COVER REMOVAL

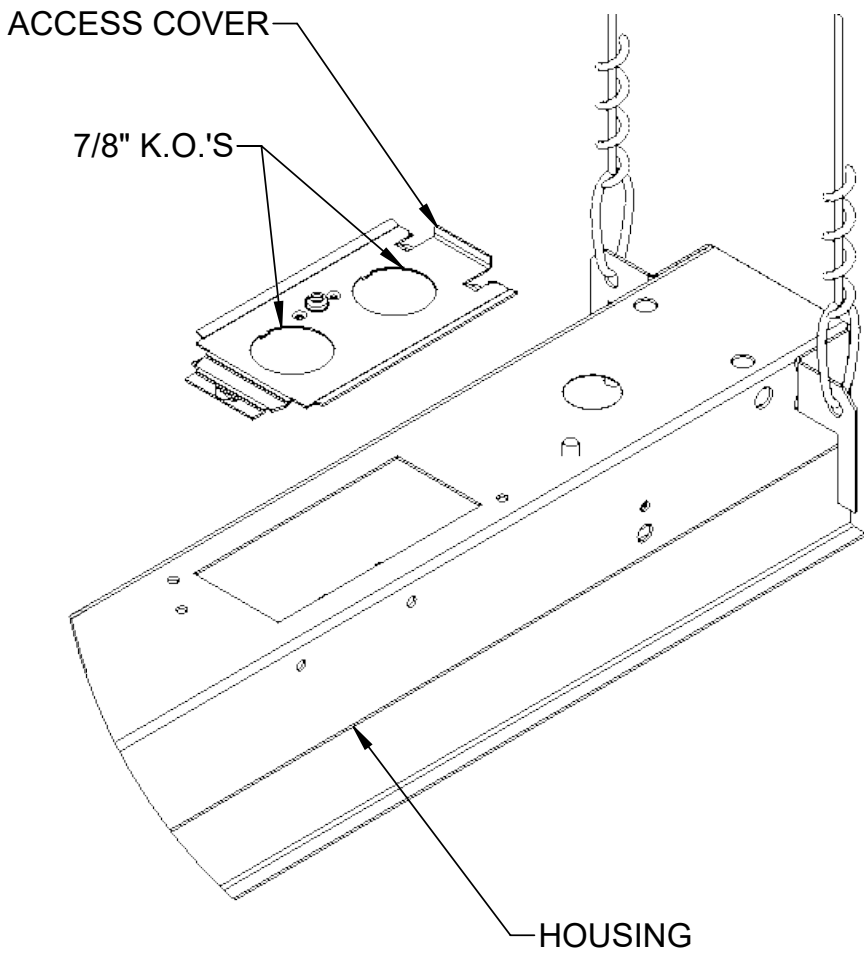

REMOVE ACCESS COVER FROM FIXTURE HOUSING BY SLIDING THE COVER AND SHIFTING IT OUT. REMOVE 7/8" KNOCK-OUT AT DESIRED FEED LOCATION.

6

END CAP REMOVAL

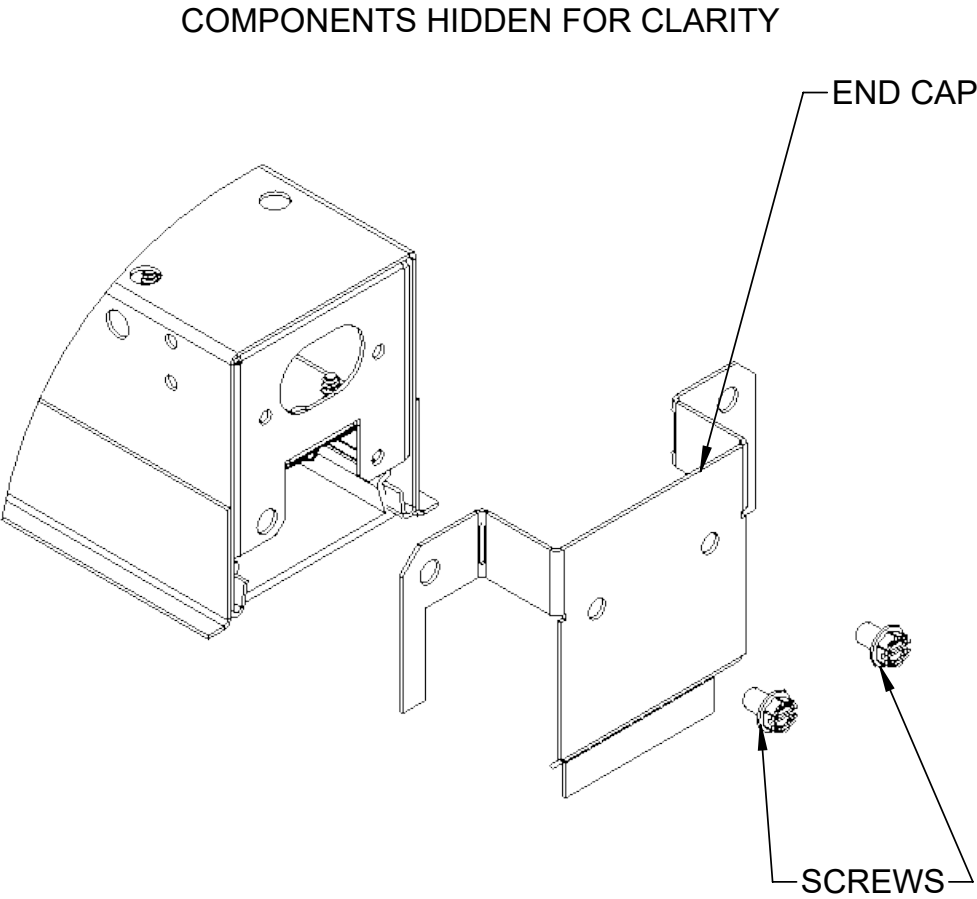

REMOVE THE END CAP BY REMOVING (2) #8 SCREWS AS SHOWN. FOR INDIVIDUAL FIXTURE, DO SO AT BOTH ENDS. FOR ROW, DO SO AT NEAR END OF 1ST FIXTURE AND FAR END OF LAST FIXTURE.

7

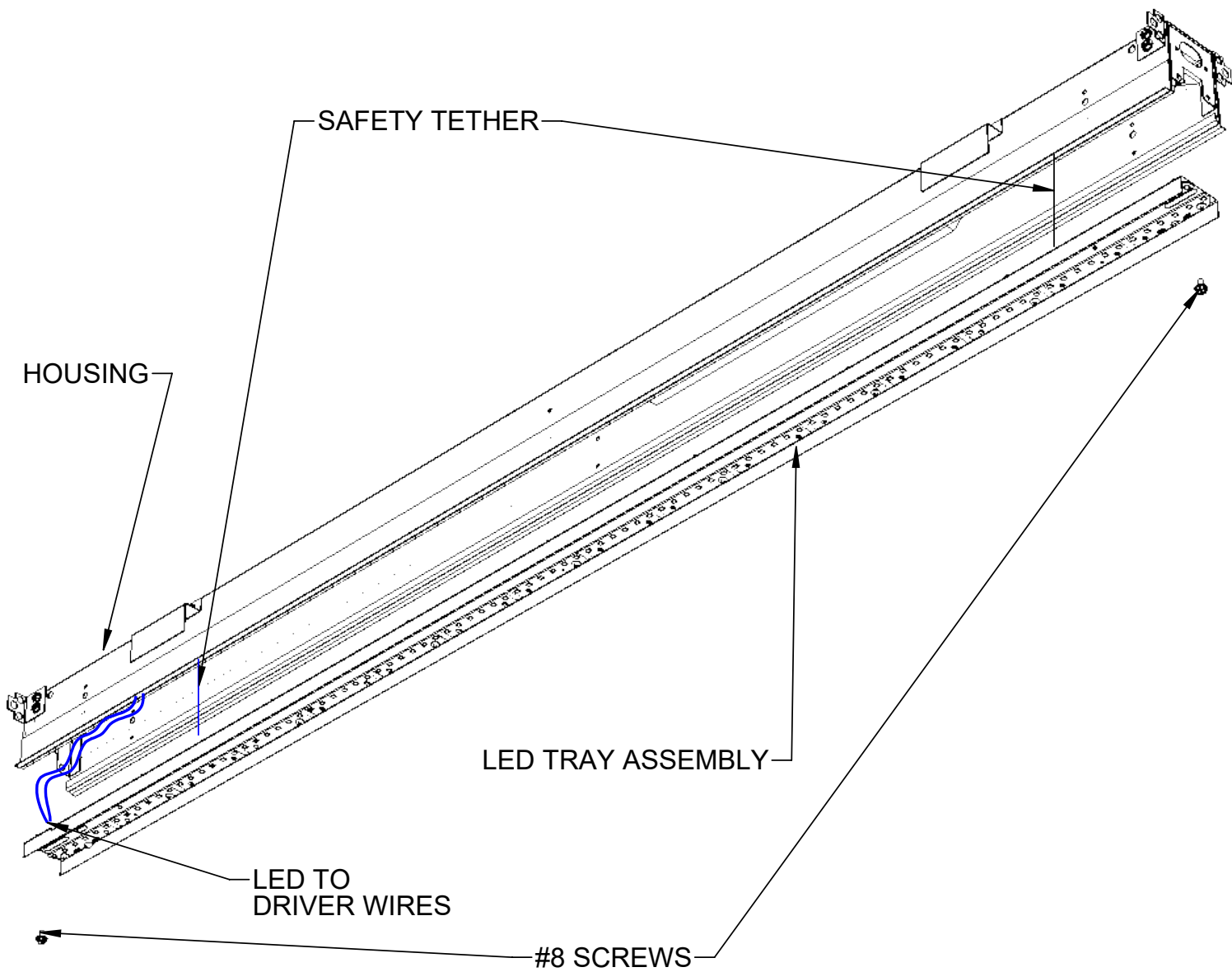

BEFORE REMOVING LED TRAY ASSEMBLY SEE STEP 4 FOR LENS REMOVAL. TO REMOVE LED TRAY ASSEMBLY:
REMOVE THE (2) #8 SHEET METALS SCREWS AS SHOWN.
DISCONNECT WIRE NUTS THAT CONNECT LED WIRES TO DRIVER.
DISCONNECT SAFETY TETHERS CONNECTED TO THE LED TRAY
TO FULLY REMOVE THE LED TRAY ASSEMBLY FROM HOUSING.
(TO REPLACE LED TRAY ASSEMBLY REPEAT THE ABOVE STEPS IN REVERSE)

8

DRIVER REMOVAL

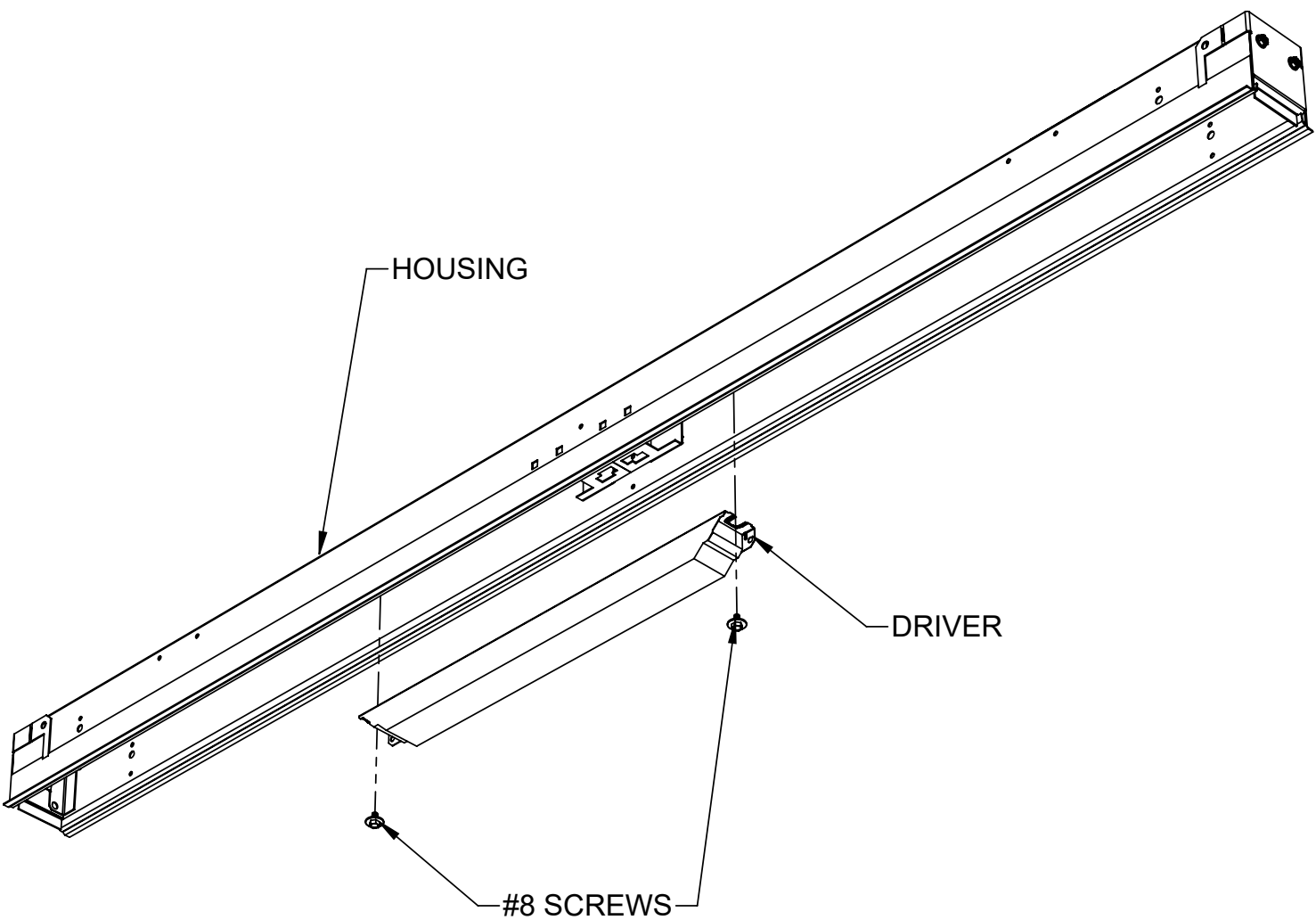

LED TRAY ASSEMBLY REMOVAL

BEFORE REMOVING DRIVER SEE STEPS 4 AND 7 FOR LENS AND LED TRAY REMOVAL.
REMOVE THE (2) #8 SHEET METAL SCREWS AS SHOWN AND REMOVE DRIVER.
(TO REPLACE LED TRAY ASSEMBLY REPEAT THE ABOVE STEPS IN REVERSE)