

⚠ WARNING: Fixtures must be grounded in accordance with local codes or the National Electrical Code. Failure to do so may result in serious personal injury.

All electrical work must be done by a qualified electrician.

KEEP THIS SHEET FOR FUTURE REFERENCE.

Tools Required: Flat Blade Screwdriver Ratchet with 7/16" Socket

Installation Instructions: **⚠** Make certain the electrical supply is **OFF** before starting fixture installation.

1. Tear rope caulk in half lengthwise and place around top and sides of J-Box. Install wall mounting plate with J-Box screws (by others). Mounting plate will mount to any octagonal or 4" square wall or ceiling mounted J-Box by others.
2. Attach stationary cover and gasket to fixture swivel with two 1/4-20 hex head screws and torque to 10 foot-pounds.
3. Guide fixture and stationary cover over tabs on mounting plate. Install cover mounting screws.
4. Make all wiring connections observing polarity, i.e. green-to-ground, white-to-common, and black-to-voltage.
5. Tuck wires into J-Box and install splice cover.
6. See fixture installation instructions for swivel adjustments.

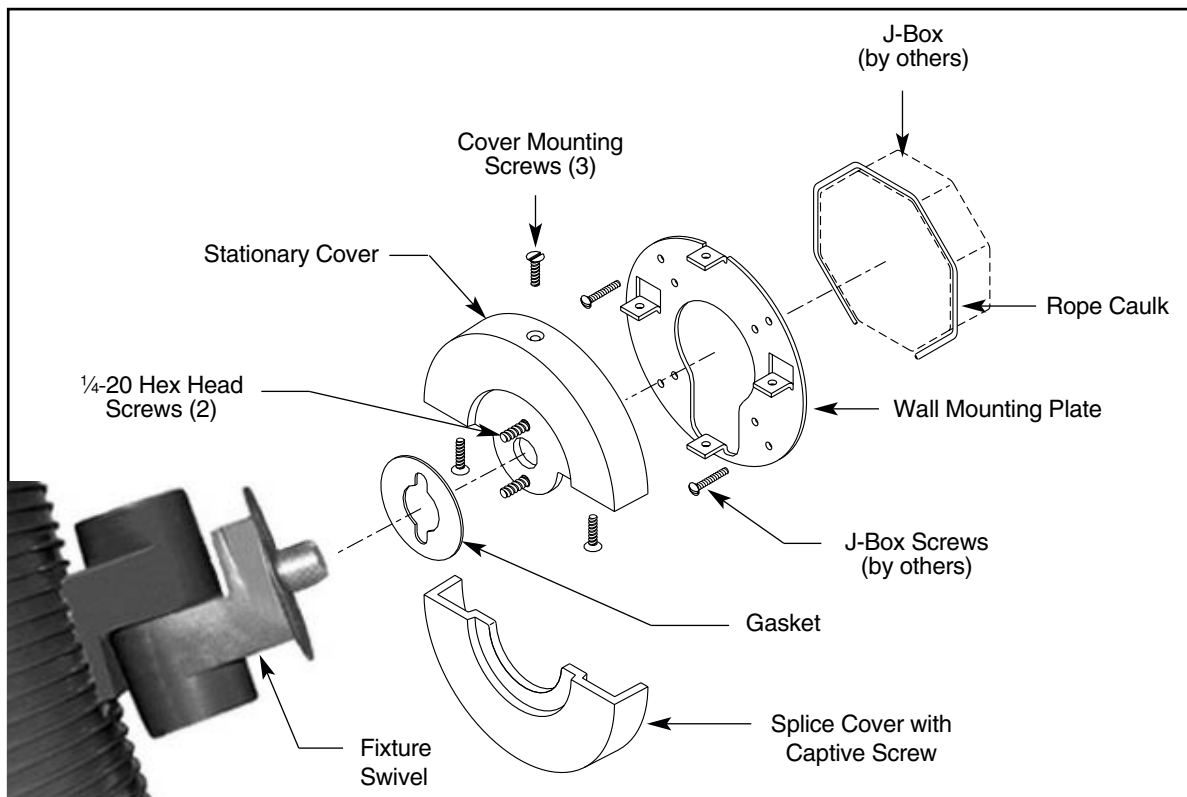

For warranty see: currentlighting.com/kimlighting