

IMPORTANT SAFEGUARDS

READ AND FOLLOW ALL SAFETY INSTRUCTIONS

When using electrical equipment, basic safety precautions should always be followed including the following:

This equipment is designed for use with germicidal UV radiation sources and must be installed in compliance with competent technical directions to prevent risk of personal injury from UV radiation.

UV radiation can pose a risk of personal injury. Overexposure can result in damage to eyes and bare skin. To reduce the risk of overexposure this equipment must be installed in accordance with the manufacturer's site planning recommendations. This may include instructions on the relative location of each germicidal system component, the minimum distances between UV-generating devices and other objects or surfaces, and protection from line-of-sight exposure to UV radiation in occupied spaces located above the equipment mounting area (e.g. upper floor balconies, open staircases, etc.)

UV and optical radiation can be reflected by surrounding surfaces such as ceilings and walls. Since the reflective properties of surfaces can vary widely, it should be considered as part of site planning. Follow the manufacturer's recommendations for selecting appropriate ceiling and wall finishes.

IT IS THE RESPONSIBILITY OF THE INSTALLER TO ENSURE THAT PERSONS WILL NOT BE EXPOSED TO EXCESSIVE UV OR OPTICAL RADIATION DURING EQUIPMENT OPERATION. THIS WILL REQUIRE THE INSTALLER TO CONDUCT AN ASSESSMENT OF IRRADIANCE OR ILLUMINANCE LEVELS IN THE SURROUNDING OCCUPIED SPACES PRIOR TO OCCUPANCY.

Equipment should be mounted in locations and at heights where it will not readily be subjected to tampering by unauthorized personnel.

Maintenance and servicing of this UV generating equipment shall be performed by authorized personnel. Service personnel must wear appropriate Personal Protective Equipment (PPE) if the equipment will be in operation during the maintenance or servicing work. Contact the equipment manufacturer for PPE recommendations and guidance.

The use of accessory equipment not recommended by the manufacturer may cause an unsafe condition.

Do not use this equipment for other than intended use.

Device using Current's 365DisInFx™ technology are not intended to be used as medical devices and are not registered as such under any applicable laws. They provide an added layer of protection along with masks, hygiene, and social distancing.

SAVE THESE INSTRUCTIONS

365DisInFx™ LED Luminaires RVU Recessed Series-UVA



BEFORE YOU BEGIN

Read these instructions completely and carefully.

Save These Instructions

Use only in the manner intended by the manufacturer.

If you have any questions, contact the manufacturer.

Installation and servicing should be performed by qualified personnel.

⚠ WARNING/AVERTISSEMENT

RISK OF ELECTRICAL SHOCK

- Turn power off before inspection, installation or removal.
- Properly ground electrical enclosure.

RISQUE D'ÉLECTROCUTION

- Coupez l'alimentation avant l'inspection, l'installation ou l'enlèvement du produit.
- Assurez-vous de correctement mettre à la terre le boîtier d'alimentation électrique.

⚠ WARNING/AVERTISSEMENT

RISK OF FIRE

- Follow all NEC and local codes.
- Use only UL approved wire for input/output connections. Minimum size 18 AWG (0.75mm²).

RISQUES D'INCENDIE

- Respectez tous les codes NEC et codes locaux.
- N'utilisez que des fils approuvés par UL pour les entrées/sorties de connexion. Taille minimum 18 AWG (0.75mm²).

⚠ CAUTION/ATTENTION

- Retrofit kit may fall down if not installed properly, follow installation instructions.
- L'ensemble de mise à niveau à DEL peut tomber s'il n'est pas installé correctement. Suivre les instructions d'installation.
- This device is not intended for use with Emergency Exits.
- Cet appareil n'est pas conçu pour utilisation avec sortie de secours.

⚠ CAUTION/ATTENTION

- Turn power off prior to installation; risk of UV exposure.
- Coupez l'alimentation avant d'installer; risque d'exposition à un rayonnement UV.
- Wear appropriate Personal Protective Equipment (PPE).
- Portez les équipements de protection individuelle (EPI) appropriés.
- When combining two or more UV solutions, whether from Current and/or other manufacturers, please consult a trained product application representative to ensure the total irradiance (UV dose) does not exceed recommended limits for human exposure to UV per IEC 62471 Photobiological Safety for Lamps and Lamp Systems standard and American Conference of Governmental Industrial Hygienists (ACGIH®) TLVs®. To the extent UV solutions are combined, it may affect the inactivation rates.
- Si vous associez plusieurs solutions UV, qu'elles proviennent de Current et/ou d'autres fabricants, consulter un représentant formé aux applications des produits pour s'assurer que l'irradiance totale (dose UV) ne dépasse pas les limites d'exposition humaine recommandées par la norme CEI 62471 Sécurité Photobiologique des Lampes et des appareils utilisant des lampes et la Conférence Américaine d'Hygiénistes Industriels Gouvernementaux (ACGIH). Dans la mesure où les solutions UV sont associées, cela peut avoir une influence sur les taux d'inactivation.

⚠ CAUTION/ATTENTION

- DO NOT INSTALL THIS EQUIPMENT IN A DWELLING.
- N'INSTALLEZ PAS CET ÉQUIPMENT DANS UN LOGEMENT.
- CAUTION - RISK OF PERSONAL INJURY. DO NOT USE THIS RETROFIT KIT TO CONVERT PORTABLE OR HANDHELD LUMINAIRES.
- ATTENTION - RISQUE DE BLESSURES. N'UTILISEZ PAS CE KIT DE CONVERSION POUR MODIFIER DES LUMINAIRES PORTABLES.

THE RETROFIT KIT IS ACCEPTED AS A COMPONENT OF A LUMINAIRE WHERE THE SUITABILITY OF THE COMBINATION SHALL BE DETERMINED BY AUTHORITIES HAVING JURISDICTION. PRODUCT MUST BE INSTALLED BY A QUALIFIED ELECTRICIAN IN ACCORDANCE WITH THE APPLICABLE AND APPROPRIATE ELECTRICAL CODES. THE INSTALLATION GUIDE DOES NOT SUPERSEDE LOCAL OR NATIONAL REGULATIONS FOR ELECTRICAL INSTALLATIONS.

LE NÉCESSAIRE DE MODERNISATION EST ACCEPTÉ À TITRE DE COMPOSANT D'UN LUMINAIRE LORSQUE LA PERTINENCE DE LA COMBINAISON DOIT ÊTRE DÉTERMINÉE PAR LES AUTORITÉS COMPÉTENTES CE PRODUIT DOIT ÊTRE MIS EN PLACE PAR UN ÉLECTRICIEN QUALIFIÉ CONFORMÉMENT AUX CODES ÉLECTRIQUES APPROPRIÉS APPLICABLES. LE GUIDE D'INSTALLATION NE SUPPLANTE PAS LES RÈGLEMENTS LOCAUX OU NATIONAUX EN MATIÈRE D'INSTALLATIONS ÉLECTRIQUES.

⚠ WARNING/AVERTISSEMENT**RISK OF FIRE OR ELECTRICAL SHOCK**

- Luminaire wiring and electrical parts may be damaged when drilling for installation of LED retrofit kit. Check for enclosed wiring and components.
- LED Retrofit Kit installation requires knowledge of luminaire electrical systems. If not qualified, do not attempt installation. Contact a qualified electrician.
- Install this kit only in luminaires that have the construction features and dimensions shown in the photographs and/or drawings and where the input rating of the retrofit kit does not exceed the input rating of the luminaire.
- To prevent wiring damage or abrasion, do not expose wiring to edges of sheet metal or other sharp objects.
- Do not make or alter any open holes in an enclosure of wiring or electrical components during kit installation.
- Suitable for damp locations.

RISQUE D'ÉLECTROCUTION

- Le câblage du luminaire ainsi que ses composantes électriques peuvent être endommagés lors du perçage requis pour l'installation de l'ensemble de mise à niveau à DEL. Vérifiez le câblage et les composants.
- L'installation de l'ensemble de mise à niveau à DEL requiert des connaissances en système électrique d'éclairage. Si vous n'avez pas les qualifications adéquates, ne procédez pas à l'installation et contactez un électricien qualifié.
- N'installez cet ensemble de mise à niveau à DEL que sur des luminaires ayant une construction et des dimensions indiquées sur les photos et dessins et ce, seulement dans la mesure où les spécifications d'entrées de l'ensemble de mise à niveau à DEL n'excède pas les spécifications d'entrée du Luminaires dans lequel il sera installé.
- Afin de prévenir tout dommage ou abrasion aux fils électriques, évitez que ceux-ci ne viennent en contact avec les bordures métalliques ou d'autres objets pointus.
- Ne laissez aucune ouverture dans le boîtier ou le compartiment où se trouvent les composants électriques.
- Convenient aux emplacements humides.

Components Supplied:

The components have been properly packed to avoid damage during transit. Inspect the components to confirm there is no physical damage. Do not install damaged components.

- (1) RVU Fixture
- (2) RVU Mounting Bracket
- (5) #8 x 1/2" Self-Drilling Screw
- (1) Green Ground Screw, Optional
- (1) Provided Safety Tether

Prepare Electrical Wiring**Electrical Requirements**

- The LED luminaire must be connected to the mains supply according to its ratings on the product label.

**Grounding Instructions**

- The grounding and bonding of the overall system shall be done in accordance with National Electric Code (NEC) and local codes.

For Technical Support, Please Contact:

- By Phone: **1-888-694-3533**
- By Email: **lightingproinfo@currentlighting.com**

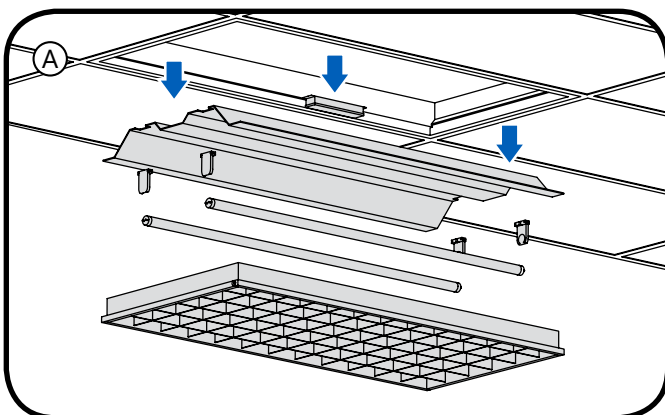
Installation

- A** Prior to the installation, disconnect all incoming power to fixture. Remove existing hardware (lens/lens frame, parabolic louver, reflector/ballast covers, brackets, lamps/ lamp holders). Leave supply and grounding leads.

Note: Follow all federal and local regulations when disposing of lamps and removed components.

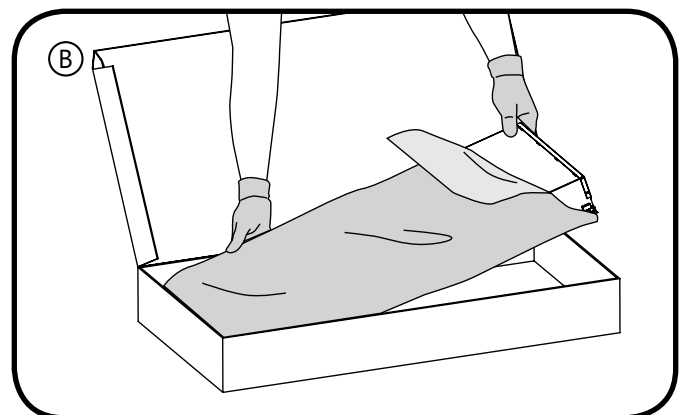

- B** Carefully unpack unit from its packaging. Properly inspect for defects before installing. Wear work gloves to prevent dirt and oil from being transferred to the luminaire.

Installation - Continued

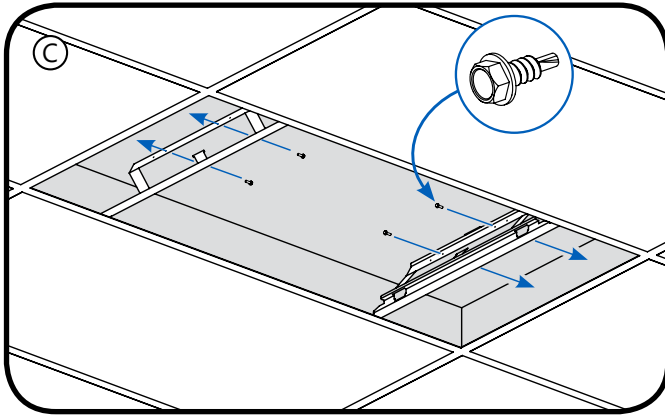

- C** Install RVU Mounting Bracket to each end of the fixture by sliding RVU Mounting Brackets between the fixture and t-grid, ensuring the mounting bracket is centered in the fixture. Secure the RVU Mounting Brackets to the fixture using 4 of the provided #8 x 1/2" self-drilling screws.

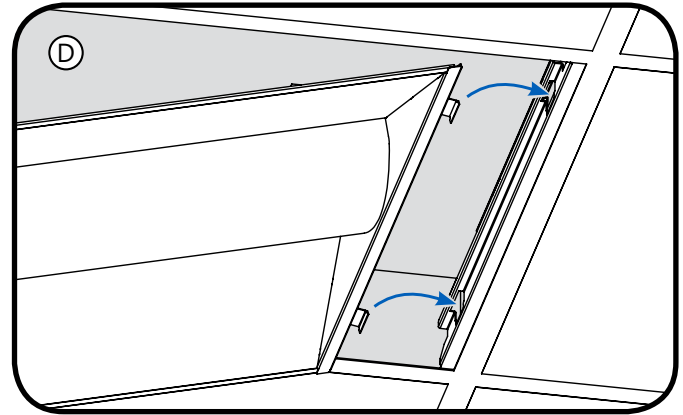

- D** Install the RVU Fixture T-hinges into the RVU Mounting Bracket cutouts

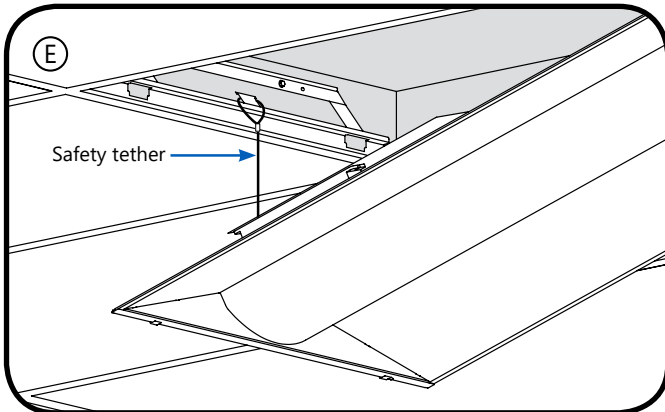

- E** Secure RVU fixture to existing fluorescent fixture using provided safety tether. Ensure safety tether loop is secured around T-shaped tab in RVU Mounting Bracket.

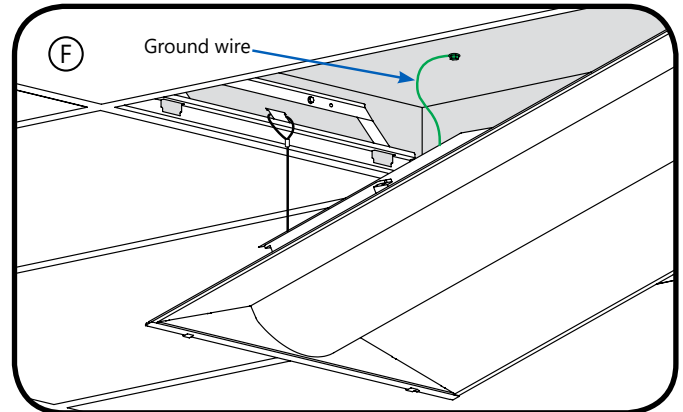

- F** Install grounding wire using provided green ground screw (if existing hole is available) OR #8 x 1/2" self-drilling screw.

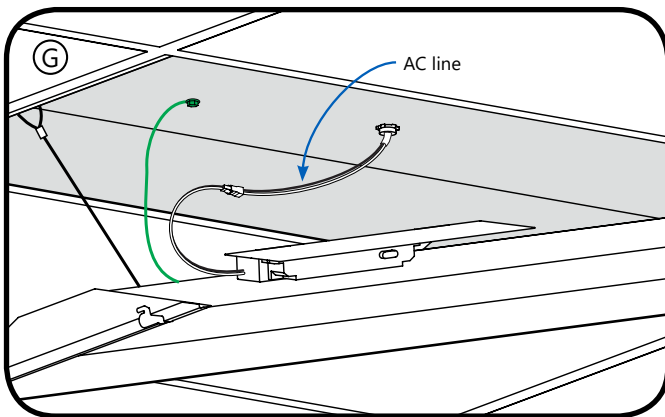

- G** Connect the LED driver to the AC line.

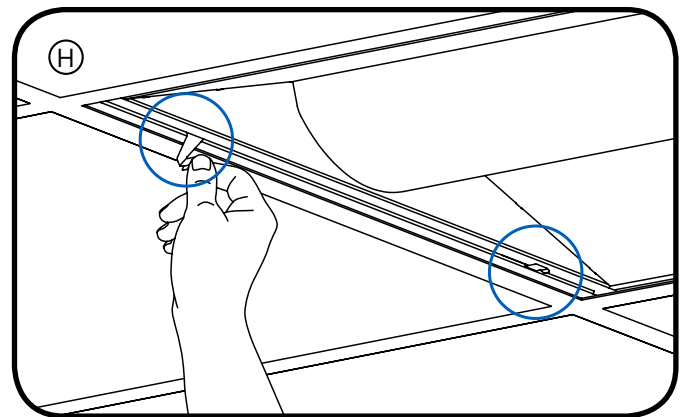

- H** Secure swing door by locking latches found on the end of the assembled RVU Door.

Installation - Continued

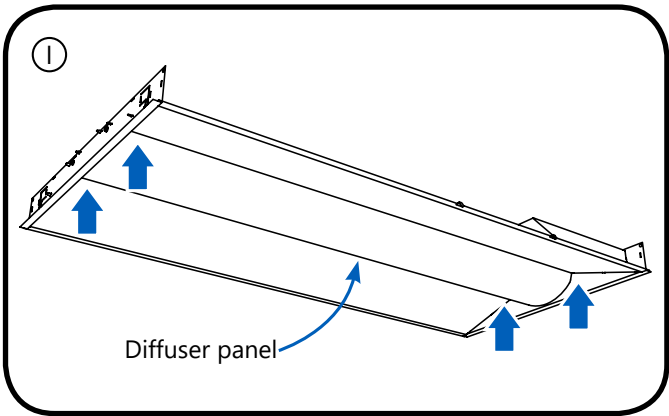

1 Please ensure diffuser is in place and secure, with no gaps between diffuser and housing. LEDs should not be visible. If diffuser is damaged or missing, do not install and please contact the manufacturer for replacement.

Electrical Connections

WARNING/AVERTISSEMENT

RISK OF ELECTRICAL SHOCK

- Disconnect power before servicing or installing product.

RISQUE D'ÉLECTROCUTION

- Couper l'alimentation avant le dépannage ou avant l'installation du produit.

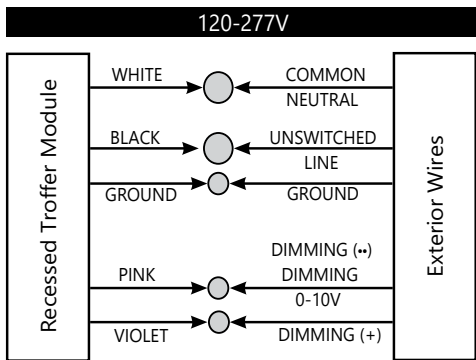

NOTE: Two sets of leads may be provided from the linear fixture labeled with black and white labels corresponding to “UV” and “WHITE” light circuits. These may be connected to the same or separate circuits depending on customer instruction. Dimming is not recommended on the UV circuit as it will reduce the disinfection effectiveness.

BLACK = UV Light Circuit

WHITE = White Light Circuit

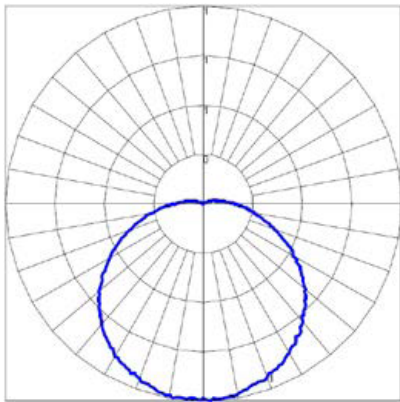

Maximum Candela = 1.159 Located At Horizontal Angle = 85, Verticle Angle = 2
#1 - Vertical Plane Through Horizontal Angles (85 - 265) (Through Max. Cd.)

Make An Informed Decision

1. UV radiation can pose a risk of personal injury. Overexposure can result in damage to eyes and bare skin. To reduce risk of overexposure, equipment must be installed in accordance with manufacturer's site planning and application recommendations, including minimum ceiling height restrictions.
2. UV solutions are intended for common high traffic spaces and not recommended for dwellings or home use.
3. Installation of the devices should be performed by qualified professionals as detailed in Current's installation guide.
4. To allow for occupancy during use, Current products comply with IEC 62471 – Photobiological Safety of Lamps and Lamp Systems standards and American Conference of Governmental Industrial Hygienists (ACGIH®) TLVs® guidelines when installed as directed.
5. Current's UV products are meant to be used in conjunction with other protective measures like manual cleaning and the use of proper PPE. They are not a substitute for other measures.
6. Current products are not intended for use as a medical device.
7. If combining two or more UV solutions, whether from Current and/or other manufacturers, please consult a trained product application representative to ensure the total irradiance (UV dose) does not exceed recommended human exposure limits. To the extent UV solutions are combined, it may impact inactivation rates.

FCC Statements:

This device complies with Part 15 of the FCC Rules. Operation is subject to the following two conditions: (1) This device may not cause harmful interference, and (2) this device must accept any interference received, including interference that may cause undesired operation. CAN ICES-005 (A) / NMB-005 (A)

Note: This equipment has been tested and found to comply with the limits for a Class A digital device, pursuant to part 15 of the FCC Rules. These limits are designed to provide reasonable protection against harmful interference when the equipment is operated in a commercial environment. This equipment generates, uses, and can radiate radio frequency energy and, if not installed and used in accordance with the instruction manual, may cause harmful interference to radio communications. Operation of this equipment in a residential area is likely to cause harmful interference in which case the user will be required to correct the interference at their own expense.

EPA:

EPA Est. 90375-MEX-1

Questions:

Web: LED.com | Phone: 1-888-694-3533

All product and company names are trademarks™ or registered® trademarks of their respective holders. Use of them does not imply any affiliation with or endorsement by them. All specifications are subject to change without notice.

These instructions do not purport to cover all details or variations in equipment nor to provide for every possible contingency to be met in connection with installation, operation or maintenance. Should further information be desired or should particular problems arise which are not covered sufficiently for the purchaser's purposes, the matter should be referred to Current.

Ces instructions ne prétendent pas couvrir tous les détails ou variantes de l'équipement ni couvrir toutes les conditions possibles à satisfaire en rapport avec l'installation, l'opération ou l'entretien. Si des informations supplémentaires sont souhaitées sur des aspects qui ne sont pas suffisamment couverts pour satisfaire les besoins du client, ou si des problèmes particuliers se présentent, veuillez adresser ces questions à Current.