



## Universal / Surface Mount LED Exit Sign AC Only (LUELS Series)



### BEFORE YOU BEGIN

Read these instructions completely and carefully.

When using electrical equipment, basic safety precautions should always be followed including the following.



#### WARNING/AVERTISSEMENT

- Review the diagrams thoroughly before beginning. If you feel you do not have electrical wiring experience, refer to a do-it-yourself wiring handbook or have your fixture installed by a qualified licensed electrician.
- All electrical connections must be in accordance with local codes, ordinances, and the National Electric Code. If you are unfamiliar with methods from installing electrical wiring, secure the services from a qualified licensed electrician.
- Before starting the installation, disconnect the power by turning off the circuit breaker or by removing the appropriate fuse at the fuse box. Using the light switch to turn off power is not sufficient to prevent electrical shock.
- Do not use outdoors
- Do not let power supply cords touch hot surfaces
- Do not mount near gas or electric heaters
- Use caution when servicing batteries. Battery acid can cause burns to skin and eyes. If acid is spilled on skin or eyes, flush acid with fresh water and contact a physician immediately.
- Equipment should be mounted in locations at heights where it will not be subjected to tampering by unauthorized personnel.
- The use of accessory equipment is not recommended by the manufacturer and may cause an unsafe condition.
- Do not use this equipment for other than its intended use.
- All services should be performed by qualified personnel only.

#### INSTALLER:

- See unit label for additional model specifications

#### WARNING:

- This product contains chemicals known to the State of California to cause cancer, birth defects and/or other reproductive harm. Thoroughly wash hands after installing, handling, cleaning, or otherwise touching this product.

## Save These Instructions

Use only in the manner intended by the manufacturer. If you have any questions, contact the manufacturer.

## Components Supplied

- LED Edge-Lit EXIT Sign
- 2 Adjust Bracket and Bar hanger
- Hardware Bag

## Before Installation

### Electrical Connections

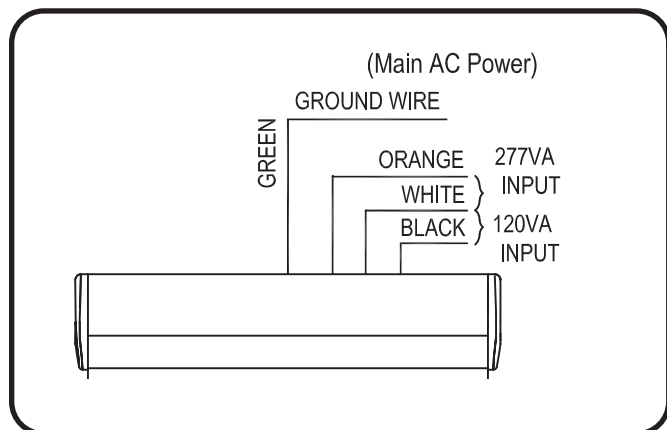

- 1 Make the proper supply wire connections
- 2 If using 120VAC, connect the black and white wires to the building utility.
- 3 If using 277VAC, connect the orange and white wires to the building utility
- 4 Cap off unused wires. In all cases, use standard wire nuts in connection to wires.

## Before Installation

### Determine Directions

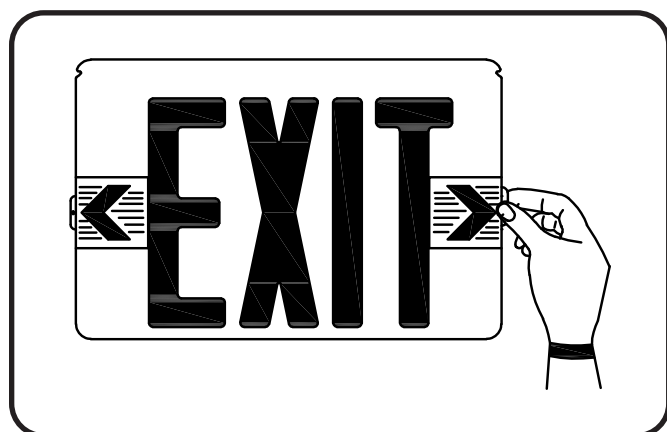

- 1 If indicator is needed, keep indicator and remove instruction film.
- 2 If the indicator is not needed, remove indicator and instruction film together.

NOTICE:  
MUST WEAR GLOVE FOR ALL INSTALLATION PROCESSES

## Installation - Surface, Ceiling &amp; Wall Mounting

NOTE: FIRST TURN OFF ELECTRICITY

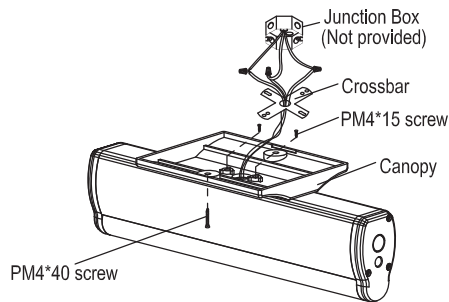

① Attach crossbar to junction box, using screws if needed (Screws are not provided)

② Feed AC supply wires through canopy center hole.

③ Assemble canopy onto main body assembly with (2) PM4\*15 screws (supplied) and make proper wire connections. (See ELECTRICAL CONNECTIONS).

④ Use (2) PM4-40 screws (supplied) tighten canopy to crossbar.

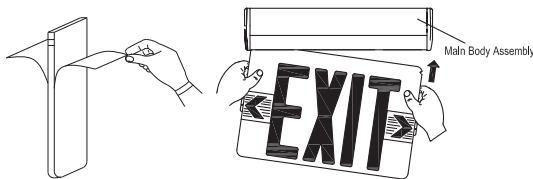

⑤ Peel off protective film from both sides of EXIT panel insert EXIT panel into main body assembly gently. If EXIT panel is for single face, make sure Exit letter direction is correct.

⑥ Determine direction for chevron placement. (See DETERMINE DIRECTION)

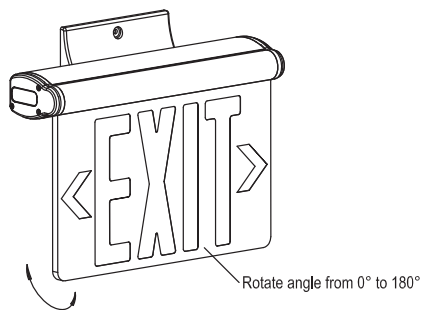

⑦ The unit can be installed on any surface. You may rotate the EXIT panel at any angle from 0° to 180°. For Ceiling mounting rotate 90° become Wall Mounting.

## Installation - Surface End Mounting

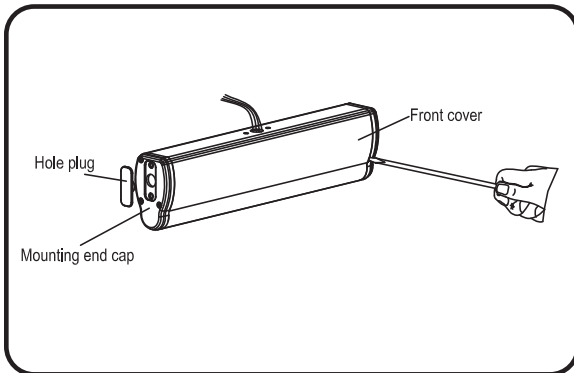

- ① Attach crossbar junction box, using screws if needed. (Screws are not provided)
- ② Use screwdriver to open front cover to remove the hole plug from the slots or mounting end cap.

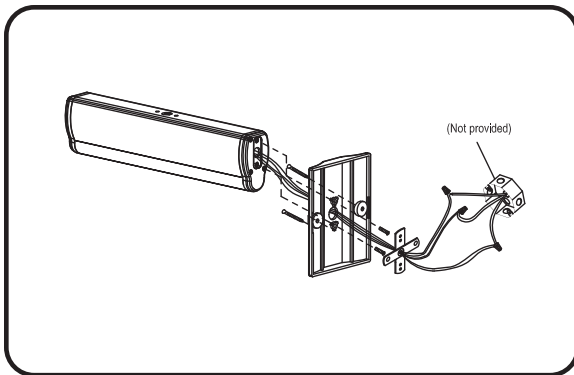

- ③ Pull out all AC supply wires and feed wires thru the center holes of mounting end cap and then canopy.
- ④ Reference 3-6 step in surface, ceiling & wall mounting above for surface end mounting.
- ⑤ The unit can be installed on any surface, you may rotate the EXIT panel in any angle from 0° to 180°.

## Assembly Drawing

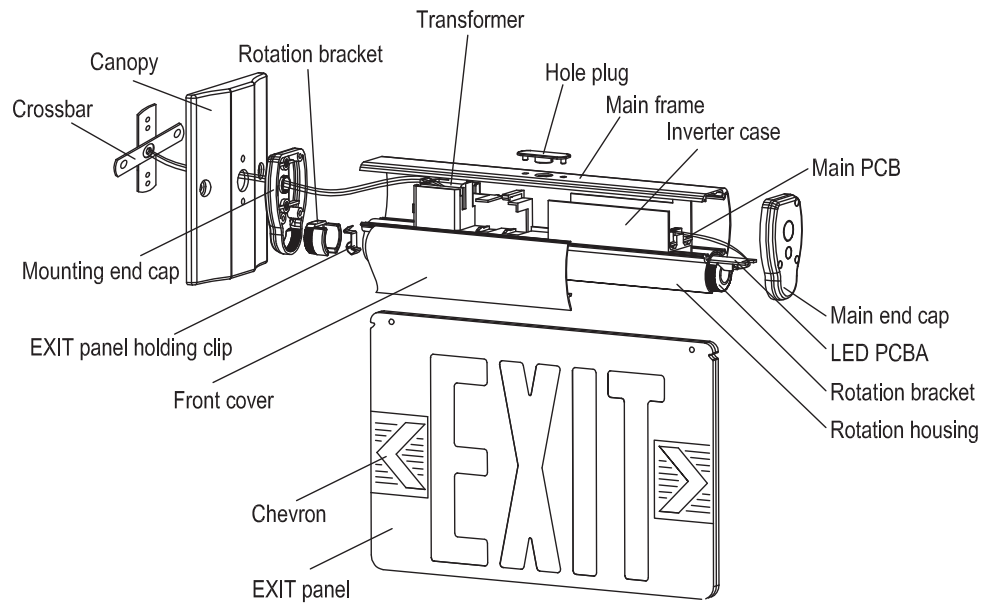
**RECYCLING INFORMATION**

All steel, aluminum, and thermoplastics parts are recyclable. All cartons contain recycled materials. Please recycle responsibly.