

Lumination® Cable Suspension Kit

KitKIT-SUSP-YOKEM-SEMI-XXFT (95046985 / 95046986)



BEFORE YOU BEGIN

Read these instructions completely and carefully.

⚠ WARNING/AVERTISSEMENT

RISK OF ELECTRIC SHOCK

- Turn power off before inspection, installation or removal.
- Properly ground electrical enclosure.

RISK OF FIRE

- Follow all NEC and local codes.

RISQUES DE DÉCHARGES ÉLECTRIQUES

- Coupez l'alimentation avant d'inspecter, installer ou déplacer le luminaire.
- Assurez-vous de correctement mettre à la terre le boîtier d'alimentation électrique.

RISQUES D' INCENDIE

- Respectez tous les codes NEC et codes locaux.

Kit Contains:

1. Suspension cable -10' (2x)
2. Toggled cross-cable (2x)
3. Cross-cable gripper (2x)
4. M6 bolt (2x)
5. 1/4-20 cable coupler (2x)
6. Hourglass sleeve (2x)

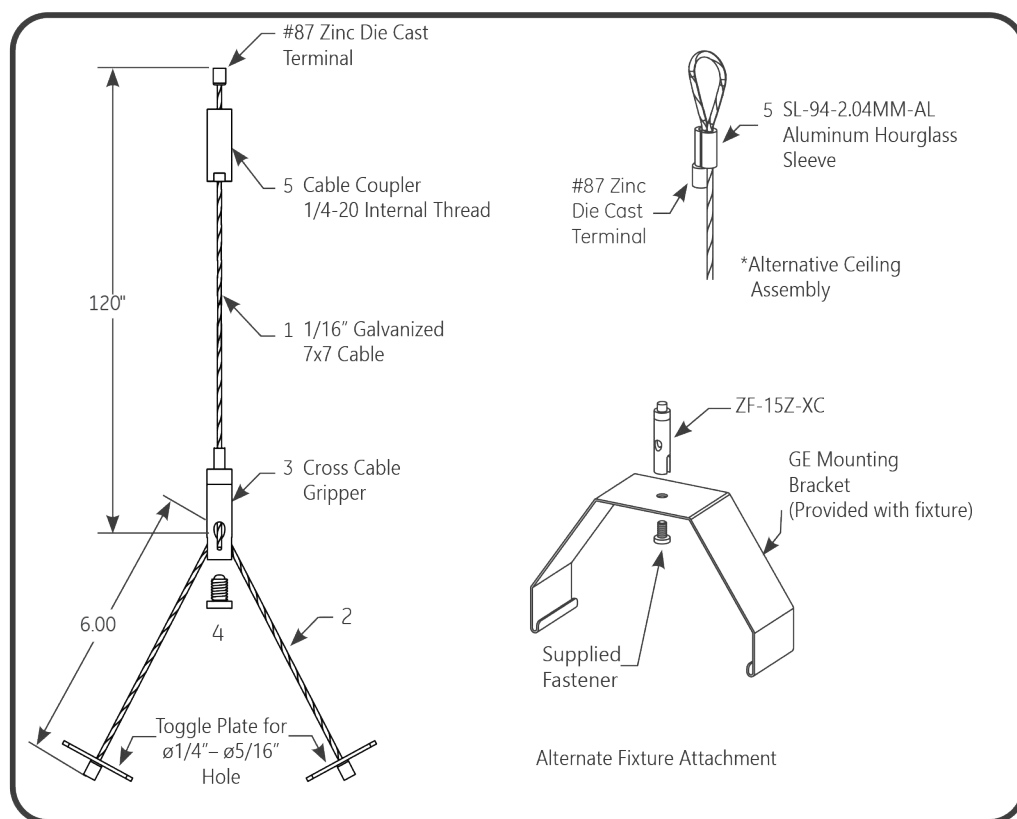

① Connect Gripper To Luminaire Mounting System

The Lower Mounting Kit is designed to connect either directly to a compatible luminaire or to a mounting bracket included with the luminaire and provide leveling through the adjustment of the cable position.

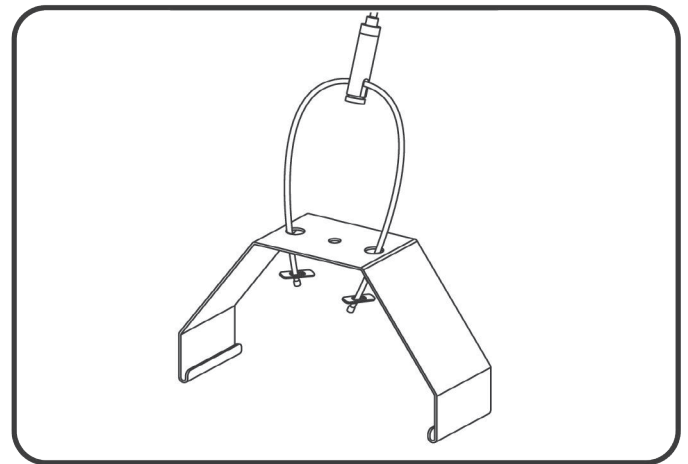
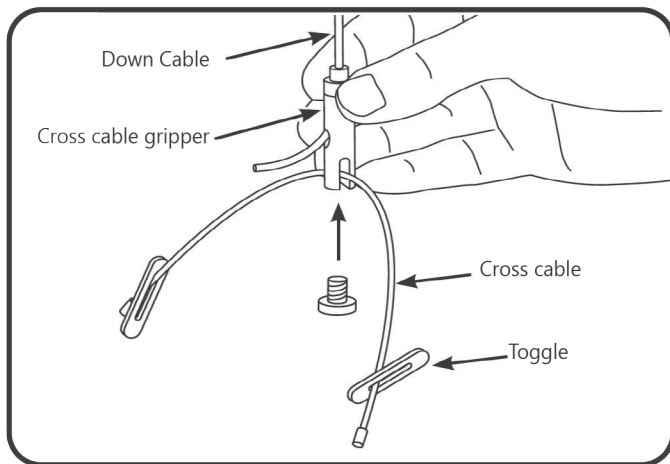

For luminaires/mounting brackets with dual mounting holes: Connect toggled cross cable as shown and adjust position to level. Ensure M6 bolt is tightened into gripper after levelling.

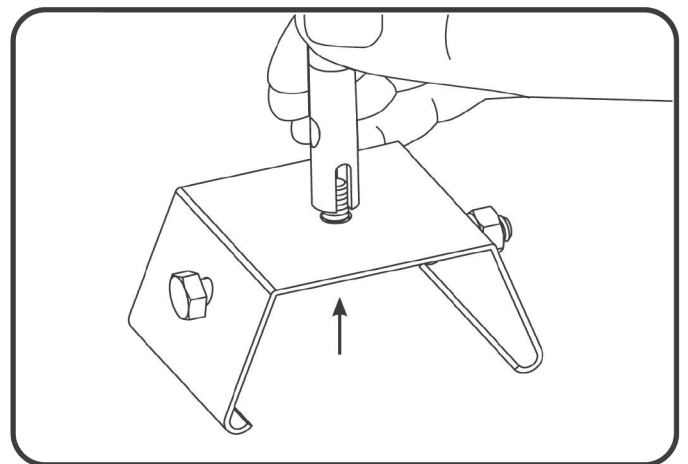
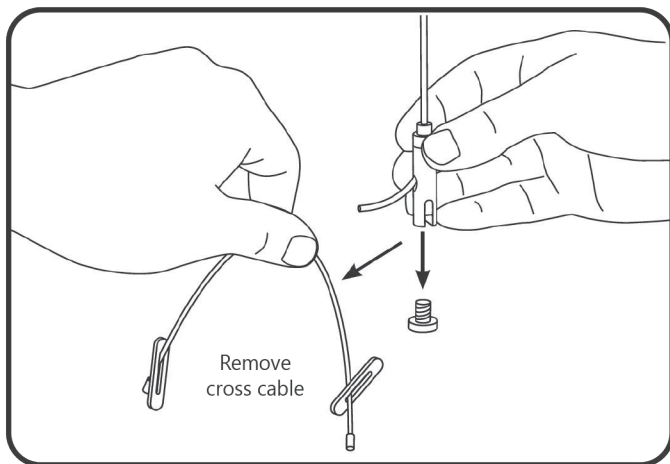

For mounting brackets with a single central hole: Remove cross cable from gripper and use M6 bolt to attach gripper directly to bracket.

② Connect Aircraft Cable To Ceiling Structure

The Lower Mounting Kit can connect to the ceiling structure in one of two ways:

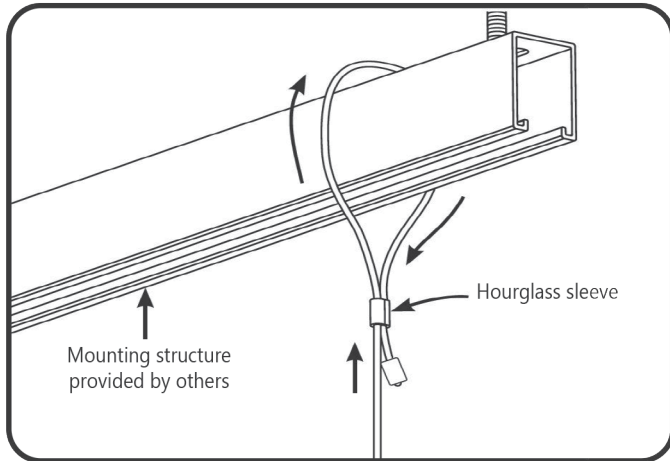

Loop onto structure: Using hourglass sleeve loop aircraft cable over existing building structure and pull tight. Ensure structure is rated for luminaire load before mounting.

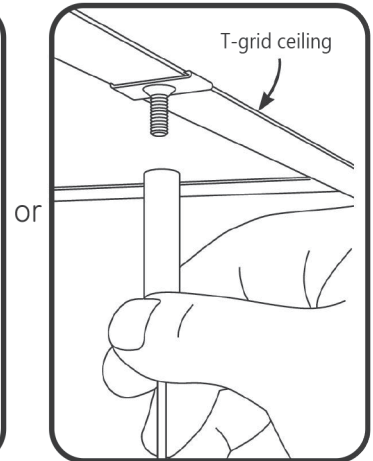
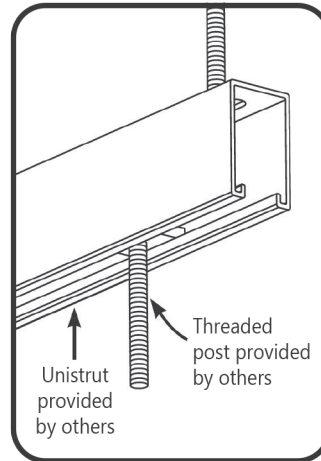

Couple to 1/4-20 rod: Install aircraft cable through 1/4-20 coupler and tighten coupler onto 1/4-20 rod attached to building structure. For finished drywall or T-grid ceilings use KIT-MTG-UPR (93026986) to provide 1/4-20 thread. Ensure ceiling structure is rated for luminaire load before mounting.

③ Attach Aircraft Cable To Gripper And Adjust Height

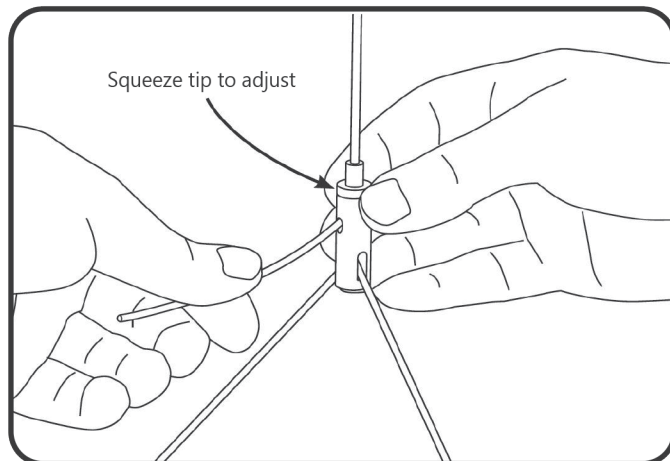

Pass aircraft cable end through hole at top of cross gripper and pull through until desired level is reached.

Note: Height cannot be adjusted while gripper is under load.

Once mounting brackets are properly levelled luminaires can be installed into brackets according to the specific instructions provided with the luminaire