

LED Power Supply

24
Volt

GEPS24LT-100U-NA (120-277 VAC input/24VDC output/100W)

Power Supply Features

- Supports all 24 VDC Current LED Products
- Dry and Damp Locations Rated
- Class 2 Power Supply
- 120-277 VAC Input

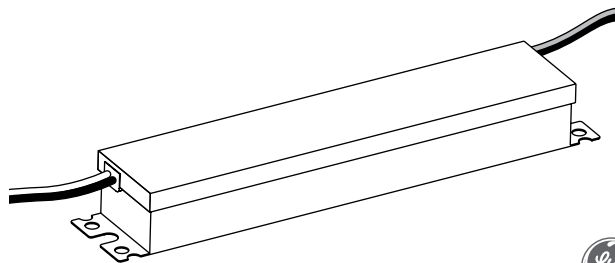

BEFORE YOU BEGIN

Read these instructions completely and carefully.

⚠ WARNING / AVERTISSEMENT

RISK OF ELECTRIC SHOCK

- Disconnect power at fuse box or circuit breaker before servicing or installing product.
- Properly ground power supply.
- AC input connections shall be suitably enclosed. The power supply shall be enclosed or made inaccessible to users during normal use.

RISK OF FIRE

- Use only approved wire for input/output connection. Minimum size 18 AWG (0.82 mm²).
- Follow all local codes.
- Application considerations potentially requiring additional spacing include high ambient temperature seen by the power supply, poor contact with a heat dissipating material, inadequate ventilation, or direct exposure to sun.

RISQUES DE DÉCHARGES ÉLECTRIQUES

- Coupez l'alimentation électrique à la boîte de fusibles ou au disjoncteur avant l'entretien ou l'installation du produit.
- Assurez-vous de correctement mettre à terre le bloc d'alimentation.
- Les connexions d'entrée CA doivent être convenablement enfermées. Le bloc d'alimentation doit être enfermée ou rendue inaccessible aux utilisateurs pendant l'utilisation normale.

RISQUES D'INCENDIE

- N'utilisez que des fils approuvés pour les entrées/sorties de connexion. Taille minimum 18 AWG (0.82 mm²).
- Respectez tous les codes locaux.
- Certaines applications pourraient requérir un espacement additionnel, p. ex. une température ambiante élevée autour du bloc d'alimentation, un mauvais contact avec une matière dissipatrice de chaleur, une ventilation inadéquate ou une exposition directe au soleil.

⚠ CAUTION / ATTENTION

RISK INJURY

- While performing installations described, gloves, safety glasses or goggles should be worn.

RISQUES DE BLESSURE

- Lors de l'exécution des installations décrites, des gants, des lunettes de sécurité ou des lunettes de protection doivent être portées.

Prepare Electrical Wiring



Electrical Requirements

- Limited to use in dry and damp locations.
- The suitability of rain enclosure shall be determined if intended for wet location.
- The grounding and bonding of the LED Driver shall be done in accordance with National Electric Code (NEC) Article 600.
- Follow all National Electric Codes (NEC) and local codes.

Save These Instructions

Use only in the manner intended by the manufacturer. If you have any questions, contact the manufacturer.

Power Supply Installation

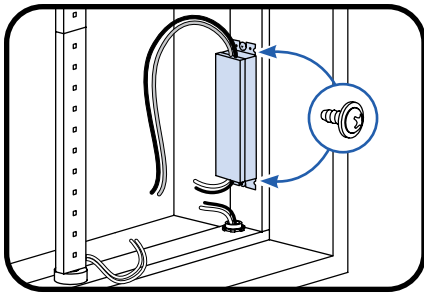

- 1 Mount the power supply. Mounting the power supply base directly to a thermally conductive installation surface can improve thermal performance.

NOTE: All electrical connections should be suitably protected from mechanical damage and the environment. Seal all connections exposed to water with electrical grade self-hardening silicone.

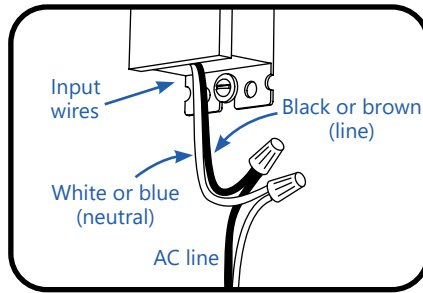

- 2 Connect the AC line to the black or brown (line) and white or blue (neutral) input wires of the power supply using suitable wire connectors.

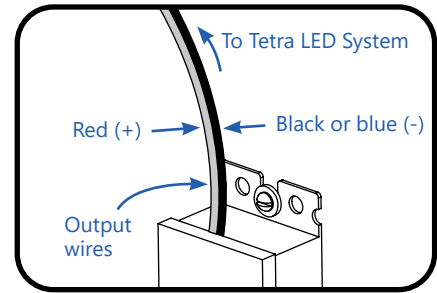

- 3 Connect the supply wire that is attached to the Tetra LED System to the red (+) and black or blue (-) output wires of the power supply as outlined in the **“Electrical Connections”** section of your LED system’s Installation Instructions.

NOTE: To avoid overloading this power supply with LED modules, please refer to the specific module loading guides.

⚠ WARNING
RISK OF ELECTRIC SHOCK
 AC input connections shall be suitably enclosed.

FOR UL

NOTE: For installation in Canada, a disconnect switch of appropriate rating needs to be placed within 29.5 feet (9 meters) of primary side of the power supply. The switch voltage rating shall not be less than the branch circuit voltage. The switch must also support twice the amount of input current.

FOR UL

NOTE: When installing power supply, connect to the appropriate sized building breaker or disconnect device for line, neutral and ground connections, in accordance with National Electric Code (NEC) Article 600 and all local regulations.

OPTIONAL

A Weather Box (GEXNWB2) may be used to house and seal Class 2 connections.

A) Insert wire connectors into weather box. Fill with electrical grade silicone and close box.

B) Secure the weather box using a #6 or #8 (M2 or M3) screw.

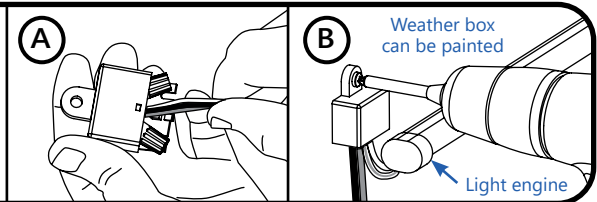

Power Supply Specifications

| Performance Data | Min | Typical | Max |
|---|---|---------|--------|
| Input Voltage (VAC) | 108 | 120-277 | 305 |
| Input Frequency (Hz) | – | 50/60 | – |
| Input Current (A) | – | – | 0.95 |
| THD** | – | – | 20 |
| PF** | 0.95 | – | – |
| Output Voltage (VDC) | 23.0 | – | 25.0 |
| Output Current (ADC) | – | – | 4.15 |
| Output Power (W) | – | – | 99.6 |
| Environmental Operating Temperature Range | -40°C | +25°C | +55°C* |
| Environmental Humidity (non-condensing) | 10% | – | 90% |
| Environmental Storage Temperature Range | -40°C | – | +85°C |
| Environmental Rating | UL Dry and Damp Locations | | |
| Dimensions | 9.50 in. x 1.69 in. x 1.00 in. (241.3 mm x 43.0 mm x 25.4 mm) | | |

*Maximum case temperature is 90°C

**At 120VAC - 277VAC Full Load

Troubleshooting

| Symptom | Solution |
|--------------------------------------|--|
| All LEDs are OFF | <ul style="list-style-type: none"> Check AC input connection and/or check circuit breaker. Check wire connection(s) at the Tetra® LED System and power supply for improper termination(s) or short circuits. Properly terminate or replace the wire connection(s). Check that connections are the red striped wire (+) of the LED strip to the red wire (+) of the power supply and the white wire (-) of the LED strip to the black or blue wire (-) of the power supply. Ensure the overall length of the Tetra® LED System does not exceed the maximum load. If so, remove the excess load and cycle the AC supply to reset the drivers built in overload protection. |
| Some LEDs appear dim | <ul style="list-style-type: none"> Ensure the length of supply wire is equal to or below the recommended remote mounting distance. |
| Some of the LEDs are not illuminated | <ul style="list-style-type: none"> Check wire connection(s) at the Tetra® LED System and power supply for improper termination(s) or short circuits. Properly terminate or replace the wire connection(s). Check that connections are the red striped wire (+) of the LED strip to the red wire (+) of the power supply and the white wire (-) of the LED strip to the black or blue wire (-) of the power supply. |

This device complies with part 15 of the FCC Rules. Operation is subject to the following two conditions: (1) This device may not cause harmful interference, and (2) this device must accept any interference received, including interference that may cause undesired operation.

Note: This equipment has been tested and found to comply with the limits for a Class A digital device, pursuant to part 15 of the FCC Rules. These limits are designed to provide reasonable protection against harmful interference when the equipment is operated in a commercial environment. This equipment generates, uses, and can radiate radio frequency energy and, if not installed and used in accordance with the instruction manual, may cause harmful interference to radio communications. Operation of this equipment in a residential area is likely to cause harmful interference in which case the user will be required to correct the interference at his own expense.

This Class [A] RFLD complies with the Canadian standard ICES-005. Ce DEFR de la classe [A] est conforme à la NMB-005 du Canada.

Conforms to the following standards:



This product is intended to be used as a lamp control gear that is installed after the mains control switch.

For the latest Tetra install guides for your product go to: <https://www.led.com>

Current Lighting Solutions, LLC
Cleveland, OH 44124