

Traffic Signal

Cleaning/Maintenance Guide

Maintenance and Inspection Schedule

Periodically (as required), inspect signals for physical damage (including cracks, dents, etc.), failed LEDs, lens clouding and dirt and/or dust accumulation on the signal. If dirt, dust or debris is present, please follow the below cleaning instructions.

If the signal is damaged, please contact your reseller to purchase a new one.

Cleaning Instructions and Cautions

DO NOT CLEAN INTERNAL SYSTEM

Signals are not designed to be disassembled and do not require cleaning of internal parts.

PERIODIC CLEANING

Should the signal require cleaning, use only non-abrasive, neutral (pH 6-8) cleaner containing no chlorinated or aromatic hydrocarbons.

⚠ WARNING

RISK OF ELECTRICAL SHOCK.
Turn power OFF before inspection, installation or removal.

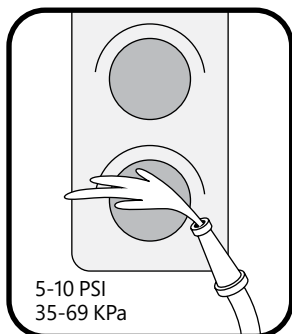

① Pre-rinse the signals. A low-pressure hose may be used.

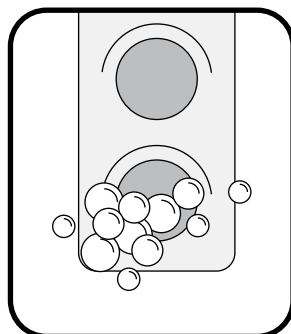

② The lens of the signals may be cleaned using a cleaning solution as described above.

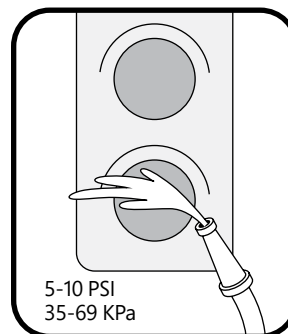

③ Rinse clean with a low-pressure hose.

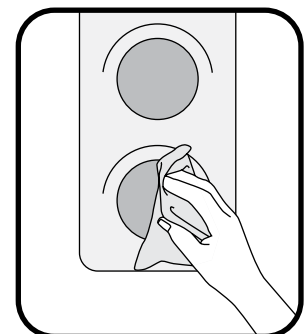

④ Wipe dry with a clean non-abrasive cloth.