

### HOUSING INSTALLATION INSTRUCTIONS

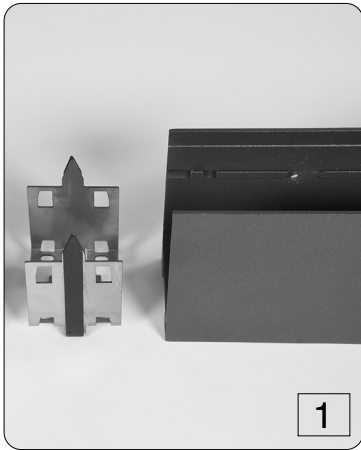

Align housing and mounting plate. If applicable mate two or more housing units on a flat surface (on ground) before installing the housing assembly to wall/surface.

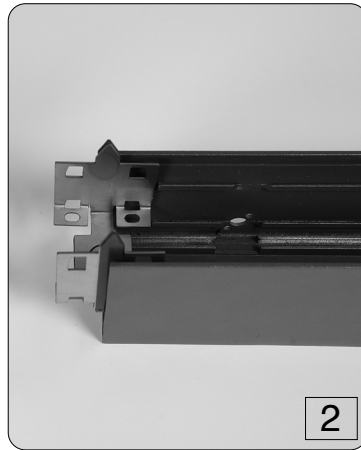

Slide the mating plate into the housing opening. Push the mating plate in till the slots of the mating plate engage the rails in the housing and the plate bottoms out on the screw bosses.

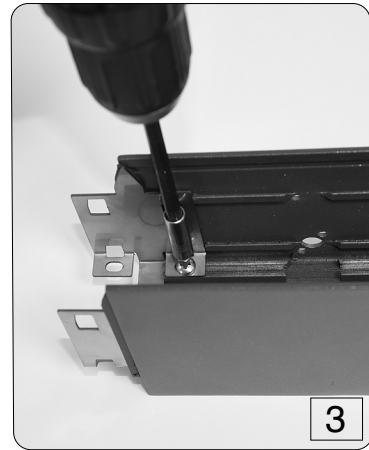

Partially secure the mating plate with hardware. Do not fully tighten the screws.

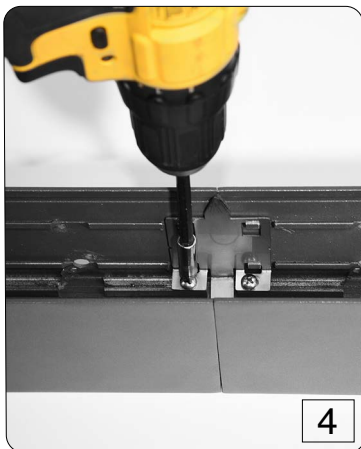

Align the next housing unit into the other half of the mating plate and repeating step 3.

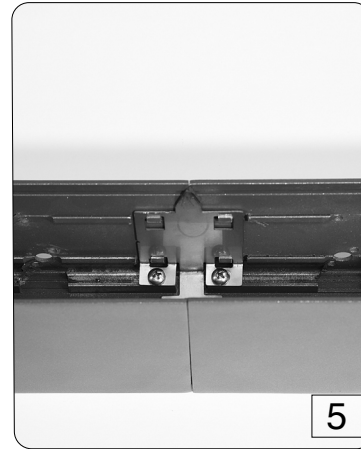

Ensure both housing units line up properly with minimal of gap between them and fully tighten all screws. Do not over tighten the screws or damage to the housing screw bosses could occur.

### LENS INSTALLATION INSTRUCTIONS



Mount external housing(s) to wall/surface.  
[Click here](#) for adjustable arm mounting detail.  
[Click here](#) for fixed arm mounting detail.

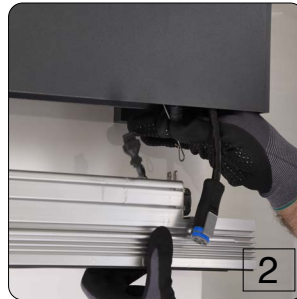

Attach retention cables to eyelets on both sides of the light engines.



For Up Light: connect secondary power cable to the light engine.  
 For Downlight, power cable and light engine are prewired.



Connect the fixture power cable to the light engine and make sure the tabs are fully engaged.

For continuous run →



Continuous run: connect the mating power cable from one light engine to the other light engine. Repeat this process for multiple sections.  
 Note: To prevent binding, create a loop in the mating power cable by twisting it before plugging in the second end.



Install light engine(s) to housing(s) by pushing the light engine into the external housing one end at a time until the housing clips inside fully engage. Repeat for continuous run.



Install external lens.



Put in lens latches. Repeat this step for continuous run. Ensure that the lens latches are fully engaged. An audible click will be heard when each latch spring locks and the bottom edge will sit flush with the external housing's edge.

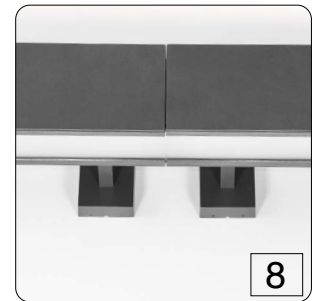

Turn on power and check for operation. Installation completed.