

Always On.

At Current, inspiration flows both ways. In providing the lighting and controls solutions that help create beautiful, functional and safe environments, we're inspired by the people who live, work and play in those spaces.

Only Current can provide reliable performance, responsive service, and the uncompromising quality you expect from an industry leader every time, always.

Our Vertical Markets



Commercial

Stores, Offices, Hotels, Supermarkets, Restaurants, Healthcare, Education



Industrial

Manufacturing Centers, Warehouses, Food Processing Plants



Municipal

Roadways, Residential Streets, Shared Spaces



Specialty

Greenhouses, Disinfection Lighting, Signage, Transportation

Our Solutions



LED Lighting

Optimize utilities to end excess energy spending, promote safety and improve aesthetics



Controls, Sensors & IoT Solutions

Improve space utilization and increase productivity, and find actionable insights with IOT



Energy Management Systems

Establish more sustainable energy practices across an enterprise



Disinfection for Occupied Spaces

Reduce the presence of pathogens



Horticultural Lighting

Maximize the potential of greenhouses and indoor farms

Current



Industry-leading portfolio of innovative product and tech brands

With the convergence of two iconic leaders who each bring rich histories and deep talent, Current is uniquely positioned to help our customers solve complex challenges with the industry's widest selection of advanced lighting and intelligent controls.

HLI Brands

Current's HLI Brands portfolio of products offers well-known and respected brands, offering a comprehensive range of indoor luminaires, outdoor luminaires, and connected lighting solutions for architectural, commercial, industrial and institutional applications.





The NX Lighting Controls Wall Station family is designed to provide intuitive user control for the NX System. All NXSW2 Wall Stations are digitally addressable and can connect to any NX device enabled with a SmartPort connection. With their clean and unobtrusive decorator style form factor, the NXSW2 Wall Stations can be integrated seamlessly with standard decorator wall plates. This design and functionality makes the NX Wall Station family a perfect solution for a wide variety of applications across commercial, institutional, and industrial buildings. All NX Wall Stations can be configured for use in the NX system utilizing the NX Lighting Controls mobile app or NX Area Controller.

Table of Contents

- 6 NXSW2-ORLO (On/Raise/Lower/Off)
- 7 NXSW2-SS (Scene Switch)
- 8 NXSW2-OO (On/Off)
- 9 NXSW2-CCT (CCT)
- 10 NXSW2-Smart Switch
- 11 NXSW2-Key (Digital Key Switch)
- 12 Button Types
- 14 Technical Services
- 15 Design Services



NXSW2-ORLO

The On/Raise/Lower/Off specialty wall station provides intuitive control for diverse applications such as single use office, large conference room, or classroom environment. The On/Raise/Lower/Off functions allow users to easily adjust their light levels while simplifying installation for contractors with no additional setup or programming required.

The ORLO wall station can be paired with NX Room Controllers or NX enabled luminaires via a Cat5 connection. The ORLO wall station comes pre-configured from the factory with settings optimized to meet basic code requirements and controls loads within a zone. Settings can be fine-tuned utilizing the NX Lighting Controls mobile app.

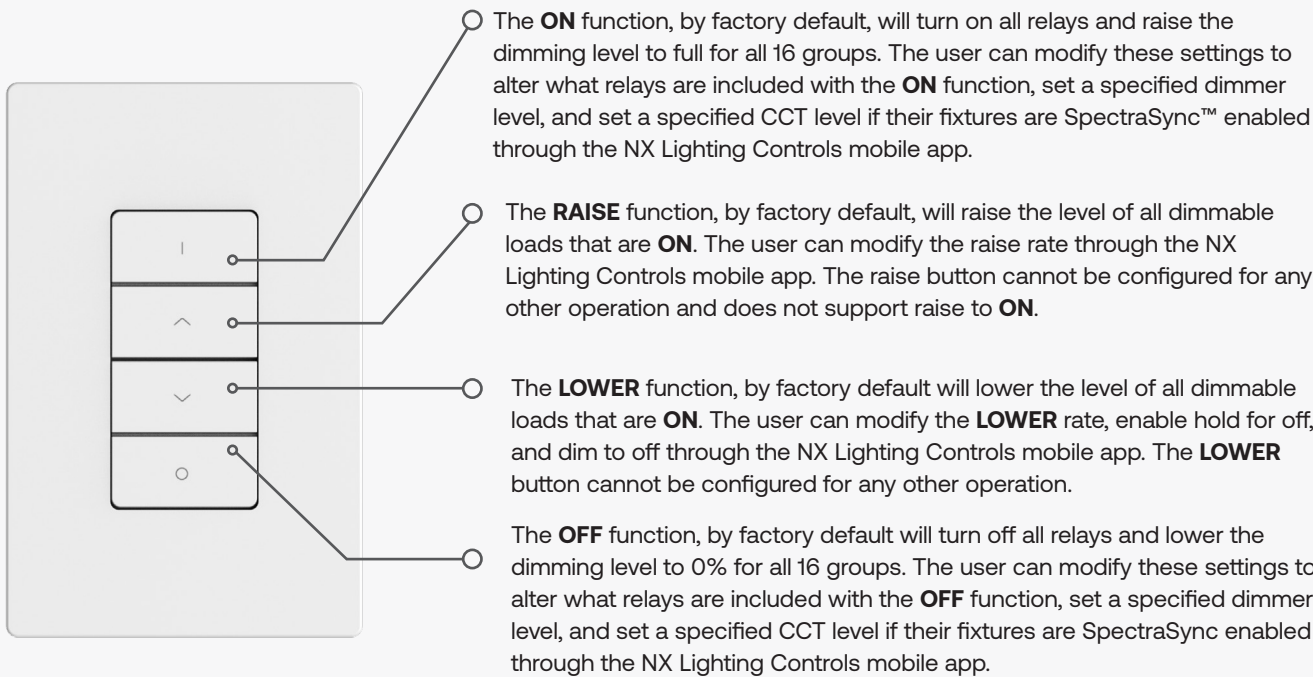

AVAILABLE COLORS

WHITE

LIGHT ALMOND

IVORY

GRAY

BLACK

RED

TECHNOLOGY



GENERAL SPECIFICATIONS	
Connection	NX SmartPORT or FX Port using plenum rated Cat5 cables
Custom Button	No
Construction	Housing - Rugged, high impact, injection molded plastic
Dimensions	4.12”H (104.65mm) x 1.86”W (47.24mm) x 1.72”D (43.4mm)
Weight	2.4 oz (68g)
Mounting	Switches may be mounted individually in a single gang switch box or ganged together in a multi-gang switch box Decorator-style wall plates available separately

NXSW2-SS

The Scene Switch specialty wall station is designed to provide preset scenes for applications such as instructional spaces, conference rooms, or multipurpose meeting spaces. The preset scene functions allow users to easily adjust their light levels utilizing predefined settings or can be manually adjusted using the raise and lower functions. Each scene button includes a pilot light to provide visual feedback for the current activated scene. The preset buttons can also be replaced with custom button caps which are ordered separately.

The Scene Switch wall station can be paired with NX Room Controllers or NX enabled luminaires via a Cat5 connection. The Scene Switch wall station comes preconfigured from the factory with settings optimized to meet basic code requirements and controls all loads within in a zone. Settings can be fine-tuned utilizing the NX Lighting Controls mobile app.

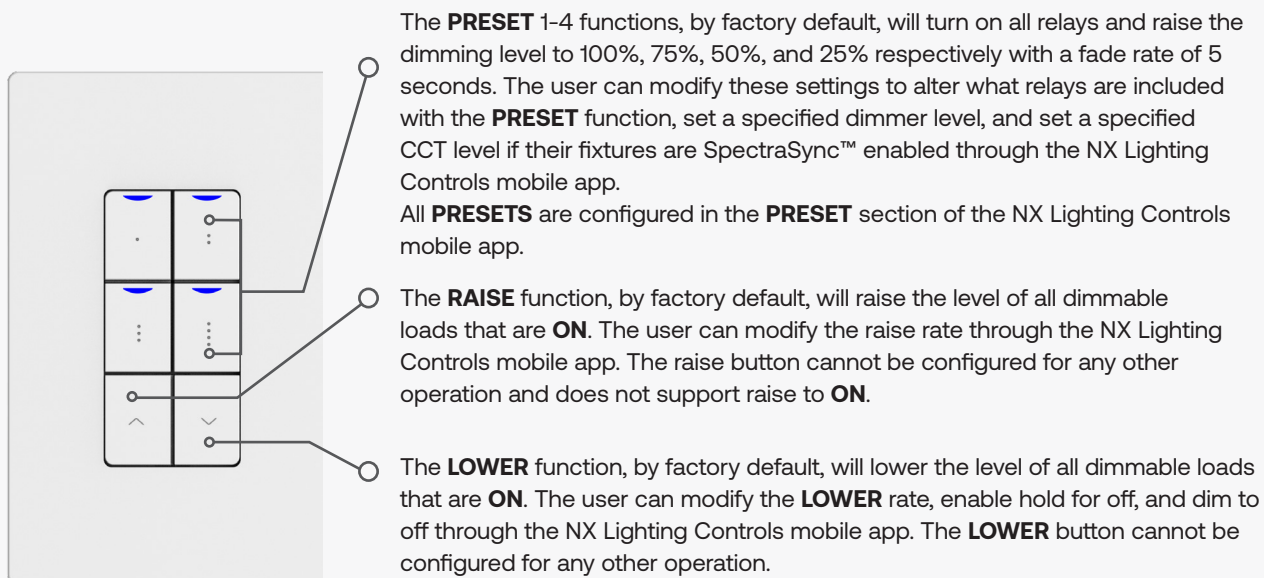

AVAILABLE COLORS

WHITE

LIGHT ALMOND

IVORY

GRAY

BLACK

RED

TECHNOLOGY



GENERAL SPECIFICATIONS	
Connection	NX SmartPORT or FX Port using plenum rated Cat5 cables
Custom Button	Yes (Ordered Separately See Custom Button Ordering)
Construction	Housing - Rugged, high impact, injection molded plastic
Dimensions	4.12”H (104.65mm) x 1.86”W (47.24mm) x 1.72”D (43.4mm)
Weight	2.4 oz (68g)
Mounting	Switches may be mounted individually in a single gang switch box or ganged together in a multi-gang switch box Decorator-style wall plates available separately

NXSW2-OO

The On/Off specialty wall station is designed to provide simple On/Off control for any application. The On/Off functions are enabled from the factory to provide instant control to all groups connected in the local zone. The On/Off specialty wall station is an ideal companion for a specialty Scene Switch or NX Smart Button wall stations.

The On/Off wall station can be paired with NX Room Controllers or NX enabled luminaires via a Cat5 connection. The On/Off wall station comes preconfigured from the factory with settings optimized to meet basic code requirements and controls all loads within a zone. Settings can be fine-tuned utilizing the NX Lighting Controls mobile app.

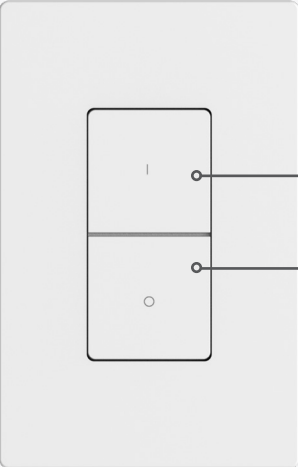

- The **ON** function, by factory default, will turn on all relays and raise the dimming level to full for all 16 groups. The user can modify these settings to alter what relays are included with the **ON** function, set a specified dimmer level, and set a specified CCT level if their fixtures are SpectraSync™ enabled through the NX Lighting Controls mobile app.
- The **OFF** function, by factory default, will turn off all relays and lower the dimming level to 0% for all 16 groups. The user can modify these settings to alter what relays are included with the **OFF** function, set a specified dimmer level, and set a specified CCT level if their fixtures are SpectraSync enabled through the NX Lighting Controls mobile app.



AVAILABLE COLORS

- WHITE
- LIGHT ALMOND
- IVORY
- GRAY
- BLACK
- RED

GENERAL SPECIFICATIONS

Connection	NX SmartPORT or FX Port using plenum rated Cat5 cables
Custom Button	No
Construction	Housing - Rugged, high impact, injection molded plastic
Dimensions	4.12”H (104.65mm) x 1.86”W (47.24mm) x 1.72”D (43.4mm)
Weight	2.4 oz (68g)
Mounting	Switches may be mounted individually in a single gang switch box or ganged together in a multi-gang switch box Decorator-style wall plates available separately

TECHNOLOGY



NXSW2-CCT

The CCT specialty wall station is designed to provide simple chromaticity control for commercial applications. The preset CCT functions allow users to easily adjust their color settings utilizing predefined set points or can be manually adjusted using the raise and lower CCT functions. Each CCT button includes a pilot light to provide visual feedback for the current activated scene. The preset buttons can also be replaced with custom button caps which are ordered separately.

The CCT wall station can be paired with NX Room Controllers or NX enabled luminaires via a Cat5 connection. The CCT wall station comes preconfigured from the factory with settings optimized to meet basic code requirements and controls all loads within a zone. Settings can be fine-tuned utilizing the NX Lighting Controls mobile app.

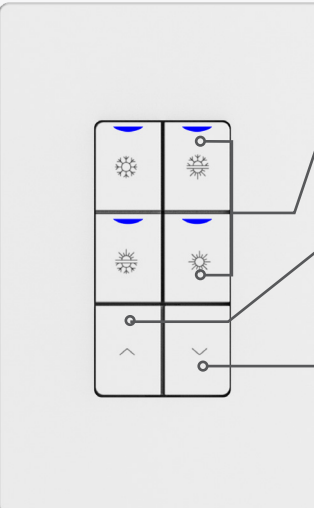

- The CCT **PRESETS** 1-4 functions, by factory default, will set the CCT to 5000K, 4200K, 3500K, or 2700K respectively. The user can modify these settings to alter what relays are included with the CCT **PRESET** function, set a specified dimmer level, and enable a Dim to Warm function if their fixtures are SpectraSync™ enabled through the NX Lighting Controls mobile app.
- The **RAISE** CCT function, by factory default, will raise the level of all CCT enabled loads that are ON. The user can modify the CCT **RAISE** rate through the NX Lighting Controls mobile app. The CCT raise button cannot be configured for any other operation and does not support raise to **ON**.
- The **LOWER** CCT function, by factory default, will lower the CCT level of all dimmable loads that are **ON**. The user can modify the CCT **LOWER** rate through the NX Lighting Controls mobile app. The **LOWER** button cannot be configured



AVAILABLE COLORS

- WHITE
- LIGHT ALMOND
- IVORY
- GRAY
- BLACK
- RED

GENERAL SPECIFICATIONS

Connection	NX SmartPORT or FX Port using plenum rated Cat5 cables
Custom Button	Yes (Ordered Separately See Custom Button Ordering)
Construction	Housing - Rugged, high impact, injection molded plastic
Dimensions	4.12”H (104.65mm) x 1.86”W (47.24mm) x 1.72”D (43.4mm)
Weight	2.4 oz (68g)
Mounting	Switches may be mounted individually in a single gang switch box or ganged together in a multi-gang switch box Decorator-style wall plates available separately

TECHNOLOGY



NXSW2 – SMART SWITCH

The Smart Switch wall station is designed to operate as all button types within the NX wall station offering. This customization allows users to create custom configurations tailored to their application, limiting the number of wall stations needed. The Smart Switch comes available in multiple button types including 1, 2, 3, 4, 6, and 8 button versions. Each Smart Switch button includes a pilot light to provide visual feedback for the current activated scene. The Smart Switch buttons can also be replaced with custom button caps which are ordered separately.

The Smart Switch wall station can be paired with NX Room Controllers or NX enabled luminaires via a Cat5 connection. The Smart Switch wall station comes preconfigured from the factory with settings optimized to meet basic code requirements and controls all loads within a zone. Settings can be fine-tuned utilizing the NX Lighting Controls mobile app.

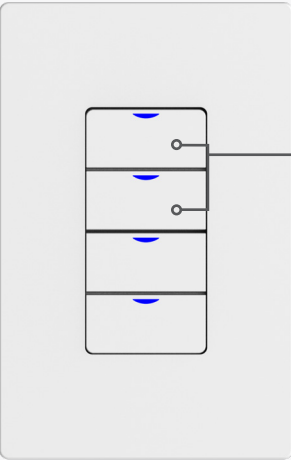

The default operation of the Smart Switch buttons is a **TOGGLE** button type with simple press for ON/press for OFF functionality. The user can modify the button types to be configured to any button type through the NX Lighting Controls mobile app.

The NXSW2 Smart Station is available in multiple button configurations.

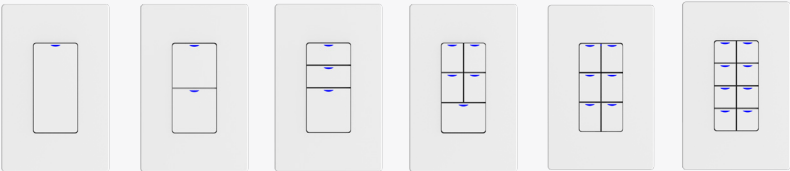

TECHNOLOGY



AVAILABLE COLORS



GENERAL SPECIFICATIONS

Connection	NX SmartPORT or FX Port using plenum rated Cat5 cables
Custom Button	Yes (Ordered Separately See Custom Button Ordering)
Construction	Housing - Rugged, high impact, injection molded plastic
Dimensions	4.12"H (104.65mm) x 1.86"W (47.24mm) x 1.72"D (43.4mm)
Weight	2.4 oz (68g)
Mounting	Switches may be mounted individually in a single gang switch box or ganged together in a multi-gang switch box Decorator-style wall plates available separately

NXSW2 – KEY

The Digital Key Switch Specialty wall station is designed to operate as all button types within the NX wall station offering. This customization allow users to create custom configurations tailored to their application. The Digital Key Switch comes in two button types: Single Throw Maintained and Single Throw Momentary. The Digital Key Switch relies on a key to access control and includes a pilot light to provide visual feedback for the actuated function.

The Digital Key Switch Specialty wall station can be paired with NX Room Controllers or NX enabled luminaires via a Cat5 connection. The Digital Key Switch come preconfigured from the factory with settings optimized to meet basic code requirements and controls all loads within a zone. Settings can be fine-tuned utilizing the NX Lighting Controls mobile app.

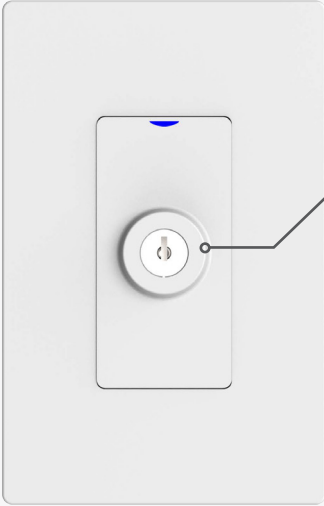

The default operation of the Digital Key Switch is a **TOGGLE** button type with simple 90° right turn for ON/90° right turn for OFF functionality. The user can modify the switch types to be configured to any button type through the NX Lighting Controls mobile app.



TECHNOLOGY



AVAILABLE COLORS



GENERAL SPECIFICATIONS

Connection	NX SmartPORT or FX Port using plenum rated Cat5 cables
Custom Button	No
Construction	Housing - Rugged, high impact, injection molded plastic
Dimensions	4.12"H (104.65mm) x 1.86"W (47.24mm) x 1.84"D (46.7mm)
Weight	2.4 oz (68 g)
Mounting	Switches may be mounted individually in a single gang switch box or ganged together in a multi-gang switch box Decorator-style wall plates available separately

NX SMART PROGRAMMABLE BUTTON TYPES

Button Type	Button Functions	Default	Optional	Notes
TOGGLE	Group ON to 100%	●		No configurable options for Toggle available, includes LED pilot light, factory default button type for programmable buttons
ON	Group ON to 100%	●		The ON button supports LED pilot on programmable buttons. Specialty switch buttons do not support LED pilot light. ON button does not support fade time.
	Group ON to user-set level		●	
	Set color temperature for ON		●	
	Include relay	●		
	Exclude relay		●	
OFF	Group OFF to 0%	●		OFF button does not support fade time.
	Group to user-set light level		●	
	Set color temperature for OFF		●	
	Include relay	●		
	Exclude relay		●	
RAISE	Press and hold to ramp group level up	●		Raise does not turn lights ON. Two adjustments can be made for ramp rate. Speed of change in millisecond (300 - 1000) and % of change (1-25)
	Tap to step group level up	●		
LOWER	Hold to ramp group level down	●		Firm press for OFF applies to the Lower button on the NXSW2-SS scene switch only
	Tap to step group level down	●		
TIMED ON	Group ON to 100%	●		Timer can be set between 1 - 180 minutes. Defalut is 60 minutes. Hold the button for 3 seconds to cancel the ON.
	Group ON to user-set level		●	
	Set color temperature for ON		●	
	Set color temperature for OFF at timeout			
	Group OFF to 0% at timeout	●		
	Group to user-set level at timeout		●	
	Include relay for ON	●		
	Include relay for OFF	●		
PRESET	Activate preset scene (1 - 16)	●		LED is lit when the preset scene is active
ON/RAISE/ LOWER/OFF	Tap while OFF to turn group ON	●		Same functionality as the override buttons on the Room Controller
	Press and hold while ON to ramp group level down	●		
	Release and press again to ramp group level up	●		
	Tap while ON to turn group OFF	●		
SINGLE BUTTON ON/OFF	Group ON to 100%	●		Default operation is identical to the Toggle button except this button type includes options for ON and OFF
	Group ON to user-set level		●	
	Set color temperature for ON		●	
	Include relay for ON	●		
	Exclude relay		●	
	Group OFF to 0%	●		
	Group to user-set light level		●	
	Set color temperature for OFF		●	
	Include relay for OFF	●		
	Exclude relay		●	

ADDITIONAL BUTTON TYPES

Button Type	Button Functions	Default	Optional	Notes
DISABLE	Disables all button functionality	●		Button is Functionless
EMERGENCY OVERRIDE	Sends Fire Emergency Command	●		Four different Modes: Emergency Toggle, Emergency Maintain (Default), Emergency On, Emergency Off
DEMAND RESPONSE	Sends Demand Response Level for the Zone	●		Demand Response Level (1-10) Default: 10. Three different Modes: Off, On, On/Off
ON/RAISE	Group ON to 100%	●		The ON button supports LED plot on programmable buttons. Two adjustments can be made for ramp rate. Speed of change in millisecond (300-1000) and % of change (1-25)
	Group ON to user-set level		●	
	Set color temperature for ON		●	
	Include relay	●		
	Exclude relay		●	
	Press and hold to ramp group level up	●		
OFF/LOWER	Tap to step group level up	●		OFF button does not support fade time. Two adjustments can be made for ramp rate. Speed of change in millisecond (300 - 1000) and % of change (1-25)
	Group OFF to 100%	●		
	Group to user-set level		●	
	Set color temperature for OFF		●	
	Include relay	●		
	Exclude relay		●	
PARTITION	Press and hold to ramp group level down	●		Lit LED indicates that the rooms are combined
	Tap to step group level down	●		
	Tap ON to combine rooms	●		
	Tap OFF to separate rooms	●		
CCT ON	Tap to go to the selected color	●		Default fade time is 5 seconds, 18 hours max fade time
	Include relay for ON		●	
CCT RAISE	Press and hold button to increase the color temp	●		Two adjustments can be made for ramp rate. Speed of change in millisecond (300 - 1000) and % of change (1-25)
	Tap button to increse the color temp in steps	●		
CCT LOWER	Press and hold button to lower the color temp	●		Two adjustments can be made for ramp rate. Speed of change in millisecond (300 - 1000) and % of change (1-25)
	Tap button to lower the color temp in steps	●		

Comprehensive Support Options to Meet Project Needs

Contact Us



Option 1
Tech Support



Option 2
Field Commissioning

Call (800) 888-8006 and select one of the options listed above

Tech Support Hours: 7:00am - 7:00pm EST, Monday - Friday

Quotes, Applications, Layouts and Submittal Requests:
controls-Design@currentlighting.com

Technical Support (troubleshooting, specifications, programming):

<https://www.currentlighting.com/controls/technical-services>



Phone and Remote Support

While it is our goal to provide you with intelligent, simple and scalable control solutions, customer experience level and project complexity may necessitate additional support during the design development, construction and post-occupancy stages of a project. The support team is available for consultation to evaluate multiple control scenarios to identify the ideal lighting control device or system to meet energy code requirement and customer criteria. Additionally, our team of friendly and experienced professionals is enabled to assist on-site personnel, such as installation contractors, third party integrators, certified field technicians and facilities personnel, to quickly resolve issues and provide additional support.



Warranty

Current provides a 5-year limited warranty for LED luminaires and Lighting Controls devices.



On-site Support

Current offers on-site support service to ensure your project goes smoothly. While Current products are designed with simplicity in mind, some projects may benefit from a Field Service Engineer to perform an on-site pre-installation walk-through, after-hours and remote startup assistance, occupant training, sensor tuning, preset programming and other pre/post-occupancy services.



Design Services

Our team of lighting control system design professionals are available to provide sensor layouts, networked system design services and third party integration support for new and retrofit projects. Our goal is to provide you with on-time and accurate delivery of design deliverables optimized for your specific application, compliant with local building codes and project specifications.



Classroom Education

Current offers cutting edge educational opportunities at Institute facilities across the United States. Our headquarters, located in Greenville, SC houses one of the industries largest training facilities with over 25,000 square-feet and is engineered to present a total solutions approach to your lighting and controls challenges.

Additionally, we have dedicated Institute facilities in North Carolina and Texas as well as Current facility classrooms for in-person instruction across the United States.

The Institute

Virtual Education

Current's virtual education opportunities cover many facets of the lighting and controls industry including fundamentals, trends, technology, and product solutions. In addition, we can provide accredited continuing education (CEU) modules to help you maintain your certifications.

Engage with us in a way that's best for you!

- An online university with modules designed for self pace individual learning consumed on-demand.
- Live (private) instructor-led training private events for individuals within your own organization designed specifically for your needs.
- Live (public) instructor led training public events highlighting new technologies, continuing education, and lighting trends.



ARCHITECTURAL AREA LIGHTING

BEACON

COLUMBIA LIGHTING

COMPASS

DUAL-LITE

EXO

FORUM

KIM LIGHTING

KURT VERSEN

LIFESHIELD

LITECONTROL

NX LIGHTING CONTROLS

PRESCOLITE

Current - HLI Brands

701 Millennium Blvd.
Greenville, SC 29607

currentlighting.com/

© 2023 HLI Solutions, Inc. All rights reserved. Information and specifications subject to change without notice. All values are design or typical values when measured under laboratory conditions.

(
I