

Lighting Controls

NX MEDIA CONVERTER

DATE:	LOCATION:
TYPE:	PROJECT:
CATALOG #:	

FEATURES

- Supports 10BASE-T, 100BASE-TX, 100BASE-FX and IEEE 802.3 specification
- Multimode converter, supports up to 5km distance
- Cost-effective, small and lightweight
- RJ45 port supports Full/Half-Duplex auto-negotiation and MDI/MDIX auto-crossover
- 120V AC Power Supply
- LED indicators for RJ45 and fiber port status
- 0° to 40°C Operating Temperature
- Wall mounting kit included



CONTROL TECHNOLOGY



SPECIFICATIONS

CONSTRUCTION

- 1.71" (43.4mm) W x 4.10" (104.1mm) D x 0.84" (21.3mm) H
- 4oz (113.4g), 12oz (340.2g) with AC adapter

INSTALLATION

- Operating Temperature: 0° to 40°C, Storage Temperature: -40° to 60°C
- 5% to 95% (non-condensing)
- -100m to 4000m
- Wall mountable (See install guide for details)

DATA CONNECTION

- Supports IEEE 802.3 Standard for Ethernet Communications
- Up to 1536 bytes frame size

DATA CONNECTION (CONTINUED)

- Port Types
 - Copper: 10/100BASE-T (RJ45)
 - Fiber: 100BASE-X (ST)
- Cable Types
 - Copper: EIA/TIA 568A/B, Cat5 UTP and higher
 - Fiber: Multimode: 50/125µm, 62.5/125µm. Single-mode: 9/125µm
- Connector Types
 - Copper: Standard RJ45
 - Fiber: ST Connector

ELECTRICAL

- US AC Adapter: 100–120V AC/60Hz, 0.03A @ 120V AC (max)

ELECTRICAL (CONTINUED)

- DC Input
 - 5.0 to 12.0V DC, 0.5A @ 5V DC, 0.3A @ 9V DC, 2.5mm Barrel Connector

CERTIFICATIONS

- Conforms with UL, CE, FCC Class A

WARRANTY

- 5 year warranty

ORDERING GUIDE

Example: NX-EOF-MC-01

CATALOG #

Model	Ethernet	Converter	Version
NX NX Lighting Controls	EOF Ethernet Over Fiber	MC Media Converter	01 Version 1

Lighting Controls

NX MEDIA CONVERTER

DIMENSIONS

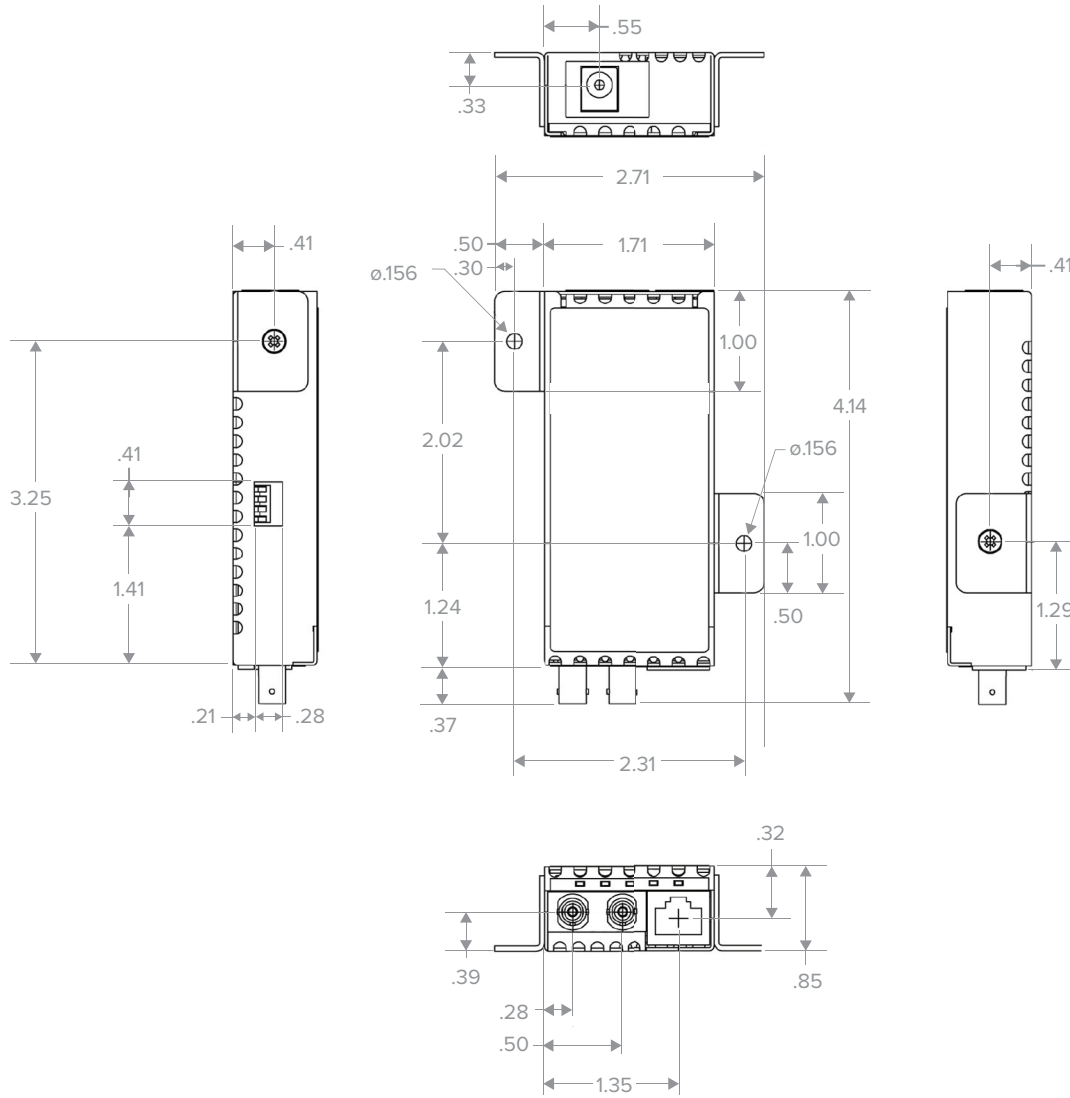

Lighting Controls

NX MEDIA CONVERTER

APPLICATION DIAGRAM

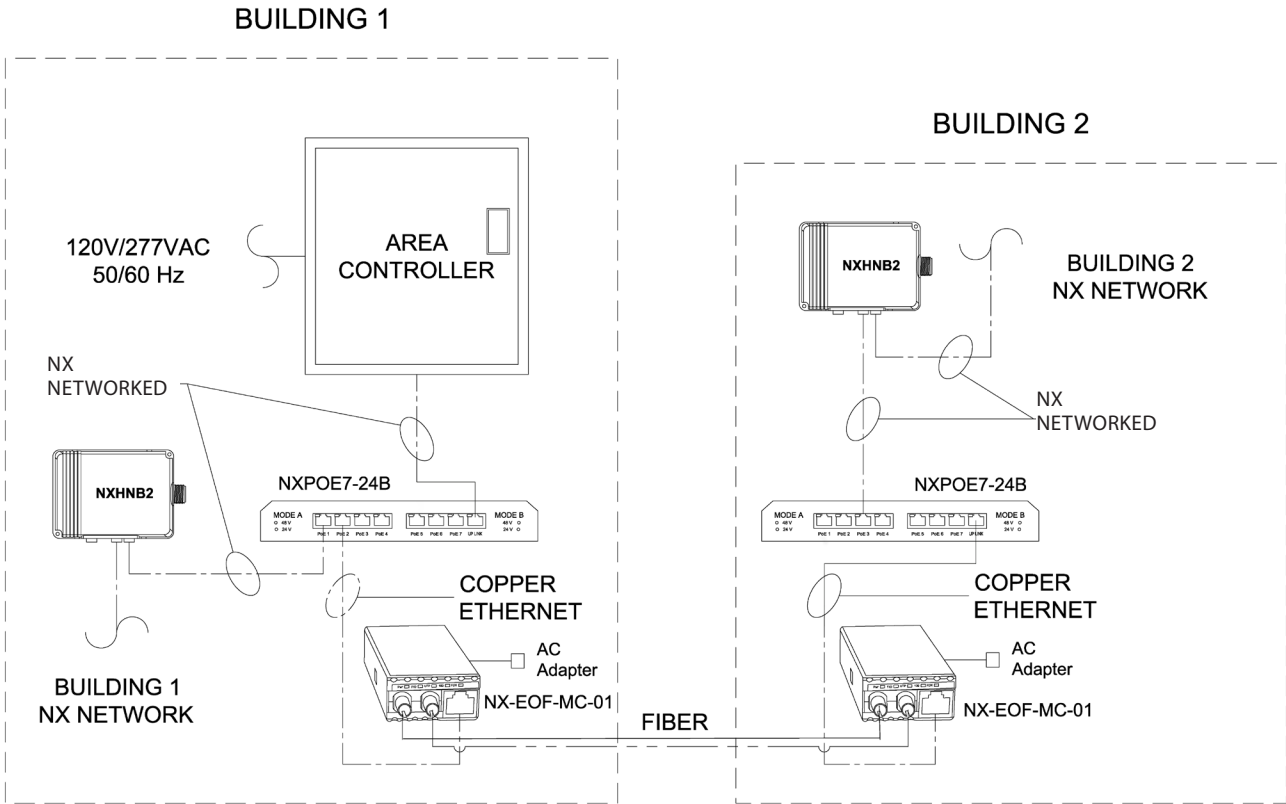

LED INDICATORS

Funtion/ Legend	Color	Off	On
AC/DC Power "Pwr"	Green	No AC/DC power	Power applied
PoE Power "PoE"	Green	No PoE power detected	PoE power applied
Fiber Link "F/O"	Green	No fiber link	Solid = link Blinking (10Hz) = data Blinking (1Hz) = RX FEFI
	Amber	No fiber link or DDMI alarm	Solid = link with DDMI alarm Blinking (10Hz) = data with DDMI Blinking (1Hz) = RX FEFI and DDMI (see footnote)
RJ-45 Speed "10"	Green	No link at 10M	Solid = linked at 10M Blinking (10Hz) = data at 10M
RJ-45 Speed "100"	Green	No link at 100M	Solid = linked at 100M Blinking (10Hz) = data at 100M
RJ-45 Duplex "FDX"	Green	Half Duplex	Full Duplex

Note: DDMI alarm indicates a possible problem with the SFP transceiver installed in the module. SFP transceivers are programmed with alarm thresholds for differentiators and the DDMI alarm indicates a threshold issue.

DIP-SWITCH SETTINGS

The NX Media Converter comes with a default DIP-switches setting (all down) as shown below. It is recommended that these settings are left as default and not changed by the user.

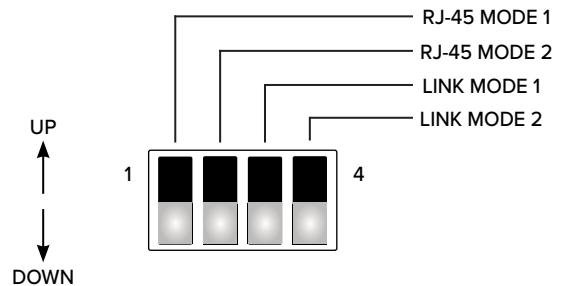

DEFAULT CONFIGURATION MODE FOR DIP-SWITCHES