

Lighting Controls

NXP2 SERIES

NX LIGHTING CONTROL PANEL

DATE:	LOCATION:
TYPE:	PROJECT:
CATALOG #:	



FEATURES

- Meets applicable ASHRAE, IECC and Title 24 energy codes and requirements
- Available in 8, 16, 24, 32 and 48 relay panel sizes
- Operates as standalone panel or NX network device
- Programmable using the Bluetooth® NX Lighting Controls mobile app*
- Matching number of relays and dimming channels
- Integrated NX SmartPORTs™ for connection of NX switches, sensors and accessories
- Optional UL924 emergency control
- Contractor friendly mounting/installation

*Requires NX Radio Bridge with Real Time Clock - included



SPECIFICATIONS

CONSTRUCTION

- Exterior:
 - NEMA 1 Enclosure (Available In surface and flush mount versions)
 - (4) Keyhole mounting holes for mounting to wall
 - Standard electrical knockouts on top, bottom and sides for low voltage and line voltage feeds
 - Hinged locking door
- Interior:
 - Allows for installation of the exterior prior to the addition of the interior electrical components
 - (4) Keyhole mounting holes for mounting to panel exterior
 - Optional metal plate barrier available to separate relays (p/n NXP2-PBAR)
- Panel Dimensions:
 - 08 Relay Panel: 20.7"L x 20.0"W x 4.0"D
 - 16 Relay Panel: 24.6"L x 20.0"W x 4.0"D
 - 24 Relay Panel: 32.6"L x 20.0"W x 4.0"D
 - 32 Relay Panel: 32.6"L x 20.0"W x 4.0"D
 - 48 Relay Panel: 40.4"L x 20.0"W x 4.0"D

ELECTRICAL

- Network Interface
 - Ethernet 10 base-T via NX Networked cable, integral 2-port Ethernet hub

ELECTRICAL (CONTINUED)

- Input Voltages
 - UNV: 120/277VAC (50/60Hz)
 - 347: 347VAC
 - 480: 480VAC
- Relay Operating Voltages
 - Single Pole:
 - General Use: 30A @ 347VAC
 - Tungsten: 1960W @ 120VAC
 - (Standard) Ballast: 10A @ 3470VAC
 - Electronic Ballast: 16A @ 277VAC
 - Motor Starting: 1 HP @ 110-125VAC; 1.5HP @ 220-277VAC
 - Short Circuit Current Rating (SCCR) of 14,000A @ 277VAC
 - Double Pole¹:
 - General Use: 20A @ 347/480VAC
 - Tungsten: 2400W @ 120VAC
 - (Standard) Ballast: 20A @ 347/480VAC
 - Motor Starting: ½ HP @ 110-125VAC; 1.5HP @ 220-277VAC
 - Short circuit Current Rating (SCCR) of 5,000A @ 277VAC
- Relay Electrical Ratings
 - Rated for minimum 60,000+ operations (30,000+ cycles) at full 20A load
 - Rated full-life with HID load

ELECTRICAL (CONTINUED)

- Relay Mechanical Ratings
 - Rated for minimum 120,000+ operations (60,000+ cycles)
- Relay Operation
 - Mechanically latching
 - Provides at-a-glance indication of ON or OFF relay status
 - Includes manual override switch (integral to the relay)
- 0-10V Dimming
 - Available on all panels
 - (8) Integrated dimming channels per Relay-Dimmer Board
 - Each dimming channel capable of sinking 50mA
 - Full support for Dim-to-Off drivers
- Class 2 Low Voltage NX SmartPORTs
 - (4) NX SmartPORTs - 24VDC, 1.2A MAX (all outputs combined)
 - Supports NX switches, sensors (NXOS, NXSMP, NXDS) and accessories²
 - RS485 digital communication
- Class 2 Inputs / Outputs
 - (4) 3-Wire dry contact inputs. Each input provides connection for sourcing 24VDC, common, control and switch pilot light functionality

Lighting Controls

NXP2 SERIES

NX LIGHTING CONTROL PANEL

SPECIFICATIONS (CONTINUED)

ELECTRICAL (CONTINUED)

- Class 2 Inputs / Outputs (Continued):
 - (2) SPDT (Normally Open/Normally Closed) dry contact outputs. Each output rated for 24VDC @ 50mA.
- Terminal Tolerance:
 - Wire size: 14, 16, 18, 20, 22 AWG
 - Recommended tightening torque: 0.45 N-m (4 in-lbs.)
- Optional UL924 Emergency Control⁴
 - Pre-installed at factory
 - When installed, panel is suitable for controlling emergency lighting circuits
 - On loss of normal power, all relays go to closed (ON) position and all dimming channels will go to 100% light output

ELECTRICAL (CONTINUED)

- Bluetooth® Technology
 - Bluetooth programming using the NX Lighting Controls mobile app requires the NX Radio Bridge with Real Time Clock (p/n NXBTC) – Included

OPERATION

- Programming and Configuration
 - Programmable via Bluetooth NX Lighting Controls mobile app (available on Google Play™ and Apple® App Store)



- Programmable via web-browser user interface³

OPERATING ENVIRONMENT

- Indoor use only
- 32° to 112°F (0° to 50°C)
- Relative humidity (non-condensing): 10% to 90%

CERTIFICATIONS

- UL 916, CAN/CSA C22.2 No. 205
- UL 924, CAN/CSA C22.2 No. 141 Emergency Lighting (Requires UL924 Emergency Control Option)

WARRANTY

- 5 year limited

Notes:

- 1 Double pole relays occupy (2) relay spaces
- 2 Connection of NX actuators, bridges and radios is not supported
- 3 Requires NX Area Controller

ORDERING GUIDES

Stocked Panels

Example: NXP2-PNL-16-16-U-S

CATALOG #

Model	
NXP2-PNL-8-0-U-S	NX Lighting Control Panel V2, 8 Relay Capacity, 8 Dimming Channels, Relays Not Included, Bluetooth Radio Bridge With Real Time Clock Included, 120/277VAC, Surface Mount
NXP2-PNL-8-8-U-S	NX Lighting Control Panel V2, 8 Relay Capacity, 8 Dimming Channels, 8-30A/Single Pole Latching Relays, Bluetooth Radio Bridge With Real Time Clock Included, 120/277VAC, Surface Mount
NXP2-PNL-16-0-U-S	NX Lighting Control Panel V2, 16 Relay Capacity, 16 Dimming Channels, Relays Not Included, Bluetooth Radio Bridge With Real Time Clock Included, 120/277VAC, Surface Mount
NXP2-PNL-16-16-U-S	NX Lighting Control Panel V2, 16 Relay Capacity, 16 Dimming Channels, 16-30A/Single Pole Latching Relays, Bluetooth Radio Bridge With Real Time Clock Included, 120/277VAC, Surface Mount
NXP2-PNL-24-0-U-S	NX Lighting Control Panel V2, 24 Relay Capacity, 24 Dimming Channels, Relays Not Included, Bluetooth Radio Bridge With Real Time Clock Included, 120/277VAC, Surface Mount
NXP2-PNL-24-24-U-S	NX Lighting Control Panel V2, 24 Relay Capacity, 24 Dimming Channels, 24-30A/Single Pole Latching Relays, Bluetooth Radio Bridge With Real Time Clock Included, 120/277VAC, Surface Mount
NXP2-PNL-32-0-U-S	NX Lighting Control Panel V2, 32 Relay Capacity, 32 Dimming Channels, Relays Not Included, Bluetooth Radio Bridge With Real Time Clock Included, 120/277VAC, Surface Mount
NXP2-PNL-32-32-U-S	NX Lighting Control Panel V2, 32 Relay Capacity, 32 Dimming Channels, 32-30A/Single Pole Latching Relays, Bluetooth Radio Bridge With Real Time Clock Included, 120/277VAC, Surface Mount
NXP2-PNL-48-0-U-S	NX Lighting Control Panel V2, 48 Relay Capacity, 48 Dimming Channels, Relays Not Included, Bluetooth Radio Bridge With Real Time Clock Included, 120/277VAC, Surface Mount
NXP2-PNL-48-48-U-S	NX Lighting Control Panel V2, 48 Relay Capacity, 48 Dimming Channels, 48-30A/Single Pole Latching Relays, Bluetooth Radio Bridge With Real Time Clock Included, 120/277VAC, Surface Mount

Lighting Controls

NXP2 SERIES

NX LIGHTING CONTROL PANEL

ORDERING GUIDES (CONTINUED)

Custom Panels

Example: NXP2-EIT-48-24SP-12DP-UNV-S

CATALOG #

NXP2								
Model	Panel Shipment	Panel Size	Single Pole Relay Qty	Double Pole Relay Qty	Emergency Control	Input Voltage	Enclosure Mount	
NXP2 NX Lighting Control Panel V2	EIT Enclosure/ Interior Together ¹ EIS Enclosure/ Interior Separately ¹ ENC Enclosure Only INT Interior Only ¹	8 8 Relay/ Dimmer Capacity 16 16 Relay/ Dimmer Capacity 24 24 Relay/ Dimmer Capacity 32 32 Relay/ Dimmer Capacity 48 48 Relay/ Dimmer Capacity	nnSP Single Pole Relay Qty	nnDP Double Pole Relays	Blank No UL924 Control 924 UL924 Panel ²	UNV Universal Voltage (120/277VAC) 347 347VAC 480 480VAC	S Surface Mount F Flush Mount	

Notes:

- 1 Bluetooth Radio Bridge With Real Time Clock included for panel programming
- 2 If ordering a UL924 panel, must order a fully populated interior

Stocked NXP2 Panel Accessories

Example: NXP2-RL-DP

CATALOG #

Model	
NXP2-RL2-SP	Single Pole - General Use: 30A @ 347VAC; Tungsten: 1920W @ 120VAC; (Standard) Ballast: 10A @ 347VAC; Motor Starting: 1HP @ 110-125VAC; 1.5HP @ 220-277VAC
NXP2-RL-DP	Double Pole - General Use: 20A @ 347/480VAC; Tungsten: 2400W @ 120VAC; (Standard) Ballast: 20A @ 347/480VAC; Motor Starting: 1HP @ 110-125VAC; 1.5HP @ 220-277VAC
NXP2-PBAR	NX Lighting Control Panel V2 Relay Channel Barriers – Set of two
NXP2-CNTRLBRD	NX Lighting Control Panel V2 Controller Board Replacement
NXP2-RLYDMRBRD	NX Lighting Control Panel V2 Relay/Dimmer Board Replacement

Lighting Controls

NXP2 SERIES

NX LIGHTING CONTROL PANEL

DIMENSIONS

Sizes	A	B
V2-8	20.7"	17.7"
V2-16	24.6"	21.6"
V2-24	32.6"	29.6"
V2-32	32.6"	29.6"
V2-48	40.4"	37.4"



Surface Mount Panel Dimensions

Note:
1 For Flush Mount Panels, add 2" to A & B dimensions

Lighting Controls

NXP2 SERIES

NX LIGHTING CONTROL PANEL

ADDITIONAL INFORMATION

Panel Interior

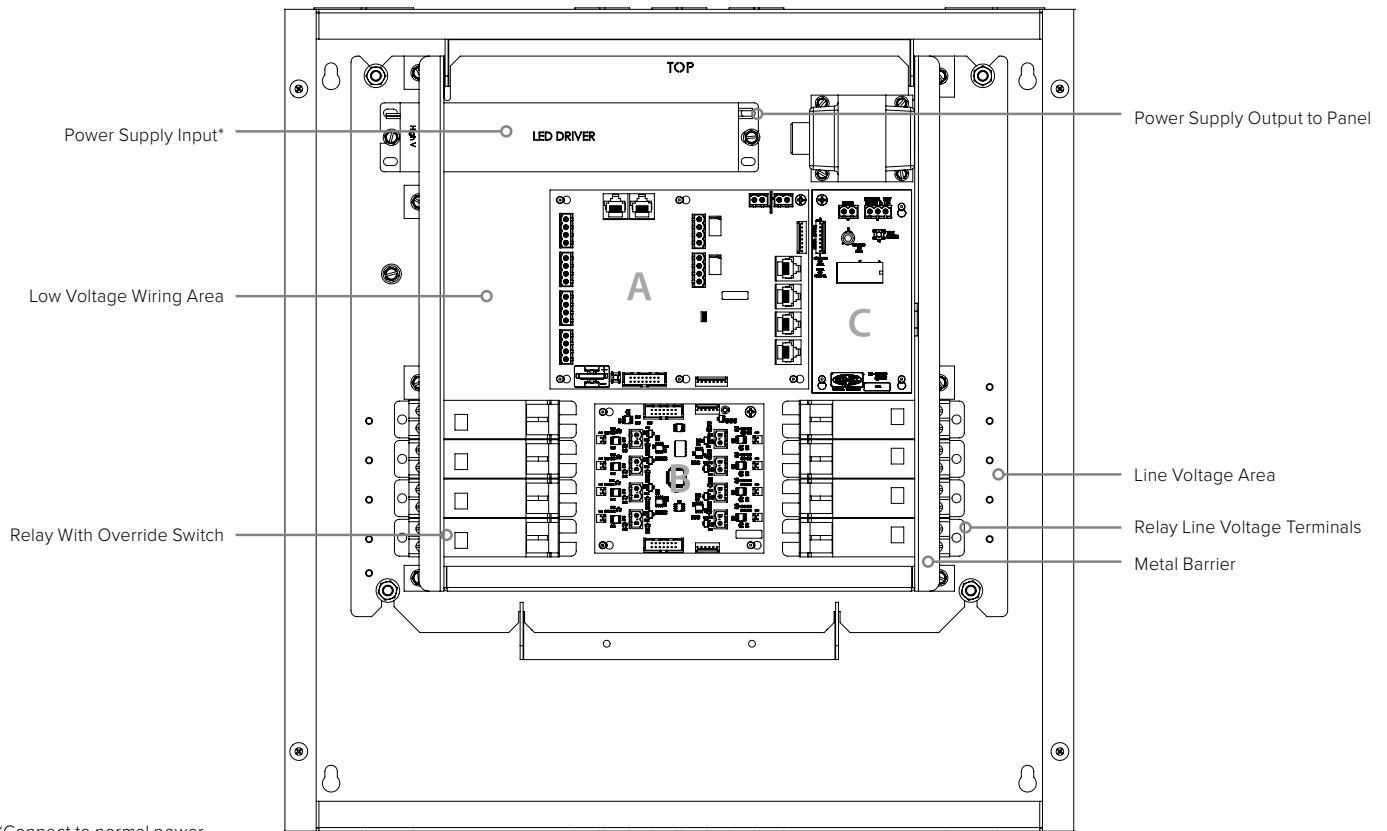

*Connect to normal power source if panel is controlling emergency circuits.

Fully Populated 8 Relay Interior (with UL924 Option Board) Mounted in the Exterior Enclosure

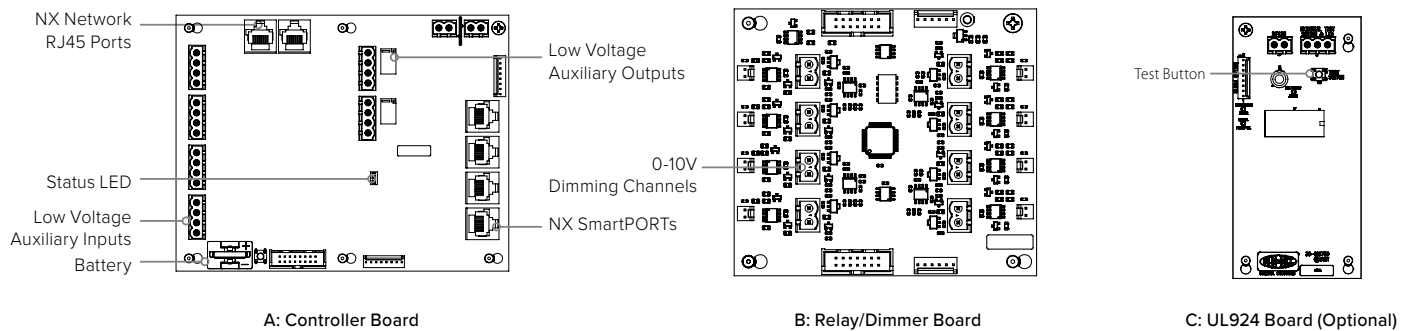

Lighting Controls

NXP2 SERIES

NX LIGHTING CONTROL PANEL

WIRING DIAGRAMS (CONTINUED)

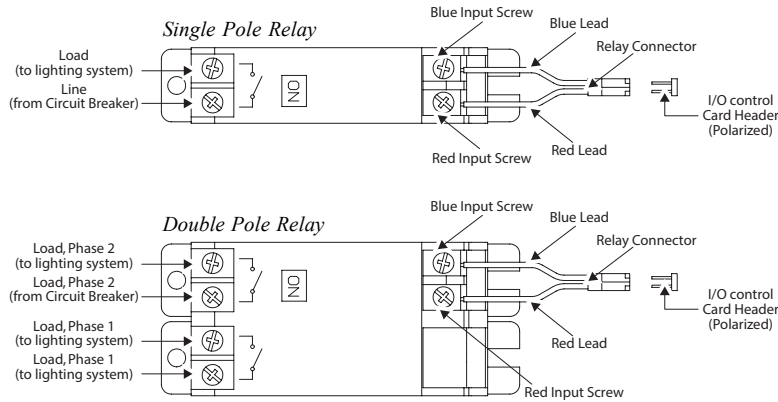

Relay Wiring Diagrams

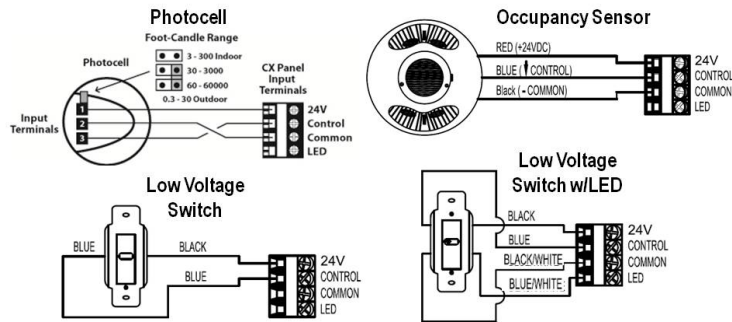

Low Voltage Input Wiring Diagrams

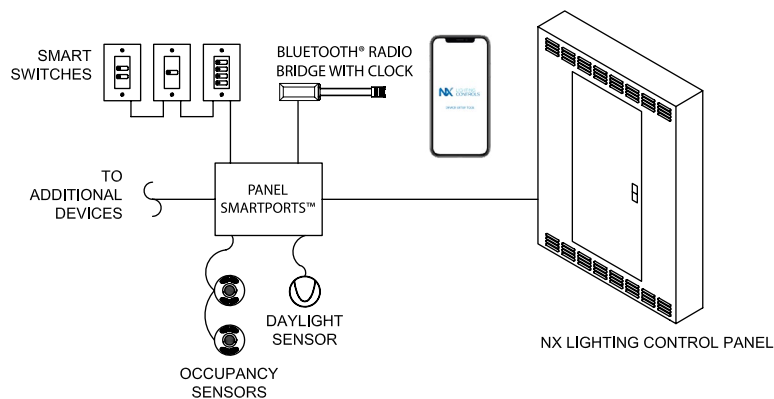

Standalone Panel Programmed Using Bluetooth Radio Bridge with Clock and NX Lighting Controls mobile app

Lighting Controls

NXP2 SERIES

NX LIGHTING CONTROL PANEL

WIRING DIAGRAMS (CONTINUED)

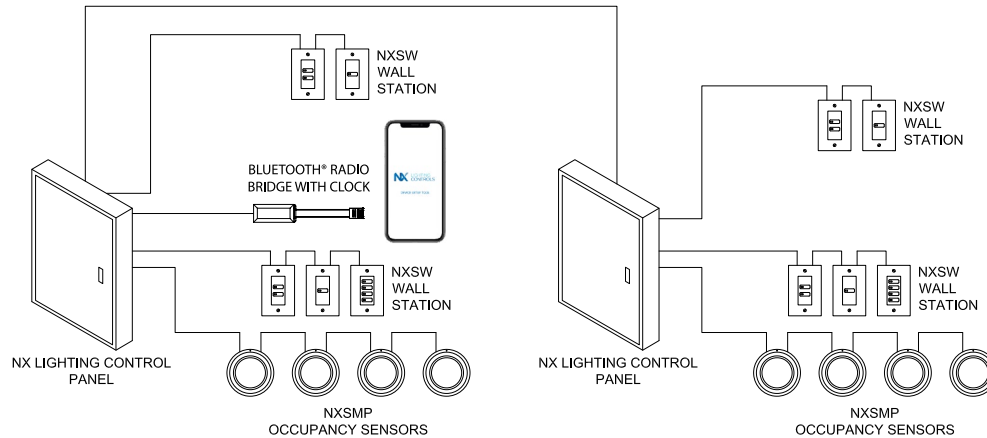

Networked Panels Programmed Using Bluetooth Radio Bridge with Clock and NX Lighting Controls mobile app

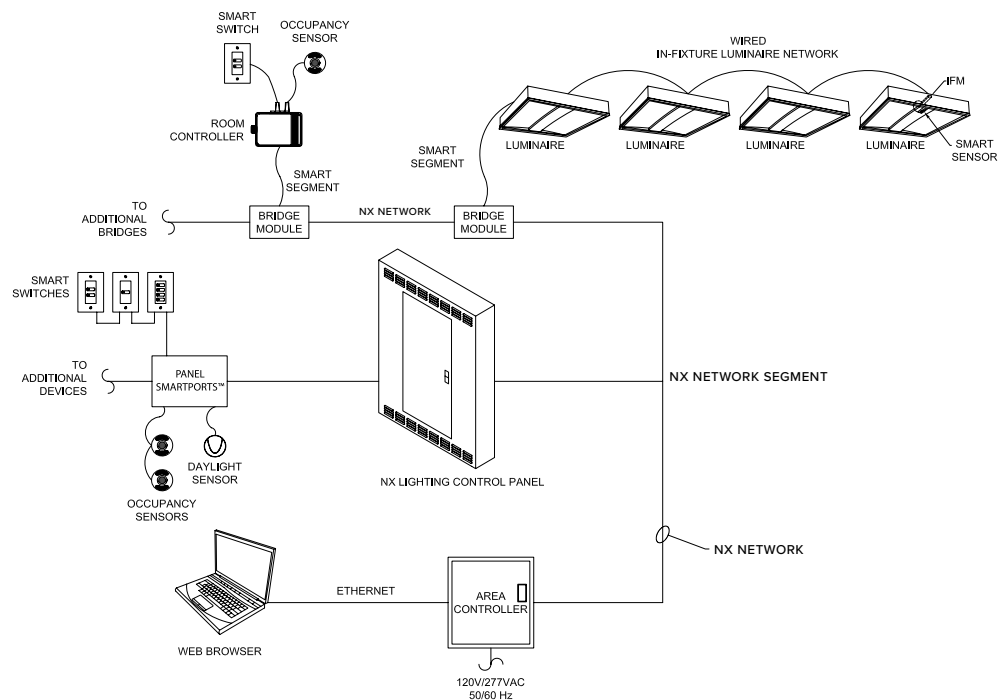

Networked Panel Programmed Using the NX Area Controller