

4L-RW-D

MOD™ 4 LED RECESSED WALL DIRECT

| | |
|------------|-----------|
| DATE: | LOCATION: |
| TYPE: | PROJECT: |
| CATALOG #: | |

FEATURES

- Variable Intensity technology provides a range of specifiable outputs and resulting fixture wattages
- 2 SDCM color consistency
- TriGain® Technology provides superior color quality without compromising efficacy. The 4L-RW-D series delivers 90 CRI at 122 LPW



CONTROLS TECHNOLOGY



SPECIFICATIONS

CONSTRUCTION

- Housing constructed from die-formed and welded steel with wiring knockouts in top
- End caps constructed from die-formed steel.

OPTICAL PERFORMANCE

- 2 SDCM color consistency, 90 CRI
- SOF: Soft diffuse acrylic lens
- ASYM: Asymmetric Highly transmissive diffuse acrylic lens with linear prisms
- BAT: "Batwing" distribution created from highly transmissive diffuse acrylic lens with linear prisms

INSTALLATION

- PT Mounting: Continuous spackle trim with beaded edge welded to housing. Spackle trim allows plaster coat up to fixture edge for clean ceiling appearance
- 90° Wall to Ceiling Mounting configurations available. Fixtures provided with special end caps with knockouts that allow for conduit (by others) to be run from wall to ceiling fixtures. C90L, C120L, C135L pattern configurations not available for ceiling to wall intersection

ELECTRICAL

- Variable Intensity (VI) technology allows precise specification of fixture output/wattage. Fixture will be programmed and labeled to specification. Indirect and direct hemispheres can be independently specified
- LED boards and drivers can be accessed and removed from fixture, while installed
- Entire LED module can be removed and replaced
- 1C (1 Circuit) Fixture wired for a single circuit
- Emergency Battery: 10W battery powered driver. Provides a minimum of 90 minutes of emergency lighting. Inverter-Compatible. Provided by others. Available in 4'+ fixtures
- Current's patented TriGain® phosphor delivers 90 CRI color quality at 80 CRI efficacy

CONTROLS

- Sensors install between diffusers
- NX Lighting Controls provides options for standalone and networked integrated sensor with wired or wireless connectivity for NX system deployments
- SpectraSync™ Color Tuning Technology: Control your space based on the needs of the application, specific activities throughout the day and preferences of the occupants

MOD[™]X

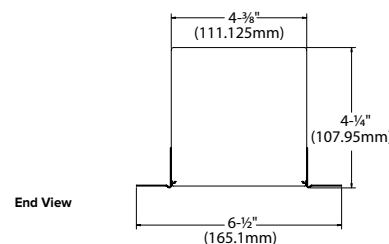

| | Weight |
|---------|----------|
| 4L-RW-D | 3 lbs/ft |

CERTIFICATIONS

- CSA listed for damp location
- IBEW
- AF of L
- UL924
- This product meets federal procurement law requirements under the Buy American Act (FAR 52.225-9) and Trade Agreements Act (FAR 52.225-11). See [Buy America\(n\) Solutions](#).
- Emergency Battery Backup options are California Energy Commission (CEC) Title 20 Compliant.

WARRANTY

- LED boards - 5 years
- LED drivers (standard) - 5 years
- LED drivers (Lutron) - 3 years

| KEY DATA | |
|------------------------|--------------|
| Lumen Range Per Foot | D: 300–1250 |
| Wattage Range Per Foot | 2.5–11.2 |
| Efficacy Range (LPW) | 112–122 |
| Rated Life (Hours) | L90: >60,000 |

4L-RW-D

MOD™ 4 LED RECESSED WALL DIRECT

| | |
|------------|-----------|
| DATE: | LOCATION: |
| TYPE: | PROJECT: |
| CATALOG #: | |

ORDERING GUIDE

Example: 4L-PT-WDC-8-4-.3-.3-08-SOF-C1-27K9-D030-D01-1C-UNV

CATALOG #

| 4L | Series | Mounting | Fixture Distribution | Wall Length (In Feet) | Ceiling Length (In Feet) | Wall Length Adder | Ceiling Length Adder | Max Length in Row |
|--------|--------|---|--------------------------------------|--------------------------------|--------------------------------|--|--|--|
| 4L MOD | PT | Drywall with plaster trim (trimless finish) | WDC Direct WCAD Asymmetric Direct | ___'W Enter in foot increments | ___'C Enter in foot increments | .3 Wall length +3" .6 Wall length +6" .9 Wall length +9" Measured in Inches | .3 Wall length +3" .6 Wall length +6" .9 Wall length +9" Measured in Inches | 02 2', 609 mm 03 3', 914 mm 04 4', 1219 mm 05 5', 1524 mm 06 6', 1829 mm 08 8', 2438 mm |

| Direct Optical Distribution | Finish/Color ³ | Color Temperature | Direct Output/ft ⁶ | Driver | Circuiting |
|--|--|---|--|---|--------------|
| SOF Soft Diffuse Lens, Lambertian ASYM Asymmetric Diffuse Lens ^{1,2} BAT Batwing Lens | C1 Matte White (Default) C2 Textured Matte White C3 Light Silver C4 Machined Aluminum C5 Carbon Black C6 Textured Camera Black CC Custom Color | 27K9 2700K, 90 CRI ⁴ 30K9 3000K, 90 CRI 35K9 3500K, 90 CRI 40K9 4000K, 90 CRI 50K9 5000K, 90 CRI ⁴ 2230TD 2200K–3000K SpectraSync™ Dim-to-Warm ^{4,5} 2765T 2700K–6500K SpectraSync™ Tunable White ^{4,5} | D030 300 (min) ⁷ to D125 1250 (max) | D01 1% Dimming, 0–10V D00 1% Dim-to-Off, 0–10V D05 SpectraSync 5% Dimming, 0–10V ⁸ DS1 1% Dimming w/ Soft Start, 0–10V DS0 1% Dim-to-Off w/ Soft Start, 0–10V LEC Hi-lume 1% Ecosystem LED Driver ⁴ DALI DALI ⁴ DALIP Powered by DALI (2.0) ⁴ NDM Non-Dimming | 1C 1 Circuit |

OPTIONAL

| Voltage | Nightlight | Emergency | Thru-wiring | Patterns ^{4,12} | Chicago Environmental Air Modification |
|--|---|--|--|---|---|
| UNV Universal Voltage (120V through 277V) 347 347 Volt ^{4,9} | NL Nightlight Circuit Required. Enter quantity. 2NL = 2 nightlight circuits/row | EF 10W Emergency Battery Pack. Enter quantity. 2EF = 2 emergency batteries/row. (CEC Title 20 Compliant) ¹⁰ | W1 No Thru Wire W2 Provide Normal and Emergency/ Nightlight Thru Wiring ¹¹ W3 Provide Normal Thru Wiring Only | C90L Illuminated 90° Corner C120L Illuminated 120° Corner C135L Illuminated 135° Corner | CCEA Chicago Environmental Air Modification |

- Notes:
- Not Available with Patterns.
 - Must be ordered with WCAD.
 - Visit currentlighting.com/litecontrol for details.
 - Additional lead time may be applicable. Contact factory.
 - Must be ordered with D05 Driver option; excludes 2' lengths and patterns.
 - Specifiable in 50 lumen increments. Reference the Performance Data Table for full performance offering and exceptions.
 - D030 not available in 2'
 - Must be ordered with 2230TD or 2765T option
 - Excludes Emergency Battery Pack 'EF' Option. Excludes DALI, DALIP and Lutron (LEC) Dimming Drivers
 - EF - 10W battery powered driver. Provides a minimum of 90 minutes of emergency lighting. Inverter-Compatible. Provided by others.
 - Only applicable when specified with Emergency/Nightlight.
 - Contact Factory for pattern configurations. Approval drawings required.
- NX In-Fixture Control Options:**
- Not available for row mounting. Only available with 0–10V Driver options. Contact factory for Length restrictions.
 - Refer to NX Integrated Controls Reference Table for Functionality of Options.

Control Options⁴

NX Networked – Wired

- NXE NX Wired Dual RJ45 SmartPORTS, without Sensor^{13,14}
 NXERM NX Wired Dual RJ45 SmartPORTS and Integral NXSMP2-LMI PIR Occupancy Sensor with Automatic Dimming Photocell and Bluetooth® Programming^{13,14}

NX Networked – Wireless

- NXWRM NX Networked Wireless Enabled Integral NXSMP2-LMI PIR Occupancy Sensor with Automatic Dimming Photocell and Bluetooth® Programming^{13,14}
 NXW NX Networked Wireless Radio Module NXRM2 and Bluetooth® Programming, without Sensor^{13,14}

Sensors

- SD1 Daylight Sensor Required. Enter quantity. 2SD1 = 2 daylight sensors/row
 SO1 Occupancy Sensor Required. Enter quantity. 2SO1 = 2 occupancy sensors/row
 SZ1 Zigbee Radio Module Required. Enter quantity. 2SZ1=2 radio modules/row. Radio controls up to 10 drivers. Must be ordered with D00.

4L-RW-D

MOD™ 4 LED RECESSED WALL DIRECT

| | |
|------------|-----------|
| DATE: | LOCATION: |
| TYPE: | PROJECT: |
| CATALOG #: | |

CONTROLS OPTIONS AND FUNCTIONALITY



| | Control Option Ordering Logic & Description | Control Option Functionality | | | | | | | | | | Control Option Components |
|-------------|---|------------------------------|-------------|----------|------------|------------------|---------------------|---------------|----------------|------------------------------------|---------------|---------------------------|
| | | Sensor | Networkable | Grouping | Scheduling | Occupancy/Motion | Daylight Harvesting | 0-10V Dimming | On/Off Control | Bluetooth® App Programming | Sensor Height | |
| NX Wired | NXE NX Wired Dual RJ45 SmartPORTS, without Sensor | N/A | ✓ | ✓ | ✓ | - | - | ✓ | ✓ | Requires NXBTC dongle ¹ | - | NXDSP |
| | NXERM NX Wired Dual RJ45 SmartPORTS and Integral NXSMP2-LMI PIR Occupancy Sensor with Automatic Dimming Photocell and Bluetooth® Programming | NXSMP2-LMI | ✓ | ✓ | ✓ | ✓ | ✓ | ✓ | ✓ | ✓ | Max: 12' | NXSMP2-LMI NXDSP |
| NX Wireless | NXWRM NX Networked Wireless Enabled Integral NXSMP2-LMI PIR Occupancy Sensor with Automatic Dimming Photocell and Bluetooth® Programming | NXSMP2-LMI | ✓ | ✓ | ✓ | ✓ | ✓ | ✓ | ✓ | ✓ | Max: 12' | NXSMP2-LMI |
| | NXW NX Networked Wireless Radio Module NXRM2 and Bluetooth® Programming, without Sensor | N/A | ✓ | ✓ | ✓ | - | - | ✓ | ✓ | ✓ | - | NXRM2-H |

¹ NXBTC needs to be plugged into an available NX SmartPort™ on the fixture network

4L-RW-D WITH NXWRM WIRELESS CONTROL OPTION

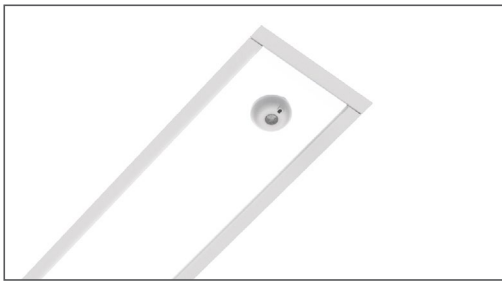

CONTROLS TECHNICAL SUPPORT

1-800-888-8006 (7:00 am–7:00 pm est)

APP INFORMATION

NX Lighting Controls App



The NX Lighting Controls App is a free to use mobile application for programming both an NX Lighting Controls System or Standalone Bluetooth Sensors. The mobile app allows you to configure devices, discover and setup wireless enabled luminaires and program your NX system settings.



Android



Apple iOS

NX Connect App



The NX Connect mobile App is a free to use mobile application for programming a NX Connect System. The mobile App allows you to discover, configure and share your NX Connect system.



Apple iOS

4L-RW-D

MOD™ 4 LED RECESSED WALL DIRECT

| | |
|------------|-----------|
| DATE: | LOCATION: |
| TYPE: | PROJECT: |
| CATALOG #: | |

CONTROLS OPTIONS AND FUNCTIONALITY (CONTINUED)

SpectraSync™ Color Tuning Technology:

Control your space based on the needs of the application, specific activities throughout the day and preferences of the occupants with distinct SpectraSync™ Color Tuning Technologies.



| SPECTRASYNCH COLOR TUNING TECHNOLOGY | | |
|--------------------------------------|--------------|--|
| Mode | Kelvin Range | Description |
| Dim to Warm | 2200K–3000K | Mimics the familiar warming effect that occurs with traditional incandescent sources as they are dimmed |
| Tunable White | 2700K–6500K | Offers users the ability to tailor CCT to their personal preference, enhancing task visibility, material and colors or the aesthetics of the space |
| Scheduled White | 2700K–6500K | Mimics the rhythm of natural light or follows an alternative user-defined schedule throughout the day, enhancing an occupant's mood and well-being |

SpectraSync Tunable White

Available in 2765T (2700K–6500K). Requires two 0–10V controllers, one for intensity and one for CCT. Minimum 5% dimming.

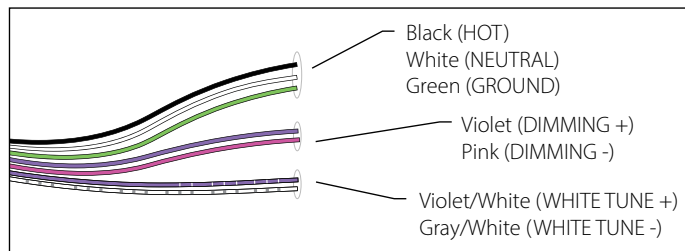

SpectraSync Tunable White luminaires are provided with two 0–10V circuits. The violet and pink circuit is for wiring to any qualified 0–10V controller for dimming. The violet/white and gray/white circuit is for wiring to any qualified 0–10V controller for Tunable White CCT control.

Controller Manufacturer Data

SpectraSync Tunable White was designed to be used with sinking style dimmers (provided by others) and is compatible with:

- Current: NX Lighting Controls Room Controllers (NXRC) and In-fixture Controllers (NXFM)
- Lutron: DDTV, DVSTV, and NDTV dimmers
- Wattstopper: ADF120277 and CD4BL (Titan) dimmers

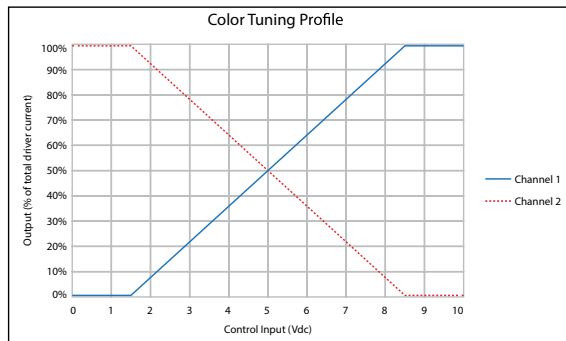

PERFORMANCE DATA TABLE

The table below shows the delivered lumens for the various lumen outputs. Use this chart in connection with the output multiplier capability to deliver any output required.

| Nomenclature | Lumens/Ft | W/Ft | Efficacy |
|--------------|-----------|------|----------|
| Downlight | | | |
| D030 (min) | 300 | 2.5 | 120 |
| D050 | 500 | 4.1 | 122 |
| D075 | 750 | 6.2 | 120 |
| D125 | 1250 | 10.2 | 122 |

(wattage may vary up to 5% from published)

Output Multiplier Table

Photometrics for the MOD Family are published here at a nominal 3500K temperature. This table may be used to approximate the lumen values at different Kelvin temperatures. Power consumption would stay the same.

| Option | 2700K 90 CRI | 3000K 90 CRI | 3500K 90 CRI | 4000K 90 CRI | 5000K 90 CRI |
|--------|--------------|--------------|--------------|--------------|--------------|
| SOF | 0.89 | 0.96 | 1.00 | 1.00 | 0.99 |
| REG | 0.69 | 0.74 | 0.77 | 0.77 | 0.76 |
| BWO | 0.62 | 0.67 | 0.70 | 0.70 | 0.69 |
| ASYM | 0.89 | 0.96 | 1.00 | 1.00 | 0.99 |
| BAT | 0.89 | 0.96 | 1.00 | 1.00 | 0.99 |
| DRP | 0.89 | 0.96 | 1.00 | 1.00 | 0.99 |
| LPAD | 0.80 | 0.86 | 0.90 | 0.90 | 0.89 |

DIMENSIONS

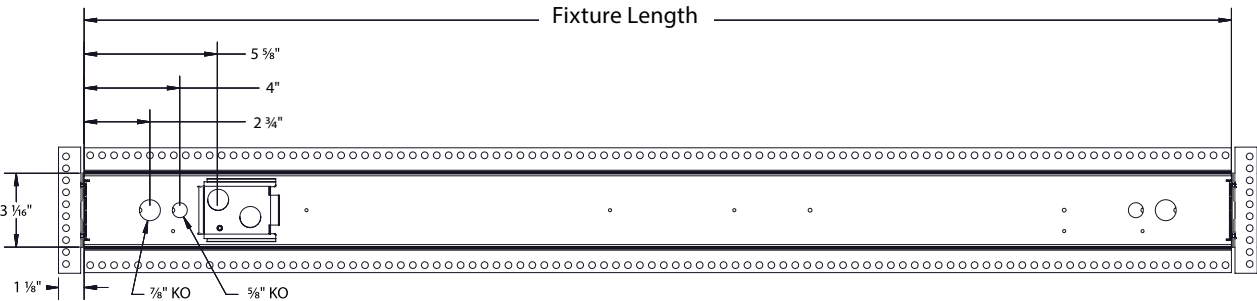

INDIVIDUAL MOUNTING

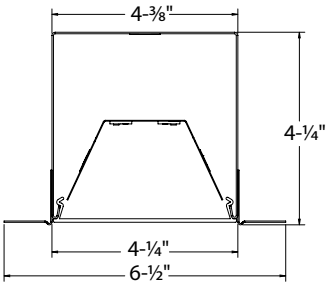

4L-PT

END CAP VIEW

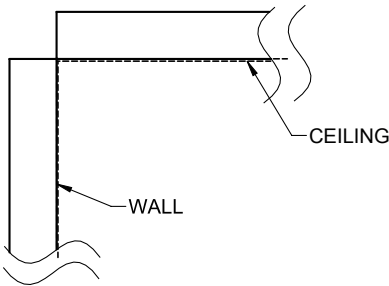

PATTERNS

PHOTOMETRY CONTINUED

4L-R-D-04-SOF-CX-35K9-D075

| | |
|------------------|----------------------|
| LUMINAIRE DATA | |
| Description | MOD 4L Linear Direct |
| Delivered Lumens | 3000 |
| Watts | 25 |
| Efficacy | 120 |
| Mounting | Recessed |

| ZONAL LUMEN SUMMARY | | |
|---------------------|---------|-------------|
| Zone | Lumens | % Luminaire |
| 0-40 | 1423.75 | 47.50 |
| 0-60 | 2419.07 | 80.60 |
| 0-90 | 2999.9 | 100.0 |
| 0-180 | 2999.9 | 100.0 |

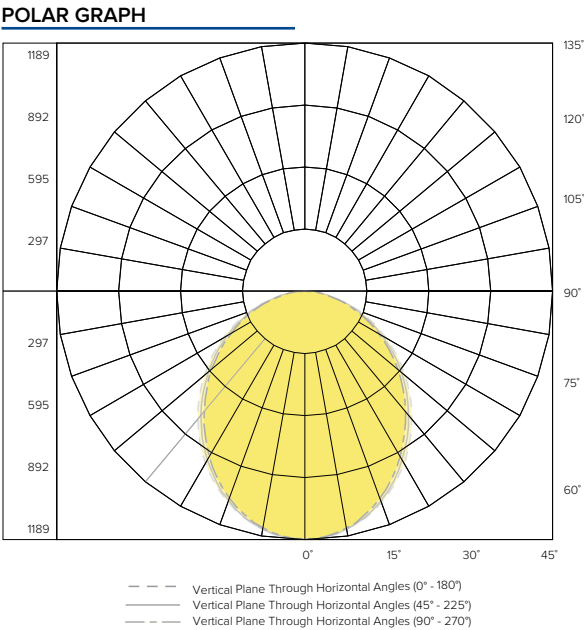

TM-30 DATA

COLOR VECTOR GRAPHIC

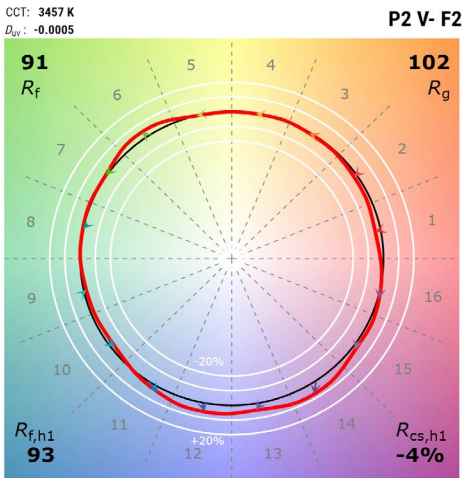

*Graphics shown are at 35K
— Reference Illuminant — Test Source

4L-RW-D

MOD™ 4 LED RECESSED WALL DIRECT

| | |
|------------|-----------|
| DATE: | LOCATION: |
| TYPE: | PROJECT: |
| CATALOG #: | |

ADDITIONAL INFORMATION

Driver

| | |
|-------|---|
| D01 | 100%–1% dimming range. Fixture will be wired for low voltage 0–10V dimming control. |
| D00 | Dim-to-Off 100%–1% dimming range. Fixture will be wired for low voltage 0–10V dimming control. |
| D05 | 100%–5% dimming range. Fixture will be wired for low voltage 0–10V dimming control. Only applicable if either 2230TD, 2750T or 2765T is selected. |
| DS1 | Soft-Start 100%–1% dimming range. Fixture will be wired for low voltage 0–10V dimming control. |
| DS0 | Soft-Start Dim-to-Off 100%–1% dimming range. Fixture will be wired for low voltage 0–10V dimming control. |
| LEC | Hi-Lume 1% EcoSystem LED Driver with Soft-On, Fade-to-Black dimming technology. |
| DALI | DALI compatible. |
| DALIP | Self-Powered DALI bus (e.g. DEXAL) |
| NDM | Non-dimming. Fixture will be wired for fixed light output. |

Rated Life

Tested in accordance to LM79-2008 & derived from EPA TM-21 calculator

L70: 280,000 (calculated per TM-21 extrapolated curve)

L70: >61,000 (reported per TM-21/LM80 6x's limitation)

L90: 72,000 (calculated per TM-21 extrapolated curve)

L90: >61,000 (reported per TM-21/LM80 6x's limitation)

Rated Life (Driver)

Standard = 100,000 hours

Lutron = 50,000 hours