

DATE:	LOCATION:
TYPE:	PROJECT:
CATALOG #:	

FEATURES

- Variable Intensity technology provides a range of specifiable outputs and resulting fixture wattages
- 2 SDCM color variation
- 4", 5" or 6" aperture wall grazer
- 10 color temperature choices
- Available with optional Luminance Control Deflector (LCD)



SPECIFICATIONS

CONSTRUCTION

- Fixture Housing: Steel
- Ends provided with hole to accommodate wiring
- Supplied with external brackets for row mounting
- Aluminum LED module rests in housing
- Fixture Support Rail: Extruded aluminum wall-mounted rail that provides fixture support and, along with provided splines, ensures fixture alignment
- Provides reveal at wall to compensate for wall construction irregularities

OPTICAL PERFORMANCE

- 2 SDCM color consistency, 80 or 90 CRI

INSTALLATION

- Fixture system must be installed prior to installation of ceiling
- Finish of wall should extend 7" above finished ceiling height

ELECTRICAL

- 1C (1 Circuit) fixture wired for a single circuit
- LED boards and drivers can be accessed and removed from fixture, while installed

CERTIFICATIONS

- CSA listed for damp locations
- IBEW
- AF of L
- IC Rated
- This product qualifies as a "designated country construction material" per FAR 52.225-11 Buy American-Construction. Materials under Trade Agreements effective 8/14/2020. Not applicable with configurations including SpectraSync, NX Lighting Controls, or sensors.

WARRANTY

- LED boards - 5 years
- LED drivers (standard) - 5 years
- LED drivers (Lutron) - 3 years

KEY DATA	
Lumen Range Per Foot	300-950
Wattage Range Per Foot	2.6-9.4
Efficacy Range (LPW) Per Foot	101-119
Rated Life (Hours) Per Foot	L70: >61,000 L90: 49,000

60L

WALL/SLOT® 6000 LED

DATE:	LOCATION:
TYPE:	PROJECT:
CATALOG #:	

ORDERING GUIDE

Example: 60L-G-24-8-C1-35K-D095-D01-1C-UNV-2SE

CATALOG #

60L					
Series	Ceiling Type	Row Length (In Feet)	Max Length In Row	Finish/Color ²	Color Temperature
60L Wall/Slot® 6000 LED	PT Plaster Trim G Grid	___' Enter in foot increments ¹	2 2', 610mm 3 3', 914mm 4 4', 1219mm 6 6', 1829mm 8 8', 2438mm	C1 Matte White	27K 2700K ³ 30K 3000K 35K 3500K 40K 4000K 50K 5000K ³ 27K9 2700K, 90 CRI ³ 30K9 3000K, 90 CRI 35K9 3500K, 90 CRI 40K9 4000K, 90 CRI 50K9 5000K, 90 CRI ³
LS60L Litespeed Wall/Slot® 6000 LED					

Output/ft ⁴	Driver	Circuiting	Voltage	Straight Run Termination
D030 300 (min) to D095 950 (max)	D01 1% Dimming, 0-10V D00 Dim-to-Off DS1 Soft Start 1% Dimming DS0 Soft-Start Dim-to-Off (1%) LEC Hi-lume 1% Ecosystem LED Driver DALI DALI ³ DALIP Powered by DALI (2.0) ³ NDM Non Dimming	1C 1 Circuit	UNV Universal Voltage (120V through 277V) 347 347 Volt ^{3,7}	EC End Cap. Enter quantity. SE Straight Extension, 2"-12". Enter quantity

OPTIONAL

Luminance Control Deflector	Patterns	Nightlight	Thru-wiring	Chicago Environmental Air Modification
LCD Luminance Control Deflector	PTRN Contact factory for pattern configuration ⁵	NL Nightlight Circuit Required. Enter quantity. 2NL = 2 nightlight circuits/row	W1 No Thru Wire W2 Provide Normal and Emergency/Nightlight Thru Wiring ⁶ W3 Provide Normal Thru Wiring Only	CCEA Chicago Environmental Air Modification

Notes:

- Note Max Length In Row. 200' max for LITESPEED orders.
- Visit currentlighting.com/litecontrol for details.
- Additional lead time may be applicable. Contact factory.
- Specifiable in 50 lumen increments. Reference the Performance Data Table for full performance offering and exceptions.
- Approval drawings required.
- Only applicable when specified with Emergency/Nightlight.
- Excludes LEC, DALI, and DALIP Dimming Drivers.

PERFORMANCE DATA TABLE

The table below shows the delivered lumens for the various lumen outputs and beam distributions. Use this chart in connection with the output multiplier capability to deliver any output required.

NOMENCLATURE	LUMENS/FT	WATTAGE/FT	EFFICACY
D030*	300	2.6	114
D035*	350	2.9	119
D040	400	3.5	114
D045	450	4.0	114
D050	500	4.4	114
D055	550	5.0	110
D060	600	5.4	111
D065	650	6.0	108
D070	700	6.6	106
D075	750	7.0	107
D080	800	7.6	105
D085	850	8.2	103
D090	900	8.8	102
D095	950	9.4	101

(Wattage may vary up to 5% from published)

*D030 and D035 not available in 2ft

Output Multiplier Table

Photometrics for the 60L are published here at a nominal 3500K temperature. This table may be used to approximate the lumen values at different Kelvin temperatures. Power consumption would stay the same.

Option	2700K	3000K	3500K	4000K	5000K	2700K 90 CRI	3000K 90 CRI	3500K 90 CRI	4000K 90 CRI	5000K 90 CRI
Multiplier	0.95	0.98	1.00	1.03	1.05	0.83	0.85	0.88	0.90	0.93
LCD Multiplier	0.86	0.88	0.90	0.93	0.95	0.75	0.77	0.79	0.81	0.84

DIMENSIONS

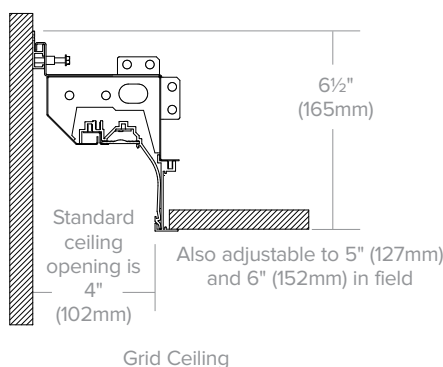
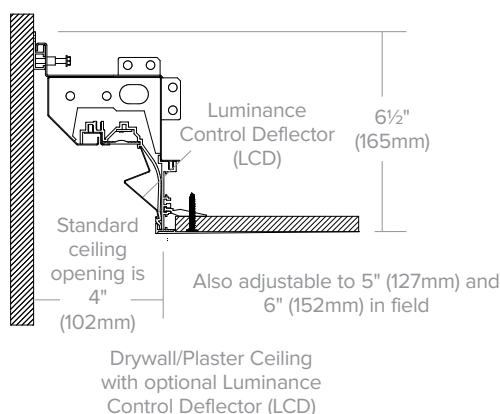

60L
WALL/SLOT® 6000 LED

DATE: LOCATION:
TYPE: PROJECT:
CATALOG #:

DIMENSIONS CONTINUED

Adjustable Ceiling Opening

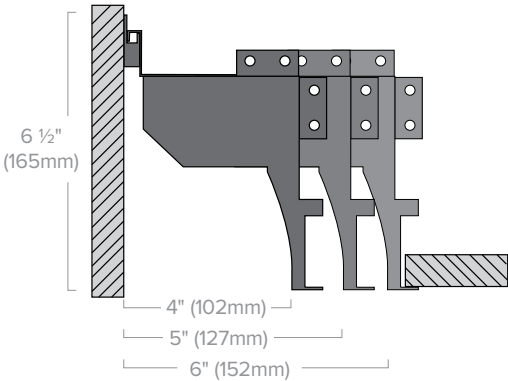

Ceiling Type (Specify the Applicable Ceiling)

PT Plaster Trim

Accommodates a range of drywall thicknesses: 1/2", 3/4", 5/8" and 1".

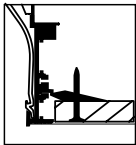

G Grid

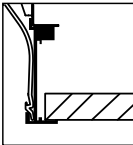

Patterns

Plan View

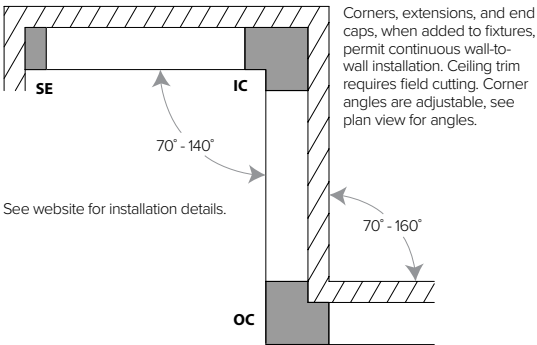

Connector Details

Table with 3 columns: Connector, Ceiling Opening, and Extension or Corner Dimensions. It lists dimensions for SE (Straight Extension), IC (Inside Corner), and OC (Outside Corner) for 4", 5", and 6" ceiling openings.

PHOTOMETRY

60L-G-04-C1-35K-DXX-D01-1C-UNV-W1

LUMINAIRE DATA

Test No.	19.01099
Description	4' Wall/Slot 3500K
Delivered Lumens	5726
Watts	56.6W
Efficacy	101.2
Mounting	Wall/Slot
Spacing Criterion	1.39

ZONAL LUMEN SUMMARY

Zone	Lumens	% Luminaire
0-40	3212	56.1
0-60	4599	80.3
0-90	5455	95.3
0-180	5726	100.0

POLAR GRAPH

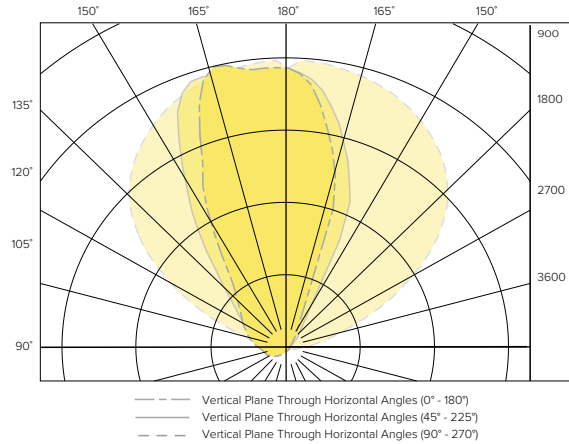

60L-G-04-C1-35K-DXX-D01-1C-UNV-LCD-W1

LUMINAIRE DATA

Test No.	19.01089
Description	4' Wall/Slot 3500K with LCD
Delivered Lumens	5126
Watts	56.6W
Efficacy	90.6
Mounting	Wall/Slot
Spacing Criterion	1.38

ZONAL LUMEN SUMMARY

Zone	Lumens	% Luminaire
0-40	2305	45.0
0-60	3567	69.6
0-90	4576	89.3
0-180	5126	100.0

POLAR GRAPH

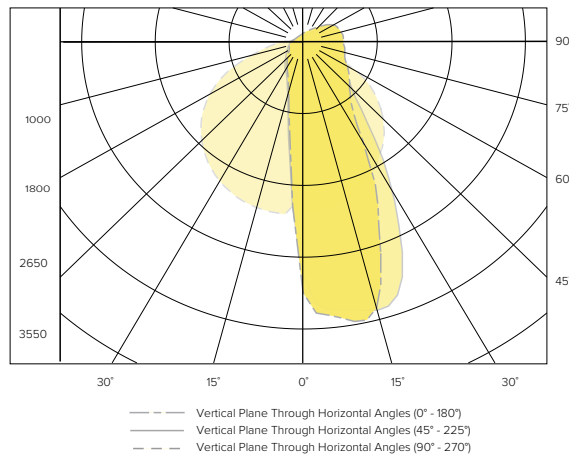

TM-30 DATA

COLOR VECTOR GRAPHIC

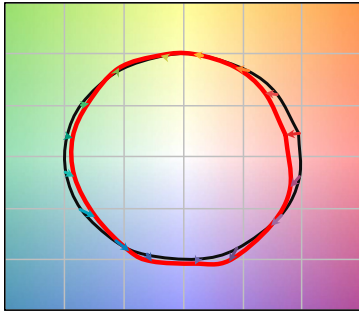

*Graphics shown are at 35K

— Reference Illuminant — Test Source

COLOR DISTORTION GRAPHIC



TEST RESULTS - 3500K	
Value	80+ CRI
CCT (K)	3644
CIE R _a	83
D _{UV}	-0.0006
R _f	82
R _g	95
x	0.3970
y	0.3851

ADDITIONAL INFORMATION

Output (VI Technology)

Variable Intensity (VI) technology allows precise specification of fixture output/wattage. Fixture will be programmed and labeled to specification. See output section for available increments.

Driver

D01	100%- 1% dimming range. Fixture will be wired for low voltage 0-10V dimming control.
D00	Dim-to-Off 100%-1% dimming range. Fixture will be wired for low voltage 0-10V dimming control.
DS1	Soft-Start 100%-1% dimming range. Fixture will be wired for low voltage 0-10V dimming control.
DS0	Soft-Start Dim-to-Off 100%-1% dimming range. Fixture will be wired for low voltage 0-10V dimming control.
LEC	Hi-Lume 1% EcoSystem LED Driver with Soft-On, Fade-to-Black dimming technology.
DALI	DALI compatible.
DALIP	Self-Powered DALI bus (e.g. DEXAL)
NDM	Non-dimming. Fixture will be wired for fixed light output.

Luminance Control Deflector:

Shields LEDs from direct view and minimizes shadows on wall. Shield can be installed either during or after fixture installation without tools - output multiplier (.9)

Rated Life

Test in accordance to the LM79-2008 and derived from EPA TM-21 calculator

L70: >61,000 (reported per TM-21/LM80 6x's limitation)

L90: 49,000 (reported per TM-21/LM80 6x's limitation)

Fixture Weight

5.5 lbs/ft.