

TCB2 - Wooden Pole Clamp for 2 Fixtures

Mounting Accessory

DESCRIPTION

Wall and Pole Mount for 6" to 12" Diameter Wooden Pole for 2 fixtures with 2 3/8" knuckle mounting.

DIMENSIONS & WEIGHT	
Fixture Mount ID	2.375"
Fixture Mount OD	2.5"
Weight	20 lbs.

MOUNTING INSTRUCTIONS

- Insert 1/2-13 threaded rod (2) into one side of TCB assemble bracket (1).
- Install washer (4) and nut (5) to one end of rod. Do not tighten.
- Slide TCB bracket (3) onto threaded rod.
- Install washer (4) and nut (5) to other end of rod. Do not tighten.
- Repeat steps 1-4 until all brackets are mounted together.
- Secure brackets to diameter of pole by tightening all nuts (5).

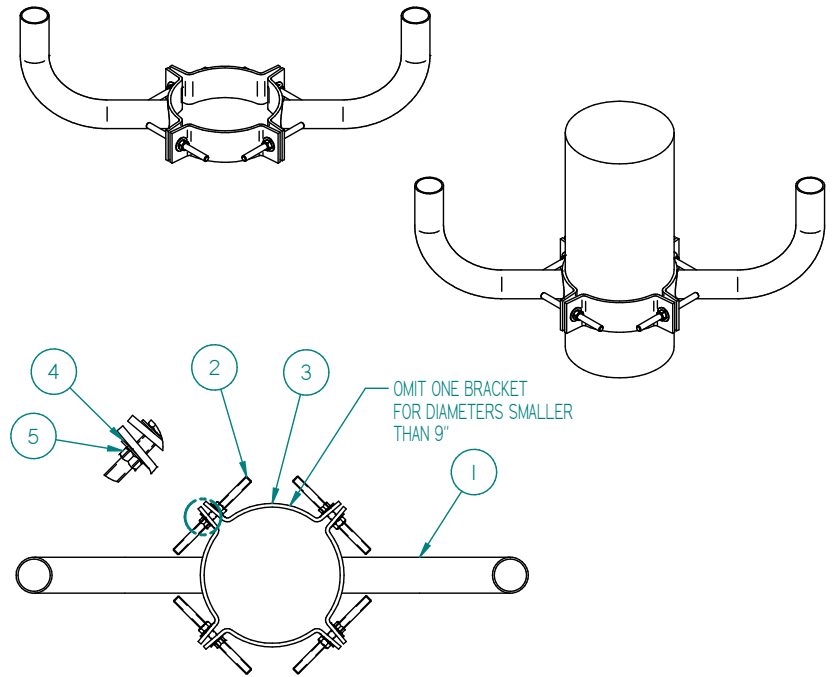

STANDARD FINISH COLORS & MATERIAL

- Steel
- Powder Coat Paint Finish

ORDERING GUIDE

CATALOG # Example: TCB2-BLT

ORDERING INFORMATION

Series	Color
TCB2 Wooden Pole Clamp for 2 Fixtures	BLT Black Matte Textured BLS Black Gloss Smooth DBT Dark Bronze Matte Textured DBS Dark Bronze Gloss Smooth GTT Graphite Matte Textured LGS Light Grey Gloss Smooth LGT Light Grey Matte Textured PSS Platinum Silver Smooth WHT White Matte Textured WHS White Gloss Smooth VG Verde Green Textured CC Custom Color

SHIPPING PACKAGE CONTENTS	
Qty	Description
2	TCB Bracket Assembly
2	TCB Bracket
4	1/2-13 Threaded Rod - 16 Nut
8	1/2 Flat Washer
8	1/2 Nut
Weight	20 lbs.