

# NOR-3.5R

NONI 3.5" ROUND RECESSED FAMILY

DATE: \_\_\_\_\_ LOCATION: \_\_\_\_\_

TYPE: \_\_\_\_\_ PROJECT: \_\_\_\_\_

CATALOG #: \_\_\_\_\_

## FEATURES

- Downlight (two styles), Lensed Wall Wash (two styles), Adjustable Accent
- ¼" overlap microflange and flangeless trims featuring CorrectCut
- Cast aluminum, magnetically-attached reflectors with applied finishes
- Interchangeable primary optics for Downlight and Adjustable Accent
- New Construction Non-IC, IC & Chicago Plenum applications
- Up to 2000 delivered lumens @ 80 CRI 3000K
- 90 CRI (27, 30, 35, 40K); 80 CRI (30, 35K)
- Dynamic white options (18–30K Dim-to-Warm, 27–65K Tunable White)

*Noni*™



## CONTROLS



## SPECIFICATIONS

### HOUSING CONSTRUCTION

- Formed 22GA steel housing, finished matte black. New Construction (NHN) housing thermally protected. Insulation must be 3" away from housing. New Construction IC (NHI) inherently protected for direct contact with insulation installation
- Removable cover plates on housing side and bottom for j-box inspection
- Downlight (DL) & Shallow Lensed Wall Wash (LWS) feature ultra shallow 2" deep housing. Integral j-box has (4) 7/8" knock-outs
- Adjustable Accent (AA) & Deep Lensed Wall Wash (LWD) utilize 3 3/8" deep housing. Integral j-box has (6) 7/8" knock outs
- Universal adjustable mounting brackets accept 0.5" EMT conduit or 1.5" or 0.75" lathing channel (by others)
- Optional Residential Mounting Bars (RMB) extend from 16–24"
- CorrectCut design is a rolled sheet metal edge which serves as a cutting guide for installers. Provides fixed cutout outer diameter which ensures reliable flange coverage and clean, finished appearance. *KV-exclusive*
- LED protection plate pre-installed from factory
- Control options require above ceiling access

### TRIM CONSTRUCTION

- Reflector assembly includes reflector collar & reflector insert. Both cast aluminum, matte finish. Can be mixed/matched as desired. Insert attaches to collar via magnets. Gasket centers insert and prevents light leak

### TRIM CONSTRUCTION (CONTINUED)

- ¼" overlap flange. Thickness measures .047"
- Ceiling thickness range 5/8"- 1¼". Two Downlight trim ceiling thickness options available: Shallow (DS) optimized for 5/8" ceiling (compatible up to & including 1 1/8"). Deep (DD) optimized for 1¼" ceiling (compatible with 1¼" only)
- Flangeless (FT) mud-in ring is low profile, die-cast featuring an edge to plaster up to. Ring attaches to ceiling and comes with removable protective plug installed at factory

### OPTICS

- Static white fixtures feature low profile, high efficiency polycarbonate TIR primary optics for (DL) and (AA) functions
- All dynamic white fixtures feature optical grade silicone lens
- Optics installed and serviceable from below through housing aperture
- Media holder included standard. Accepts 1 reflector accessory. Matte black finish, reduces visual brightness at top of trim
- Adjustable Accent (AA) lockable hot-aim 0°–40° vertical tilt, 362° horizontal rotation. Features translating center beam at finished ceiling plane (5/8")
- Two wall wash options, both optimized for 18" spacing off-wall with 2:1 spacing. LWD optic provides industry-leading horizontal uniformity near top-of-wall. LWS optic provides excellent vertical uniformity in ultra shallow housing

### ELECTRICAL

- Integral LED module and driver are field serviceable from below through housing aperture
- Chip-on-board LED. 2 SDCM CCT consistency for static white options. 3 SDCM consistency for Dynamic options
- Static White and Dim to Warm LED rated life L85 @ 55,000 hours (TM-21). Tunable White LED rated life L70 @ 50,000 hours (TM-21)
- Integral solid state constant current dimming driver. 1% and Dim-to-Dark options for 0–10V, ELV and TRIAC controls. NX or Lutron Vive control options available
- Drivers are UL Class 2, inherent short circuit and overload protection. RoHS compliant

### CERTIFICATIONS

- cULus certified to UL 1598
- Suitable for wet locations
- Hexcel Louver (HEX) and No Lens (NON) suitable for damp locations.
- City of Chicago Environmental Air (CCEA / CP)
- Install in environments where ambient temperature does not exceed 25°C

### WARRANTY

- 5 year warranty

KEY DATA	
Wattages	25, 17, 10
Beam Spreads	25, 30, 35, 50, 75
SDCM	2
Rated Life	L85 @ > 55,000 Hours

# NOR-3.5R

NONI 3.5" ROUND RECESSED FAMILY

## ORDERING GUIDE

Examples: NOR-3.5RDL-NHN17-930K-MD-DMINU / NOR-3.5RDS-TRM-FWHS-RBL-SOL

CATALOG # \_\_\_\_\_

### HOUSING

NOR-3.5R		Housing		Output	CRI/CCT	Beam Spread <sup>5</sup>
Series	Function					
NOR-3.5R Noni Recessed 3.5" Round	<b>Shallow Housing (2" Depth)</b>	<b>NHN</b>	New Construction, Non-IC	<b>10</b> 10 Watt <b>17</b> 17 Watt	<b>Static</b> <b>927K</b> 90 CRI, 2700K <b>930K</b> 90 CRI, 3000K <b>935K</b> 90 CRI, 3500K <b>940K</b> 90 CRI, 4000K <b>830K</b> 80 CRI, 3000K <b>835K</b> 80 CRI, 3500K  <b>Dynamic</b> <b>1830DT</b> 90 CRI, 1800K–3000K Dim-to-Warm <sup>1,2,3</sup> <b>2765T</b> 90 CRI, 2700K–6500K SpectraSync™ Tunable White <sup>1,2,3,4</sup>	<b>VN</b> Very Narrow (.42 SC / 25°) <b>NR</b> Narrow (.50 SC / 30°) <b>MD</b> Medium (.58 SC / 35°) <b>WD</b> Wide (.80 SC / 50°) <b>XW</b> Extra Wide (1.06 SC / 75°) <sup>6</sup> <b>LW</b> Lensed Wall Wash <sup>7</sup>
	<b>DL</b>	Downlight	<b>NHI</b>	New Construction, IC <sup>1</sup>		
	<b>LWS</b>	Lensed Wall Wash, Shallow	<b>CP</b>	Chicago Plenum <sup>1</sup>		
	<b>Deep Housing (3" Depth)</b>					
	<b>LWD</b>	Lensed Wall Wash, Deep				
	<b>AA</b>	Adjustable Accent				

Dimming		Controls <sup>13</sup>		U	Accessories	
				Voltage		
<b>DM1</b>	0–10V 1% <sup>8, 14, 15</sup>	<b>N</b>	None	<b>U</b>	<b>RMB</b> Residential Mounting Bars	
<b>PDM</b>	ELV, TRIAC 1% <sup>8, 14</sup>	<b>LV</b>	Lutron Vive 0–10V (120–277V)	<b>U</b>		Universal Voltage (120–277V)
<b>ERP</b>	0–10V, ELV, TRIAC Dim-to-Dark <sup>8, 15</sup>	<b>LVE</b>	Lutron Vive EcoSystem (120V Only)			
<b>PEQ0E</b>	Lutron Hi-Lume Premier 0.1%	<b>NXE</b>	NX Dual RJ45 SmartPORTS, without Sensor <sup>15</sup>			
<b>SpectraSync</b>		<b>NXW</b>	NX Networked Wireless Radio Module NXRM2 and Bluetooth Programming, without Sensor <sup>15</sup>			
<b>DMT</b>	0–10V 5% <sup>4</sup>					

### TRIM

NOR-3.5R		TRM	Reflector Flange Color	Reflector Insert Color	Lens	
Series	Function	Trim				
NOR-3.5R Noni Recessed 3.5" Round	<b>Shallow Housing Compatible</b>	<b>TRM</b> Trim	<b>Flanged</b>	<b>Texture</b>	<b>SOL</b> Solite <sup>9</sup> <b>CLR</b> Clear <sup>9</sup> <b>FRS</b> Frosted <sup>10</sup> <b>LIN</b> Linear Spread (10 x 40°) <sup>9, 11</sup> <b>HEX</b> Hexcel Louver <sup>9, 12</sup> <b>NON</b> No Lens <sup>9, 11</sup>	
	<b>DS</b>		Downlight, Shallow (¾"–1½" ceiling)	<b>RWH</b>		White
	<b>DD</b>		Downlight, Deep (1¼" ceiling only)	<b>RGY</b>		Gray
	<b>LWS</b>		Lensed Wall Wash, Shallow	<b>RBL</b>		Black
	<b>Deep Housing Compatible</b>		<b>RGT</b>	Graphite		
	<b>LWD</b>		Lensed Wall Wash, Deep	<b>RPP</b>		Pink Panache
	<b>AA</b>		Adjustable Accent	<b>RGH</b>		Grasshopper
			<b>Smooth</b>			
			<b>Flangeless</b>			
			<b>FT</b>	Flangeless		<b>RWHS</b>
				<b>RGYS</b>	Gray	
				<b>RBLS</b>	Black	
				<b>RCOS</b>	Copper	
				<b>RAMW</b>	Anti-Microbial White	
				<b>Other</b>		
				<b>RX</b>	Custom Finish	

- Notes:
- Available in 10 or 17 watt outputs
  - NHN housing only
  - Available with NR or LW optic only
  - DMT driver must be selected for use with 2765T
  - DL and AA performance based on SOL lens with RWHS insert finish
  - Available only with FRS lens
  - Available only when LW functions selected
  - Not available with LVE control
  - Not available with LW function
  - Available with all functions. Must be selected with LW
  - Available with DS only
  - Wet location not suitable for HEX or NON
  - Above ceiling access required
  - Only available in 17 or 25 watt outputs
  - DM1 or ERP required with NX options

# NOR-3.5R

NONI 3.5" ROUND RECESSED FAMILY

## PERFORMANCE DATA

Performance data provided below based on 80 CRI, 3000K with White reflector and Solite lens. Extra Wide (XW) and Lensed Wall Wash (LWS, LWD) performance includes White reflector and Frosted lens.

Output	Beam Spread	Beam	Delivered Lumens	Efficacy	Spacing Criterion	Candela @ 0°
25 Watt	Very Narrow (VN)	25	2033	80	0.42	8414
	Narrow (NR)	30	1964	78	0.50	6056
	Medium (MD)	35	1846	73	0.58	4200
	Wide (WD)	50	2021	80	0.80	2711
	Extra Wide (XW)	75	1598	63	1.06	1133
17 Watt	Very Narrow (VN)	25	1535	89	0.42	6311
	Narrow (NR)	30	1483	86	0.50	4542
	Medium (MD)	35	1394	81	0.58	3150
	Wide (WD)	50	1526	88	0.80	2033
	Extra Wide (XW)	75	1206	70	1.06	850
10 Watt	Very Narrow (VN)	25	953	93	0.42	3929
	Narrow (NR)	30	921	90	0.50	2828
	Medium (MD)	35	866	85	0.58	1961
	Wide (WD)	50	948	93	0.80	1266
	Extra Wide (XW)	75	749	73	1.06	529

Output		Delivered Lumens	Efficacy	Max Candela
25 Watt	Wall Wash, Shallow (LWS)	1280	51	773
	Wall Wash, Deep (LWD)	1306	52	1223
17 Watt	Wall Wash, Shallow (LWS)	967	56	587
	Wall Wash, Deep (LWD)	986	57	929
10 Watt	Wall Wash, Shallow (LWS)	600	59	364
	Wall Wash, Deep (LWD)	612	60	576

# NOR-3.5R

NONI 3.5" ROUND RECESSED FAMILY

## MULTIPLIER TABLE

CRI, CCT	927	930	935	940	830	835	1830TD	2765T			
	0.83	0.86	0.87	0.87	1.0	1.02	0.46	0.55*			
Media	SOL	CLR	LIN	HEX	FRS	NON	*Multiplier value based on 4600K.				
	1.0	1.02	0.95	0.76	0.78	1.12					
Output	10 Watt	17 Watt	25 Watt								
	0.47	0.76	1.0								
Finishes	RWH	RGY	RBL	RGT	RPP	RGH	RWHS	RGYS	RGBLS	RCOS	RAMW
	1.0	0.9	0.85	0.85	0.8	0.8	1.02	0.95	0.9	0.8	1.05

## ELECTRICAL DATA

	DM1	PDM	ERP	PEQ0E	DMT
Dimming Protocols Supported	0–10V	ELV, TRIAC	0–10V, ELV, TRIAC	Lutron Hi-Lume Premier 0.1%	0–10V
Input Voltage	120–277V	120–277V	120–277V	120–277V	120–277V
Input Frequency	50/60 Hz	50/60 Hz	50/60 Hz	50/60 Hz	50/60 Hz
Dim Level	20W <1% 17W <5%	1%	1% Dim-to-Dark	0.1% Dim-to-Dark	17W <5%
Power Factor (PF)	≥0.90	≥0.90	≥0.90	0.95 Typical	≥0.90
Total Harmonic Distortion (THD)	<20%	<20%	<20%	15% Typical	<20%
Inrush Current	NEMA 410 Limit	NEMA 410 Limit	NEMA 410 Limit	NEMA 410 Limit	NEMA 410 Limit
Electromagnetic Interference (EMI) Filtering	FCC CFR Title 47 Part 15 Class B	FCC CFR Title 47 Part 15 Class B	FCC CFR Title 47 Part 15 Class B at 120Vac, Class A at 277Vac	Contact Lutron	FCC CFR Title 47 Part 15 Class B
Transient Surge Protection	IEEE C62.41.1-2002 & C62.41.2-2002 Category A	IEEE C62.41.1-2002 & C62.41.2-2002 Category A	IEEE C62.41.1-2002 & C62.41.2-2002 Category A	Contact Lutron	IEEE C62.41.1-2002 & C62.41.2-2002 Category A

# NOR-3.5R

NONI 3.5" ROUND RECESSED FAMILY

DATE: \_\_\_\_\_ LOCATION: \_\_\_\_\_

TYPE: \_\_\_\_\_ PROJECT: \_\_\_\_\_

CATALOG #: \_\_\_\_\_

## DIMENSIONS

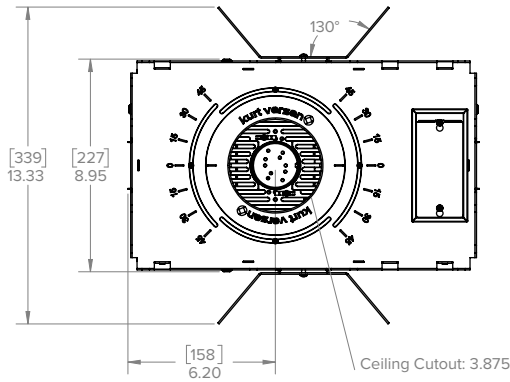

Housing

### Shallow Housing (DL, LWS)

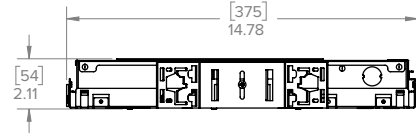

### Deep Housing (LWD, AA)

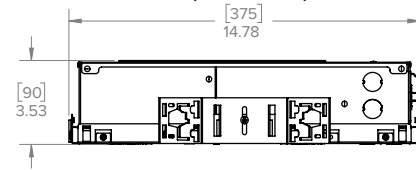

### Flange

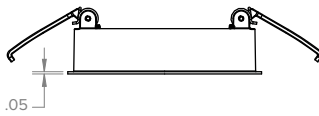

### Flangeless (FT)



### Flangeless (FT) with Downlight, Shallow (DS)

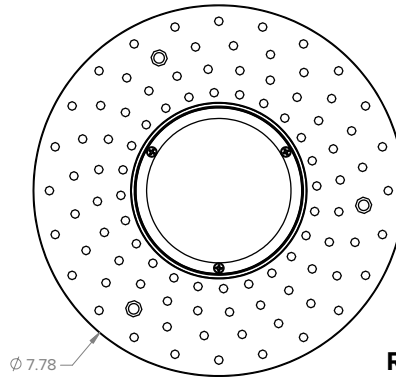
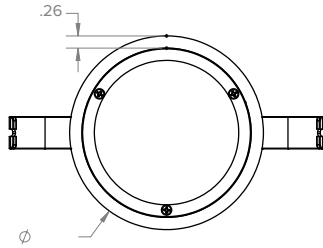
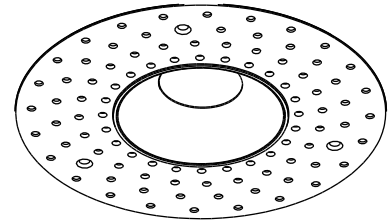

Reflector Collar

### Downlight (DS)

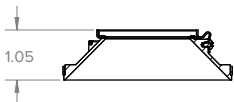

### DownLight, Deep (DD)

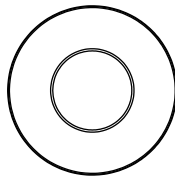

### Lensed Wall Wash Shallow (LWS)

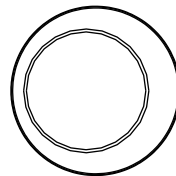
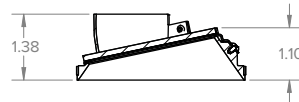

### Lensed Wall Wash Deep (LWD)

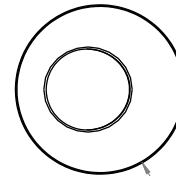
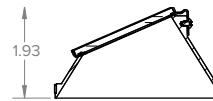

### Adjustable (AA)

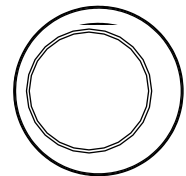
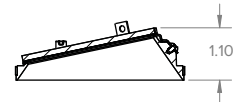

Reflector Insert