

# Flow 91L

3" WET LOCATION PENDANT, WALL,  
OR SURFACE DIRECT

## FEATURES

- Wet location application.
- Sections can be joined for continuous runs.
- Pendant, Surface, and Wall mounting available.
- Variable Intensity technology provides a range of specifiable outputs and resulting fixture wattages.
- 1500 lumens/ft max. See performance data table on page 3 for additional information.
- TriGain® Technology provides superior color quality without compromising efficacy.

# FLOW

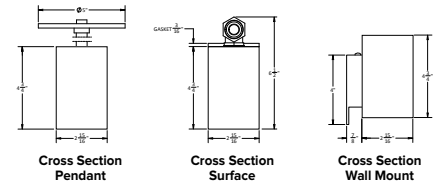
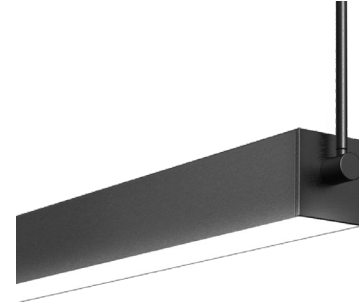

	Weight
91L-PWS-3	4 lbs/ft

## SPECIFICATIONS

### CONSTRUCTION

- 2.9" x 4.8" profile with 2.4" aperture (nominal).
- Extruded aluminum housing with machined aluminum end headers
- Machined aluminum end caps mechanically attached with no exposed fasteners
- Closed-cell silicon gasketing

### OPTICS

- 3 SDCM CCT consistency, 80 CRI.
- Soft diffuse extruded acrylic downlight diffuser.
- Glass lens not available.

### ELECTRICAL

- Variable Intensity (VI) technology allows precise specification of fixture output/wattage. Fixture will be programmed and labeled to specification.
- LED boards and solid state constant current driver are field-servicable.

### ELECTRICAL (CONTINUED)

- LED rated life L90 > 60,000 hours. Tested in accordance to LM79-2008 & rated life derived from EPA TM-21 calculator.
- 1C (1 Circuit) Fixture wired for a single circuit
- 2C (2 Circuit) Two power feeds required.
- 10W battery powered driver. Provides a minimum of 90 minutes of emergency lighting. Available in fixtures greater than 3' in length.
- Inverter-Compatible. Provided by others.
- Operating Temperature: -30 to 50°C

### INSTALLATION

- Pendant mount option requires suspension at every row joint.
- Surface mount available as direct distribution only.

### CERTIFICATIONS

- ETL listed for wet locations
- IBEW
- AF of L
- This product meets federal procurement law requirements under the Buy American Act (FAR 52.225-9) and Trade Agreements Act (FAR 52.225-11). See [Buy America\(n\) Solutions](#).
- Emergency Battery Backup options are California Energy Commission (CEC) Title 20 Compliant.

### WARRANTY

- LED boards - 5 years
- LED drivers (standard) - 5 years

KEY DATA	
Lumen Range	350-1200
SDCM	3
Rated Life	L90 > 60,000 Hours
Efficacy	92-109

# Flow 91L

3" WET LOCATION PENDANT, WALL,  
OR SURFACE DIRECT

## ORDERING GUIDE

**Example:** 91L-W-D-3-STD-12-06-SOF-C5-35K-D100-D01-1C-UNV-WM

CATALOG #

91L	Series	Mounting	Distribution	Aperture	Row Length (In Feet)	Max Length in Row	Diffuser
91L	Flow	<b>P</b> Pendant <b>S</b> Surface <sup>1</sup> <b>W</b> Wall	<b>D</b> Direct	<b>3</b> 3"	____' Enter in foot increments	<b>02</b> 2', 609mm <b>03</b> 3', 914mm <b>04</b> 4', 1219mm <b>05</b> 5', 1524mm <b>06</b> 6', 1828mm <b>08</b> 8', 2438mm	<b>SOF</b> Soft Diffuse Lens, Lambertian

Finish/Color	CCT/CRI	Direct Output/Ft <sup>3</sup>	Driver	Circuiting	Voltage
<b>C1</b> Matte White (Default)	<b>30K</b> 3000K, 80CRI	<b>D035</b> 350 (Min) to	<b>D01</b> 1% Dimming, 0-10V	<b>1C</b> 1 Circuit	<b>UNV</b> 120-277V
<b>C4</b> Machined Aluminum	<b>35K</b> 3500K, 80CRI	<b>D120</b> 1200 (Max)		<b>2C</b> 2 Circuit	
<b>C5</b> Carbon Black	<b>40K</b> 4000K, 80CRI				
<b>CC</b> Custom Color					

Optional			
<b>Mounting Kit</b> <b>Pendant</b> <b>H72</b> 72" Pendant <sup>8</sup> <b>Wall</b> <b>WM</b> Standard Wall Mount	<b>Nightlight</b> <b>NL</b> Nightlight Circuit Required <sup>4</sup>	<b>Emergency</b> <b>EF</b> 10W Emergency Battery Backup (CEC Title 20 Compliant) <sup>5</sup>	<b>Thru-Wiring</b> <b>W1</b> No Thru-Wire <b>W2</b> Provide Normal and NL/EF Thru-Wiring <sup>6</sup> <b>W3</b> Provide Normal Thru-Wiring Only

Notes:

- <sup>1</sup> For surface mount, leave mounting kit blank.
- <sup>2</sup> Specifiable in 50 lumen increments. Reference the Performance Data Table for full performance offering and exceptions.
- <sup>3</sup> Specifiable in 50 lumen increments. Reference the Performance Data Table for full performance offering and exceptions.
- <sup>4</sup> Enter Quantity. 2NL= 2 Nightlight circuits per row.
- <sup>5</sup> Enter Quantity. 2EF= 2 Batteries per row. 10W battery powered driver. Provides a minimum of 90 minutes of emergency lighting. Inverter Compatible. Provided by others.
- <sup>6</sup> Only applicable when specified with Emergency/Nightlight
- <sup>7</sup> Contact Factory for pattern configurations. Not available for pendant mount application. Additional lead time may be applicable Approval drawings required.
- <sup>8</sup> Only ships with 5" canopies.

# Flow 91L

3" WET LOCATION PENDANT, WALL,  
OR SURFACE DIRECT

## PERFORMANCE DATA TABLE

The table below shows the delivered lumens for the various lumen outputs. Use this chart in connection with the output multiplier capability to deliver any output required

Distribution/Output	Lumens/Ft	W/Ft	Efficacy
<b>Direct</b>			
D035	350	3.9	89
D040	400	4.4	90
D045	450	4.9	92
D050	500	5.4	92
D055	550	6.0	93
D060	600	6.5	94
D065	650	7.1	92
D070	700	7.7	91
D075	750	8.3	91
D080	800	8.9	90
D085	850	9.6	89
D090	900	10.4	88
D095	950	11.0	87
D100	1000	11.7	86
D105	1050	12.5	85
D110	1100	13.3	83
D115	1150	14.1	82
D120	1200	14.9	81

*(wattage may vary up to 5% from published)*

### Output Multiplier Table

Photometrics and outputs published on this spec sheet are based on nominal 3500K temperature. This table may be used to approximate the lumen values at different Kelvin temperatures. Power consumption would stay the same.

CCT	80 CRI
3000K	0.98
3500K	1
4000K	1.03

# Flow 91L

3" WET LOCATION PENDANT, WALL,  
OR SURFACE DIRECT

## DIMENSIONS

### 91L-PWS-3

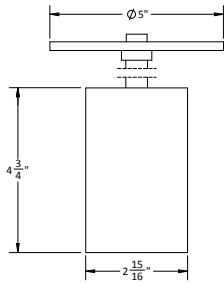

Cross Section  
Pendant

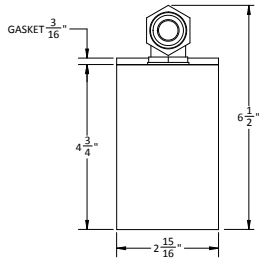

Cross Section  
Surface

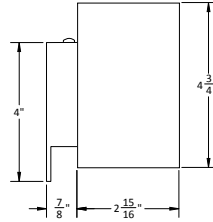

Cross Section  
Wall Mount