

Flow 91L

4" WET LOCATION RECESSED
DIRECT

FEATURES

- Wet location application
- Sections can be joined for continuous runs
- Variable Intensity technology provides a range of specifiable outputs and resulting fixture wattages
- 1350 lumens/ft max. See performance data table on page 3 for additional information.



FLOW

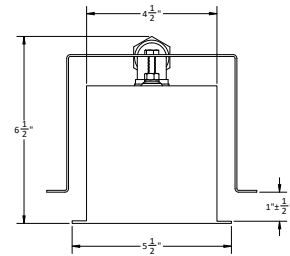
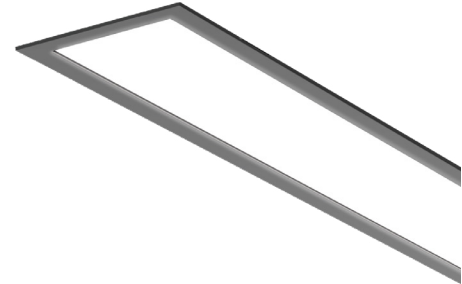

Cross Section

SPECIFICATIONS

CONSTRUCTION

- 4.5" x 4.8" profile with 4" aperture (nominal).
- Integral 1/2" drywall flange
- Extruded aluminum housing with machined aluminum end headers
- Machined aluminum end caps mechanically attached with no exposed fasteners
- Closed-cell silicon gasketing

OPTICS

- 3 SDCM CCT consistency, 80 CRI.
- Soft diffuse extruded acrylic downlight diffuser.
- Glass lens not available

ELECTRICAL

- Variable Intensity (VI) technology allows precise specification of fixture output/wattage. Fixture will be programmed and labeled to specification.
- LED boards and solid state constant current driver are field-servicable.
- LED rated life L85 > 50,000 hours. Tested in accordance to LM79-2008 & rated life derived from EPA TM-21 calculator.
- 1C (1 Circuit) Fixture wired for a single circuit

ELECTRICAL (CONTINUED)

- 10W battery powered driver. Provides a minimum of 90 minutes of emergency lighting. Available in fixtures greater than 3' in length.
- Inverter-Compatible. Provided by others.
- Operating Temperature: -20 to 25°C

INSTALLATION

- Integral side rails allow installation into drywall slot. Visible flange is located on all 4 sides of fixture.

CERTIFICATIONS

- ETL listed for wet locations
- IC Rated
- IBEW
- AF of L
- This product meets federal procurement law requirements under the Buy American Act (FAR 52.225-9) and Trade Agreements Act (FAR 52.225-11). See [Buy America\(n\) Solutions](#).
- Emergency Battery Backup options are California Energy Commission (CEC) Title 20 Compliant.

	Weight
91L-R-4	4 lbs/ft

WARRANTY

- LED boards - 5 years
- LED drivers (standard) - 5 years

KEY DATA	
Lumen Range	350-1350
SDCM	3
Rated Life	L85 > 50,000 Hours
Efficacy	113-124

Flow 91L

4" WET LOCATION RECESSED
DIRECT

ORDERING GUIDE

Example: 91L-DW-D-4-STD-16-08-SOF-C1-35K-D060-D01-1C-UNV

CATALOG #

91L Series	Mounting	Distribution	Aperture	Row Length (In Feet)	Max Length in Row	Diffuser
91L Flow	DW Drywall	D Direct	4 4"	_____ ' Enter in foot increments	02 2', 609mm 03 3', 914mm 04 4', 1219mm 05 5', 1524mm 06 6', 1828mm 08 8', 2438mm	SOF Soft Diffuse Lens, Lambertian

Finish/Color	CCT/CRI	Direct Output/Ft ¹	Driver	Circuiting	Voltage
C1 Matte White (Default)	30K 3000K, 80CRI	D035 350 (Min)	D01 1% Dimming, 0-10V	1C 1 Circuit	UNV 120-277V
C4 Machined Aluminum	35K 3500K, 80CRI	to			
C5 Carbon Black	40K 4000K, 80CRI	D135 1350 (Max)			
CC Custom Color					

Optional			
Nightlight	Emergency	Thru-Wiring	Patterns
NL Nightlight Circuit Required ²	EF 10W Emergency Battery Backup (CEC Title 20 Compliant) ³	W1 No Thru-Wire W2 Provide Normal and NL/EF Thru-Wiring ⁴ W3 Provide Normal Thru-Wiring Only	C90L Illuminated 90° Corner ⁵

Notes:

- ¹ Specifiable in 50 lumen increments. Reference the Performance Data Table for full performance offering and exceptions.
- ² Enter Quantity. 2NL= 2 Nightlight circuits per row.
- ³ Enter Quantity. 2EF= 2 Batteries per row. 10W battery powered driver. Provides a minimum of 90 minutes of emergency lighting. Inverter Compatible. Provided by others.
- ⁴ Only applicable when specified with Emergency/Nightlight
- ⁵ Contact Factory for pattern configurations. Additional lead time may be applicable Approval drawings required.

Flow 91L

4" WET LOCATION RECESSED

DIRECT

PERFORMANCE DATA TABLE

The table below shows the delivered lumens for the various lumen outputs. Use this chart in connection with the output multiplier capability to deliver any output required

Distribution/Output	Lumens/Ft	W/Ft	Efficacy
D035	350	3.3	106
D040	400	3.7	108
D045	450	4.1	110
D050	500	4.5	111
D055	550	4.9	112
D060	600	5.3	113
D065	650	5.8	112
D070	700	6.3	111
D075	750	6.7	112
D080	800	7.2	111
D085	850	7.7	110
D090	900	8.3	108
D095	950	8.8	108
D100	1000	9.3	108
D105	1050	9.9	106
D110	1100	10.5	105
D115	1150	11.1	104
I120	1200	11.7	103
I125	1250	12.3	102
I130	1300	13.0	100
I135	1350	13.6	99

(Wattage may vary up to 5% from published)

Output Multiplier Table

Photometrics and outputs published on this spec sheet are based on nominal 3500K temperature. This table may be used to approximate the lumen values at different Kelvin temperatures. Power consumption would stay the same.

CCT	80 CRI
3000K	0.98
3500K	1
4000K	1.03

Flow 91L

4" WET LOCATION RECESSED
DIRECT

DIMENSIONS

91L-R-4

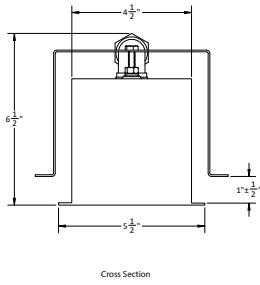

DATE: _____ LOCATION: _____

TYPE: _____ PROJECT: _____

CATALOG #: _____