

## FEATURES

- Contoured shape enhances performance and simplifies cleaning
- Die-cast end-caps and extruded aluminum body provide durability
- Provides ambient and reading illumination with optional night light
- Antimicrobial finish in three standard colors
- Multiple switching and control options



## SPECIFICATIONS

### CONSTRUCTION

- Extruded aluminum body, die-cast end-caps and 16-gauge galvanized steel back-plate and 21-gauge CRS wire way
- The nominal 0.080" thick extruded acrylic lens presents a smooth room-side surface for simple wipe-down
- Polyester powder coat paint finish with an antimicrobial compound additive that inhibits the growth of microbes
- Three standard colors are available with custom colors available upon request

### OPTICS

- The LED source is available in 3000K, 3500K, 4000K and 5000K CCT with standard > 80 CRI and optimal life > 60,000 hours at 90% lumen maintenance

### INSTALLATION

- The 3-step mounting process simplifies installation
- The back plate is secured directly to the wall structure or with wall anchors
- The wire way houses the electrical components and mounts to the back plate
- The shroud hooks onto the back plate and is secured with stainless steel fasteners

### ELECTRICAL

- Available in universal 120V–277V; 50/60 Hz
- Contact factory for other supply voltage needs
- Each mode of operation is controlled independently by a dedicated driver
- A variety of options are available for control
- A single-pole pull switch provides control for the bottom light compartment
- A 4-pole pull switch provides sequential control of both light compartments
- Both pull switch options are supplied with an antimicrobial plastic pull cord
- The low voltage controller (LVC) options deliver patient control through a patient pillow switch, bed side rail or wall switch(s) (by others) with normally-open momentary dry contacts
- The night light options (NW, NA) can be controlled from a wall switch or patient pillow switch (by others)
- The NWS or NAS options provide a night light with a 3-way, stainless steel, low voltage switches mounted at either end of the fixture
- The optional Bed Safety Switch (BSS) reduces the potential for luminaire damage from movement of motorized patient beds

### CERTIFICATIONS

- Built and tested to UL1598 standard and bears the CSAus label for Damp Locations
- Pre-approved by OSHPD for installation in California healthcare facilities

### WARRANTY

- 5 year warranty

KEY DATA	
Lumen Range	1,887–7,756
Wattage Range	19–74
Efficacy Range (LPW)	99–110
Reported Life (Hours)	L90/60,000
Input Current Range (mAmps)	7–27

## ORDERING GUIDE

**Example:** EBL4-35-WH-120-LVC22

CATALOG #

EBL		-		-		-		-	
Model	Size	Color Temp		Finish		Voltage		Options	
EBL Evexia Bed Light	2 2' (27.47")	30K	3000K	WH	White	U	Universal (120-277)	NW	Night light white (3000K) <sup>2, 3</sup>
	3 3' (38.50")	35K	3500K	AL	Aluminum	120	120	NA	Night light amber (590nm) <sup>2, 3</sup>
	4 4' (49.76")	40K	4000K	TP	Taupe	277	277	NWS	Night light white (3000K) with 3-way momentary switches located at both ends of the luminaire <sup>2, 3, 4</sup>
		50K	5000K	CC	Custom Color <sup>1</sup>			NAS	Night light amber (590nm) with 3-way momentary switches located at both ends of the luminaire <sup>2, 3, 4</sup>
								P4L	4-Pole Pull Switch (mounted to the left as facing the luminaire) <sup>2, 5</sup>
								P4R	4-Pole Pull Switch (mounted to the right as facing the luminaire) <sup>2, 5</sup>
								P1L	1-Pole Pull Switch for control of the lower compartment (mounted to the left side as facing the luminaire) <sup>2, 5</sup>
								P1R	1-Pole Pull Switch for control of the lower compartment (mounted to the right side as facing the luminaire) <sup>2, 5</sup>
								LVC	Low Voltage Controller for individual control of the reading function. <sup>3, 6, 7</sup>
								LVC2__	Low Voltage Controller for individual or sequential control of two (2) independent functions. Use LVC Selection Chart included in this document to complete ordering code. (Ex. LVC21, LVC22) <sup>3, 6, 7</sup>
								LVC3__	Low Voltage Controller for individual control of three (3) functions or sequential control of two (2) functions and individual control of one (1) function. Use LVC Selection Chart included in this document to complete ordering code. (Ex. LVC31, LVC32) <sup>3, 6, 7, 8, 11</sup>
								LVCDSM__	Low Voltage Controller for up to three (3) functions with one (1) or two (2) functions having 0-10v dimming and the remaining function(s) being controlled independently. Use LVC Selection Chart included in this document to complete ordering code. (Ex. LVCDSM4) <sup>3, 7, 8</sup>
								BSS	Bed Safety Switch <sup>2, 3, 9</sup>
								ELL14	Emergency battery pack <sup>10</sup>
								GMF	Slow blow fuse
								RIF	Radio interference frequency filter
								TR	Tamper-resistant hardware

### Notes:

- Customer to provide RAL number or color chip to match. Additional set-up charges will be applied to the order
- 120V models only
- Not available for EBL2 model
- Not available with LVC22, LVC23, LVC31, LVC32 and LVCDSM1-3 options
- Supplied with 5' plastic, antimicrobial white pull cord
- Not available with Universal voltage (U). Select 120V or 277V
- Not available with Pull Switch options (P4L, P4R, P1L, P1R)
- Confirm that the facility's nurse call system supports (3) dry-contact connections for lighting when the intent is to control (3) different lighting functions
- The Bed Safety Switch (BSS) helps limit damage to luminaire by disconnecting power to motorized patient bed when luminaire is moved
- Available for EBL4 model only
- Selection of NA or NW required

## PERFORMANCE CHART

		CCT	Ambient (Uplight)			Reading (Downlight)			Ambient + Reading		
			Lumens	Input Watts	LPW	Lumens	Input Watts	LPW	Lumens	Input Watts	LPW
80 CRI	EBL2	3000K	1934	19	101	1887	19	99	3785	38	100
		3500K	1967	19	104	1920	19	101	3850	38	101
		4000K	2052	19	107	2003	19	105	4016	38	106
		5000K	2052	19	107	2003	19	105	4016	38	106
	EBL3	3000K	3197	31	104	3196	31	103	6348	61	103
		3500K	3252	31	106	3251	31	105	6458	61	105
		4000K	3392	31	110	3391	31	109	6736	61	110
		5000K	3392	31	110	3391	31	109	6736	61	110
	EBL4	3000K	3687	37	99	3695	37	100	7310	74	99
		3500K	3751	37	101	3759	37	102	7436	74	100
		4000K	3912	37	105	3921	37	106	7756	74	105
		5000K	3912	37	105	3921	37	106	7756	74	105

## DIMENSIONS

	L	L1	L2	L3
EBL2	27.47" (697.7mm)	2.75" (69.9mm)	12.23" (310.6mm)	—
EBL3	38.50" (977.9mm)	2.75" (69.9mm)	13.25" (336.6mm)	17.74" (450.6mm)
EBL4	49.76" (1263.9mm)	2.75" (69.9mm)	16" (406.4mm)	23.38" (593.9mm)

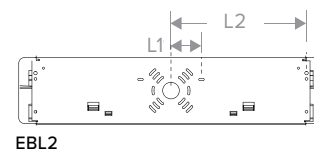
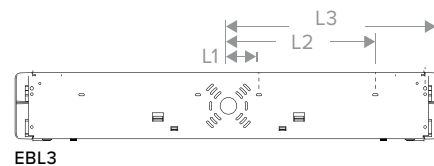
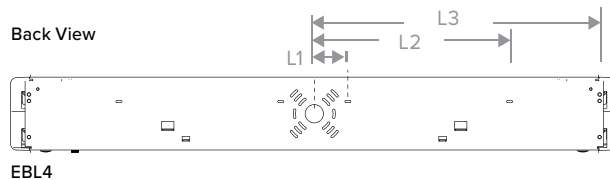
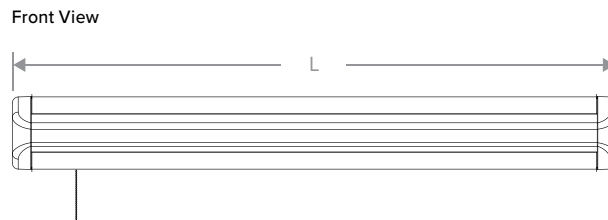
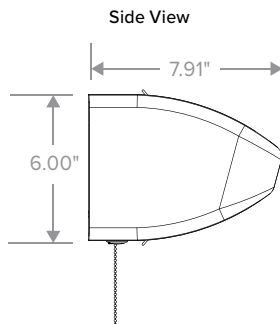

## PHOTOMETRY

### LUMINAIRE DATA

Test No.	18.00933
Description	Evexia patient bed light - Uplight only
Delivered Lumens	3751
Watts	37.2
Efficacy	100.8 Lm/W
Mounting	Wall

### ZONAL LUMEN SUMMARY

Zone	Lumens	% Luminaire
0-30	2	0.0
0-40	3	0.1
0-60	5	0.1
0-90	86	2.3
90-120	847	22.6
90-130	1396	37.2
90-150	2645	70.5
90-180	3665	97.7
0-180	3751	100.0

### POLAR GRAPH

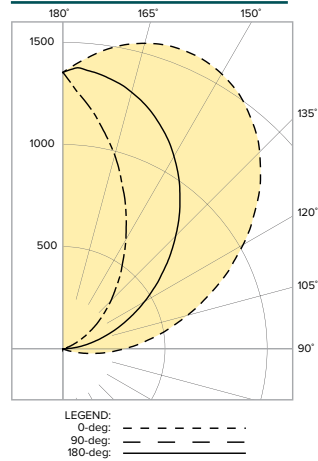

### LUMINAIRE DATA

Test No.	18.00934
Description	Evexia patient bed light - Downlight only
Delivered Lumens	3759
Watts	37.0
Efficacy	101.6 Lm/W
Mounting	Wall

### ZONAL LUMEN SUMMARY

Zone	Lumens	% Luminaire
0-30	1022	27.2
0-40	1647	43.8
0-60	2828	75.2
0-90	3681	97.9
90-120	74	2.0
90-130	75	2.0
90-150	77	2.0
90-180	78	2.1
0-180	3759	100.0

### POLAR GRAPH

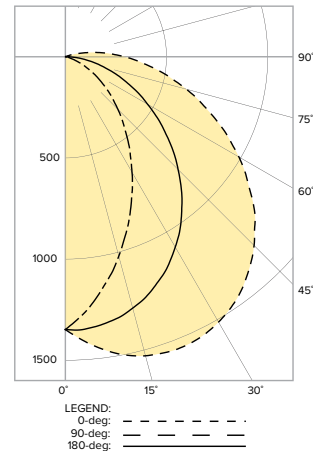

## ADDITIONAL INFORMATION

### LVC SELECTION CHART

The Low Voltage Controller (LVC) option allows control of the luminaire functions from a patient pillow switch, bed side rail, or wall switch which normally-open momentary dry contacts. Depending on the number of modes to be controlled, various control options are available.

Independent	I	Dedicated On/Off control for a single load
Sequential	S	On/Off Control of two loads by sequentially cycling through them
Smooth dim	SM	Smooth increase in light level from a starting point of 25% by continuing to press the switch. When released, pressed and held again, the light level decreases until the switch is released

LVC Ordering Code	FUNCTION		
	Ambient (top compartment)	Reading (bottom compartment)	Night Light (top compartment)
LVC1		I	
LVC21	I or S*	I or S*	
LVC22	I or S*		I or S*
LVC23		I or S*	I or S*
LVC31	I	I	I
LVC32	S	S	I
LVCDSM1	SM	I	I
LVCDSM2	I	SM	I
LVCDSM3	SM	SM	I
LVCDSM4	SM	I	
LVCDSM5	I	SM	
LVCDSM6	SM	SM	

\* The selection of individual (I) or sequential (S) control is determined by in-field connections at the control(s).