

# LTR-SCA

LITEISTRY™ SLOPED CEILING ADAPTER

DATE: \_\_\_\_\_ LOCATION: \_\_\_\_\_

TYPE: \_\_\_\_\_ PROJECT: \_\_\_\_\_

CATALOG #: \_\_\_\_\_

## LITEISTRY™



### FEATURES

- Sloped Ceiling Adapter (SCA) designed for seamless integration with standard LITEISTRY recessed 3", 4" and 6" round aperture downlights
- Available for ceiling slopes from 5° to 35° (in 5° increments)
- Durable, powder coat white finish (standard) for interior and flange

### SPECIFICATIONS

#### CONSTRUCTION

- Heavy-gauge, self-flanged spun aluminum adapter
- Housing, Trim, and Sloped Ceiling Adapter accessory ordered separately

#### OPTICS

- Adapter allows the axis of the standard LITEISTRY housing to remain unchanged
- Full adapter contour optimizes lighting characteristics of the specified light engine/trim assembly

#### INSTALLATION

- Designed for easy installation in a wide range of sloped ceiling applications
- SCA4 and SCA6 mounts securely to housing plaster frame and ceiling using the standard trim torsion springs
- SCA3 mounts using the standard trim wing springs and mousetrap springs on the SCA reflector

#### INSTALLATION (CONTINUED)

- Max Ceiling Thickness for all 3" aperture: 1.25" Max Ceiling Thickness for 4"/6" apertures: 2" (5° to 20°); 1.75" (25° to 35°)
- Refer to LITEISTRY downlight specification sheets and LTR-SCA Installation Instruction Sheet for additional details

### ORDERING GUIDE

Example: LTR-SCA4-35

CATALOG #

#### HOUSING

LTR-SCA					
Base Model		Nominal Downlight Aperture		Degree of Ceiling Slope	
LTR-SCA	LITEISTRY™ Sloped Ceiling Adapter, White Powder Coat Finish	3	For use with 3" LTR-3RD Series <sup>1</sup>	05	5° Slope Angle
		4	For use with 4" LTR-4RD Series <sup>1</sup>	10	10° Slope Angle
		6	For use with 6" LTR-6RD Series <sup>1</sup>	15	15° Slope Angle
				20	20° Slope Angle
				25	25° Slope Angle
				30	30° Slope Angle
				35	35° Slope Angle

Notes:

- 1 For new construction round downlight housing types only; not compatible with Wall Wash or Adjustable configurations.

# LTR-SCA

LITEISTRY™ SLOPED CEILING ADAPTER

DATE: \_\_\_\_\_ LOCATION: \_\_\_\_\_

TYPE: \_\_\_\_\_ PROJECT: \_\_\_\_\_

CATALOG #: \_\_\_\_\_

## DIMENSIONS

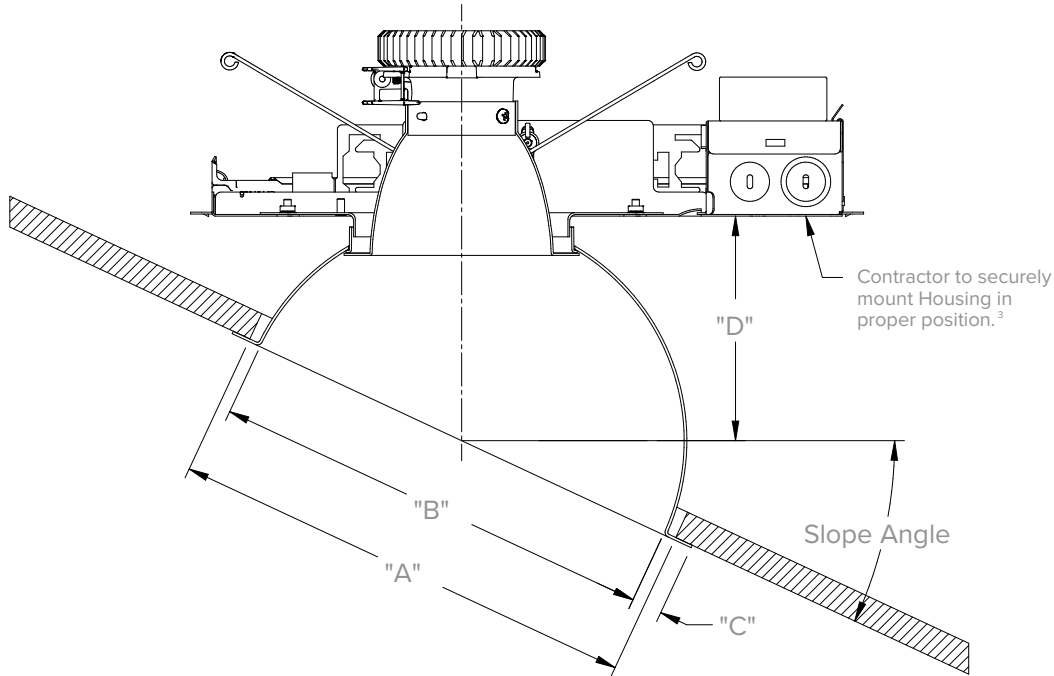

LITEISTRY Housing, Trim, and SCA Adapter ordered separately

SCA Accessory <sup>1</sup>	Housing/Trim Series Compatibility <sup>2</sup>	"A" Ceiling Opening	"B" Aperture	"C" Flange Width	"D" <sup>3</sup> Height to Ceiling Plane	
					For 5° to 30°	For 30° to 35°
LTR-SCA3-xx	LTR-3RD	10.00" (254.0mm)	9.50" (241.3mm)	0.50" (12.7mm)	5.00" to 6.50" (127.0mm to 165.1mm)	
LTR-SCA4-xx	LTR-4RD	10.50" (266.7mm)	10.00" (254.0mm)	0.63" (16.0mm)	4.88" to 5.38" (123.8mm to 136.5mm)	5.00" to 6.00" (127.0mm to 152.4mm)
LTR-SCA6-xx	LTR-6RD	11.50" (292.1mm)	11.00" (279.4mm)	0.63" (16.0mm)	4.88" to 5.88" (123.8mm to 149.2mm)	5.13" to 6.00" (130.2mm to 152.4mm)

Notes:

- 1 xx = Slope Angle, see Ordering Guide for available options.  
Refer to LTR-SCA Installation Manual for more details.
- 2 For Downlight Housing/Trim configurations only, (not compatible with Wall Wash or Adjustable trims).
- 3 Max Ceiling Thickness for all 3" aperture: 1.25"  
Max Ceiling Thickness for 4 7/6" apertures: 2" (5° to 20°); 1.75" (25° to 35°)