

LIGHTOWL PASSIVE INFRARED SENSOR

CEILING AND WALL MOUNT OCCUPANCY SENSORS

LIGHTOWL



FEATURES

- IntelliDAPT™ self-adaptive technology-no manual adjustment required
- All-digital passive infrared (PIR) sensor
- Non-volatile memory for sensor settings
- Relay and photocell control
- Low voltage device: 24VDC
- 5 year limited warranty



SPECIFICATIONS

CONSTRUCTION

- Casing - Rugged, high-impact, injection-molded plastic KJB ABS Cycolac (UL-945VA)
- Color-coded leads are 6" long (154.4mm)
- 5.0 oz (142g)
- Off-white
- Red - infrared motion

INSTALLATION - MOUNTING

- LOIRWVRP - Max mounting height: 12ft
- LOIRHBRP - Max mounting height: 30ft

ELECTRICAL

- 24VDC, 33 mA (uses UVPP and MP-Series power pack-not included)
- 24VDC active high-logic control signal with short circuit protection and dry contact (See: RP Option)

OPERATION

- Auto reset from test setting
- Self-adjusting timer

OPERATION CONTINUED

- Self-adjusting passive infrared and acoustic thresholds
- Automatic false-on/false-off corrections
- Dual-element pyrometer and 12-element cylindrical rugged lens

OPERATION CONTINUED

- Automatic mode: 8–30 minutes (self-adjusts based on occupancy)
- Test mode: 8 seconds (for an easy check at installation)

OPERATING ENVIRONMENT

- Indoor use only
- Operating temperature: 32°F to 104°F (0°C to 40°C)
- Relative humidity (non-condensing): 0% to 95%

COVERAGE

- LOIRWVRP (Wide View): 1,600 square feet (487.68 square meters)

COVERAGE CONTINUED

- LOIRHBRP (High Bay): 120 linear feet

RP OPTION

- Relay and photocell included
- Relay: N/O + N/C contacts; SPDT; 500 mA rated @ 24 VDC; three-wire isolated relay
- Photocell: adjustable natural-light override ranges from 0 to 100 foot-candles (0–1,000 lux)
- Factory set at 3,000 lux (disable photocell)

CERTIFICATIONS

- UL and cUL listed

WARRANTY

- 5 year warranty

ORDERING GUIDE

Example: LOIRWVRP

CATALOG #

Model	Technology	Relay/Photocell Option
LO LightOWL Sensor	IRWV Passive Infrared Wide View IRHB Passive Infrared High Bay	RP Relay Photocell

LIGHTOWL PASSIVE INFRARED SENSOR

CEILING AND WALL MOUNT OCCUPANCY SENSORS

DIMENSIONS

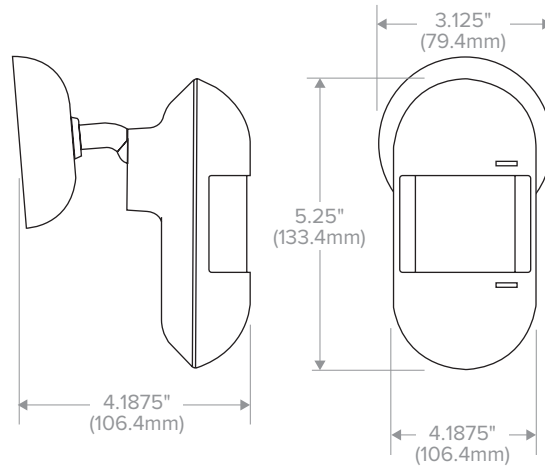

ADDITIONAL INFORMATION

Coverage Patterns

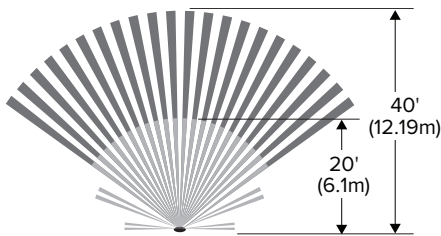

■ IR Minor Motion ■ IR Major Motion

LOIRWVRP - Coverage Range (Top View)

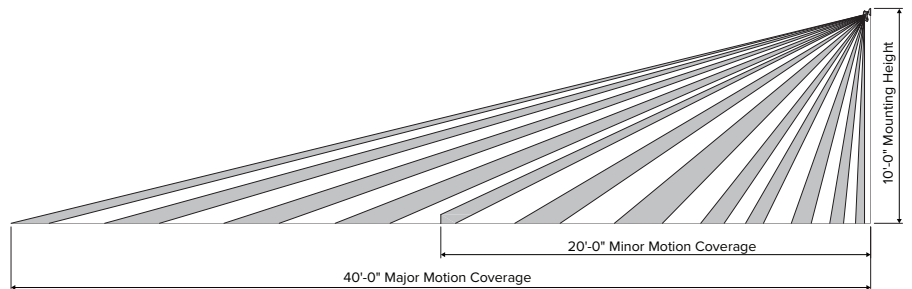

LOIRWVRP - Coverage Range (Side View)

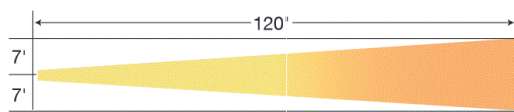

Minor Motion: ■ Ultrasonic ■ PIR Major Motion: ■ Ultrasonic ■ PIR

LOIRHBRP - Coverage Range (Top View)

LIGHTOWL PASSIVE INFRARED SENSOR

CEILING AND WALL MOUNT OCCUPANCY SENSORS

ADDITIONAL INFORMATION (CONTINUED)

Wiring Diagrams

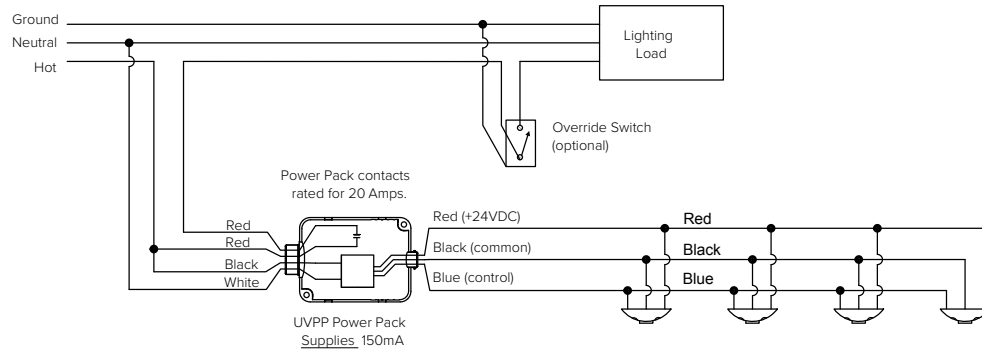

Low Voltage Sensors (devices)
Requires 33mA each

NOTE:

- DO NOT attempt to power more than 4 devices, be it sensors or slave packs, from a single power pack.

1 Circuit with up to 4 Sensors and UVPP

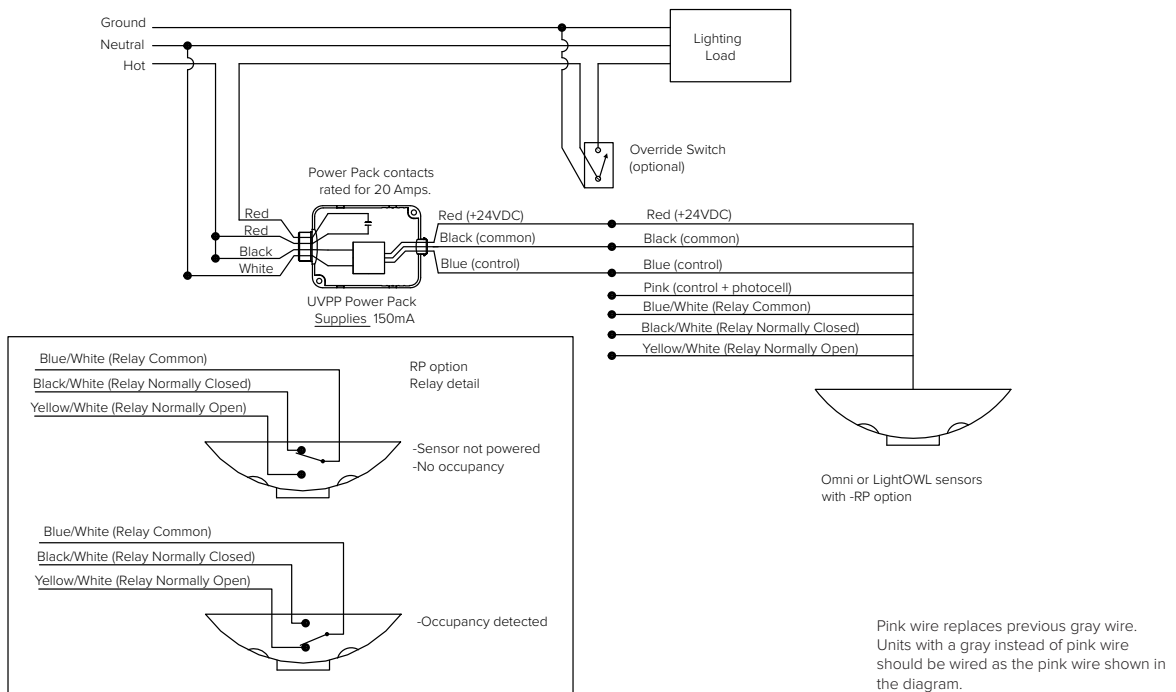

1 Circuit with RP Option Wiring

LIGHTOWL PASSIVE INFRARED SENSOR

CEILING AND WALL MOUNT OCCUPANCY SENSORS

ADDITIONAL INFORMATION (CONTINUED)

Wiring Diagrams

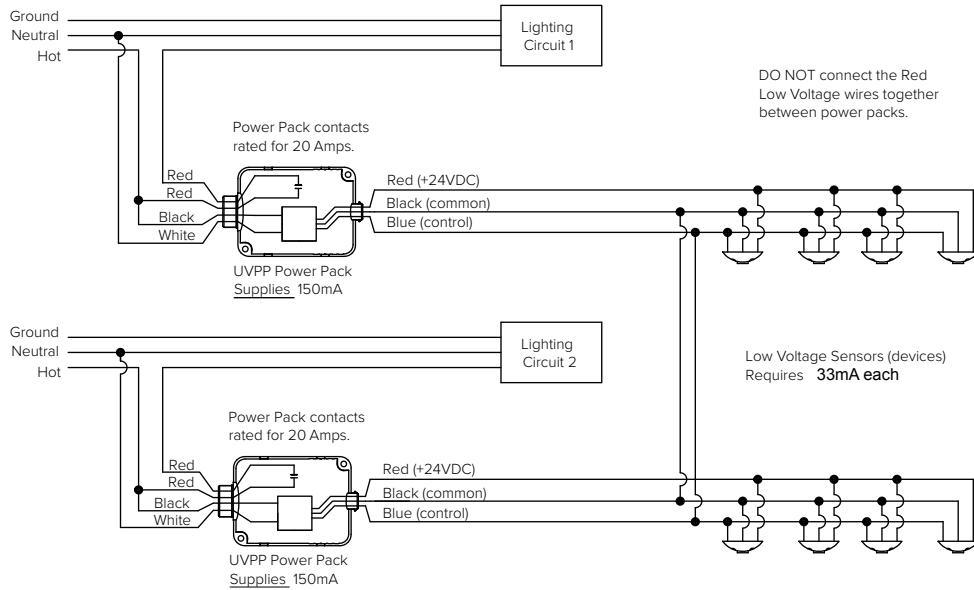

NOTES:

1. Lighting load turns on when at least one sensor detects motion
2. DO NOT attempt to power more than 4 devices, be it sensors or slave packs, from a single power pack
3. No more than 4 power packs should be connected in this way

2 Circuits with 5 to 8 Sensors