



CUSTOMER NAME _____
PROJECT NAME _____
DATE _____ TYPE _____
CATALOG NUMBER _____

EFC1 Series LED Compact Flood Light

The Evolve® LED Compact Flood, EFC1, is a replacement for 50W to 150W HID general purpose flood luminaires offering significant energy savings with a long-life LED light source. The EFC1 provides symmetric spot and general purpose flood distribution patterns with lumen levels ranging from 2,000 to 12,000 lumens per fixture. This compact flood is designed to meet the lighting needs for applications such as small format signage, facade, flag or monument, parking and landscape lighting.

Construction

Housing:	Aluminum die cast enclosure. Integral heat sink for maximum heat transfer
Lens:	Impact resistant tempered glass
Paint:	Corrosion resistant polyester powder paint, minimum 2.0 mil thickness Standard = Black, Dark Bronze, Gray, White (RAL & custom colors available) Optional = Coastal Finish
Weight:	11-14.5 lbs (5.0-6.6 kgs)

Optical System

Lumens:	2,000 to 12,000
Distribution:	3x3, 6x6, 7x7
Efficacy:	106-143 LPW
CCT:	2700K, 3000K, 4000K, 5000K
CRI:	≥70

Electrical

Input Voltage:	120-277V
Input Frequency:	50/60Hz
Power Factor:	≥ 90% at rated watts
Total Harmonic Distortion:	≤ 20% at rated watts

Surge Protection*

STANDARD	OPTIONAL
10kV/5kA	Secondary 10kV/5kA (R Option)

*Per ANSI C136.2-2015

Lumen Maintenance

Projected Lxx per IES TM-21-11 at 25°C

LUMEN CODES	DISTRIBUTION	LXX(10K) @ HOURS		
		25,000 HR	50,000 HR	60,000 HR
33	3x3	95	92	92
66, 77	6x6, 7x7	98	96	95

Note: Projected LXX based on LM80 (> 10,000 hour testing). Accepted industry tolerances apply to initial luminous flux and lumen maintenance measurements.

Luminaire Ambient Temperature Factor

AMBIENT TEMP (°C)	INITIAL FLUX FACTOR	AMBIENT TEMP (°C)	INITIAL FLUX FACTOR
10	1.02	30	0.99
20	1.01	40	0.98
25	1.00	50	0.97

Ratings

Operating Temperature:	-40°C to 50°C
Vibration*:	Mini-Trunnion Mounting: 3G Slipfitter Mounting: 2G ½" NPT Swivel Mounting: 1.5G
LM-79:	Testing in accordance with IES Standards

*Per ANSI C136.31-2010

Controls

Dimming:	Standard - 0-10V Optional - DALI (Option U)
Sensors:	Photo Electric Sensors (PE) available LightGrid and Daintree Compatible

Warranty

5 Year (Standard)



Not all product variations listed on this page are DLC qualified. Visit www.designlights.org/search to confirm qualifications.

CUSTOMER NAME _____
PROJECT NAME _____
DATE _____ TYPE _____
CATALOG NUMBER _____

EFC1 01 7

PROD. ID	GEN	VOLTAGE	OPTIC CODE	DISTRIBUTION ³	CRI	CCT	DIMMING	CONTROLS	MOUNTING	COLOR	OPTIONS
E = Evolve	01	0 = 120-277V ¹	02 = 2000 lm ²	33 = NEMA 3x3 (Spot)	7 = 70	27 = 2700K	A = ANSI C136.41 7-Pin Receptacle ⁴	A = No Control	J1 = 1/2" NPT SWIVEL MOUNT ⁶	BLCK = Black	F = Fusing
F = Flood		8 = 120-240V ^{1,2}	04 = 4000 lm	66 = NEMA 6x6		30 = 3000K	D = No Receptacle, with external (3ft (18/5) power/dimming cable. (T2 mount only)	D = Shorting Cap ⁵	K1 = Knuckle Slipfitter: For 1.9 in. - 2.3 in OD Tenon ⁸	DKBZ = Dark Bronze	H2 = Daintree Enabled motion sensor ⁸
C1 = Compact		1 = 120V	06 = 6000 lm	77 = NEMA 7x7 (80° Wide Flood)		40 = 4000K	N = No PE Receptacle & No External Dimming Leads	E = Non-Dimming PE Control ^{5,10}	K2 = Knuckle Slipfitter: For 1.9 in. - 2.3 in OD Tenon ¹¹	GRAY = Gray	H4 = Motion Sensor ⁸
		2 = 208V	08 = 8000 lm			50 = 5000K	P = ANSI 7-Pin Receptacle with external (3ft (18/5) power/dimming cable. (T2 mount only) ⁴		S1 = Knuckle Slipfitter: For 2.3 in. - 3.0 in OD Tenon ⁸	WHITE = White	R = Optional Secondary Enhanced SPD
		3 = 240V	10 = 10000 lm						S2 = Knuckle Slipfitter: For 2.3 in. - 3.0 in OD Tenon ¹¹		U = DALI Programmable ⁷
		4 = 277V	12 = 12000 lm						T2 = Mini Trunnion ¹¹		V1 = Field Adjustable Module (FAM) Module
									V1 = Knuckle Wall Mount		XXX = Special Options
											Y = Coastal Finish ⁹

¹ Not Available with Fusing
² Optical code 02 limited to 120 to 240V Voltage range
³ Nominal IES Type classing subject to typical variation, individual units may differ
⁴ All units with "A" and "P" options have restricted aiming angles of 0-60°
⁵ Can only be ordered with "A" or "P" Dimming Options
⁶ Supplied with leads
⁷ Compatible with LightGrid System
⁸ Only available with mount K1 or S1 AND DIMMING N
⁹ Recommended for installations within 750 feet from coast. Lead time varies, check with factory.
¹⁰ PE Control only available for 120-277V
¹¹ External 3ft #16/3 power cable includes external 3ft #16/3 power cable

CUSTOMER NAME _____
PROJECT NAME _____
DATE _____ TYPE _____
CATALOG NUMBER _____

OPTIC CODE	DISTRIBUTION	CLASSIFICATION	TYPICAL INITIAL LUMENS			TYPICAL SYSTEM WATTAGE
			2700K	3000K	4000K & 5000K	120-277V
02	33	3 x 3	1800	1900	2000	15
04	33	3 x 3	3700	3800	4000	30
06	33	3 x 3	5500	5700	6000	46
08	33	3 x 3	7400	7600	8000	65
10	33	3 x 3	9300	9600	10000	85
12	33	3 x 3	11100	11500	12000	105
02	66	6 x 6	1700	1900	2000	14
04	66	6 x 6	3500	3800	4000	28
06	66	6 x 6	5300	5700	6000	43
08	66	6 x 6	7100	7600	8000	56
10	66	6 x 6	8900	9600	10000	72
12	66	6 x 6	10600	11500	12000	88
02	77	7 x 7	1700	1900	2000	14
04	77	7 x 7	3500	3800	4000	28
06	77	7 x 7	5300	5700	6000	43
08	77	7 x 7	7100	7600	8000	56
10	77	7 x 7	8900	9600	10000	72
12	77	7 x 7	10600	11500	12000	88

For additional information on EFC1 IES files, please refer to [LED.com](https://www.led.com)

EFC1 3x3 20° SPOT

12,000 Lumens
 4000K
 EFC101_1233740_-

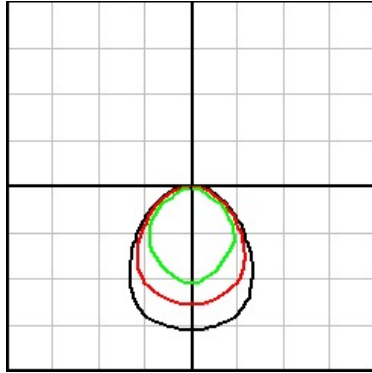

Grid Distance in Units of Mounting Height at 35'
 Tilt is 45°. Initial Footcandle Values at Grade

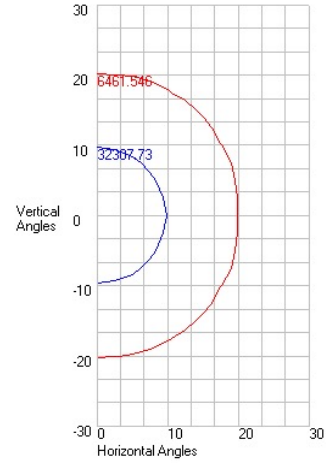
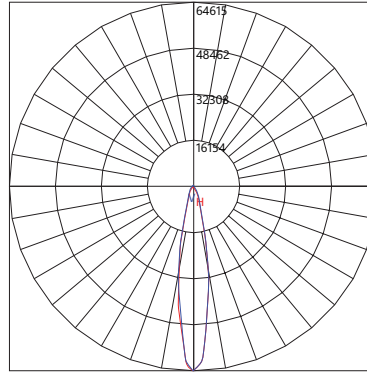

EFC1 NEMA 6x6

12,000 Lumens
 4000K
 EFC101_1266740_-

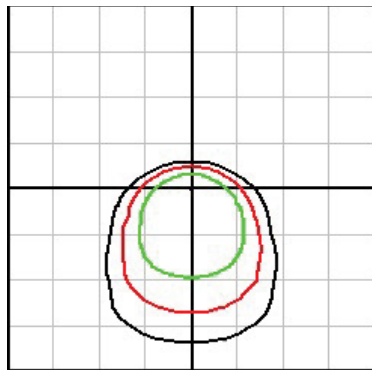

Grid Distance in Units of Mounting Height at 35'
 Tilt is 45°. Initial Footcandle Values at Grade

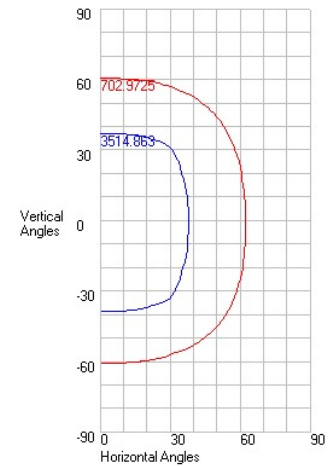
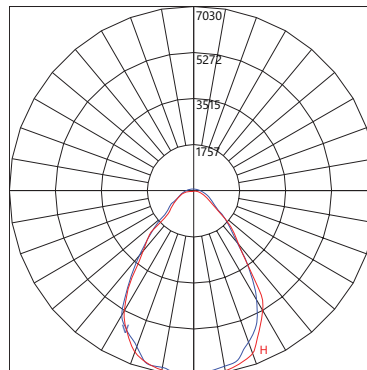

EFC1 NEMA 7x7

12,000 Lumens
 4000K
 EFC101_1277740_-

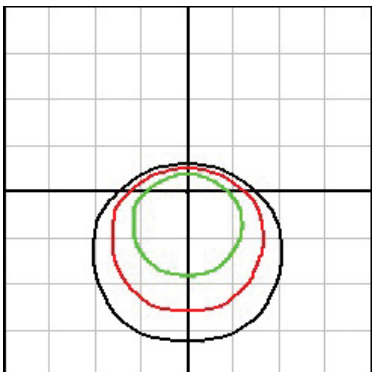

Grid Distance in Units of Mounting Height at 35'
 Tilt is 45°. Initial Footcandle Values at Grade

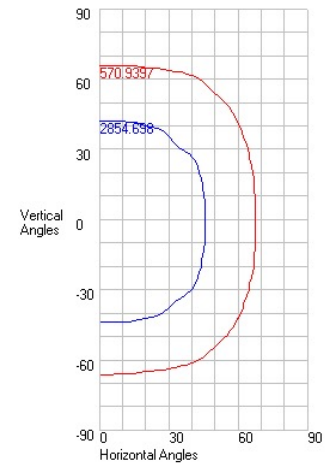
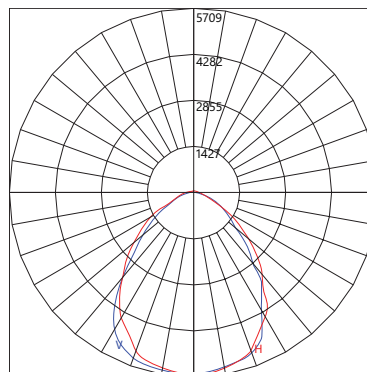

CUSTOMER NAME _____
PROJECT NAME _____
DATE _____ TYPE _____
CATALOG NUMBER _____

H2 - Daintree Enabled Motion Sensing Option

- Recommended Mounting Height: 15-30' (4.6-9.1m)
- Coverage Radius: Approx. 30'-60' (9-18m)
- Lateral Coverage: 300°
- Default Settings:
 - Output: Occupied - 100%/Unoccupied - 50%
 - PE Sensor: None
 - Ramp/Fade: 5 Minutes/5 Minutes
- Adds < 1W to fixture power rating
- Requires Wide Area Control (WAC)

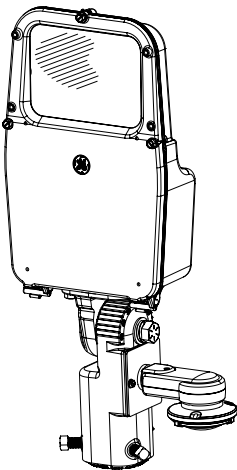
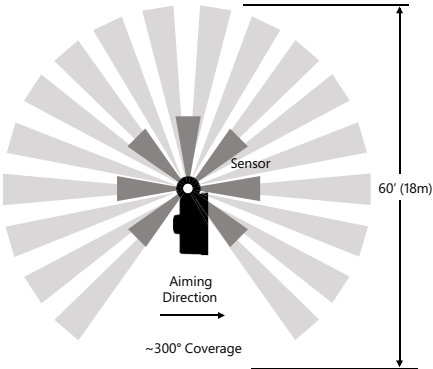
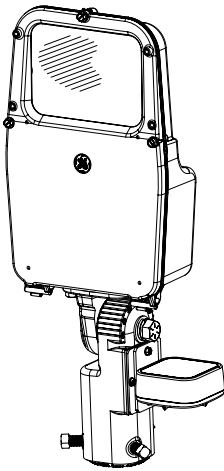

H4 - Motion Sensing Option (Wattstopper)

- Recommended Mounting Height: 15-30' (4.6-9.1m)
- Coverage Radius: 40'-60' (12m-18m)
- Lateral Coverage: 300°
- Default Settings:
 - Output: Occupied - 100%/Unoccupied - 50%
 - PE Sensor: Enabled
 - Ramp/Fade: 5 Minutes/5 Minutes
- Adds < 1W to fixture power rating
- Field programmable using FSIR-100 hand held programmer

Effective Projected Area

- Approximate Net Weight: 11-14.5 lbs (5.0-6.6 kgs)
- Effective Projected Area (EPA): 1.2 ft^2 (0.11 m^2)

PE & Accessories

SAP NUMBER	PART NUMBER	DESCRIPTION
93029237	PED-MV-LED-7	ANSI C136.41 Dimming PE, 120-277V
28299	PECOTL	Standard 120-277V
73251	SCCL-PECTL	Shorting Cap

Shields

SAP NUMBER	PART NUMBER	DESCRIPTION	COLOR
93300533	TSVBLCK-EFC	Top and Side Visor	Black
93300531	VAN-EFC	Vandal Shield	–
93300532	WG-EFC	Wire Guard	–
93300534	BDABLK-EFC	Barn Doors	Black

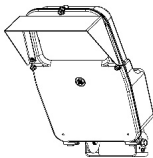

TSV
Top & Side Visor



VAN
Vandal Shield

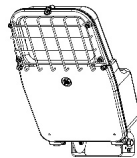

WG
Wire Guard

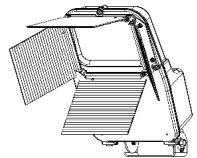

BDA
Barn Doors

T2-TRUNNION MOUNT

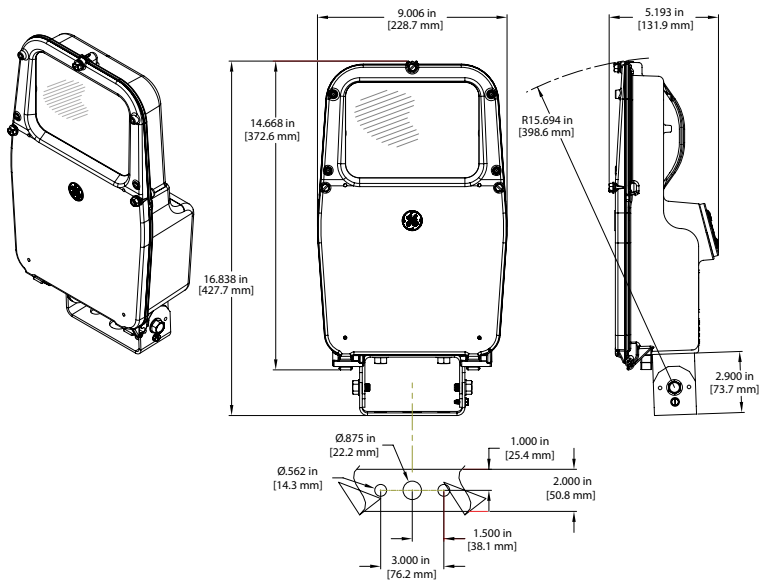

K1 K2 S1 & S2 - KNUCKLE SLIPFITTER MOUNT

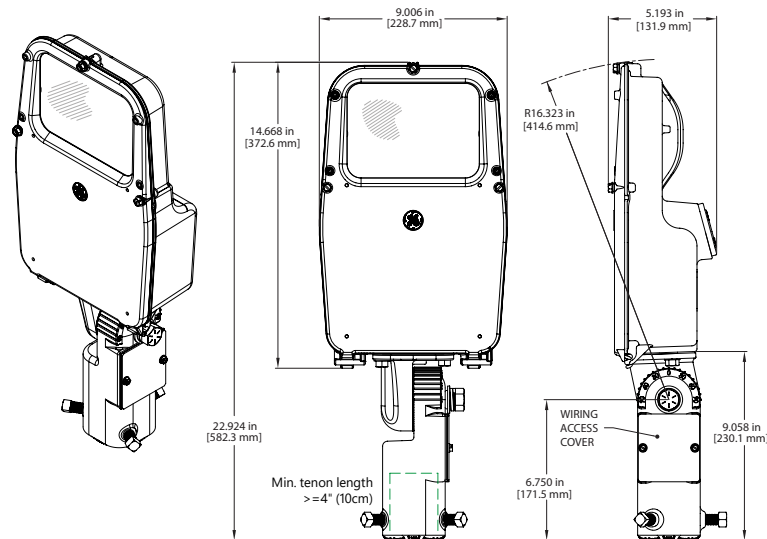

PE AIMING RESTRICTIONS

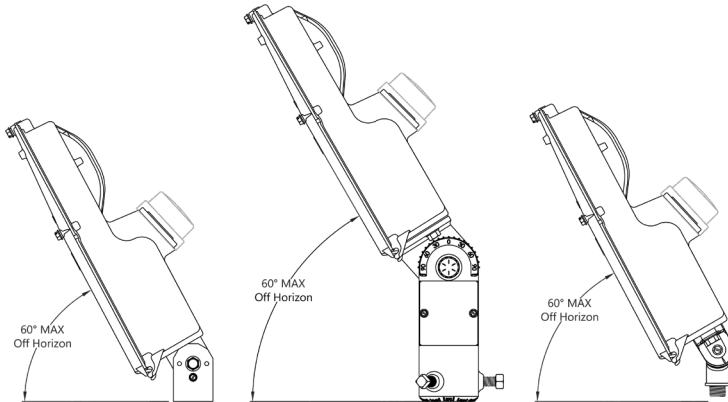

J1 - 1/2" NPT SWIVEL MOUNT

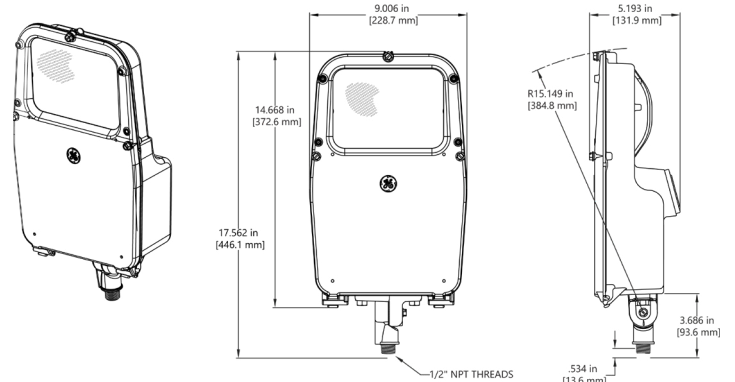

T2

K1, K2, S1 & S2

J1

V1-BOX KNUCKLE WALL MOUNT

