



Tetra[®] Ladder

CABINET SIGN LIGHTING SYSTEMS



Snap Clip & Let It Roll

Introducing the **Tetra[®] Ladder**, our latest innovation in cabinet sign LED modules. Designed for rapid installation, **Tetra[®] Ladder** offers unparalleled versatility, accommodating cabinets as shallow as 5" (127mm) deep for single-sided and 10" (254mm) deep for double-sided applications. What's more, this groundbreaking product supports both single-sided and double-sided applications, eliminating the need for separate solutions. With a simple connection process – just connect one lead for single-sided or both for double-sided – the **Tetra[®] Ladder** is the ultimate solution for efficient and effective cabinet sign illumination.

Tetra[®] Ladder

Components

SKU	Order Code	CCT	Description	Box Quantity	Additional Information
93319723	GELD71-1	7100K	Tetra® Ladder White Modules	1 Reel/box	72.1 ft. (21.98 m) 90 modules per Reel. 1.26 modules/ft. (4.13 modules/m) Includes: 20 Ladder bracket assemblies (2 bags of 10), 2 In-line Cable Grippers, and 1 spacing clip (for joining two sections)
93319722	GELD65-1	6500K	Tetra® Ladder White Modules		
93319720	GELD50-1	5000K	Tetra® Ladder White Modules		

Technical Specifications

Order Code	Typical Brightness (Lumens/module)	Typical Brightness Lumens/ft (Lumens/m)	Modules / Foot	Efficacy/Module (Lumens/W)	Energy Consumption Rated Module Wattage	Power Supply Loading (ft/100W)	Viewing Angle
GELD71-1	476	600 (1964)	1.26	165	2.88 W/module	24.95 ft/ 30 modules	165°
GELD65-1	476	600 (1964)		165			
GELD50-1	476	600 (1964)		165			

Spacing

Tetra Ladder	Depth	Max Stroke
Single-Sided	5" (127mm)	12" (305mm)
	6" (152mm)	15" (381mm)
	7" (178mm)	17" (432mm)
Double-Sided	10" (254mm)	12" (305mm)
	12" (305mm)	15" (381mm)
	14" (356mm)	17" (432mm)
	25" (635mm) +	12" (305mm)



Cable Gripper

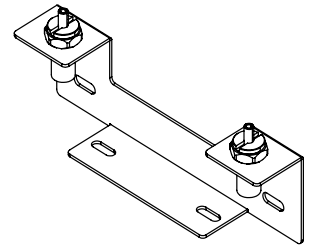

Ladder Bracket Assembly

Accessories

SKU	Description	Packaging Quantity
93320904	Cable Gripper (for mounting the aircraft cable)	20/bag
93322200	Ladder Bracket Assembly	10/bag
93322201	In-Line Gripper (for joining two sections together)	20/bag

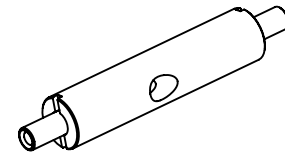

In-Line Gripper

Additional Specifications

Dimmable	Yes (with dimmable power supply)				
Cutting Resolution	Cut on wire between every module				
Power Supply Voltage	24VDC				
Maximum Supply Wire Limits		18 AWG/0.82 mm² Supply Wire	16 AWG/1.31 mm² Supply Wire	14 AWG/2.08 mm² Supply Wire	12 AWG/3.31 mm² Supply Wire
	25W Power Supply	120 ft./36.6 m	-	-	-
	80W Power Supply	20 ft./6.1 m	25 ft./7.6 m	35 ft./10.6 m	40 ft./12.1 m
	100W Power Supply	20 ft./6.1 m	25 ft./7.6 m	35 ft./10.6 m	40 ft./12.1 m
	200W Power Supply	20 ft./6.1 m	25 ft./7.6 m	35 ft./10.6 m	40 ft./12.1 m
	300W Power Supply	20 ft./6.1 m	25 ft./7.6 m	35 ft./10.6 m	40 ft./12.1 m
Operating Environment	-40 °C to +60 °C (-40 °F to +140 °F)				
Warranty	Limited system warranty of up to ten (10) years				
Module Dimensions (h x l x w) mm (inches)	0.5 x 4.3 x 1.7 (12.3 x 110 x 43)				
System Certifications	UL Recognized (c-us) #E219167, UL Certified Retrofit Sign Conversion Kit (c-us) #E229508, CE, UKCA, Class III, IP66, UL rated for dry and damp locations.				