

# URBAN LUMINAIRE AMBER

URBAN STIRKE

## FEATURES

- Uses true amber LEDs unlike phosphor-converted amber LEDs which still produce blue wavelength light that can still be disruptive to wildlife
- Specially designed amber-colored LEDs produce light with a narrow spectral distribution that minimizes disruption to sea turtles and other wildlife
- LEDs have a peak wavelength between 589-595 nm and a width of no more than 20nm at 50% power



## CONTROL TECHNOLOGY



## SPECIFICATIONS

### CONSTRUCTION

- The drivers shall be located in the top cast housing and shall be accessible without tools by hinging the lower shade assembly. The driver and all electrical components shall be on a tray
- The lower shade shall be made from a one-piece aluminum spinning
- The housing is designed for LED thermal management without the use of metallic screens, cages, or fans. The top casting shall be able to be pendent mounted in place with a stainless steel safety pin and then permanently held in place with four stainless steel bolts

### ELECTRICAL

- Universal 120-277 VAC or 347-480 VAC input voltage, 50/60 Hz
- Ambient operating temperature -40°C to 40°C
- Drivers have greater than 90% power factor and less than 20% THD
- LED Drivers have output power over-voltage, over-current protection and short circuit protection with auto recovery

### ELECTRICAL (CONTINUED)

- Field replaceable surge protection device provides 20kA protection meeting ANSI/IEEE C62.41.2 Category C High and Surge Location Category C3; Automatically takes fixture off-line for protection when device is compromised
- Button photocell available
- Ambient operating temperature -40°C to 40°C

### CONTROLS

- Available with Energeni for optional set dimming, timed dimming with simple delay, or timed dimming based on time of night visit

### FINISH

- IFS polyester powder-coat electrostatically applied and thermocured
- IFS finish consists of a five stage pretreatment regimen with a polymer primer sealer and top coated with a thermoset super TGIC polyester powder coat finish
- The finish meets the AAMA 605.2 performance specification which includes passing a 3000 hour salt spray test for corrosion resistance and resists cracking or loss of adhesion per ASTM D522 and resists surface impacts of up to 160 inch-pounds

### CERTIFICATIONS

- NRTL Certified, UL8750, UL 1598 and CSA22.2#250. 13-14 for wet locations
- IDA approved
- Meets FWC Guidelines for sea turtle nesting at coastal environments when combined with shielding

### WARRANTY

- 5 year warranty



KEY DATA	
Lumen Range	1500–3000
Wattage Range	15–65
Efficacy Range (LPW)	48-83

# URBAN LUMINAIRE AMBER

URBAN STRIKE

## ORDERING GUIDE

Example: URB-CAP-21-36L-95-AM-UNV-4W-NRNW-BLT

CATALOG #

Model	Lens Option	Engine—Watts	CCT/CRI <sup>3</sup>	Voltage	Optics	Electrical Options
URB Urban	<b>CAP-21</b> 21" Capitol <b>MRDS-21</b> 21" Miramar deep shade <b>MAR-21</b> 21" Maritas <b>CAP-26</b> 26" Capitol <b>MRSS-26</b> 26" Miramar shallow shade <b>MRDS-26</b> 26" Miramar deep shade <b>MAR-26</b> 26" Maritas	<b>36L-30</b> 2,200 lumens <b>36L-40</b> 2,500 lumens <b>36L-50</b> 2,750 lumens <b>36L-65</b> 3,000 lumens	<b>AM</b> Monochromatic Amber, 595nm	<b>UNV</b> 120-277V <b>347</b> 347V <b>480</b> 480V	<b>2</b> Type II <b>3</b> Type III <b>4F</b> Type IV forward <b>4W</b> Type IV wide <b>5QW</b> Type V sq wide	<b>PCU</b> Button Photocell, Universal (120v-277V)

Control Options	Mounting Style	Mounting Size	Style	Finish
<b>GENI-XX</b> Energeni <sup>2</sup>	<b>PM</b> Pendant mount <b>SM</b> Side mount <sup>1</sup> <b>YM</b> Yoke mount <sup>4</sup>	<b>3</b> 3" OD Pole <sup>4</sup> <b>4</b> 4" OD Pole <sup>4</sup> <b>5</b> 5" OD Pole <sup>4</sup>	<b>NRNW</b> No rings <b>3RNW</b> Three rings	<b>BLT</b> Black Matte Textured <b>BLS</b> Black Gloss Smooth <b>DBT</b> Dark Bronze Matte Textured <b>DBS</b> Dark Bronze Gloss Smooth <b>GTT</b> Graphite Matte Textured <b>LGS</b> Light Grey Gloss Smooth <b>PSS</b> Platinum Silver Smooth <b>WHT</b> White Matte Textured <b>WHS</b> White Gloss Smooth <b>VGT</b> Verde Green Textured <b>Color Option</b> <b>CC</b> Custom Color

### Notes:

- Side mount is designed to mount over 2" Schedule 40, (2.38 arm)
- When ordering Energeni, specify the routine setting code (Example GENI-04). See Energeni brochure and Energeni instructions for setting table and options. Not available with sensor options <https://www.currentlighting.com/outdoor-lighting/energeni/249071>
- This product is approved by the Florida Fish and Wildlife Conservation Commission. Separate spec available on our website. Turtle Friendly: [https://cdn.currentlighting.com/site/specsheet/Urban\\_LED\\_spec\\_sheet\\_turtle-friendly.pdf](https://cdn.currentlighting.com/site/specsheet/Urban_LED_spec_sheet_turtle-friendly.pdf)
- Yoke mount mounting Style only

## SPECTRAL CHART

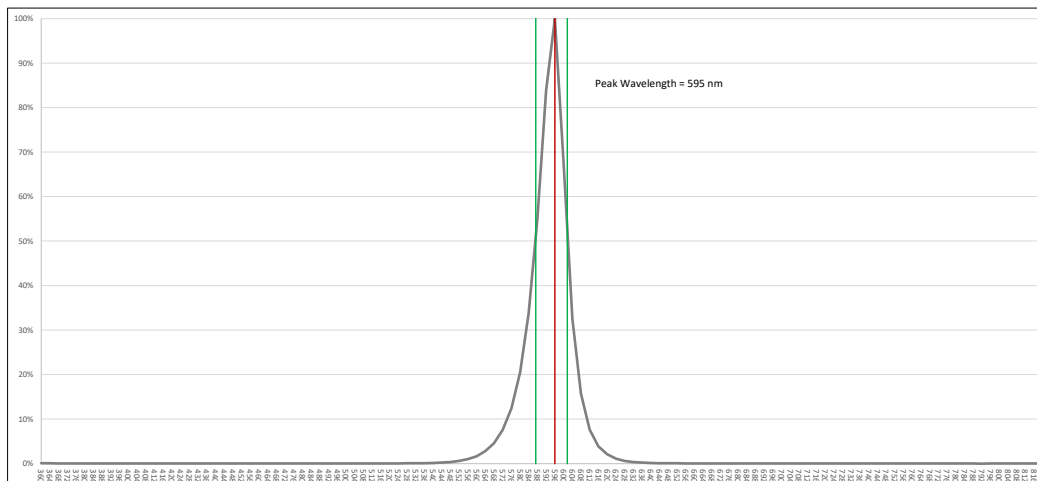

# URBAN LUMINAIRE AMBER

URBAN STRIKE

## DELIVERED LUMENS

				AMBER				
# of LEDs	NOMINAL WATTAGE	SYSTEM WATTS	DISTRIBUTION TYPE	LUMENS	LPW	B	U	G
36L	30	31.5	2	2266	72	1	0	1
			3	2242	71	0	0	1
			4F	2275	72	0	0	1
			4W	2245	71	0	0	1
	40	38.9	2	2546	65	1	0	1
			3	2519	65	1	0	1
			4F	2556	66	0	0	1
			4W	2523	65	0	0	1
	50	49.3	2	2827	57	1	0	1
			3	2797	57	1	0	1
			4F	2838	58	0	0	1
			4W	2801	57	1	0	2
	65	62.3	2	3008	48	1	0	1
			3	2976	48	1	0	1
			4F	3019	48	0	0	1
			4W	2980	48	1	0	2

# URBAN LUMINAIRE AMBER

URBAN STRIKE

## PENDANT MOUNT

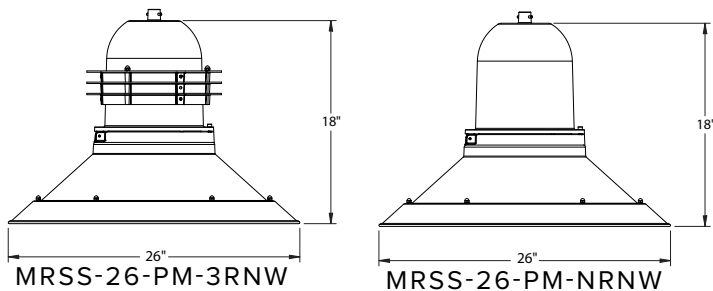
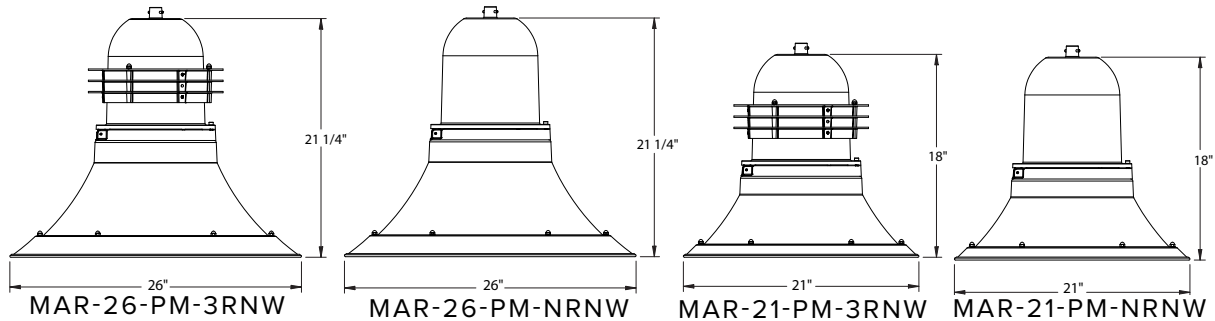
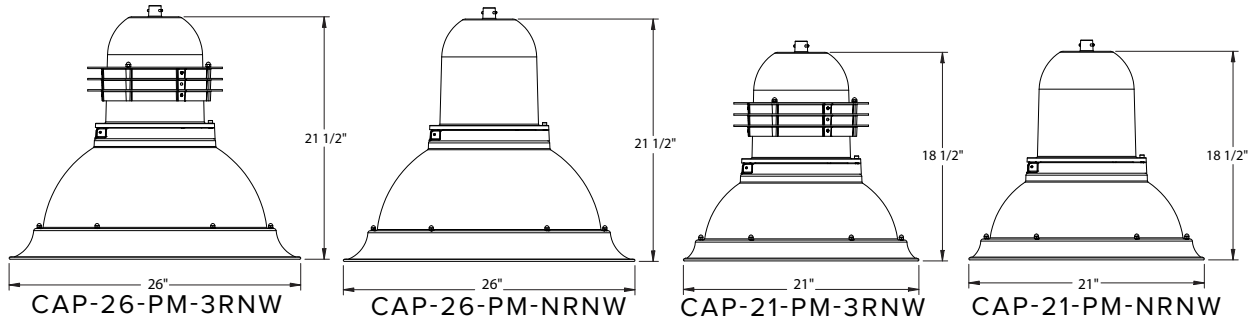
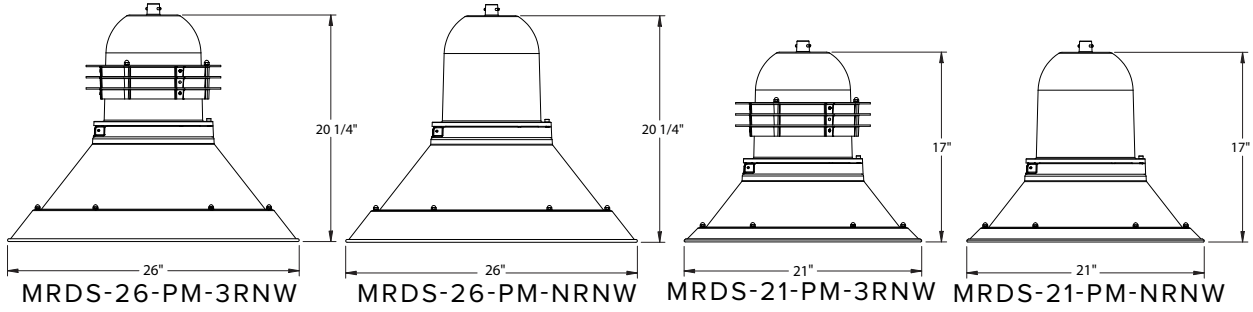

# URBAN LUMINAIRE AMBER

URBAN STRIKE

## SIDE MOUNT

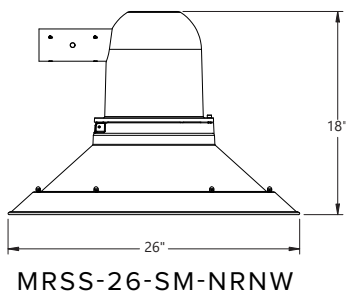
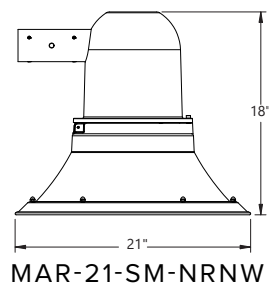
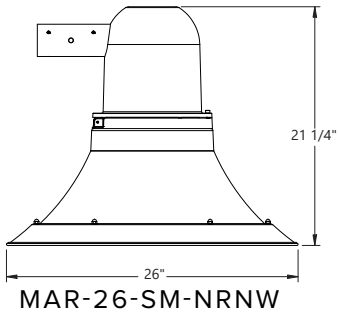
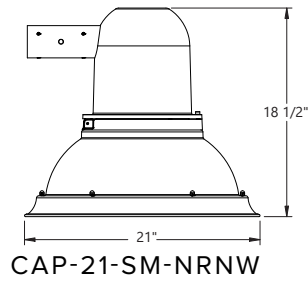
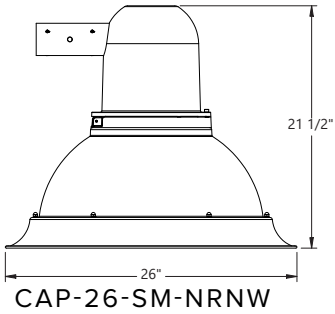
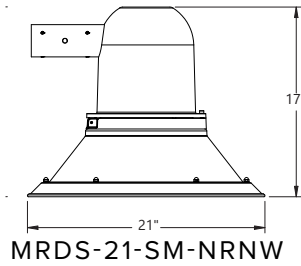
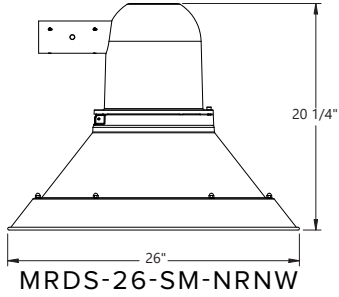

# URBAN LUMINAIRE AMBER

URBAN STRIKE

## YOKE MOUNT - 2 STRUTS FOR 21"

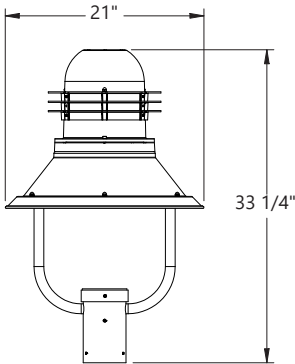

MRDS-21-YM-3RNW

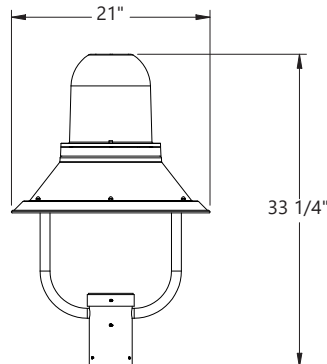

MRDS-21-YM-NRNW

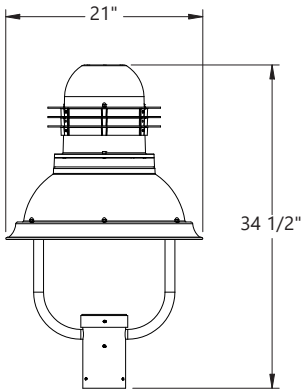

CAP-21-YM-3RNW

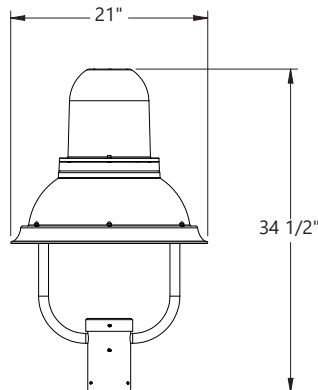

CAP-21-YM-NRNW

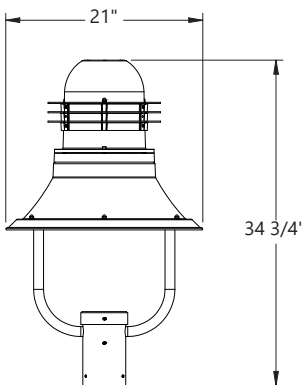

MAR-21-YM-3RNW

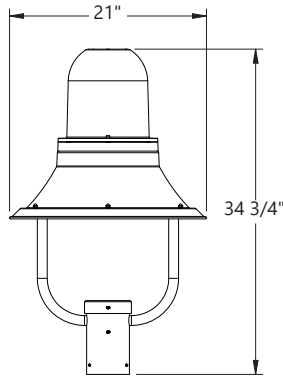

MAR-21-YM-NRNW

# URBAN LUMINAIRE AMBER

URBAN STRIKE

## YOKE MOUNT - 3 STRUTS FOR 26" VERSION

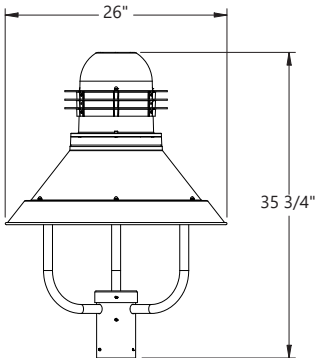

MRDS-26-YM-3R

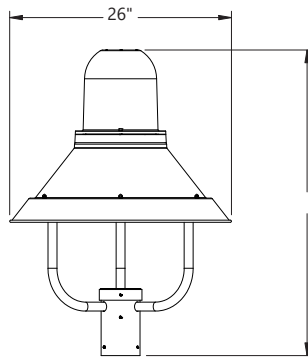

MRDS-26-YM-NRNW

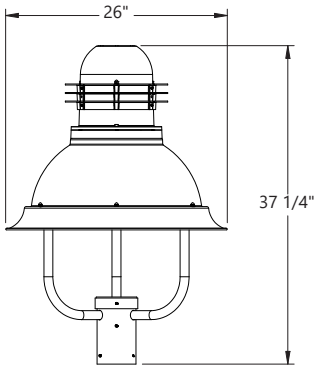

CAP-26-YM-3RNW

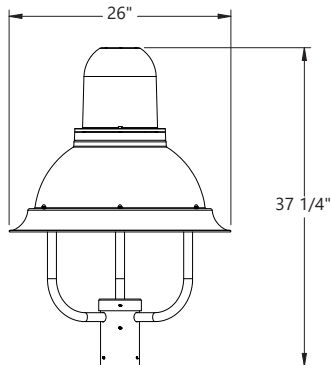

MRDS-26-YM-NRNW

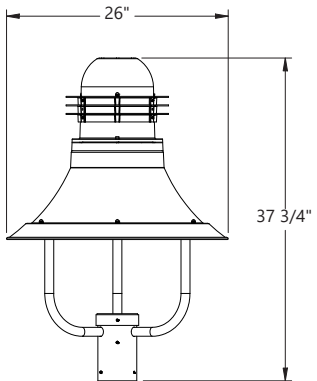

MAR-26-YM-3R

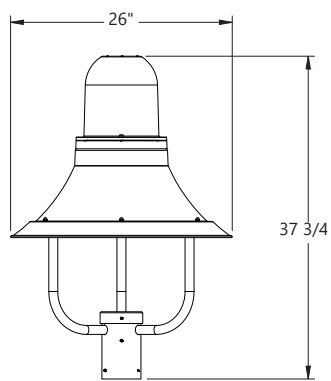

MAR-26-YM-NRNW

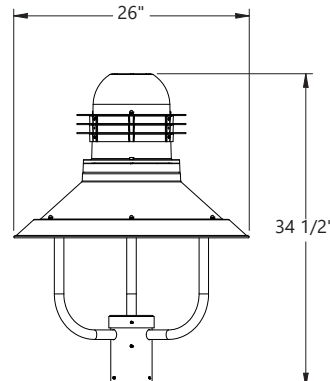

MRSS-26-YM-3R

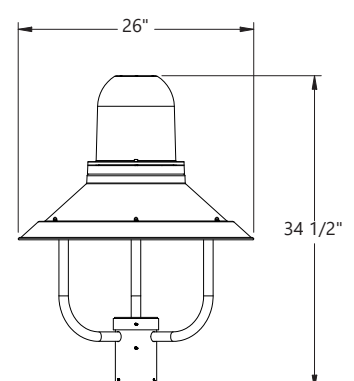

MRSS-26-YM-NRNW

# URBAN LUMINAIRE AMBER

URBAN STRIKE

## SIDE MOUNT

\* Arms ordered separately, arms mount over an open top pole, they do not mount to a tenon.

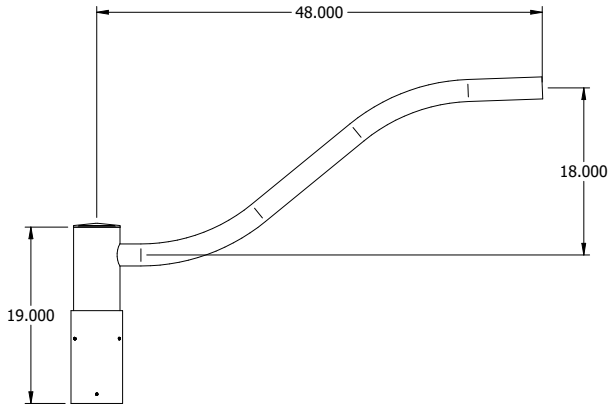

AA-10 COBRA

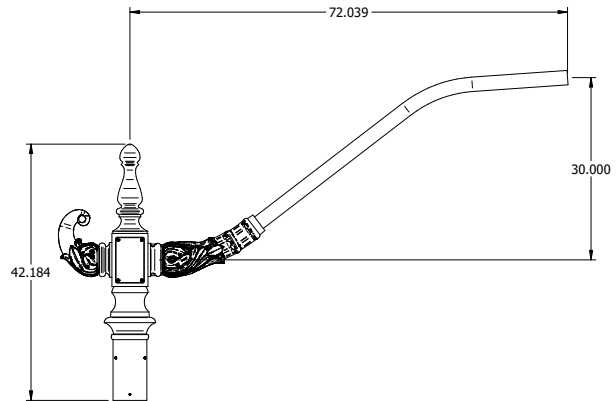

AA-10B COBRA BALBOA

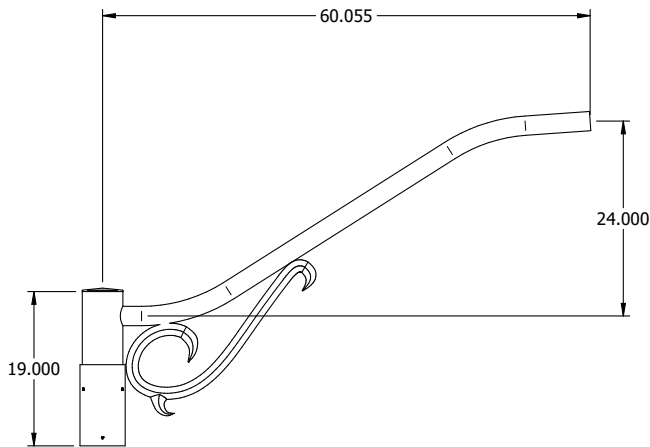

AA-10S COBRA SCROLL



# URBAN LUMINAIRE AMBER

URBAN STRIKE

## PENDANT MOUNT

\* Arms ordered separately, arms mount over an open top pole, they do not mount to a tenon.

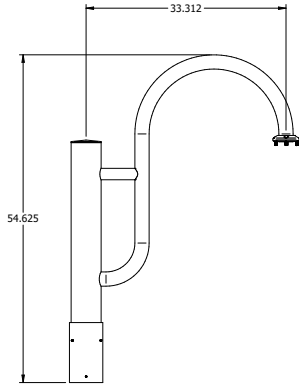
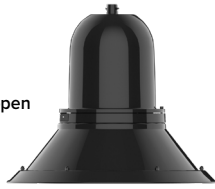

AA-42 RAILROAD SCS

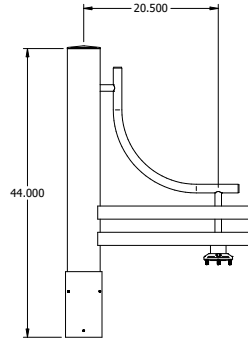

AA-40 SMALL PIERWALK

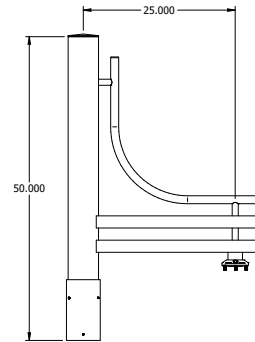

AA-38 LARGE PIERWALK

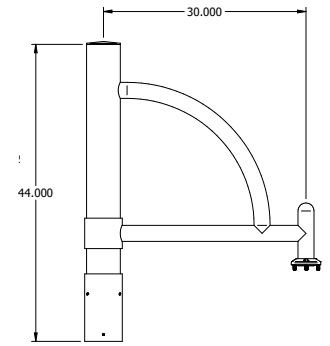

AA-49 RADIUS

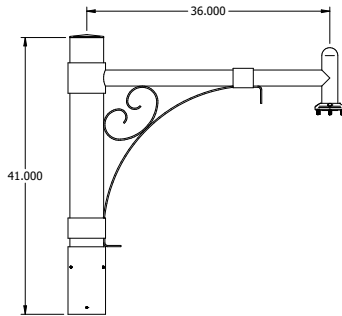

AA-27 STRATFORD

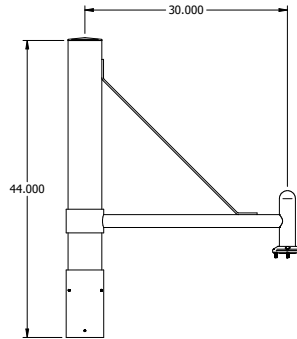

AA-44 STRUT

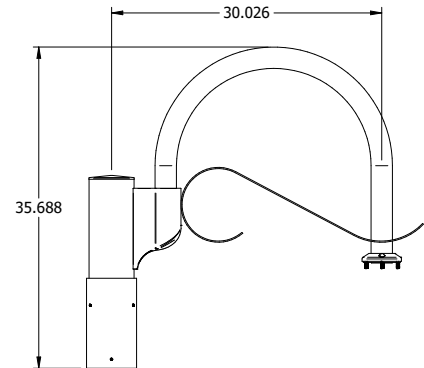

AA-45 TWIN EAGLES

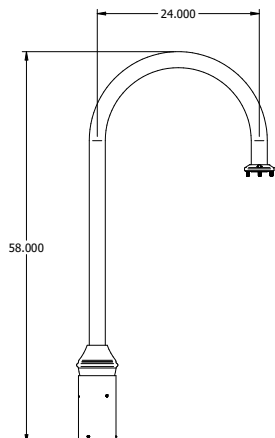

AA-39 RAILROAD

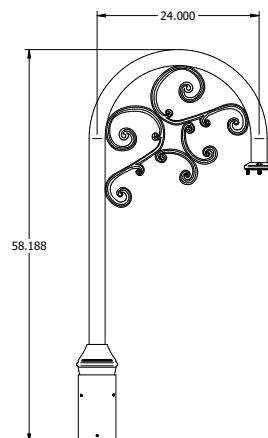

AA-39S RAILROAD SCROLL

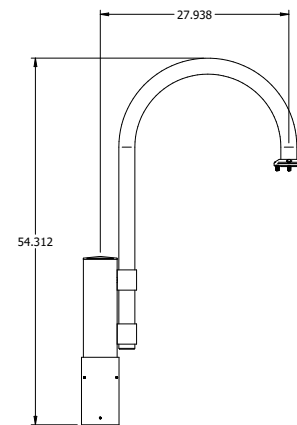

AA-41 RAILROAD STRAP

# URBAN LUMINAIRE AMBER

URBAN STRIKE

## MICRO STRIKE PHOTOMETRY

The following diagrams represent the general distribution options offered for this product. For detailed information on specific product configurations, see website photometric test reports.

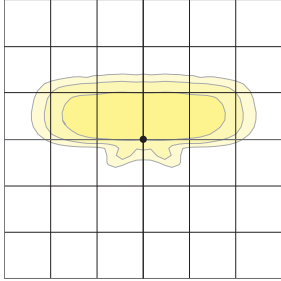
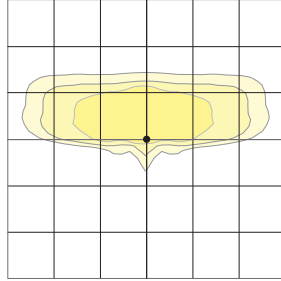
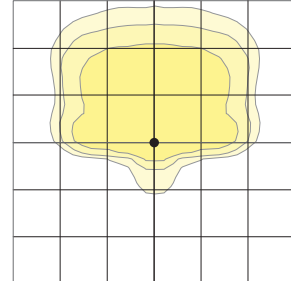
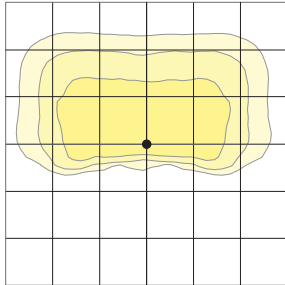
**Type 2**

**Type 3**

**Type 4F**

**Type 4W**

**Type 5QW**
