

WIN

WINDSOR LUMINAIRE

FEATURES

- The Windsor Series of 8-sided lanterns is available in 2 scaled sizes for different mounting heights
- Reliability and Technology are designed in to the classic lantern form factor
- IES Distributions
- Clear or Diffused Lensing
- Integral surge and thermal protection

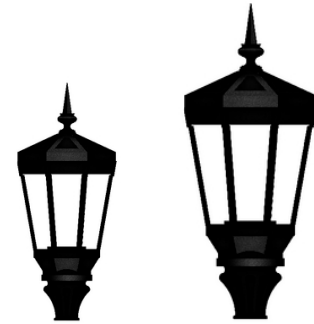

	Weight	EPA
WIN30	40 lbs	1.93 sq ft
WIN40	50 lbs	2.65 sq ft

SPECIFICATIONS

CONSTRUCTION

- The electrical chamber/fitter shall be cast aluminum
- Decorative fitter shall be designed to accommodate the driver assembly and shall be mounted to 3" OD x 3" H tenon and be secured by three or more stainless steel set screws
- Coated with a polyester finish that meets ASTM B117 corrosion test requirements and ASTM D522 cracking and loss of adhesion test requirements
- External hardware is corrosion resistant

ELECTRICAL

- 100V through 277V, 50 Hz to 60 Hz (UNV)
- Power factor is ≥ 0.90 at full load
- One piece optical cartridge system consisting of an LED engine, LED lamps, optics, gasket and stainless steel bezel
- Cartridge is held together with internal brass standoffs soldered to the board so that it can be field replaced as a one piece optical system

ELECTRICAL (CONTINUED)

- Polyurethane gasket ensures a weather-proof seal around each individual LED
- Fixture electrical compartment shall contain all LED driver components
- Rated ambient operating temperature -40°C to 40°C
- Lifeshield™ Circuit - protects luminaire from excessive temperature. The device shall activate at a specific, factory-preset temperature, and progressively reduce power over a finite temperature range
- 20kA surge protection standard

CONTROLS/OPTIONS

- Available with Energeni for optional set dimming, timed dimming with simple delay, or timed dimming based on time of night

FINISH

- IFS polyester powder-coat electrostatically applied and thermocured
- IFS finish consists of a five stage pretreatment regimen with a polymer primer sealer and top coated with a thermoset super TGIC polyester powder coat finish
- The finish meets the AAMA 2604 performance specification which includes passing a 3000 hour salt spray test for corrosion resistance and resists cracking or loss of adhesion per ASTM D522 and resists surface impacts of up to 160 inch-pounds

WARRANTY

- 5 year limited warranty

KEY DATA	
Lumen Range	3,000-11,600
Wattage Range	55-136
Efficacy Range (LPW)	61-89

WIN

WINDSOR LUMINAIRE

ORDERING GUIDE

Example: WIN40-AC-24L-55-5K-UNV-DIR2-PEC-PT-SPK-BLT

CATALOG # _____

ORDERING INFORMATION

Series	Lens Finish	Engine Watts	CCT	Voltage	Optics	Electrical Options
WIN30 Windsor 30"	AC Acrylic Clear	24L-55 4800 Lumens	3K7 3000K; 70CRI	UNV 120-277V	DIR2 Type 2	PEC Photocell, button ¹
WIN40 Windsor 40"	AF Acrylic Frosted	36L-80 7500 Lumens	4K7 4000K; 70CRI	347 347V	DIR3 Type 3	2PF Two Power Feeds ¹
	AS Acrylic Seeded	48L-110 10,000 Lumens	5K7 5000K; 70CRI	480 480V	DIR4 Type 4	
	AW Acrylic White	60L-136 12,000 Lumens			DIR5 Type 5	
	PC Polycarbonate Clear					
	PF Polycarbonate Frosted					
	PW Polycarbonate White					

Control Options	Mounting Options	Style Options	Color
GENI-XX¹ Energeni ²	PT Post Top	No Spikes	BLT Black Matte Textured
	PM Pendant Mount	S Spikes	BLS Black Gloss Smooth
			DBT Dark Bronze Textured
			DBS Dark Bronze Smooth
			GTT Graphite Matte Textured
			LGS Light Grey Gloss Smooth
			LGT Light Grey Matte Textured
			PSS Platinum Silver Smooth
			WHT White Matte Textured
			WHS White Gloss Smooth
			VGT Verde Green Textured
			Color Option
			CC Custom Color

Notes:

1 UNV (120-277V) only

2 Must specify routing setting code. See page 4 for details.

WIN

WINDSOR LUMINAIRE

PERFORMANCE DATA

CLEAR LENS

DESCRIPTION	Nominal Wattage	Distribution Type	5K (5000K nominal, 70CRI)					4K (4000K nominal, 70CRI)					3K (3000K nominal, 70CRI)				
			Lumens	LPW	B	U	G	Lumens	LPW	B	U	G	Lumens	LPW	B	U	G
WIN	55	2	4278	78	1	2	1	4363	79	1	2	1	4145	75	1	2	1
		3	4377	80	1	3	2	4465	81	1	3	2	4242	77	1	3	2
		4	4385	80	1	3	2	4473	81	1	3	2	4249	77	1	3	2
		5	4566	83	3	3	2	4657	85	3	3	2	4425	80	3	3	2
	80	2	6416	80	1	3	2	6545	82	1	3	2	6218	78	1	3	2
		3	6566	82	1	3	3	6698	84	1	3	3	6363	80	1	3	3
		4	6577	82	1	3	2	6709	84	1	3	2	6374	80	1	3	2
		5	6849	86	3	3	2	6986	87	3	3	3	6637	83	3	3	2
	110	2	8555	78	2	3	2	8726	79	2	3	2	8290	75	2	3	2
		3	8755	80	2	3	3	8930	81	2	3	3	8484	77	1	3	3
		4	8770	80	1	3	3	8945	81	1	3	3	8498	77	1	3	3
		5	9132	83	3	3	3	9315	85	4	3	3	8849	80	3	3	3
	136	2	10694	82	2	3	2	10908	84	2	3	2	10363	80	2	3	2
		3	10944	84	2	3	3	11163	86	2	3	3	10604	81	2	3	3
		4	10962	84	1	3	3	11182	86	2	3	3	10623	82	1	3	3
		5	11415	87	4	3	3	11644	89	4	3	3	11061	85	4	3	3

FROSTED LENS

DESCRIPTION	Nominal Wattage	Distribution Type	5K (5000K nominal, 70CRI)					4K (4000K nominal, 70CRI)					3K (3000K nominal, 70CRI)				
			Lumens	LPW	B	U	G	Lumens	LPW	B	U	G	Lumens	LPW	B	U	G
WIN	55	2	3461	63	1	3	2	3530	64	1	3	2	3354	61	1	3	2
		3	3539	64	1	3	3	3610	66	1	3	3	3429	62	1	3	3
		4	3478	63	1	3	3	3548	65	1	3	3	3371	61	1	3	3
		5	3711	67	2	3	3	3786	69	2	3	3	3596	65	2	3	3
	80	2	5191	65	2	3	3	5295	66	2	3	3	5030	63	1	3	3
		3	5308	66	1	3	3	5414	68	1	3	3	5144	64	1	3	3
		4	5218	65	1	3	3	5322	67	1	3	3	5056	63	1	3	3
		5	5567	70	3	3	3	5678	71	3	3	3	5395	67	3	3	3
	110	2	6922	63	2	3	3	7060	64	2	4	3	6707	61	2	3	3
		3	7078	64	2	4	4	7219	66	2	4	4	6858	62	2	3	4
		4	6957	63	1	4	4	7096	65	1	4	4	6741	61	1	3	4
		5	7423	67	3	4	3	7571	69	3	4	4	7193	65	3	4	3
	136	2	8652	62	2	4	4	8825	63	2	4	4	8384	60	2	4	3
		3	8847	64	2	4	4	9024	65	2	4	4	8573	62	2	4	4
		4	8696	62	2	4	5	8870	64	2	4	5	8427	61	2	4	4
		5	9279	67	3	4	4	9464	68	3	4	4	8991	64	3	4	4

ENERGENI ROUTINE SETTING CHART

The ENERGENI has flexible setting options to work with fixtures activated by photocontrols or time clocks. The delay and dimming level options can be configured at the factory or reconfigured at will in the field without the need for special cables or computers.

Examples:

GENI-01 Set Dimming @100%

GENI-06 Dimming Based on Hours of Operation - Dim to 20% after 9 hours

GENI-19 Dimming Based on Time of Night - Dim to 20% at 10:00 PM

Routine Number	Switch Settings (0=Down, 1=Up)					Brightness %	"Simple Delay (hrs)"	"Variable Delay Estimated Time"
	Switch 1	Switch 2	Switch 3	Switch 4	Switch 5			
01	0	0	0	0	0	100	0	
02	1	0	0	0	0	20	0	
03	0	1	0	0	0	20	3	
04	1	1	0	0	0	20	5	
05	0	0	1	0	0	20	7	
06	1	0	1	0	0	20	9	
07	0	1	1	0	0	40	0	
08	1	1	1	0	0	40	3	
09	0	0	0	1	0	40	5	
10	1	0	0	1	0	40	7	
11	0	1	0	1	0	40	9	
12	1	1	0	1	0	60	0	
13	0	0	1	1	0	60	3	
14	1	0	1	1	0	60	5	
15	0	1	1	1	0	60	7	
16	1	1	1	1	0	60	9	
17	0	0	0	0	1	20		6:00 PM
18	1	0	0	0	1	20		8:00 PM
19	0	1	0	0	1	20		10:00 PM
20	1	1	0	0	1	20		12:00 AM
21	0	0	1	0	1	20		2:00 AM
22	1	0	1	0	1	40		6:00 PM
23	0	1	1	0	1	40		8:00 PM
24	1	1	1	0	1	40		10:00 PM
25	0	0	0	1	1	40		12:00 AM
26	1	0	0	1	1	40		2:00 AM
27	0	1	0	1	1	40		4:00 AM
28	1	1	0	1	1	60		6:00 PM
29	0	0	1	1	1	60		8:00 PM
30	1	0	1	1	1	60		10:00 PM
31	0	1	1	1	1	60		12:00 AM
32	1	1	1	1	1	60		2:00 AM

WIN

WINDSOR LUMINAIRE

DIMENSIONS

WIN40

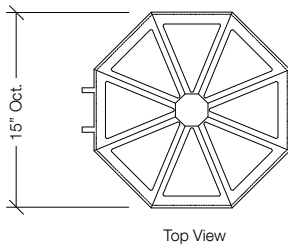
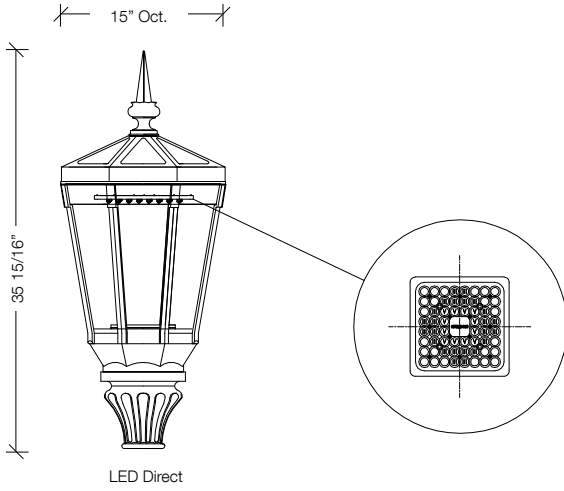

WIN30

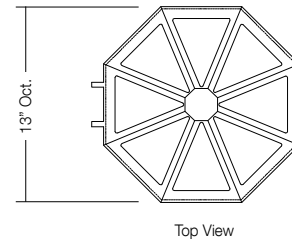
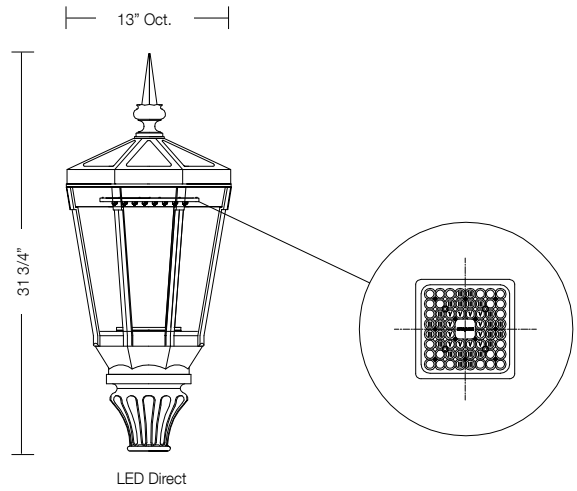

MOUNTING AND STYLE OPTIONS

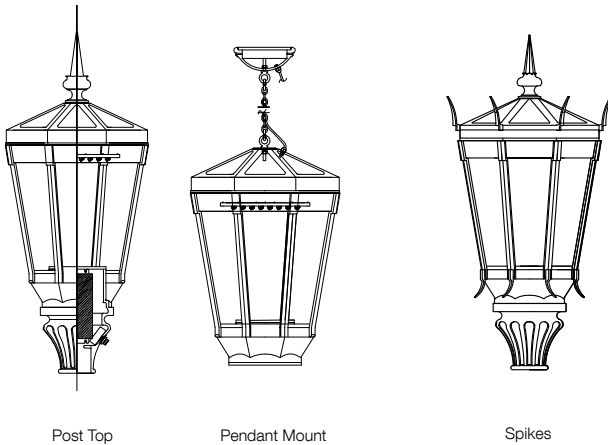

WIN

WINDSOR LUMINAIRE

POST TOP MOUNTING

Mounts to 3" OD x 3" H tenon and secured by three stainless steel screws.

COMPATIBLE ARMS

TWIN CITY (AA-65)

GRANDVILLE (AA-25)

SWAN SCROLL (AA-62)

16" SCROLL (AA-52)

TWIN CITY (AA-65)

DETAILS

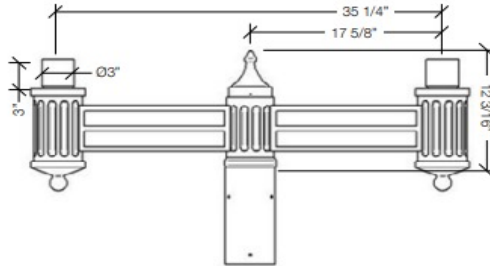

WALL BRACKET DETAILS

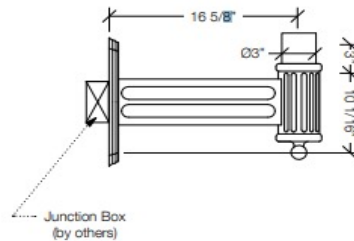

GRANDVILLE (AA-25)

DETAILS

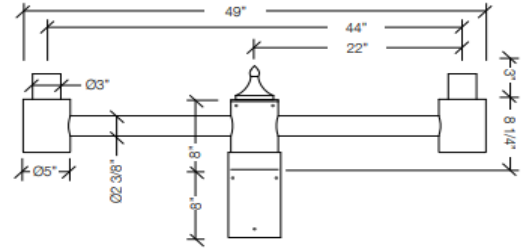

WALL BRACKET DETAILS

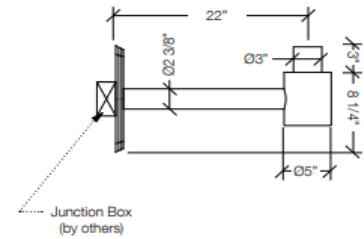

SWAN SCROLL (AA-62)

DETAILS

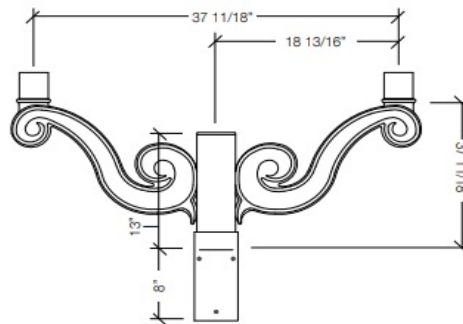

WALL BRACKET DETAILS

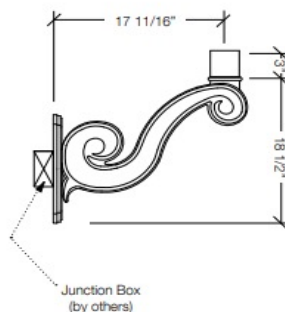

16" SCROLL (AA-52)

DETAILS

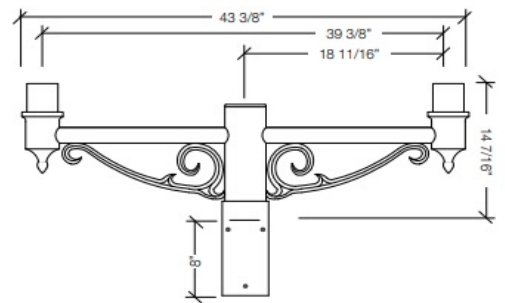

WALL BRACKET DETAILS

