

DATE:	LOCATION:
TYPE:	PROJECT:
CATALOG #:	

FEATURES

- A versatile, pedestrian-scale decorative luminaire designed for ultimate flexibility in LED pendant and catenary lighting applications
- Featuring two different optical technologies, Strike and Micro Strike Optics, which provide the best distribution patterns for retrofit or new construction
- Shade options available to enhance the product design and match any application
- Features decorative die-cast aluminum cage



Pierwalk

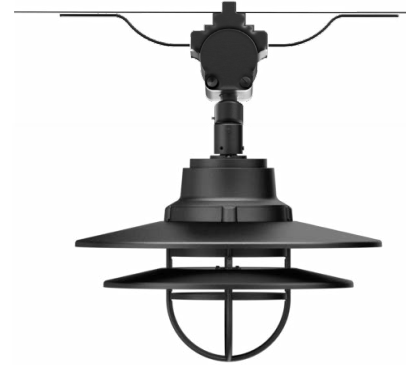

Pierwalk Catenary Mount
(Catenary mount by others)

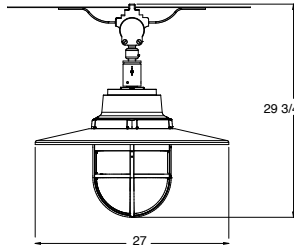

	WEIGHT		EPA (FT2) TOTAL
	SINGLE SHADE	TWO SHADES	
SLD2	15.05lbs / 6.83 kgs	17.70 lbs / 8.02 kgs	0.77 - 0.94

SPECIFICATIONS

CONSTRUCTION

- Driver housing is made of die-cast aluminum
- Shade shall be made from a one-piece aluminum spinning
- Corrosion resistant, die-cast aluminum housing with 1000 hour powder coat paint finish
- For pendant and catenary configurations, the housing is designed to be mounted in place with a stainless-steel safety pin and then permanently held in place with four stainless steel bolts
- External hardware is stainless steel
- Optional frosted lens is made from a durable acrylic material

OPTICS

- Micro Strike Optics (80L LED count) maximize uniformity in applications and come standard with mid-power LEDs which evenly illuminate the entire luminous surface area to provide a low glare appearance. Catalog logic found on page 2
- Strike Optics (18L LED count) provide best in class distributions and maximum pole spacing in new applications with high powered LEDs. Strike optics are held in place with a polycarbonate bezel to mimic the appearance of the Micro Strike Optics so both solutions can be combined on the same application. Catalog logic found on page 3
- Both optics maximize target zone illumination with minimal losses at the house-side, reducing light trespass issues. Additional backlight control shields can be added for further reduction of illumination behind the pole

- One-piece silicone gasket ensures a weatherproof seal
- All optics are field and factory rotatable
- Listed to UL1598 and CSA22.2 #250.0-24 for wet locations and 40C ambient temperatures

ELECTRICAL

- Universal 120-277 VAC or 347-480 VAC input voltage, 50/60 Hz
- Ambient operating temperature -40°C to 40°C
- Drivers have greater than 90% power factor and less than 20% THD
- LED drivers have output power over-voltage, over-current protection, and short circuit protection with auto recovery
- Field replaceable surge protection device provides 20kA protection meeting ANSI/ IEEE C62.41.2 Category C High and Surge Location Category C3; Automatically takes fixture off-line for protection when device is compromised

CONTROLS

- 0-10V Dimming Drivers are standard and dimming leads are extended out of the luminaire unless control options require connection to the dimming leads. Must specify if wiring leads are to be greater than the 6" standard
- The housing is designed for an optional twist lock photo control receptacle

CERTIFICATIONS

- Listed to UL1598 and CSA C22.2#250.0-24 for wet locations and 40°C ambient temperatures
- 1.5 G rated for ANSI C136.31 high vibration applications
- Luminaire light engine is IP65 rated
- Meets IDA recommendations using 3K CCT configuration with no lensing
- This product qualifies as a "designated country construction material" per FAR 52.225-11 Buy American-Construction Materials under Trade Agreements effective 04/23/2020.

WARRANTY

- 5 year warranty

DATE: _____ LOCATION: _____
 TYPE: _____ PROJECT: _____
 CATALOG #: _____

ORDERING GUIDE

Example: PIE2-CM-80L-25-4K7-2-UNV-BC-LS-PC-ADD-BLS

CATALOG #

Series	Mounting	# LED's - Wattage	CCT-CRI	Distribution	Voltage
PIE2	CM Catenary Mount	80L-25	AM ** Amber Monochromatic	80L Only	UNV (120-277VAC) 347V 480V
		80L-39	AP * Amber Phosphor Converted	2 Type 2	
		80L-50	27K8 2700K 80CRI	3 Type 3	
		80L-70	3K7 3000K 70 CRI	4W Type 4 Wide	
		80L-90	3K8 3000K 80CRI	4F Type 4 Forward	
		18L-15	35K8 3500K 80CRI	5QW Type 5 Square Wide	
		18L-20	4K7 4000K 70CRI	18L Only	
		18L-25	4K8 4000K 80CRI	2 Type 2	
		18L-30	5K7 5000K 70CRI	3 Type 3	
		18L-39	5K8 5000K 80CRI	4W Type 4 Wide	
		18L-50	* 80L only	4F Type 4 Forward	
		18L-70	** 18L only	5QW Type 5 Square Wide	
				FR Front Row	
				5W Type 5 Wide	
				5QN Type 5 Square Narrow	
		5QM Type 5 Square Medium			
		5RW Type 5 Rectangular			
		C Corner Optic			
		TC Tennis Court			

Options	Shade Options	Photocontrol	Programmed Controls	Colors
BC Backlight Control	LS Large Shade SS Small Shade EQS Equal Shade UQS Unequal Shade	PC Button Photocell	ADD AutoDim Timer Based Dimming ADT AutoDim Time of Day Dimming	BLS Black Gloss Smooth BLT Black Matte Textured DBS Dark Bronze Gloss Smooth DBT Dark Bronze Matte Textured GTT Graphite Matte Textured LGS Light Gray Gloss Smooth LGT Light Gray Matte Textured PSS Platinum Silver Gloss Smooth VGT Verde Green Matte Textured WHS White Gloss Smooth WHT White Matte Textured
				Color Options
				CC Custom Color CLA ¹ Clear Anodized Finish

Note:

¹ Recommended for harsh environments, salt spray 3,000 hrs rated.

DELIVERED LUMENS – PENDANT / CATENARY NO LENS

# Of LEDs	Nominal		Distribution Type	5K (5000K NOMINAL 70 CRI)				4K (4000K NOMINAL 70 CRI)				3K (3000K NOMINAL 70 CRI)						
				Lumen	Bug Rating			Lumen	Bug Rating			Lumen	Bug Rating					
					B	U	G		B	U	G		B	U	G			
80	25	24.7	2	3290	1	0	1	133	3290	1	0	1	133	3217	1	0	1	130
			3	3325	1	0	1	135	3325	1	0	1	135	3250	1	0	1	132
			4F	3375	1	0	1	137	3375	1	0	1	137	3299	1	0	1	134
			4W	3407	1	0	1	138	3407	1	0	1	138	3331	1	0	1	135
			5QW	3450	3	0	1	140	3450	3	0	1	140	3373	2	0	1	137
	39	38.4	2	4975	1	0	1	130	4975	1	0	1	130	4863	1	0	1	127
			3	5027	1	0	1	131	5027	1	0	1	131	4915	1	0	1	128
			4F	5103	1	0	2	133	5103	1	0	2	133	4988	1	0	2	130
			4W	5151	1	0	2	134	5151	1	0	2	134	5036	1	0	2	131
			5QW	5217	3	0	1	136	5217	3	0	1	136	5100	3	0	1	133
	50	49	2	5922	1	0	1	121	5922	1	0	1	121	5790	1	0	1	118
			3	5985	2	0	2	122	5985	2	0	2	122	5851	1	0	2	119
			4F	6074	1	0	2	124	6074	1	0	2	124	5938	1	0	2	121
			4W	6133	1	0	2	125	6133	1	0	2	125	5995	1	0	2	122
			5QW	6210	3	0	2	127	6210	3	0	2	127	6071	3	0	1	124
	70	68.6	2	7472	1	0	1	109	7472	1	0	1	109	7305	1	0	1	106
			3	7551	2	0	2	110	7551	2	0	2	110	7382	2	0	2	108
			4F	7664	1	0	2	112	7664	1	0	2	112	7492	1	0	2	109
			4W	7737	1	0	2	113	7737	1	0	2	113	7564	1	0	2	110
			5QW	7836	3	0	2	114	7836	3	0	2	114	7660	3	0	2	112
90	89.7	2	8772	2	0	2	98	8772	2	0	2	98	8575	2	0	2	96	
		3	8864	2	0	2	99	8864	2	0	2	99	8666	2	0	2	97	
		4F	8997	1	0	2	100	8997	1	0	2	100	8795	1	0	2	98	
		4W	9083	1	0	2	101	9083	1	0	2	101	8880	1	0	2	99	
		5QW	9198	4	0	2	103	9198	4	0	2	103	8992	4	0	2	100	

ELECTRICAL DATA

# LED's	Nominal Wattage	Input Voltage [Volts]	Oper. Current [Amps]	System Power [Watts]
80	25	120	0.20	24.5
		208	0.12	
		240	0.10	
		277	0.09	
		347	0.07	
		480	0.05	
	39	120	0.32	38.4
		208	0.18	
		240	0.16	
		277	0.14	
		347	0.11	
		480	0.08	
	50	120	0.41	49
		208	0.24	
		240	0.20	
		277	0.18	
		347	0.14	
		480	0.10	
	70	120	0.57	68.6
		208	0.33	
		240	0.29	
		277	0.25	
		347	0.20	
		480	0.14	
90	120	0.75	89.7	
	208	0.43		
	240	0.37		
	277	0.32		
	347	0.26		
	480	0.19		

PROJECTED LUMEN MAINTENANCE

OPERATING HOURS						
AMBIENT TEMP.	0	25,000	"**TM-21-11 36,000"	50,000	100,000	CALCULATED L70 (HOURS)
25°C / 77°F	1.00	0.97	0.96	0.95	0.91	408,000
40°C / 104°F	0.99	0.96	0.95	0.94	0.89	356,000

TEMPERATURE FACTOR (LATF)

AMBIENT TEMPERATURE		LUMEN MULTIPLIER
0°C	32°F	1.03
10°C	50°F	1.01
20°C	68°F	1.00
25°C	77°F	1.00
30°C	86°F	0.99
40°C	104°F	0.98
50°C	122°F	0.97

MICRO STRIKE LUMEN MULTIPLIER

CCT	70 CRI	80 CRI
2700K	-	0.841
3000K	0.977	0.861
3500K	-	0.900
4000K	1	0.926
5000K	1	0.937
MONOCHROMATIC AMBER MULTIPLIER		
Amber	0.25	

STRIKE LUMEN MULTIPLIER

CCT	70 CRI	80 CRI
2700K	-	0.810
3000K	0.933	0.853
3500K	-	0.894
4000K	1	0.900
5000K	1	0.900
MONOCHROMATIC AMBER MULTIPLIER		
Amber	0.25	

EPA

DESCRIPTION	EPA (FT2) TOTAL
Pendant/ Catenary with Large Shade (PIE2-PM-LS)	0.77
Pendant/ Catenary with Small Shade (PIE2-PM-SS)	0.66
Pendant/ Catenary with Equal Shades (PIE2-PM-EQS)	0.82
Pendant/ Catenary with Unequal Shades (PIE2-PM-UQS)	0.94

DIMENSIONS

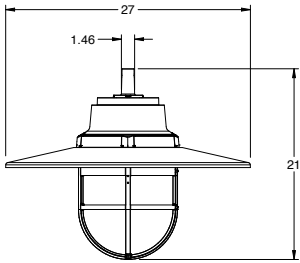

PIE2-PM-LS

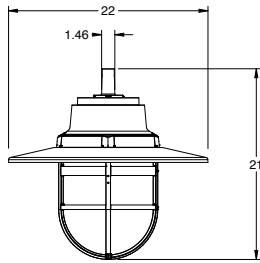

PIE2-PM-SS

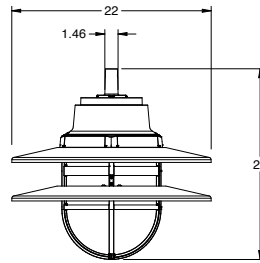

PIE2-PM-EQS

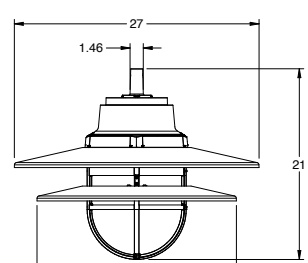

PIE2-PM-UQS

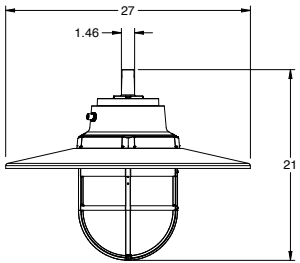

PIE2-PM-LS-PC

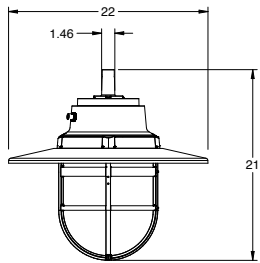

PIE2-PM-SS-PC

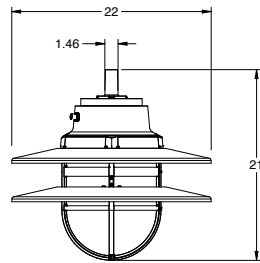

PIE2-PM-EQS-PC

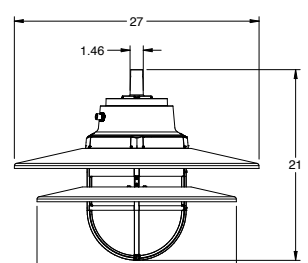

PIE2-PM-UQS-PC