

Parkway Square Sconce

FEATURES

- Seven distributions to choose from
- Integral egress lighting
- Available with highly efficient LEDs
- Six decorative screen options
- 3000K , 4000K, 5000K CCT
- Tamper resistant hardware

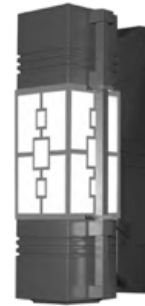

CONTROL TECHNOLOGY



SPECIFICATIONS

HOUSING

- Parkway Square housings shall be cast aluminum, A356 alloy, free of any porosity, foreign materials, or cosmetic fillers
- Vertical lens shall be opal, semi translucent high impact injection molded lighting grade acrylic and shall not be field replaceable
- Vertical struts shall be cast aluminum and painted to match the fixture. The lens shall be sealed to the housing with a molded silicone gasket on the top and bottom
- Lamp compartment shall have a molded silicone plug to completely seal the optical system from insects or dirt emanating from the electrical box or conduit
- Four stainless steel screws shall release the canopy to allow electrical access. All internal and external hardware shall be stainless steel and zinc
- Wall plate shall be secured into wall over j-box and shall be wired to the power circuit. Fixture shall be attached to the wall plate by four set-screws
- Fixture finish shall consist of a five stage pretreatment regimen with a polymer primer sealer, oven dry off, and top coated with a thermoset super TGIC polyester powder coat finish. The finish shall meet the AAMA 605.2 performance specification which includes passing a 3000 hour salt spray test for corrosion resistance

LED/OPTICS

- Optical lens frame shall be secured with four captive socket cap screws and shall be sealed with a one piece memory retentive, molded silicone gasket
- Reflector is formed aluminum with bright dip anodized finish for pedestrian scale and bead blasted finish for accent scale fixtures

ELECTRICAL

- Ballast or LED driver electrical assembly shall be integral to the fixture and mounted to the cast canopy, the electrical assembly shall be prewired with a quick disconnect plug and removable by loosening two screws. All metal halide ballasts shall be electronic
- T6 metal halide lamps shall use G12 sockets; R111 lamps shall use GX8.5 sockets; PL-L fluorescent lamps shall use 2G11 sockets
- LED drivers shall have a drive current of 350mA. Standard color temperatures are 3000K, 4000K and 5000K
- Ballast or LED driver shall accept an input voltage of 120 through 277 volts
- The MR16 lamp for emergency egress feature shall be included and powered by 120 volt input transformed into low-voltage (12 volt) by the electronic transformer (included). The MR16 lamp shall use a miniature bi-pin base
- The fixture shall include an integral secondary source to provide path of egress illumination from building to the public way. The hidden MR16 lamp, powered as a remote head is able to be angle up to 15° in either direction

CONTROLS

- SCP shall have an integral surge protection device with a current rating of 10,000 Amps using the industry standard 8/20uSec wave and sure rating of 372J
- Sensor not intended for use with additional photo- control, wireless control or dimming systems

CERTIFICATIONS

- The fixture is listed with ETL for outdoor, wet location use and shall conform to UL1598 and Canadian CSA Std. C22.2 no.9

WARRANTY

- 5 year warranty

continued on page 3

KEY DATA	
Lumen Range	7,744–18,763
Wattage Range	87–173
Efficacy Range (LPW)	79–119
Weight	20 lbs 9.07 kg
EPA	1.4

ORDERING GUIDE

Example: PKSA-DB-15LED-NW-BLT-CPR-SCP

CATALOG #

Luminaire	Lamp/Ballast	Decorative Screen	Fixture Finish
<u>Accent (Small) Scale (Weight: 32 lbs)</u> PKSA DB Down beam PKSA DS Down spread PKSA UB Up beam PKSA US Up spread PKSA DBUS Down beam/Up spread PKSA USDS Up spread/Down spread <u>Pedestrian (Medium) Scale (Weight: 55 lbs)</u> PKSP DB Down beam PKSP DS Down spread PKSP UB Up beam PKSP US Up spread PKSP DBUS Down beam/Up spread PKSP UBDS Up beam/Down spread PKSP USDS Up spread/Down spread	PKSA - Small Houseing Scale LED (24 watts, Warm white (3000K), Neutral white (4000K), Bright white (5000K). Class 2, 120 thru 277 volt) 15LED-WW DB/DS/UB/US only 15LED-NW DB/DS/UB/US only 15LED-BW DB/DS/UB/US only 24LED-WW DBUS/UBDS/UB/USDS only 24LED-NW DBUS/UBDS/UB/USDS only 24LED-BW DBUS/UBDS/UB/USDS only PKSP - Pedestrian Houseing Scale LED (24 watts, Warm white (3000K), Neutral white (4000K), Bright white (5000K). Class 2, 120 thru 277 volt) 18LED-WW DB/DS/UB/US only 18LED-NW DB/DS/UB/US only 18LED-BW DB/DS/UB/US only 30LED-WW DBUS/UBDS/UB/USDS only 30LED-NW DBUS/UBDS/UB/USDS only 30LED-BW DBUS/UBDS/UB/USDS only	Painted to match fixture. Also available in stainless steel or copper. Not available with horizontal optics DSIN Infinity DSOF Offset DSWH Wheat DSTR Trio DSSH Shutter DSCS Custom	BLS Black Gloss Smooth BLT Black Matte Textured DBS Dark Bronze Gloss Smooth DBT Dark Bronze Matte Textured GTT Graphite Matte Texture LGS Light Grey Gloss Smooth LGT Light Grey Matte Textured PSS Platinum Silver Gloss Smooth VGT Verde Green Matte Textured WHS White Gloss Smooth WHT White Matte Textured CC Custom Color ¹

Options	Controls
<u>General</u> NEG No egress lamp. Opening is sealed with a cap and painted to match fixture <u>Decorative Screen</u> CPR Copper SSP Stainless Steel	SCP Sensor Control Programmable pole accessory is available to provide occupancy detection for outdoor applications meeting California Title 24.

Notes:

1 Consult factory for custom color, marine and corrosive finish

PHOTOMETRY

PKSP DS 18LED BW WATTAGE: 21.6 LUMEN OUTPUT: EFFICACY: 51.4 Lm/W

ZONE	LUMENS	%LUMINAIRE
0 - 30	297	26.8%
0 - 40	481	42.4%
0 - 60	808	72.7%
0 - 90	1005	90.5%
90 - 120	48	4.4%
90 - 180	106	9.5%
0 - 180	1110	100%

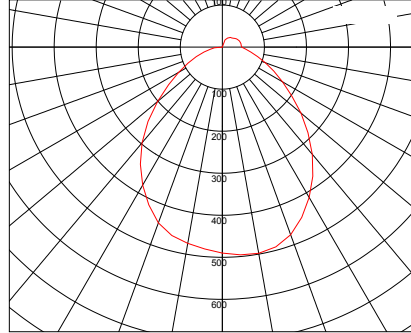

PKSP DS 70T6 WATTAGE: 94 LUMEN OUTPUT: EFFICACY: 16.8 Lm/W

ZONE	LUMENS	%LAMP	%LUMINAIRE
0 - 30	371	5.6%	23.4%
0 - 40	585	8.9%	37%
0 - 60	860	13%	54.4%
0 - 90	1089	16.5%	68.9%
90 - 120	212	3.2%	13.4%
90 - 180	492	7.5%	31.1%
0 - 180	1582	24.0%	100%

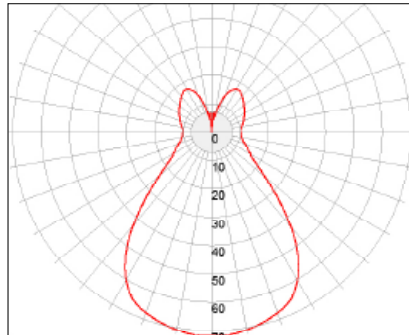

DIMENSIONS

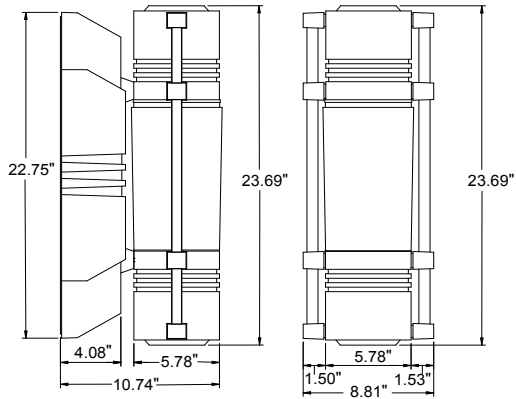

PKSA

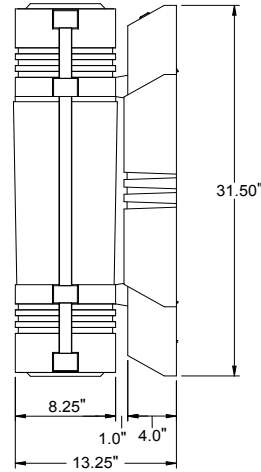
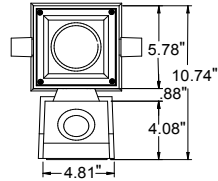

PKSP

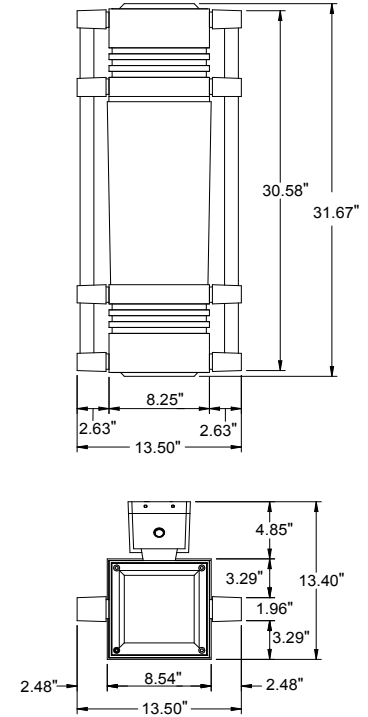

PRODUCT EXCEPTIONS & DETAILS

DECORATIVE SCREENS

Painted to match fixture. Also available in stainless steel or copper. Not available with horizontal optics.



DSIN
Infinity



DSOF
Offset



DSWH
Wheat

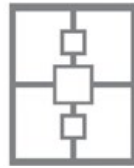

DSTR
Trio



DSSH
Shutter



DSCS
Custom