

## FEATURES

- The Parkway Square family is scaled in two sizes of luminaires and allows you to mix-and-match between four optical systems, and three hood styles
- Utilizes Strike Optics for precise distributions, maximum fixture spacing and minimal backlight.
- Type 2, 3, 4, and 5 distributions
- Post top, arm mount and wall mount configurations
- Lumen outputs ranging from 3600lm to 6400lm and up to 100lpw
- Full cutoff UO distributions available
- 2700K, 3000K, 3500K, 4000K, and 5000K
- 70, 80 and 90 CRI
- SCP pole mounted occupancy sensor is available for integrated controls capabilities

**IP65**



3000K and warmer CCTs only

**STRIKE**



ANG Angled Hood

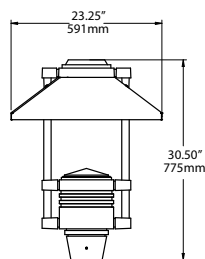

Parkway Square PKWM Horizontal

	WEIGHT	EPA (FT2) TOTAL
PKWM	57 lbs/ 25.85 kgs	2.35

## SPECIFICATIONS

### CONSTRUCTION

- All housing components shall be cast aluminum, sealed with continuous silicone rubber gaskets
- Hoods shall be of fabricated construction with seamless blended outside corners
- Secondary lens shall be clear flat tempered soda lime glass
- All internal and external hardware shall be stainless steel
- Luminaire finish shall consist of a five stage pretreatment regimen with a polymer primer sealer, oven dry off, and top coated with a thermoset super TGIC polyester powder coat finish
- Luminaire finish shall meet the AAMA 2604-05 performance specification which includes passing a 3000 hour salt spray test for corrosion resistance

### LED/OPTICS

- LEDs shall be mounted to a metal printed circuit board assembly (MCPCB) with a uniform conformal coating over the panel surface and electrical features

### LED/OPTICS (CONTINUED)

- LED optics shall be clear injection molded PMMA acrylic
- MCPCB and optic shall be sealed to a die-cast anodized aluminum heat sink with an injection molded silicone rubber gasket. IP66

### INSTALLATION

- Luminaire shall be attached to the arm assembly with four 1/4-20 stainless steel bolts. The connection shall be sealed with a silicone compression gasket.
- Pole mounted arms shall bolt to a square pole or a 4\"/>

### ELECTRICAL

- Luminaires shall have integral surge protection that shall be U.L. recognized and have a surge current rating of 10,000 Amps using the industry standard 8/20uSec wave and surge rating of 372J
- Drivers shall be U.L. recognized with an inrush current maximum of <20.0 Amps maximum at 230VAC

### CERTIFICATIONS

- Luminaire shall be listed with ETL for outdoor, wet location use, UL1598, UL 8750 and Canadian CSA Std. C22.2 no.250
- Fixture is IP65 rated

### WARRANTY

- 5 year warranty

DATE:	LOCATION:
TYPE:	PROJECT:
CATALOG #:	

## ORDERING GUIDE

Example: PKWM-ANG-Y3HC-32LED-4K7-500-BLS-PSA-TU

CATALOG #

### HOUSING

PKWM										
Luninaire		Hood	Distribution	Color Temperature		Drive Current	Fixture Finish			
PKWM	Parkway Square Accent (small scale)	ANG	Angled	Horizontal LED - Clear Lens	32LED27K8	2700K, 80 CRI	(120–277) VAC input	BLS	Black Gloss Smooth	
				Y2HC	Y2HC	32LED3K7	3000K, 70 CRI	500	500mA, 53 watts	BLT
			Y3HC	Y3HC	32LED3K8	3000K, 80 CRI	700	688mA, 73 watts	DBS	Dark Bronze Gloss Smooth
			Y4HC	Y4HC	32LED35K8	3500K, 80 CRI			DBT	Dark Bronze Matte Textured
			Y5HC	Y5HC	32LED3K9	3000K, 90 CRI			GTT	Graphite Matte Textured
			Horizontal LED - Diffused Lens	32LED4K7	4000K, 70 CRI			LGS	Light Grey Gloss Smooth	
			Y2HD	Y2HD	32LED4K8	4000K, 80 CRI			LGT	Light Grey Matte Textured
			Y3HD	Y3HD	32LED5K7	5000K, 70 CRI			PSS	Platinum Silver Gloss Smooth
			Y4HD	Y4HD	Consult factory for other CCTs and CRIs				VGTT	Verde Green Matte Textured
			Y5HD	Y5HD					WHS	White Gloss Smooth
									WHT	White Matte Textured
									Color Option	
									CC	Custom Color <sup>1</sup>

Options	Mounting
SF Single Fuse (120, 277V)	Standard fixture shall slip over a 4" / 100mm open top square pole or tenon or may choose one
DF Double Fuse (208, 240V)	
	<b>Tenon Mount</b>
	TA23 Tenon adapter slips over 2 3/8" O.D x 4" long tenon. Required for poles by others or used in conjunction with TEN pole option by AAL
	<b>Wall Mount Bracket</b>
	PSWM-TU Fixture above with arm mounted up
	PSWM-TD Fixture above with arm mounted down
	PSWM-BU Fixture below with arm mounted up
	PSWM-BD Fixture below with arm mounted down
	<b>Pole Mounted Bracket</b>
	Mounts to the side of a 4" / 102mm diameter pole or post, must specify round or square pole or post
	PSA-TU Fixture above with arm mounted up
	PSA-TD Fixture above with arm mounted down
	PSA-BU Fixture below with arm mounted up
	PSA-BD Fixture below with arm mounted down
	Visit <a href="http://currentlighting.com/aal">currentlighting.com/aal</a> for Arms, Poles & Accessories Specification Guide

### Current Control Solutions — Accessories (Sold Separately)

☐ SCP Sensor Control Programmable ([view product page](#))

Pole accessory is available to provide occupancy detection for outdoor applications meeting California Title 24

For additional information related to these accessories please visit [currentlighting.com](http://currentlighting.com). Options provided for use with integrated sensor, please view specification sheet ordering information table for details.

Notes:

<sup>1</sup> Consult factory for custom color, marine and corrosive finish

DATE: \_\_\_\_\_ LOCATION: \_\_\_\_\_

TYPE: \_\_\_\_\_ PROJECT: \_\_\_\_\_

CATALOG #: \_\_\_\_\_

## OUTDOOR LIGHTING CONTROLS OPTIONS    CONTROLS FUNCTIONALITY

	Control Option Ordering Logic & Description	Control Option Functionality								Control Option Components	
		Networkable	Grouping	Scheduling	Occupancy/ Motion	Daylight Harvesting	0-10V Dimming	On/Off Control	Bluetooth App Programming		Sensor Height
Independent	SCP Sensor Control Programmable, 8F or 40F	-	-	-	✓	✓	✓	✓	-	8ft or 40ft	

## COVERAGE PATTERNS FOR SCP

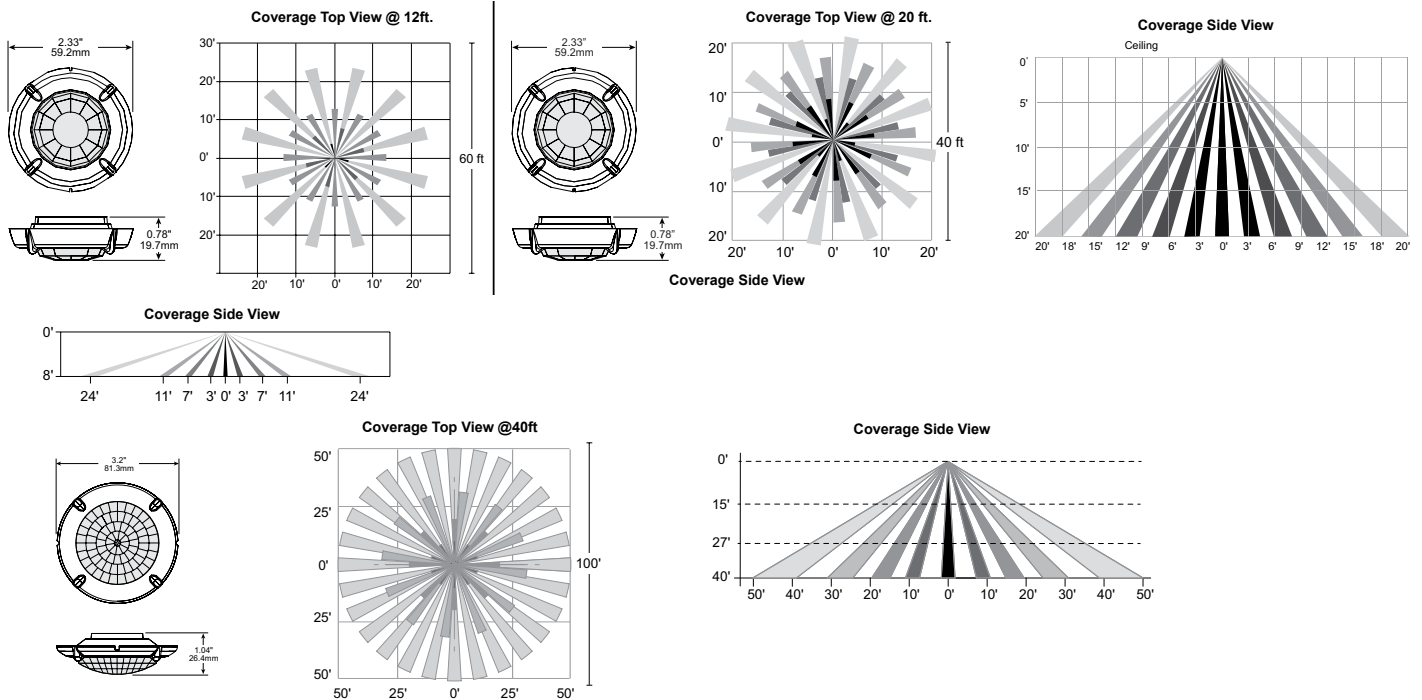

Notes:

1 Consult factory for custom color, marine and corrosive finish

DATE:	LOCATION:
TYPE:	PROJECT:
CATALOG #:	

## DIMENSIONS

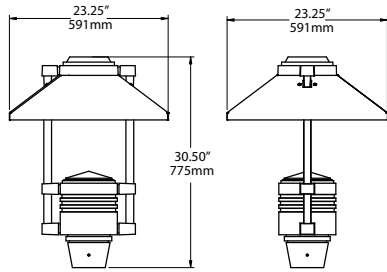

POST TOP  
WT: 57 lbs. EPA: 2.35

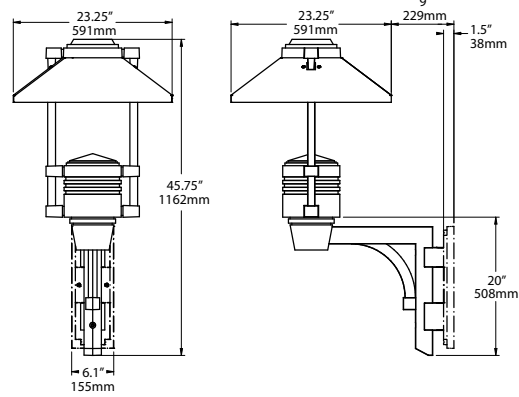

PSA-TU  
(Top of Arm Mounted Luminaire  
Upward Swept Arm Design)  
WT: 65 lbs. EPA: 2.83

PSWM-TU  
(Top of Wall Mounted Luminaire  
Upward Swept Arm Design)  
WT: 69 lbs. EPA: 3.05

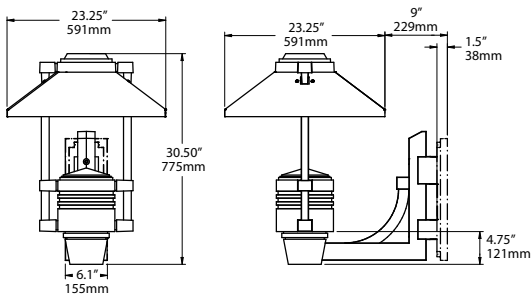

PSA-TD  
(Top of Arm Mounted Luminaire  
Downward Swept Arm Design)  
WT: 65 lbs. EPA: 2.83

PSWM-TD  
(Top of Wall Mounted Luminaire  
Downward Swept Arm Design)  
WT: 69 lbs. EPA: 3.05

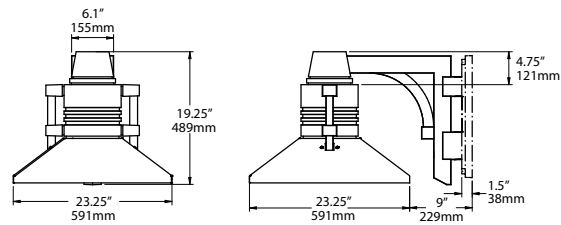

PSA-BU  
(Below Arm Mounted Luminaire  
Upward Swept Arm Design)  
WT: 65 lbs. EPA: 2.54

PSWM-BU  
(Below Wall Mounted Luminaire  
Upward Swept Arm Design)  
WT: 69 lbs. EPA: 2.76

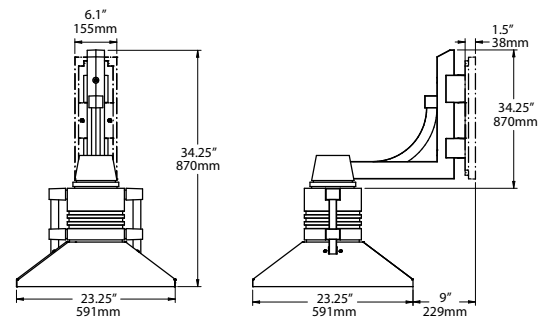

PSA-BD  
(Below Arm Mounted Luminaire  
Downward Swept Arm Design)  
WT: 65 lbs. EPA: 2.54

PSWM-BD  
(Below Wall Mounted Luminaire  
Downward Swept Arm Design)  
WT: 69 lbs. EPA: 2.76

## LUMEN OUTPUT

Drive Current	System Watts	Lens	Distribution	Light Engine	3000K			4000K			5000K		
					Delivered Lumens	Efficacy (lm/w)	BUG Rating	Delivered Lumens	Efficacy (lm/w)	BUG Rating	Delivered Lumens	Efficacy (lm/w)	BUG Rating
500	50	Clear	2	Y2HC	4798	96	B1-U0-G1	4921	98	B1-U0-G1	4978	100	B1-U0-G1
	50.2		3	Y3HC	4766	95	B1-U0-G1	4888	97	B1-U0-G1	4943	98	B1-U0-G1
	50		4	Y4HC	4670	93	B1-U0-G1	4790	96	B1-U0-G1	4843	97	B1-U0-G1
	50		5	Y5HC	4608	92	B3-U0-G1	4726	95	B3-U0-G1	4781	96	B3-U0-G1
700	71.3		2	Y2HC	6185	87	B2-U0-G2	6344	89	B2-U0-G2	6417	90	B2-U0-G2
	70.5		3	Y3HC	6144	87	B1-U0-G1	6300	89	B1-U0-G1	6373	90	B1-U0-G1
	71		4	Y4HC	5993	84	B1-U0-G1	6149	87	B1-U0-G1	6218	88	B1-U0-G1
	71		5	Y5HC	5917	83	B3-U0-G1	6069	85	B3-U0-G1	6138	82	B3-U0-G1
500	50	Diffused	2	Y2HD	3858	77	B1-U0-G1	3957	79	B1-U0-G1	4001	80	B1-U0-G1
	49.9		3	Y3HD	3753	75	B1-U0-G1	3849	77	B1-U0-G1	3893	78	B1-U0-G1
	50		4	Y4HD	3720	74	B1-U0-G1	3816	76	B1-U0-G1	3861	77	B1-U0-G1
	50		5	Y5HD	3636	73	B1-U0-G1	3729	75	B1-U0-G1	3772	75	B1-U0-G1
700	71		2	Y2HD	4964	70	B2-U0-G1	5091	72	B2-U0-G1	5148	73	B2-U0-G1
	72.8		3	Y3HD	4821	66	B2-U0-G1	4944	68	B2-U0-G1	5001	69	B2-U0-G1
	71		4	Y4HD	4776	67	B2-U0-G1	4898	69	B2-U0-G1	4953	70	B2-U0-G1
	72		5	Y5HD	4695	65	B2-U0-G1	4816	68	B2-U0-G1	4871	65	B2-U0-G1

Strike Lumen Multiplier			
CCT	70 CRI	80 CRI	90 CRI
2700K	0.9	0.81	0.62
3000K	0.933	0.853	0.659
3500K	0.959	0.894	0.711
4000K	1	0.9	0.732
5000K	1	0.9	0.732

## TM-30 DATA

### COLOR VECTOR GRAPHIC

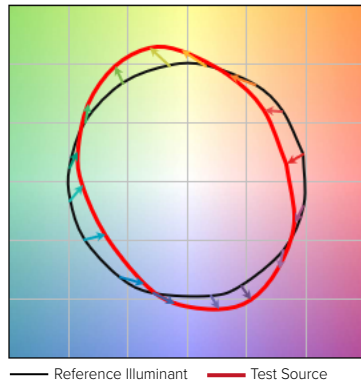

### TEST SOURCE

MBM Test Results	
CCT (K)	3947
CIE Ra	72
Duv	0.0004
x	0.3831
y	0.3793
Rf	68
Rg	99

### SPECTRAL POWER DISTRIBUTION COMPARISON

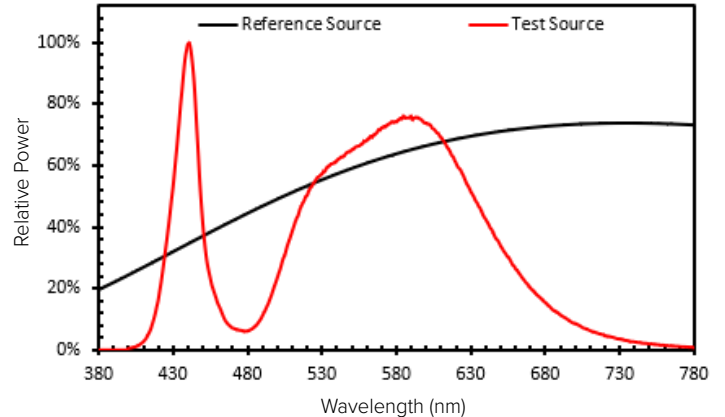

## ELECTRICAL CHARACTERISTICS

Optical System	Ordering Code		Electrical Characteristics							Inrush Current				Dimming	
			LED Drive mA	System Watts	Amps AC		Min. Power Factor	Max THD (%)	Operating Temp. Range	120V		277V		Dimming Range	Source Current out of 0-10V Purple Wire
					120	277				Ipeak (A)	T(@50% of Ipeak)	Ipeak (A)	T(@50% of Ipeak)		
YLED	32LED	500	500	50	0.4	0.2	0.9	15	-30°C to +60°C	50	142 μS	116	138 μS	5% to 10%	150 μA
		700	688	71	0.6	0.3									

TM-21 Lifetime Calculation - Projected Lumen Maintenance								
Optical System	Ordering Code	Ambient Environment °C	Projected Lumen Maintenance (% vs. Khrs)					Reported L70
			15	25	50	60	100	
YLED	32LED	15	98	97	96	95	93	>60Khrs
		25	96	96	94	93	90	
		40	96	94	91	90	86	

## LED COLOR

	Ordering Code		
	3K	4K	5K
CCT Average	3000K	4000K	5000K
CRI Minimum	≥ 70	≥ 70	≥ 70

## WIRING LEADS

- Luminaires not configured with a control system or ANSI C136 receptacle option are provided with 0-10 purple and pink dimming leads

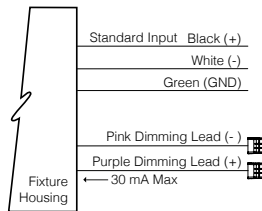

DATE:	LOCATION:
TYPE:	PROJECT:
CATALOG #:	

## STRIKE PHOTOMETRY

The following diagrams represent the general distribution options offered for this product. For detailed information on specific product configurations, see website photometric test reports.

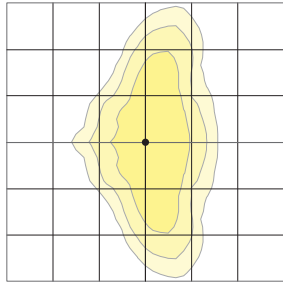

**PKWM-ANG-Y2HC-32LED-3K-500**  
Lumen Output: 4798  
Showing 0.1fc, 0.2fc, and 0.5fc

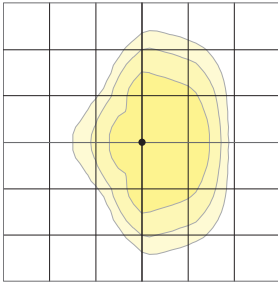

**PKWM-ANG-Y3HC-32LED-3K-500**  
Lumen Output: 4766  
Showing 0.1fc, 0.2fc, and 0.5fc

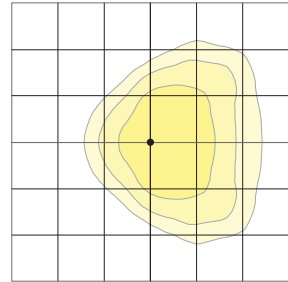

**PKWM-ANG-Y4HC-32LED-3K-500**  
Lumen Output: 4670  
Showing 0.1fc, 0.2fc, and 0.5fc

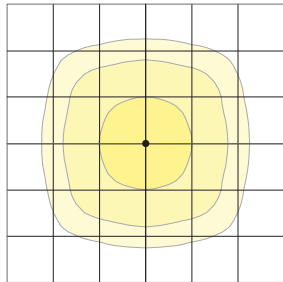

**PKWM-ANG-Y5HC-32LED-3K-500**  
Lumen Output: 4608  
Showing 0.1fc, 0.2fc, and 0.5fc

MOUNTING HEIGHT	SCALE
15ft	20ft