



### FEATURES

- Housing depth of only 1½" – no taller than standard T-bar
- Does not intrude into usable plenum space
- Unique telescoping housing minimizes installation depth and simplifies installation
- Long-life, 60,000 hour LEDs at L80 (80% lumen maintenance) reduce life cycle maintenance costs
- Four LED color choices
- Eight lumen packages ranging from 2600 to 9100 nominal lumens at up to 112 lumens per watt
- Superior color consistency to a 3-step MacAdam ellipse and 82 CRI
- Soft, uniform light distribution provides excellent vertical illumination free from harsh contrast
- Surface mount depth only 1⅞". Using an enclosing shell that combines with standard LZPT recessed fixtures, the surface mount housing can be ordered with the fixture or separately
- Multiple driver options to satisfy different applications
- LED modules and electrical accessible from below
- QR code traceability
- DLC® (DesignLights Consortium) Qualified - see [www.designlights.org](http://www.designlights.org)
- Five year warranty (Terms and Conditions apply)

### PROJECT INFORMATION

Project Name \_\_\_\_\_

Type \_\_\_\_\_

Catalog No. \_\_\_\_\_

Date \_\_\_\_\_

### CONSTRUCTION

Luminaire housing and end caps are die formed code gauge cold rolled steel. Acrylic lens (LSR) features smooth curvature for an architectural appearance.

### FINISH

White painted parts are treated with a five stage phosphate bonding process and finished after fabrication with a minimum 90% reflective gloss baked enamel.

### CEILING COMPATIBILITY

Luminaire is available to fit most standard ceiling types. NEC-compliant T-bar clips supplied with all grid trim fixtures. See ceiling details on reverse. For hard ceilings order G trim and FK flange accessory. Assemble then support FK accessory at ceiling plane using tie wires (by others). For ⅝" wide ceiling tees order ⅝" G kit accessory to trim fixture corners. For Surface Mount order SM trim option or G trim with accessory surface mounting kit. Finished depth of surface mounted fixture is 1⅞". Wiring access for surface fixtures from back of fixture only. Not suitable for end-to-end mounting.

### INSTALLATION

Unique telescoping housing is 1½" deep allowing installation in extremely shallow plenums. Housing is formed in two interlocking sections compressed narrower than the T-bar opening to simplify handling and reduce the depth required for installation to 3" required at one end of the fixture only. Once the fixture is in place in the T-bar opening the installer slides the two portions to full width. Tabbed design automatically locks the fixture to full width. An access plate is furnished with each luminaire for fast wiring access. No need to open fixture.

### CERTIFICATION

All luminaires are built to UL 1598 and 2108 standards and bear appropriate CSA labels. Damp location is standard. Emergency-equipped fixtures labeled and CSA certified to UL 924 and Dry Location unless specified. Adheres to LM79, LM80, and TM21 industry standards. IC rating is standard on all models (except with thru wiring). DLC® (DesignLights Consortium) Qualified. Please refer to the DLC website for specific product qualifications at [www.designlights.org](http://www.designlights.org).

### WARRANTY

Five year warranty (Terms and Conditions apply).

## ORDERING INFORMATION

## EXAMPLE LZPT14-35LWG-LSR0-EDU

LZPT		14		-		-		LSR		0		-		-	
MODEL	COLOR TEMP	LUMEN OUTPUT	SHIELDING	DRIVER	VOLTAGE	OPTIONS	SIZE	REFLECTOR	CEILING TYPE						
LZPT LED Zero Plenum® Troffer	30 3000K 35 3500K 40 4000K 50 5000K	XW Extra Low Watt VW Very Low Watt MW Medium Low Watt LW Low Watt ML Medium Lumen HL High Lumen VL Very High Lumen XL Extra High Lumen	LSR Linear Prismatic Lens with Surface Relief Diffuser	E Fixed Output ESD Step Dimming <sup>2,3</sup> ED 0-10V Dimming ED1 0-10V 1% Dimming LUTH Hi-Lume 1% EcoSystem LED driver with Soft-on, Fade-to-Black dimming technology <sup>2,3</sup>	U 120V-277V 347 347V	GLR Fast Blow Fuse GMF Slow Blow Fuse C38890 3-Wire Flex, 90° Connector C48890 4-Wire Flex, 90° Connector C58890 5-Wire Flex, 90° Connector 4TB (4) Bulk T-bar Clips ELL14 Emergency Battery Pack Installed, 1400 Lumens <sup>2</sup> CP Chicago Plenum	14 1' x 4'	0 Open	G Grid Lay-in SM Surface Mount <sup>1</sup>						

<sup>1</sup> LZPT may be ordered as a factory assembled surface mounted unit, or ordered as a grid "G" ceiling type and surface mounted in the field using the ZPTSMK surface mounting kit. Not suitable for continuous row mounting.

<sup>2</sup> N/A on HL, VL, and XL lumen packages.

<sup>3</sup> Not available in 347V

### ACCESSORIES (ORDER SEPARATELY)

- ZPTSMK14** LZPT Surface Mounting Kit (1' x 4')
- FK14** 1' x 4' Flange Kit
- ZPT14 ⅝" G** Grid Filler Kit (for use in ⅝" wide tee ceilings)

### PRODUCT AVAILABILITY

Lumen Package	Nominal Lumens	Watts	Lumens Per Watt
XW	2600-2800	26	100-108
VW	3300-3600	33	100-109
MW	3900-4250	38	103-112
LW	4350-4700	43	101-109
ML	4900-5300	48	102-110
HL	5500-6000	57	97-105
VL	7200-7850	77	94-102
XL	8400-9100	92	91-99

Nominal lumen range represents 3000K through 5000K. Lumens vary according to color temperatures and other factors. See specific photometric test(s).

Protected by US Patents 7,234,832 B2; 7,413,323 B2; 7,390,111 B2.  
Protected by China Patents ZL200610058339.2; ZL200610058340.5.  
Protected by Mexico Patents 263914; 264402.  
Protected by Canada Patents 2,537,985; 2,538,201.  
Specifications subject to change without notice.

**PHOTOMETRIC DATA**

**LUMINAIRE DATA**

Luminaire	LZPT14-35LWG-LSRO-EU LZPT LED Zero Plenum Troffer, Recessed Architectural 1 x 4 LED with frosted linear prismed lens
Ballast	D10CC55UNVTZ-C
Ballast Factor	1.00
Lamp	LED
Fixture Lumens	4415
Watts	41.90
Mounting	Recessed
Shielding Angle	0° = 90 90° = 90
Spacing Criterion	0° = 1.24 90° = 1.47
Luminous Opening in Feet	Length: 3.94 Width: 0.92 Height: 0.00

**ZONAL LUMEN SUMMARY**

Zone	Lumens	% Lamp	% Fixt.
0-30	1089	24.7	24.7
0-40	1826	41.4	41.4
0-60	3342	75.7	75.7
0-90	4415	100.0	100.0
0-180	4415	100.0	100.0

**ENERGY DATA**

Total Luminaire Efficiency	100.0%
Total Lumens per Watt	105
IESNA RP-1-2004 Compliance	Non-Compliant
Comparative Yearly Lighting Energy Cost per 1000 Lumens	\$2.29 based on 3000 hrs. and \$0.08 per KWH

Test LZPT14-35LWG-LSRO-EU Test Date 2/9/2015

**INDOOR CANDELA PLOT**

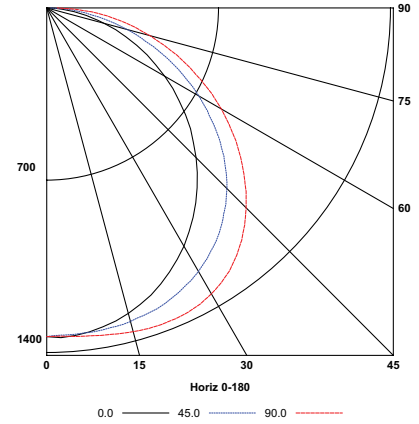

**LUMINAIRE DATA**

Luminaire	LZPT14-35MLG-LSRO-EU LZPT LED Zero Plenum Troffer, Recessed Architectural 1 x 4 LED with frosted linear prismed lens
Ballast	D10CC55UNVTZ-C
Ballast Factor	1.00
Lamp	LED
Fixture Lumens	4955
Watts	47.20
Mounting	Recessed
Shielding Angle	0° = 90 90° = 90
Spacing Criterion	0° = 1.24 90° = 1.47
Luminous Opening in Feet	Length: 3.94 Width: 0.92 Height: 0.00

**ZONAL LUMEN SUMMARY**

Zone	Lumens	% Lamp	% Fixt.
0-30	1221	24.6	24.6
0-40	2047	41.3	41.3
0-60	3749	75.7	75.7
0-90	4955	100.0	100.0
0-180	4955	100.0	100.0

**ENERGY DATA**

Total Luminaire Efficiency	100.0%
Total Lumens per Watt	105
IESNA RP-1-2004 Compliance	Non-Compliant
Comparative Yearly Lighting Energy Cost per 1000 Lumens	\$2.29 based on 3000 hrs. and \$0.08 per KWH

Test LZPT14-35MLG-LSRO-EU Test Date 2/9/2015

**INDOOR CANDELA PLOT**

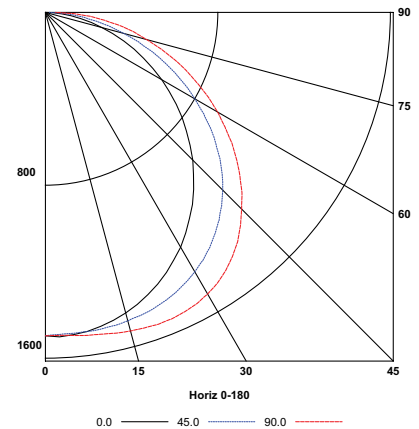

**LUMINAIRE DATA**

Luminaire	LZPT14-35HLG-LSRO-EU LZPT LED Zero Plenum Troffer, Recessed Architectural 2 x 2 LED with frosted linear prismed lens
Ballast	D10CC55UNVTZ-C
Ballast Factor	1.00
Lamp	LED
Fixture Lumens	5556
Watts	55.90
Mounting	Recessed
Shielding Angle	0° = 90 90° = 90
Spacing Criterion	0° = 1.24 90° = 1.47
Luminous Opening in Feet	Length: 3.94 Width: 0.92 Height: 0.00

**ZONAL LUMEN SUMMARY**

Zone	Lumens	% Lamp	% Fixt.
0-30	1365	24.6	24.6
0-40	2289	41.2	41.2
0-60	4199	75.6	75.6
0-90	5556	100.0	100.0
0-180	5556	100.0	100.0

**ENERGY DATA**

Total Luminaire Efficiency	100.0%
Total Lumens per Watt	99
IESNA RP-1-2004 Compliance	Non-Compliant
Comparative Yearly Lighting Energy Cost per 1000 Lumens	\$2.42 based on 3000 hrs. and \$0.08 per KWH

Test LZPT14-35HLG-LSRO-EU Test Date 2/9/2015

**INDOOR CANDELA PLOT**

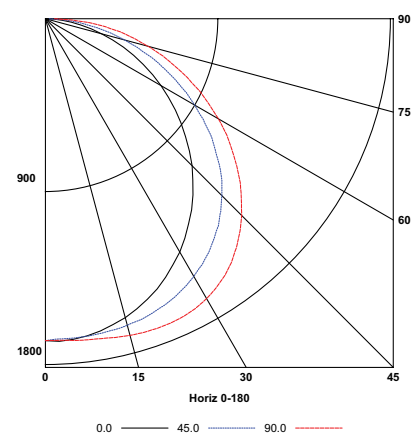

**DIMENSIONAL DATA**

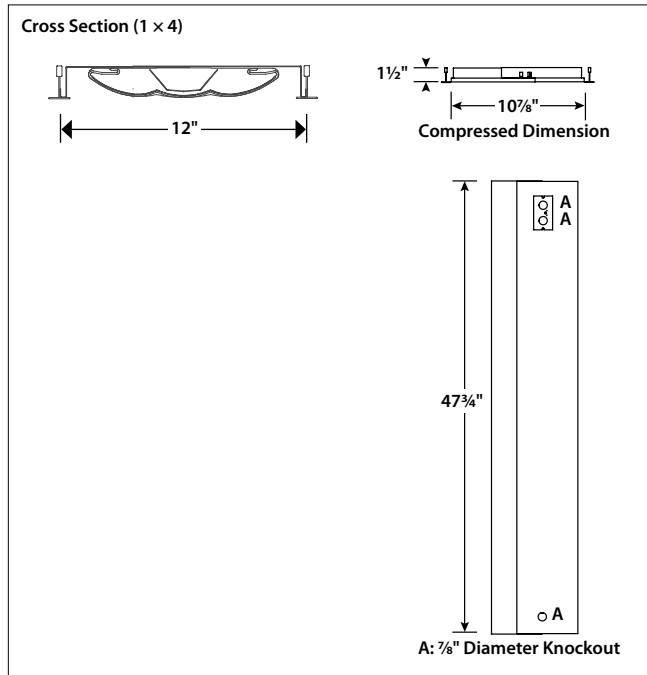

**Telescoping Housing (End View)**

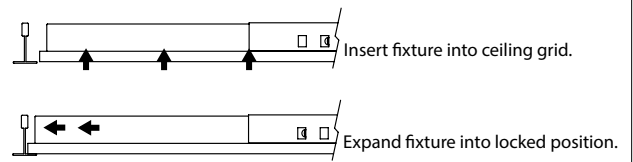

**End Installation Detail (Side View)**

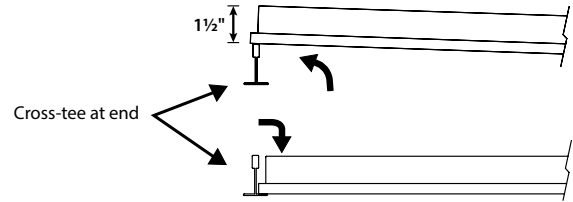

In its compressed configuration, fixture can be slid between and parallel to the tee runners. Allow 1 1/2" above cross-tee at one end of luminaire for insertion. Allow 1" above access plate for feeding power through a 90° connector.

**Flange kit rough in dimensions for single unit only:**  
nominal dimension + 3/8"

**NOTE:** All dimensions are in inches; dimensions and specifications are subject to change without notice. Please consult factory or check sample for verification.